



GEZE ACTIVATION DEVICES AND SENSOR SYSTEMS  
PERFECTLY CONTROLLED AUTOMATIC DOOR DRIVES



## TABLE OF CONTENTS

Overview: GEZE activation devices and sensor systems	<b>4</b>
Overview table for the application of activation devices on automatic door systems	<b>6</b>
<b>Activation</b>	
GEZE GC 302 radar movement detector	<b>7</b>
GEZE GC 304 radar movement detector	<b>10</b>
GEZE GC 306 proximity switch	<b>13</b>
GEZE AIR 20-Var active infrared detector	<b>15</b>
GEZE wireless programme	<b>17</b>
GEZE activation detector	<b>20</b>
GEZE LED sensor buttons	<b>22</b>
<b>Presence detectors</b>	
GEZE GC 342 laser scanner	<b>24</b>
GEZE GC 338 sensor strip	<b>26</b>
GEZE GC 335 sensor strip	<b>29</b>
GEZE GC 341 active infrared light curtain	<b>32</b>
GEZE GC 339 active infrared light curtain	<b>34</b>
GEZE GC 333 C active infrared light curtain	<b>38</b>
GEZE GZ 470 V / GZ 472 V safety photoelectric barrier	<b>40</b>
<b>Combined detectors</b>	
GEZE GC 365 combined detector	<b>42</b>
GEZE GC 363 combined detector	<b>45</b>
<b>Programme switches</b>	
GEZE programme switch	<b>49</b>
GEZE key switch	<b>51</b>
GEZE safety switches and push buttons	<b>53</b>
<b>Smoke switches and control units</b>	
GEZE RSZ 6 smoke switch control unit	<b>55</b>
<b>Miscellaneous accessories</b>	
<b>References</b>	
	<b>60</b>

## GEZE activation devices and sensor systems

### Activation of automatic drives

For the reliable operation of an automatic door, the choice of the appropriate activation devices is of considerable importance. The product range of the GEZE activation devices offers the optimum activation device for every door situation.

GEZE activation devices control and safeguard all GEZE automatic solutions according to international standards. They enable complete solutions from a single source, to be designed to meet individual needs.

#### AUTOMATIC SWING DOOR SYSTEMS



Automatic swing door systems from GEZE ease the access of a door every time when the manual opening is too hard or inconvenient. They are recommended in public as well as in private buildings, when convenience, accessibility, safety and hygiene are necessary or when energy has to be saved: in shopping centres, schools, office or industrial buildings, airports, clinics, vestibules or in private homes.

- 1 = swing door drive
- 2 = radar movement detector
- 3 = plastic elbow switch
- 4 = programme switch with key switch
- 5 = proximity switch
- 6 = elbow switch
- 7 = LED sensor button glass
- 8 = manual trigger switch
- 9 = LED sensor foot switch
- 10 = safety sensor

#### AUTOMATIC SLIDING DOOR SYSTEMS



Sliding doors are space-saving, elegant and modern. As glass solutions, they are ideal when it comes to making good use of daylight and fulfilling optical criteria. Automatic sliding door systems from GEZE can be used to implement an extremely wide range of application requirements within one building. In the entrance area, in vestibules or for automating internal doors, the automatic sliding doors from GEZE combine design and barrier-free convenience. They also meet the demands made on escape and rescue routes.

- 1 = sliding door drive
- 2 = moving leaf
- 3 = fixed panel
- 4 = combined detector
- 5 = active infrared light curtain
- 6 = programme switch with key switch
- 7 = plastic elbow switch
- 8 = LED sensor button glass
- 9 = proximity switch
- 10 = elbow switch
- 11 = LED sensor foot switch
- 12 = photoelectric barriers

## GEZE ACTIVATION DEVICES / SENSOR SYSTEMS

### DIN 18650

The industrial standard DIN 18650 was created to be able to guarantee operators and users of automatic doors optimum safety. GEZE automatic doors as well as activation devices and sensor systems are type-tested according to DIN 18650 and certified.

### EN 16005

The European standard EN 16005 sets out the design requirements and testing methods used to ensure the safe use of automatic doors. The new standard has created a Europe-wide safety standard for automatic doors. All automatic door systems and safety sensors from GEZE meet the EN 16005 standard and are available.

### AUTOMATIC REVOLVING DOOR SYSTEMS



The TSA 325 NT drive variant with its customer-specific diameter as well as height and canopy height is the focal point of modern façade design – especially in large and representative buildings. Different materials for door leaves and drum walls offer a variety of design options. The revolving door is designed to take heavy loads and is thus the ideal solution for places that have a high frequency of visitors. Thanks to its high insulating effect against weather conditions, it also saves energy and ensures a good, consistent indoor climate.

- 1 = revolving door drive  
(can alternatively be installed in the floor)
- 2 = radar movement detector
- 3 = active infrared light curtain
- 4 = emergency stop button
- 5 = programme switch with key switch (bollard on-site)

### AUTOMATIC CURVED SLIDING DOOR SYSTEMS



Automatic curved sliding door systems are a function and design element at the same time. Even with small outer dimensions, they create enormous space for passage. The door systems can be given a convex or concave form and can be connected to the building in different ways.

- 1 = sliding door drive
- 2 = combined detector
- 3 = active infrared light curtain
- 4 = programme switch with key switch (bollard on-site)

## Overview table for the application of activation devices on automatic door systems

	Swing doors	Sliding doors	Circular sliding doors	Revolving swing doors
<b>Activation</b>				
Radar movement detector	•	•	•	•
AIR movement detector	•			
Wireless programme	•	•	•	
Mechanical push button	•	•	•	
Sensor push button	•	•	•	
Rotary switch contact	•			
<b>Presence detectors</b>				
Light barriers		•		
Safety sensor	•			•
AIR light curtains		•	•	•
Laser scanner	•			
<b>Combined detectors</b>				
Detector including AIR light curtain		•	•	
<b>Programme switches</b>				
Programme switch	•	•	•	•
Key switch	•	•	•	•
Main / safety switch	•	•	•	•
<b>Smoke switches and control units</b>				
Smoke switches and control units	•			

• = Yes



## GEZE GC 302 radar movement detector

### Radar movement detector for activating automatic doors

GEZE GC 302 is used on internal and external automatic doors. Due to the pre-programmed settings, commissioning is fast and convenient. The detector can be configured using a switch or remote control. The radar field is clearly defined (narrow field, wide field) and guarantees reliable detection. The integrated motion tracking feature even identifies slow movements, which is useful for people with restricted mobility. Special features include the detection of people's direction of movement and the fading out of cross-traffic. These mean external doors can contribute to energy saving, because the opening impulse is not triggered by people walking past the door.

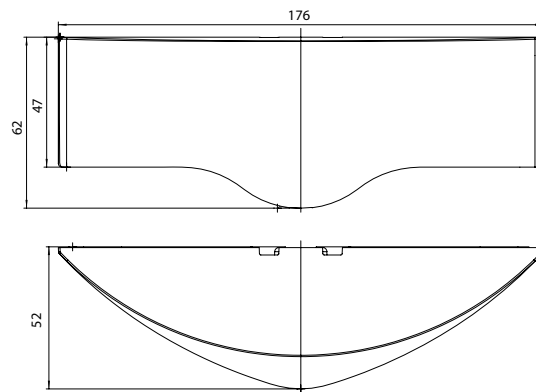

#### Area of application

- Activation of automatic swing, sliding, folding, revolving and curved sliding doors
- Use on pavements and in passages so that passing persons do not trigger an opening impulse
- Use in homes for the elderly and care homes, so that even very slow-moving people and wheelchair users are safely identified

# GEZE ACTIVATION

## Technical data

Product features	GEZE GC 302
Technology	Electromagnetic radar waves
Transmission frequency	24.125 GHz
Operating voltage	12-36 V DC / 12-28 V AC
Operating current	approx. 50 mA at 24 V DC
Output	GC 302 R: potential-free relay output, 48 V AC/DC, 0.5 A AC/1 A DC, 60 VA/30 W output current available: no detection/no fault, output current < 3 V DC or no current: detection or fault
Connection type	Push-fit screw terminal
Height	62 mm
Width	176 mm
Depth	52 mm
Installation height (max.)	4000 mm
Connection cable	5000 mm
Weight	150 g
IP rating	IP54
Operating temperature	-20 – 60 °C
Humidity	0-90 % relative, non-condensing
Approvals	DIN 18650 / EN 16005

## Detection area and application example

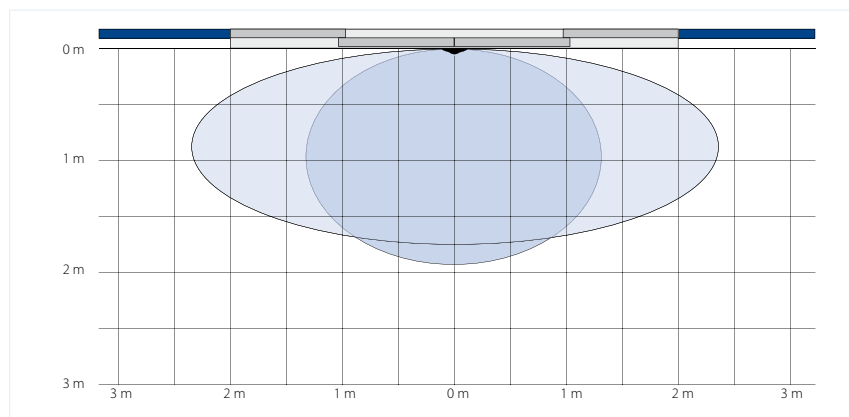

**Narrow field (1):** min. 0.7 x 0.6 m (W x D), max. 2.7 x 1.9 m (W x D)

**Wide field (2):** min. 1.1 x 0.6 m (W x D), max. 4.7 x 1.7 m (W x D)

Given values measured at installation height 2.2 m and inclination angle 35°



### Dimensional drawings for accessories

Ceiling installation kit for GC 302

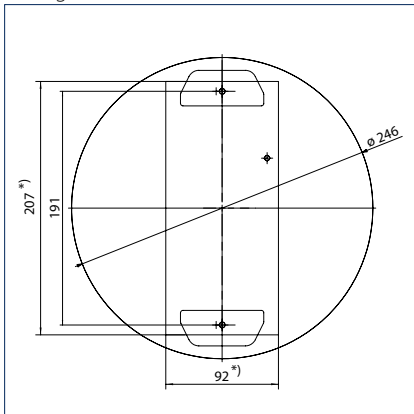

Weather hood for GC 302

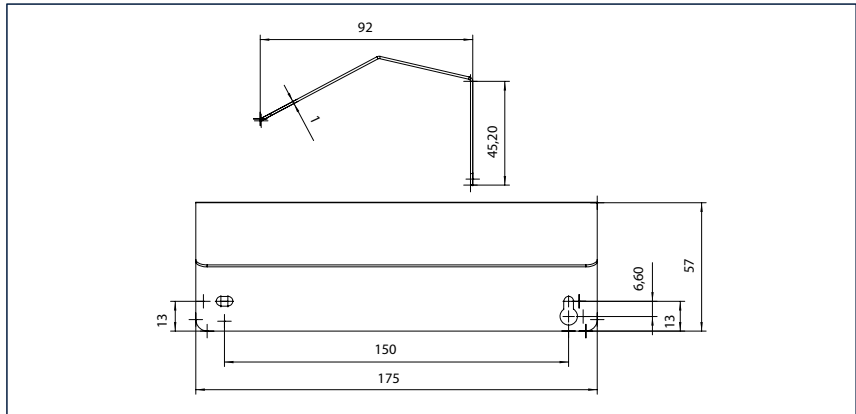

\* = Ceiling cut-out

### GEZE GC 302 - Order information

Description	Version	ID.No.
GC 302 R radar movement detector	black	124087
Radar movement detector for activating automatic doors	acc. to RAL	124088
<b>Accessories</b>		
Weather hood GC 302	EV1	115339
Protection against rainfall in the outdoor area		
Ceiling installation kit GC 302	white	115384
Installation kit for integrating the sensor into the ceiling		
Remote control GC 302		099575
Setting and parameter setting of GC 302		



Deutsche Telekom, Bonn, Germany (photo: Lothar Wels)

## GEZE GC 304 radar movement detector

### Radar movement detector with individual settings for activating automatic doors

GEZE GC 304 is used on internal and external automatic doors. Due to individual settings, this detector can be configured for demanding environmental conditions e.g. for interlocking door systems, curved sliding doors and metal environments. The detector can be configured via switches or a remote control. The radar field is clearly defined (narrow field, wide field) and guarantees reliable detection even with difficult floor conditions (e.g. reflective floor, floor mat). The integrated motion tracking feature even identifies slow movements, which is useful for people with restricted mobility. The detection of people's direction of movement and fading out of cross-traffic can contribute to energy saving, because the door's opening impulse is only triggered if necessary.

#### Special version

GC 304 SF: offers maximum security due to integrated self-monitoring, and is thus approved for use in emergency exits.

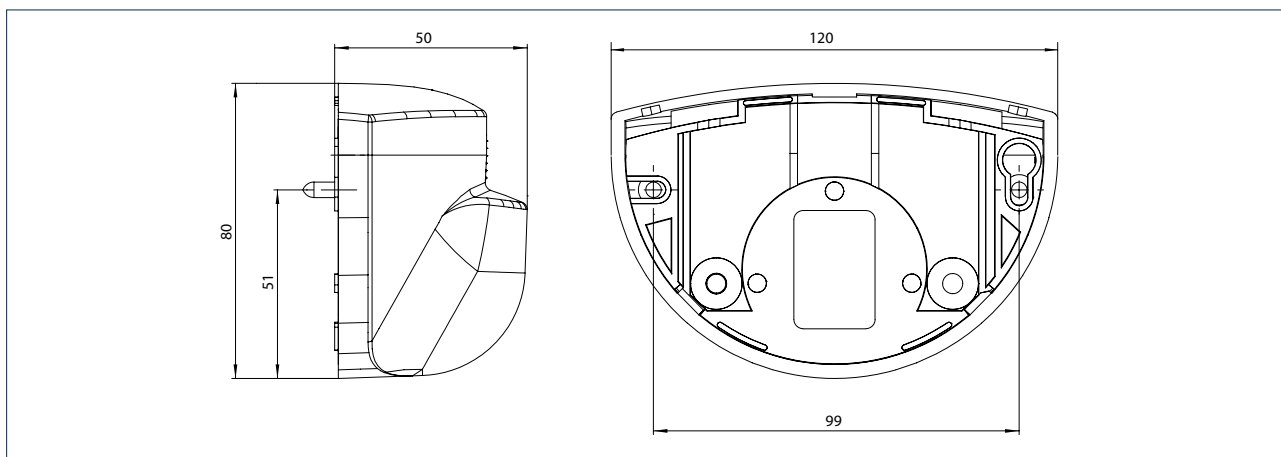

#### Area of application

- Activation of automatic swing, sliding, folding, revolving and curved sliding doors
- Use on pavements and in passages so that passing persons do not trigger an opening impulse
- Use in homes for the elderly and care homes, so that even very slow-moving people and wheelchair users are safely identified
- Version SF: for use in emergency exits

## Technical data

Product features	GEZE GC 304
Technology	Electromagnetic radar waves
Transmission frequency	24.175 GHz
Transmission frequency	GC 304 R: 24.175 GHz, GC 304 SF: 24.150 GHz
Operating voltage	12-24 V DC/AC
Operating current	approx. 85 mA at 24 V DC
Output	GC 304 R: potential-free relay output, 42 V AC/60 V DC, 1 A, 60 VA/30 W GC 304 SF: frequency output, transistor ON: 100 mA, transistor OFF: < 200 mA
Connection type	System plug-type connector
Height	80 mm
Width	120 mm
Depth	50 mm
Installation height (max.)	4000 mm
Connection cable	5000 mm
Weight	215 g
IP rating	IP54
Operating temperature	-20 – 55 °C
Humidity	< 90 % relative, non-condensing
Approvals	DIN 18650, EN 16005

## Detection area and application example

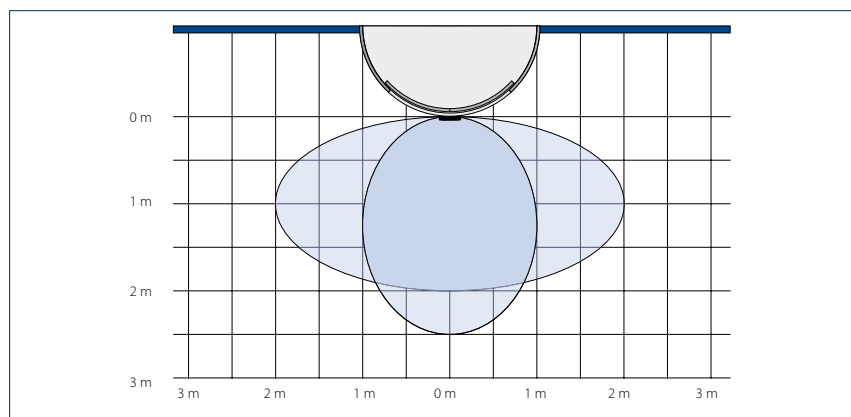

**Narrow field (1):** min. 0.5 x 0.75 m (W x D), max. 2.0 x 2.5 m (W x D)

**Wide field (2):** min. 1.0 x 0.5 m (W x D), max. 4.0 x 2.0 m (W x D)

Given values measured at installation height 2.2 m

**Dimensional drawings for accessories**

Ceiling installation kit for GC 304

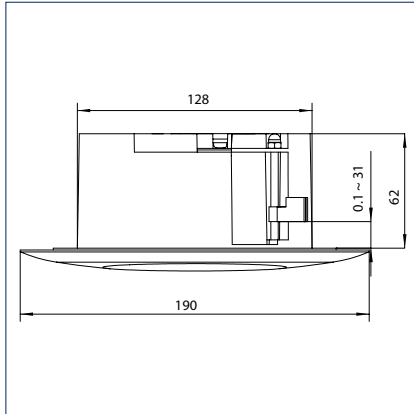

Weather hood for GC 304

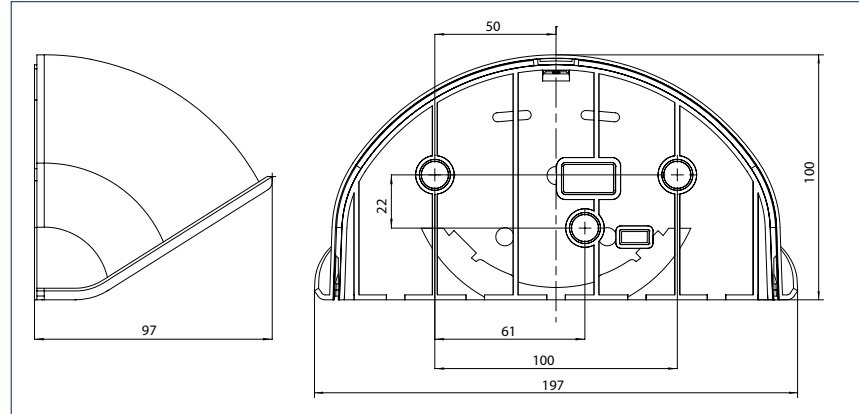

\* = Ceiling cut-out

**GEZE GC 304 - Order information**

Description	Version	ID.No.
GC 304 R radar movement detector Radar movement detector with individual settings for activating automatic doors	black	130651
GC 304 R SF radar movement detector Activation of automatic doors in the escape direction	black	130652
<b>Accessories</b>		
Weather hood GC 304 Protection against rainfall in the outdoor area	transparent	130654
Ceiling installation kit GC 304 Installation kit for integrating the sensor into the ceiling	black	130653
Remote control GC 363, GC 339, GC 304 Setting and parameter setting of GC 363, GC 339 and GC 304. Compatible with GC 362, GC 333, GC 333 C and ACTIV S GE	black	100061

## GEZE GC 306 proximity switch

### Non-contact activation of automatic doors

Open doors in a flash: with GC 306, internal doors without a haptic perception requirement can also be activated cleanly and comfortably. The sensor ensures, for instance, bacteria-free access to toilets or germ-free conditions in hotel kitchens, swimming pools and doctors' surgeries. The impulse generator is installed at hand height and precisely detects people and objects – independently of their direction of movement – both in the direct vicinity of only 10 cm, as well as 50 cm away. The different scanning ranges can be optimally adapted to existing environmental conditions and the interests of the user groups. Non-contact sensors offer a high level of operating comfort – people only need to approach them to trigger the automatic opening mechanism – and the advantage of absolute hygiene. The optimum system structure permits simple and time-saving installation in the flush mounted socket.

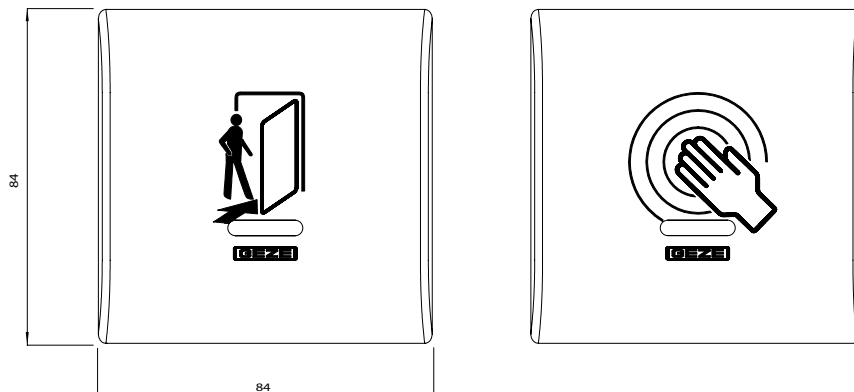

### Area of application

- Activation of automatic swing, sliding, folding, revolving and curved sliding doors
- Clean rooms with high hygiene requirements (laboratory, hospitals, operating theatres etc.)
- Homes for the elderly and care homes
- Homes for the disabled
- Hotels and gastronomy

Technical data

Product features	GEZE GC 306
Technology	Electro-magnetic radar waves
Operating voltage	24 V DC/AC
Output	Potential-free relay output, 48 V AC / DC, 1 A AC / DC, 60 VA / 30 W
Connection type	Screw terminal
Height	84 mm
Width	84 mm
Depth	32 mm
Installation height	at hand level
IP rating	IP30
Operating temperature	-20 – 55 °C
Humidity	< 90 %
Approvals	R&TTE 1999/5/EC, EMC 2004/108/EEC

Detection area and application example

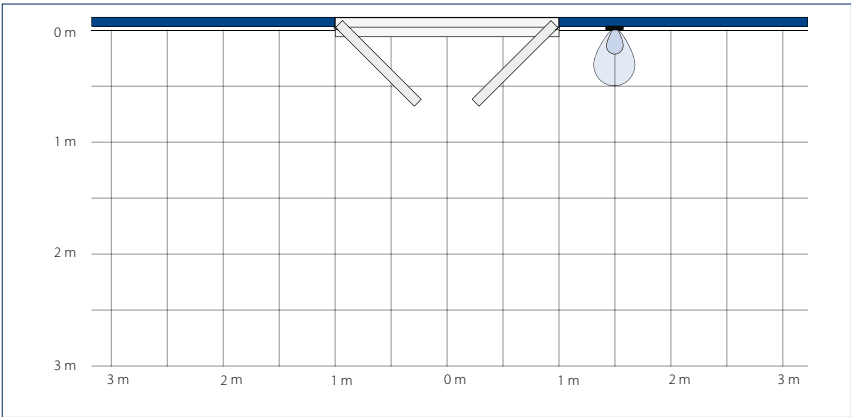

Scanned area: 10-50 cm

GEZE GC 306 - order information

Description	Version	ID no.
GC 306 with GEZE pictogram Proximity switch for activating automatic doors	alpine white	163028
GC 306 with GEZE pictogram Proximity switch for activating automatic doors	alpine white	163029
Surface-mounted box GC 306	alpine white	164059

## GEZE AIR 20-Var active infrared detector

### Light switch for monitoring the door handle of automatic swing doors

This compact active infrared detector has been designed for mobile and stationary applications. GEZE AIR 20-Var is excellently suited for use in restricted space for the presence detection of persons and objects. In addition, this detector can be used for occupied checks in interlocking door systems. The scanning range can be adjusted from 1.2 m - 2.2 m using a mechanical adjustment screw.

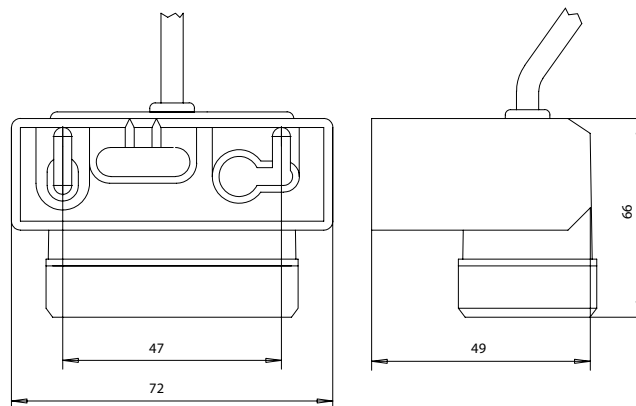

#### Area of application

- Monitoring of the door handle for activating automatic swing doors
- Use in restricted space for presence detection of persons or objects
- Use for occupied checks in interlocking door systems



## GEZE ACTIVATION

## Technical data

Product features	GEZE AIR 20-Var
Technology	Active infrared beams
Operating voltage	12-30 V DC / 18-28 V AC
Operating current	approx. 50 mA
Output	Potential-free relay output, 48 V AC / DC, 0.5 A AC / 1 A DC, 55 VA / 24 W, switching mode: bright method (output contact closed on detection)
Connection type	Push-fit screw terminal
Height	66 mm
Width	72 mm
Depth	49 mm
Scanning range adjustment	1.2 - 2.2 m
Installation height (min.)	1200 mm
Installation height (max.)	2200 mm
Connection cable	5000 mm
Light beam cross-section	60 x 60 mm
IP rating	IP52
Operating temperature	-20 – 60 °C
Humidity	< 90 % relative, non-condensing
Approvals	CE according to EMC Directive 89/336 EEC

## Detection area and application example

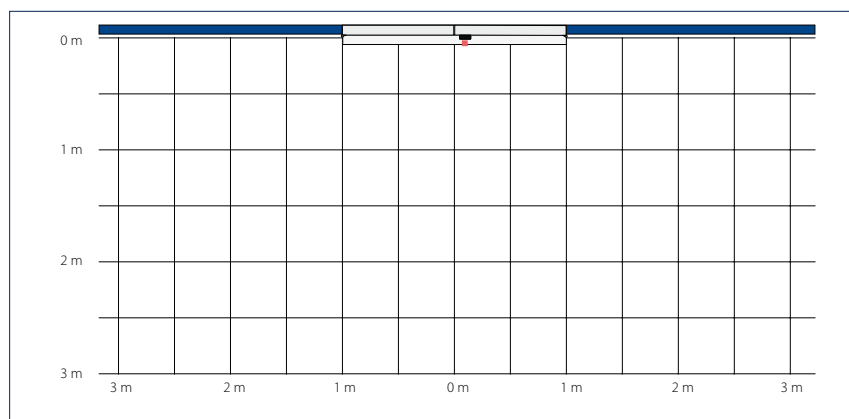

0.06 x 0.06 m (W x D)

Given values measured at detector range 1.3 m

## GEZE AIR 20-Var - Order information

Description	Version	ID.No.
GEZE AIR 20-Var Light switch for monitoring the door handle of automatic swing doors	black	082689

## GEZE wireless programme

### Wireless activation with system – reliable, convenient and secure at the touch of a button

Remote controls for a wide range of applications in our daily life bring added convenience. The elderly, disabled or physically weaker people can be afforded better quality of life, and they make work easier for care staff. They are increasingly becoming standard for barrier-free and age-appropriate living.

The wireless control of doors and windows using the GEZE wireless programme makes connection to a power supply superfluous. Thanks to the tiny dimensions of the radio modules, they can easily be integrated in the drive or flush-mounted box and can also be clipped directly into the elbow switch and mounted wirelessly on glass.



#### Area of application

- Retro-fitting without need to lay cables and using existing switches/buttons
- Installation without connection to power e.g. on glass
- Wireless activation with system – reliable, convenient and secure at the touch of a button
- Combined activation of doors and windows using a remote control

The GEZE wireless programme is safe! The encryption of the radio signals using a rolling code with up to 74 trillion code combinations means that taught radio transmitters cannot be “cracked”. Each transmitter is taught individually and safely to eliminate false or unauthorised wireless control. The radio transmitter has a range of up to 30 metres. Doors can be controlled over great distances and even through walls. The radio receiver has two outputs. At each of the two outputs, individual radio receivers can be taught and evaluated differently according to the connection to the control. In addition, it is possible to select different modes of operation via a DIP switch. For example, a short push of the button can be used to just open the door, whereas if the button is pushed for longer the door is held open. The wireless programme is compatible with all GEZE door and window drives.



WTH-1 remote control



WTH-2 remote control



WTH-4 remote control

## GEZE ACTIVATION



WTH transmitting module



WRM-24 receiving module



WRM-24B receiving module in IP-54 housing



WRM-230 receiving module



WRM-230B receiving module in IP-54 housing



WRB-5 radio reception board

	<b>WTH-1 remote control</b>	<b>WTH-2 remote control</b>	<b>WTH-4 remote control</b>
Specification	incl. wall bracket	incl. wall bracket	incl. wall bracket
Version	1 channel	2 channels	4 channels
IP rating	IP54	IP54	IP54
Dimensions	78 x 51 x 15 mm	78 x 51 x 15 mm	78 x 51 x 15 mm
Battery	12 V, 45 mAh A235	12 V, 45 mAh A235	12 V, 45 mAh A235
Battery life cycle	10,000 operations	10,000 operations	10,000 operations

	<b>WTH transmitting module</b>	<b>WRM-24 receiving module</b>	<b>WRM-24B receiving module in IP-54 housing</b>
Specification	incl. 3 connection cables incl. protective casing (can be clipped in KFT elbow switch)	2 outputs, relay contact 100 mA, 48 V	2 outputs, relay contact 100 mA, 48 V
Version		flush-mounting	surface-mounting
IP rating	IP20	IP20	IP54
Dimensions	44 x 30 x 11 mm	52 x 47 x 23 mm	130 x 80 x 35 mm
Battery	3V, 150 mAh CR2032		
Battery life cycle	50,000 operations		
Current consumption		24 V, 12.5 mA in standby	24 V, 12.5 mA in standby

	<b>WRM-230 receiving module</b>	<b>WRM-230B receiving module in IP-54 housing</b>	<b>WRB-5 radio reception board</b>
Specification	2 outputs, relay contact 5A, 230V	2 outputs, relay contact 5A, 230V	2 outputs, for clipping onto the DCU control unit circuit board (for clipping into the control unit)
Version	flush-mounting	surface-mounting	
IP rating	IP20	IP54	
Dimensions	52 x 47 x 23 mm	130 x 80 x 35 mm	44 x 27 x 10 mm
Current consumption	230 V, 3.9 mA in standby	230 V, 5.6 mA in standby	5 V, 6 mA in standby

**Application matrix for wireless programme**

	<b>ECdrive Slimdrive Powerdrive</b>	<b>TSA Slimdrive EMD</b>	<b>ECturn</b>	<b>RWA E260 central control unit</b>	<b>Window drive</b>
Pulse signal	WRM-24, WRM-24B	WRM-24, WRM-24B	WRB-5		
Pulse and permanent signal	WRM-24, WRM-24B	WRM-24, WRM-24B	WRB-5		
Dead man's signal				WRM-24, WRM-24B	WRM-230, WRM-230B
Self-adjusting signal				WRM-24, WRM-24B	WRM-230, WRM-230B

**Area of application****Radio transmitters**

- Transmitter frequency 433.93 MHz
- Safe coding of radio signals using rolling code (approx. 74 trillion code combinations)
- Radio range up to 30 m inside the building
- LED function indicator for battery and transmission check
- All-purpose applicability for doors, windows and for smoke and heat extraction systems, which can be activated wirelessly in a system concept individually or together in groups
- or defined in groups without the need for cables

**Radio receivers**

- Simple teaching of the radio transmitters using teach button with acoustic feedback
- Up to 85 radio transmitters can be taught to the WRM receiving modules, up to 12 radio transmitters can be taught to the WRB-5 radio reception board
- DIP switch for selecting mode of operation of the radio receivers (pulse operation, pulse and permanent operation, dead man's operation or self-adjusting operation)
- Tiniest housing dimensions for integrated installation within the drive or a flush-mounted box
- IP54 surface-mounting version for protected outdoor areas
- 2 outputs for individual connection possibilities

**Order information**

<b>Bezeichnung</b>	<b>Ausführung</b>	<b>Id. Nr.</b>
Remote control	WTH-1	131209
	WTH-2	131210
	WTH-4	131211
Spare battery for remote control		131217
Transmitting module	WTM	131212
Spare battery for transmitting module		131218
KFT elbow switch	white, surface-mounting	114078
	stainless steel, surface-mounting	114077
Backplate for KFT elbow switch	white	131219
	stainless steel	131220
LS990 elbow switch	surface-mounting	128582
	flush-mounting	128583
LTA24-AZ vent switch	flush-mounting	129393
Receiving module	WRM-24	131213
	WRM-230	131215
	WRM-24B	131214
Receiving module in IP-54 housing	WRM-230B	131216
Radio reception board	WRB-5	135170

### GEZE activation detectors

#### Activation detectors for a wide range of different needs for the opening and closing of automatic doors

GEZE activation detectors are offered for a wide range of installations: wall or ceiling installation. All activation detectors can be used inside and outside.



Plastic elbow switch



LS990 stainless steel elbow switch



Stainless steel elbow switch IP65



AS 500 plastic rocker push button



LS990 stainless steel rocker push button



Pull button

#### Area of application

- Activation of automatic swing, sliding, folding, revolving and curved sliding doors
- Elbow switches for use in inside and outside areas
- Sensor button suitable for barrier-free use on external doors

	Plastic elbow switch	LS990 stainless steel elbow switch	Stainless steel elbow switch	AS 500 plastic rocker push button
<b>Specification</b>	<ul style="list-style-type: none"> <li>1-pole closing contact</li> <li>Switching voltage: max. 24 V DC</li> <li>Switching current: max. 1 mA</li> </ul>	<ul style="list-style-type: none"> <li>1-pole closing contact</li> <li>Switching voltage: max. 230 V AC</li> <li>Switching current: max. 10 A</li> </ul>	<ul style="list-style-type: none"> <li>1-pole changeover contact</li> <li>Switching voltage: max. 230 V AC</li> <li>Switching current: max. 1 A</li> </ul>	<ul style="list-style-type: none"> <li>1-pole closing contact</li> <li>Switching voltage: max. 230 V AC</li> <li>Switching current: max. 10 A</li> </ul>
<b>Version</b>	surface-mounting	flush-mounting/ surface-mounting	surface-mounting	flush-mounting/ surface-mounting*
<b>IP rating</b>	IP30 / IP65*	IP30	IP65	IP20
<b>Dimensions</b>	90 x 180 x 23 mm	81 x 223 x 18 mm (flush-mounting) 81 x 223 x 51 mm (surface-mounting)	75 x 250 x 17 mm	80 x 80 x 9 mm (flush-mounting)
<b>Accessories</b>	<ul style="list-style-type: none"> <li>*1-pole changeover contact IP65, ID no. 114156</li> <li>Label wheelchair users, ID no. 72581</li> <li>Back plate ID no. 131219 (white)</li> <li>ID no. 131220 (stainless steel)</li> </ul>		<ul style="list-style-type: none"> <li>Label wheelchair users, ID no. 72581</li> </ul>	<ul style="list-style-type: none"> <li>*Surface-mounted box, ID no. 120503</li> </ul>
<b>ID no.</b>	114078 (white) 114077 (stainless steel)	141042 (flush-mounting, white) 141041 (surface-mounting, white) 128583 (flush-mounting, stainless steel) 128582 (surface-mounting, stainless steel)	119898	120888

	LS990 stainless steel rocker push button	Pull button
<b>Specification</b>	<ul style="list-style-type: none"> <li>1-pole closing contact</li> <li>Switching voltage: max. 230 V AC</li> <li>Switching current: max. 10 A</li> </ul>	<ul style="list-style-type: none"> <li>Contact system: 1 normally closed / 1 normally open contact</li> <li>Switching voltage: max. 230 V DC</li> <li>Switching current: max. 10 mA</li> </ul>
<b>Version</b>	flush-mounting	incl. pull line (length 1 m)
<b>IP rating</b>	IP20	IP65
<b>Dimensions</b>	81 x 81 x 11 mm	36 x 94 x 34 mm
<b>Accessories</b>		
<b>ID no.</b>	098396	008607



Installation situation (photo: Studio BE)

### GEZE LED sensor buttons

#### Capacitive buttons for opening and closing automatic doors with high hygiene requirements

GEZE LED sensor buttons are offered for a wide range of installations: wall or floor installation. All LED sensor buttons can be used inside and outside, if high standards of hygiene, accessibility, IP protection or robustness are required.



LED sensor button



LED sensor button glass



LED sensor button 20 mm



LED sensor foot switch

#### Area of application

- Activation of automatic swing, sliding, folding, revolving and curved sliding doors
- For use in inside and outside areas
- Use in restaurants for activation by foot



	LED sensor button	LED sensor button glass	LED sensor foot switch	LED sensor button 20 mm
<b>Specification</b>	<ul style="list-style-type: none"> <li>• PNP/NPN closing contact</li> <li>• Switching voltage: max. 24 V DC</li> <li>• Switching current: max. 400 mA</li> <li>• Current consumption: max. 35 mA at 24 V</li> </ul>	<ul style="list-style-type: none"> <li>• PNP/NPN closing contact</li> <li>• Switching voltage: max. 24 V DC</li> <li>• Switching current: max. 400 mA</li> <li>• Current consumption: max. 35 mA at 24 V</li> </ul>	<ul style="list-style-type: none"> <li>• PNP closing contact</li> <li>• Switching voltage: max. 24 V DC</li> <li>• Switching current: max. 400 mA</li> <li>• Current consumption: max. 30 mA at 24 V</li> </ul>	<ul style="list-style-type: none"> <li>• PNP closing contact</li> <li>• Switching voltage: max. 24 V DC</li> <li>• Switching current: max. 400 mA</li> <li>• Current consumption: max. 20 mA at 24 V</li> </ul>
<b>Version</b>	flush mounting	surface-mounting	surface-mounting	surface-mounting
<b>IP rating</b>	IP69	IP69	IP69K	IP69K
<b>Dimensions</b>	Ø 100 mm	Ø 100 mm	100 × 100 mm	Ø 28.5 mm
<b>Accessories</b>	<ul style="list-style-type: none"> <li>• Mounting ring flat flach, ID no. 139009</li> <li>• Mounting ring high, ID no. 139010</li> </ul>		Base assembly, ID no. 182941	-
<b>ID no.</b>	137529	143412	182936	143273

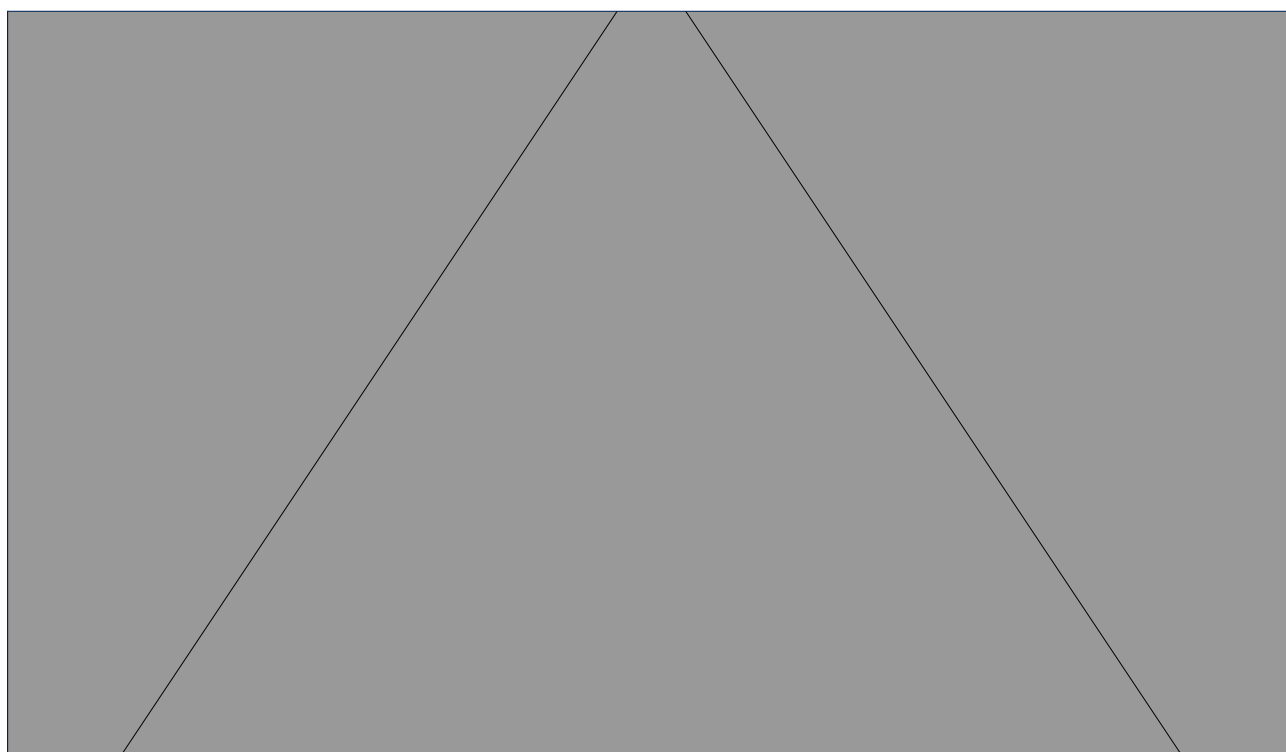

Installation situation (photo: GEZE GmbH)

## GEZE GC 342 laser scanner

### Laser scanner for the protection of automatic swing doors in compliance with DIN 18650/EN 16005

The compact and space-saving GEZE GC 342 sensor serves to protect automatic swing doors in compliance with DIN 18650/EN 16005. The sensor is preferred for use with difficult floor conditions (e.g. floor mats, metal runners, dark and absorbent floors). A large-scale detection area across the entire width of the door guarantees special protection. The sensor also has wall blanking, guaranteeing maximum security even with doors that run against walls. GC 342 automatically learns its environment. With just one sensor system, the protection of all GEZE swing door drives up to door leaf widths of 1600 mm can be achieved.

Thanks to the integrated wall blanking, the sensor learns its permanently installed environment – e.g. walls, radiators, windowsills. The parameter adjustment of the wall blanking in the drive can be omitted. The installation on the upper edge of the door near the hinge is cleverly solved and therefore is quick and easy to achieve. The door leaf width to be protected is learned using hand movements. Settings such as the position of the master module on the hinge side/opposite hinge side, immunity, background monitoring and monitoring of the secondary closing edge can be handled easily using DIP switches.

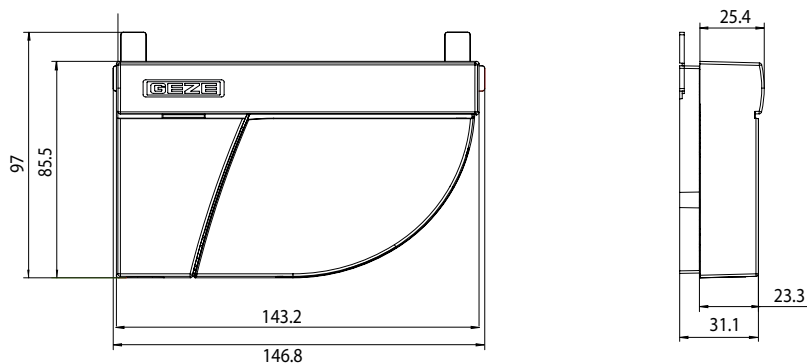

#### Area of application

- Protection of automatic swing doors in compliance with DIN 18650 / EN 16005

## GEZE PRESENCE DETECTORS

## Technical data

Product features	GC 342
Technology	Laser scanner, time-of-flight measurement
Operating voltage	24 V DC $\pm$ 15 %
Output	Transistor output, max. 42 V DC, max. 100 mA
Height	86 mm
Width	143 mm
Depth	40 mm
Installation height (min.)	1500 mm
Installation height (max.)	3870 mm
Connection cable	2500 mm
Reaction time	Door leaf protection: < 50 ms / pinch zone safety: < 90 ms
IP rating	IP54
Operating temperature	-30 – 60 °C
Humidity	0-95 % relative, non-condensing
Approvals	DIN 18650, EN 16005

## Detection area and application example

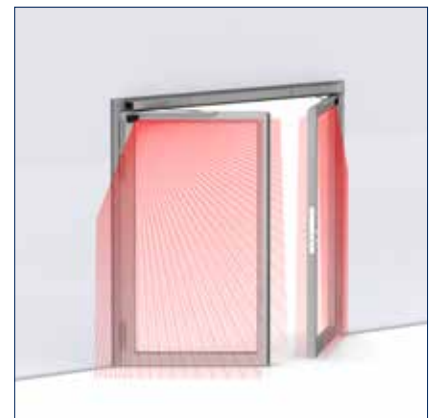
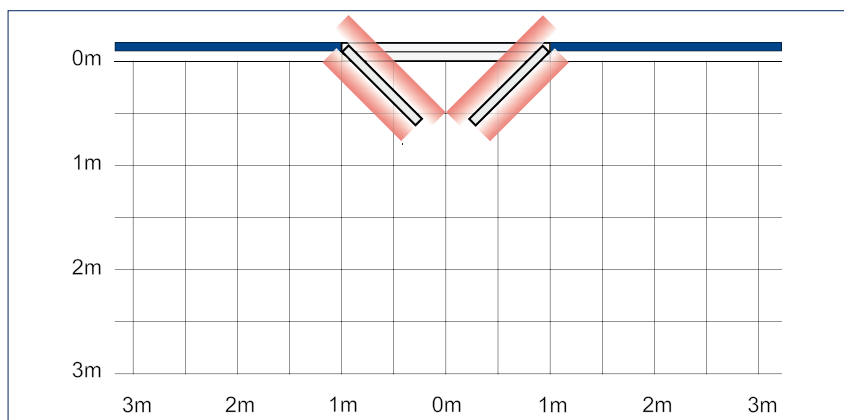

Protection range: 1,0 m at 3,87 m installation height, 1,6 m at 3,65 m installation height

Depending on the door situation and application, an additional finger protection screen is required to protect persons in need of special protection.

## GC 342 - Order information

Description	Version	ID no.
GC 342 Kit consisting of two sensors for protection of the swivelling range of automatic swing doors in accordance with DIN 18650 / EN 16005	white RAL 9016	167439
	black	167438
	stainless steel optic	167440
GC 342 (left module) consisting of one sensor for protection of the swivelling range (DIN left) of automatic swing doors in accordance with DIN 18650 / EN 16005	white RAL 9016	167433
	black	167432
	stainless steel optic	167434
GC 342 (right module) consisting of one sensor for protection of the swivelling range (DIN right) of automatic swing doors in accordance with DIN 18650 / EN 16005	white RAL 9016	167436
	black	167435
	stainless steel optic	167437
<b>Accessories</b>		
GC 342 cover set consisting of two covers (left and right versions)	white RAL 9016	167800
	black	167799
	stainless steel optic	167801
GC 342 cable set consisting of door connection cable hinge side/opposite hinge side (450 mm) and door transmission cable (2500 mm)		167759
GC 342 mounting plates consisting of two mounting plates (left and right version)	white RAL 9016	167794
	black	167793
	stainless steel optic	167795
GC 342 accessories consisting of corrugated hose (black, 650 mm), cover caps, strain relief and screw set	white RAL 9016	167806
	black	167805
	stainless steel optic	167807

## GEZE GC 338 sensor strip

### Sensor strip for the protection of automatic swing and revolving doors in accordance with DIN 18650 / EN 16005

The energy- and space-saving GEZE GC 338 sensor strip serves to protect automatic swing and revolving doors in accordance with DIN 18650 / EN 16005. The sensor strip is mainly used with difficult floor conditions (e.g. floor mats, metal rails, dark and light-absorbing floor coverings). The close-meshed detection field with a wide field of detection over the whole door width provides special protection at the main and secondary closing edges. In addition, the sensor has a wall blanking feature which makes it possible to guarantee maximum safety even with doors that open against walls. The sensor strip automatically teaches itself its environment. Protection of all GEZE swing door drives with door leaf widths of up to 1500 mm is achieved with only one sensor system. GC 338 not only offers advantages for installation and commissioning – the complete sensor system is supplied via an interface. Settings such as the position of the interface, standby mode, boost mode and grating mode can be made conveniently using the DIP switch.

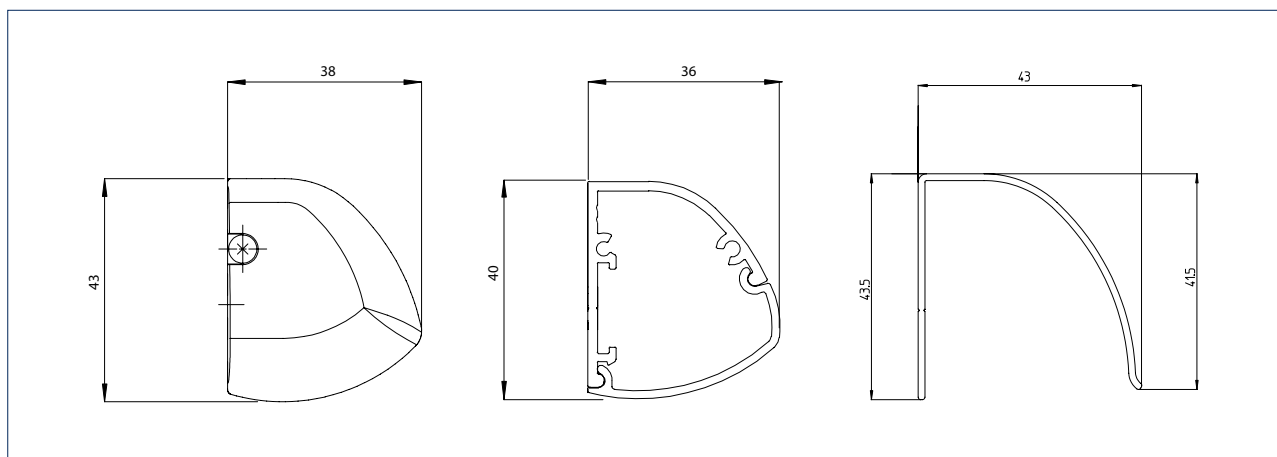

#### Area of application

- Protection of swing and revolving doors in accordance with DIN 18650 / EN 16005

## GEZE PRESENCE DETECTORS

## Technical data

Product features	GEZE GC 338
Technology	Active infrared beams
Operating voltage	24 V DC $\pm$ 20 %
Operating current	max. 200 mA (1200 strip), max. 320 mA (1500 strip) at 30 V DC
Output	PNP transistor output, max. 30 V DC, max. 100 mA
Installation height (min.)	1500 mm
Installation height (max.)	3500 mm
Connection cable	5000 mm
Reaction time	< 52 ms and < 200 ms in boost mode
IP rating	IP52
Operating temperature	-30 – 60 °C
Humidity	< 90 % relative, non-condensing
Approvals	DIN 18650, EN 16005

## Detection area and application example

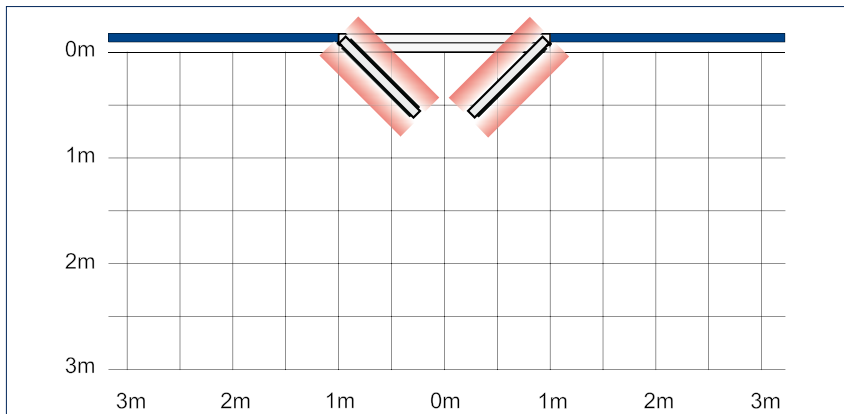

Protection range: from 0.6 m to 1.6 m at 2.2 m installation height



## GEZE GC 338 - Order information

Description	Version	ID no.
GC 338 pair of sensor strips L= 1200 mm consisting of two complete sensor strips for protection of the swivelling range of automatic swing and revolving doors in accordance with DIN 18650 / EN 16005	EV1	142219
	acc. to RAL	142825
GC 338 pair of sensor strips L= 1500 mm consisting of two complete sensor strips for protection of the swivelling range of automatic swing and revolving doors in accordance with DIN 18650 / EN 16005	EV1	142757
	acc. to RAL	142827
<b>Accessories</b>		
Adapter for sensor link arm For Powerturn, EMD / EMD-F and TSA 160 NT	EV1	144352
	acc. to RAL	153126
GC GR for GC 338 L=1200 mm For Powerturn / Powerturn F, installation on the hinge side, lever length 330 mm	EV1	157450
	acc. to RAL	157451
GC GR for GC 338 L=1500 mm For Powerturn / Powerturn F, installation on the hinge side, lever length 330 mm	EV1	157472
	acc. to RAL	157473
GC GR for GC 338 L=1200 mm For Powerturn / Powerturn F, installation on the opposite hinge side, lever length 450 mm	EV1	157474
	acc. to RAL	157475
GC GR for GC 338 L=1500 mm For Powerturn / Powerturn F, installation on the opposite hinge side, lever length 450 mm	EV1	157476
	acc. to RAL	157477

## GEZE PRESENCE DETECTORS

Description	Version	ID no.
GC GR for GC 338 L=1200 mm	EV1	149952
For EMD-F-IS DIN left, transom installation opposite hinge side, with deeper guide, incl. lever and end caps	acc. to RAL	149956
GC GR for GC 338 L=1200 mm	EV1	149958
For EMD-F-IS DIN right, transom installation opposite hinge side, with deeper guide, incl. lever and end caps	acc. to RAL	149962
GC GR for GC 338 L=1200 mm	EV1	146205
for EMD/EMD-F, with deeper guide, incl. lever and end caps	acc. to RAL	146209
GC GR for GC 338 L=1200 mm	EV1	146217
for TSA 160 NT, with deeper guide, incl. lever and end caps	acc. to RAL	146221
GC GR for GC 338 L=1200 mm	EV1	146211
for TSA 160 NT Z, with deeper guide, incl. lever and end caps	acc. to RAL	146215
GC GR for GC 338 L=1500 mm	EV1	149953
For EMD-F-IS DIN left, transom installation opposite hinge side, with deeper guide, incl. lever and end caps	acc. to RAL	149957
GC GR for GC 338 L=1500 mm	EV1	149959
For EMD-F-IS DIN right, transom installation opposite hinge side, with deeper guide, incl. lever and end caps	acc. to RAL	149963
GC GR for GC 338 L=1500 mm	EV1	146206
for EMD/EMD-F, with deeper guide, incl. lever and end caps	acc. to RAL	146210
GC GR for GC 338 L=1500 mm	EV1	146218
for TSA 160 NT, with deeper guide, incl. lever and end caps	acc. to RAL	146222
GC GR for GC 338 L=1500 mm	EV1	146212
for TSA 160 NT Z, with deeper guide, incl. lever and end caps	acc. to RAL	146216
GC 338 pair of end caps	black	142226
GC 338 receiver module		143071
GC 338 interface set comprising interface module, corrugated hose and door connection cable (5 m)		149098
GC 338 interface module		143072
GC 338 cable set comprising flat ribbon connecting cable 2 m with 5 connectors and connection cable hinge side/opposite hinge side		149237
GC 338 transmitter module		143060
GC 335 / GC 338 sensor cut-out profile L=6000 mm	EV1	079581
	mill finish	079584
GC 335 / GC 338 sensor window profile L=4000 mm		118856
GC 335 sensor cut-out profile, cut-to-size	EV1	100269
GC 335 / GC 338, weather hood L=1200 mm		142227
GC 335 / GC 338, weather hood L=1500 mm		142232
Pair of end caps GC GR for GC 335/338	black	146223

## GEZE GC 335 sensor strip

### Sensor strip for the protection of automatic swing and revolving doors in accordance with DIN 18650 / EN 16005

GEZE GC 335 serves to protect automatic swing and revolving doors in accordance with DIN 18650 / EN 16005. The click fitting in the sensor mounting profile reduces installation efforts. The inclination angle and detection range can be adjusted mechanically. Continuous self-monitoring means GEZE GC 335 fulfills the highest safety standards and is thus approved for use for emergency exits. The simple design offers a cost-optimised solution.

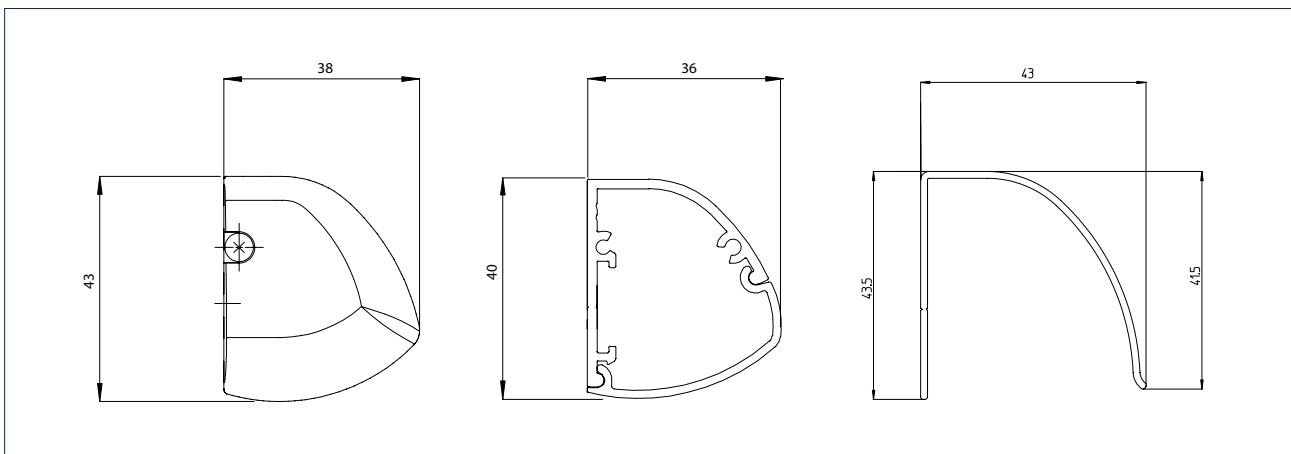

#### Area of application

- Protection of swing and revolving doors in accordance with DIN 18650 / EN 16005

Product features	GEZE GC 335
Technology	Active infrared beams
Operating voltage	24 V DC
Operating current	75 mA (master module), 65 mA (slave module) at 24 V DC
Output	Potential-free relay output, 30 V AC/DC, 0.3 A AC/0.3 A DC
Connection type	Push-fit screw terminal
Height	42 mm
Depth	37 mm
Dimensions	Sensor strip: 310/900/1400 (can be cut to size) x 42 x 37 mm (W x H x D), Sensor module: 179 x 23 x 33 mm (W x H x D)
Installation height (min.)	1500 mm
Installation height (max.)	2500 mm
Connection cable	1000 mm
Reaction time	< 70 ms
IP rating	IP52
Operating temperature	-10 – 50 °C
Humidity	< 90 % relative, non-condensing
Approvals	DIN 18650, EN 16005



# GEZE PRESENCE DETECTORS

## Detection area and application example

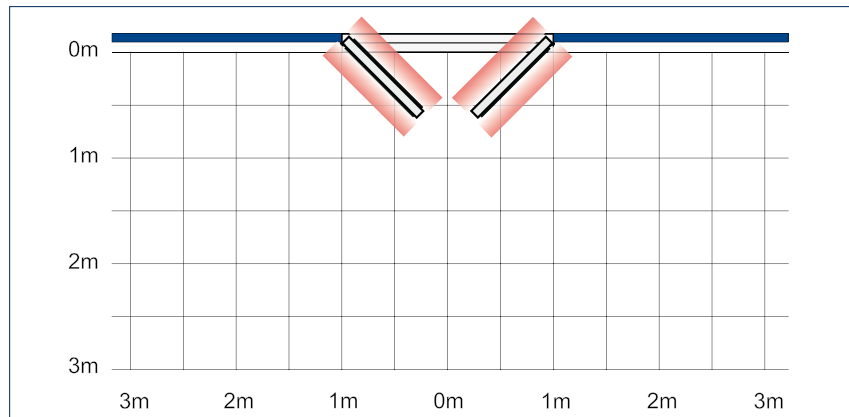

0.08 x 0.03 m per sensor module

Given values measured at installation height 2.2 m

### Number of modules (Master + Slave) per sensor strip

Door leaf width	0.8 m	0.9 m	1.0 m	1.1 m	1.2 m	1.3 m	1.4 m
Installation height 2.2 m	1+2	1+3		1+4		1+5	

### GEZE GC 335 - Order information

Description	Version	ID no.
GC 335 sensor strip L=310 mm	EV1	129856
Protection of the swivelling range of automatic swing and revolving doors in accordance with DIN 18650 / EN 16005	acc. to RAL	129859
GC 335 sensor strip L=900 mm	EV1	128054
Protection of the swivelling range of automatic swing and revolving doors in accordance with DIN 18650 / EN 16005	acc. to RAL	128057
GC 335 sensor strip L=1400 mm	EV1	128058
Protection of the swivelling range of automatic swing and revolving doors in accordance with DIN 18650 / EN 16005	acc. to RAL	128071
<b>Accessories</b>		
Adapter for sensor link arm	EV1	144352
For Powerturn, EMD / EMD-F and TSA 160 NT	acc. to RAL	153126
GC 335 extension kit		128072
With one slave module, connection cable and clip bearings		
GC 335 master module		128074
GC 335 end cap, left	black	071094
GC 335 end cap, right	black	071851
GC 335 clip bearing	black	126471
GC 335 slave module		128065
GC 335 connection cable	black	120085
GC 335 / GC 338 sensor cut-out profile, cut-to-size	EV1	100269
GC 335 / GC 338 sensor cut-out profile L=6000 mm	EV1	079581
	mill finish	079584
GC 335 / GC 338 sensor window profile L=4000 mm		118856
GEZE infrared detector		112321
Device for determining the position of infrared curtains		
Door transmission cable for GC 335		057182
8-wire		
Door transmission hose for sensor		025901
Length 300 mm		
GC 335 screws for sensor strip		081168
GC 335 screws and cable		081169

## GEZE GC 341 active infrared light curtain

**Self-monitored light curtain for the protection and activation automatic sliding doors, suitable for GC 365**

The GEZE GC 341 active infrared light curtain serves to protect single and double-leaf linear sliding doors in compliance with DIN 18650 and EN 16005. The sensor is intended for inside and outside use and has an invisible and non-contact protective device. It guarantees reliable detection even when mounted at a height of 3500 mm.

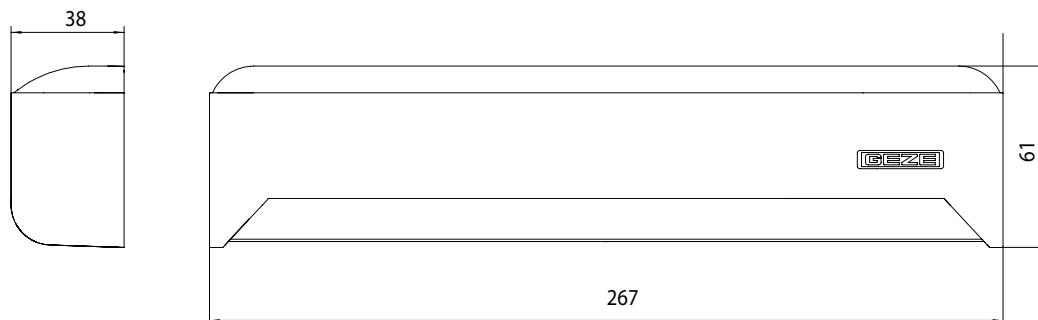

### Area of application

- Protection of automatic sliding doors
- Use in hazardous areas on the secondary closing edge without protective door leaf

# GEZE PRESENCE DETECTORS

## Technical data

Product features	GEZE GC 341
Technology	Active infrared beams
Operating voltage	12-30 V DC / 12-24 V AC
Operating current	approx. 100 mA
Output	Electric relay, 50 V DC max. switching voltage, 100 mA max. output current
Connection type	System plug-type connector
Height	61 mm
Width	267 mm
Depth	38 mm
Installation height (min.)	2000 mm
Installation height (max.)	3500 mm
Connection cable	3000 mm
Weight	245 g
IP rating	IP54
Operating temperature	-20 - 55 °C
Humidity	< 80 % relative, non-condensing
Approvals	DIN 18650, EN 16005

## Detection area and application example

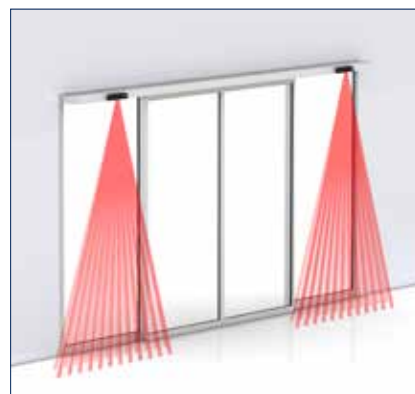
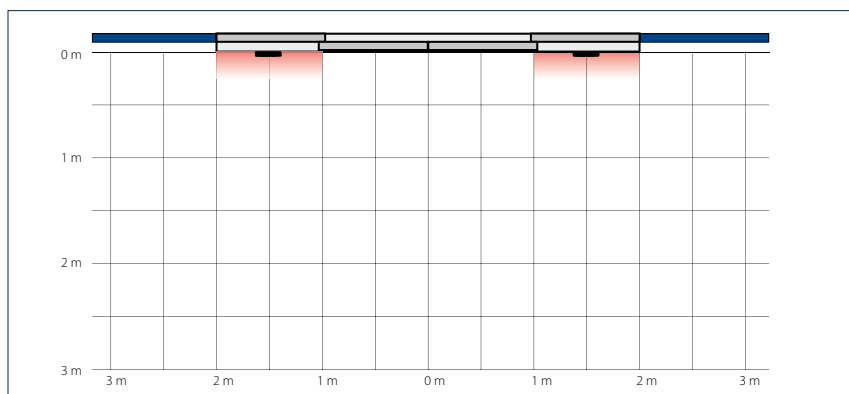

**Active infrared light curtain** Narrow field: 1.12 x 0.25 m, wide field: 2.65 x 0.25 m

Given values measured at installation height 2.2 m

4 light curtain configurations can be set without additional light prisms

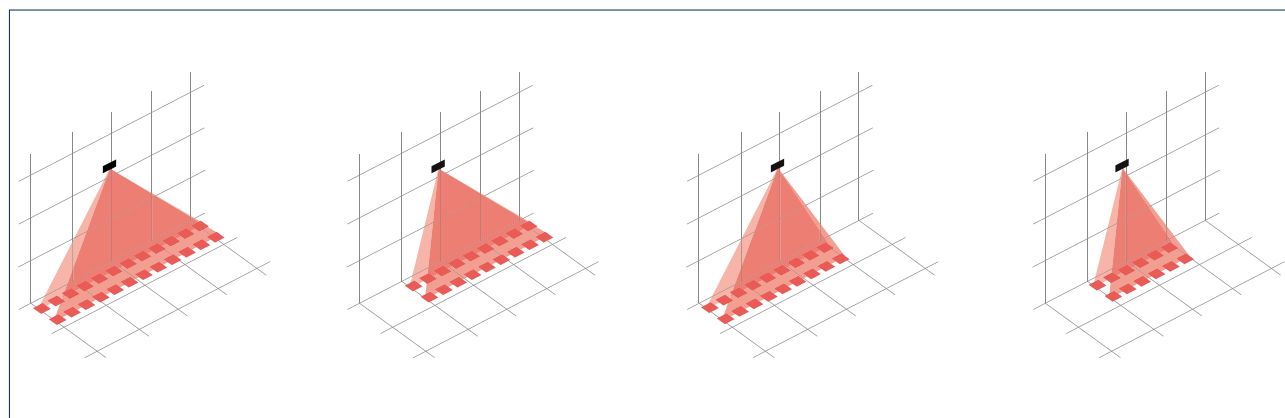

**Dimensional drawings for accessories**

Ceiling installation kit for GC 365 / GC 341

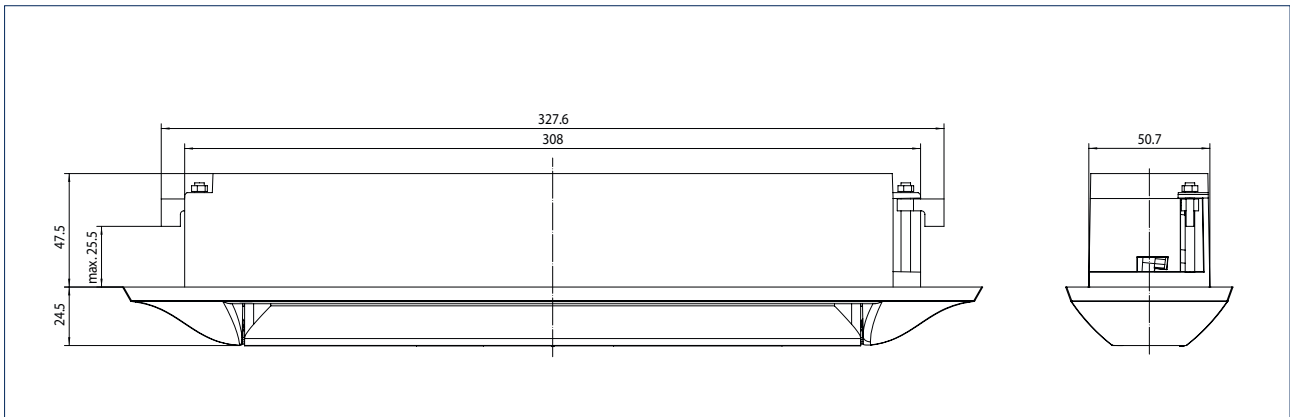

Ceiling bracket for GC 365 / GC 341

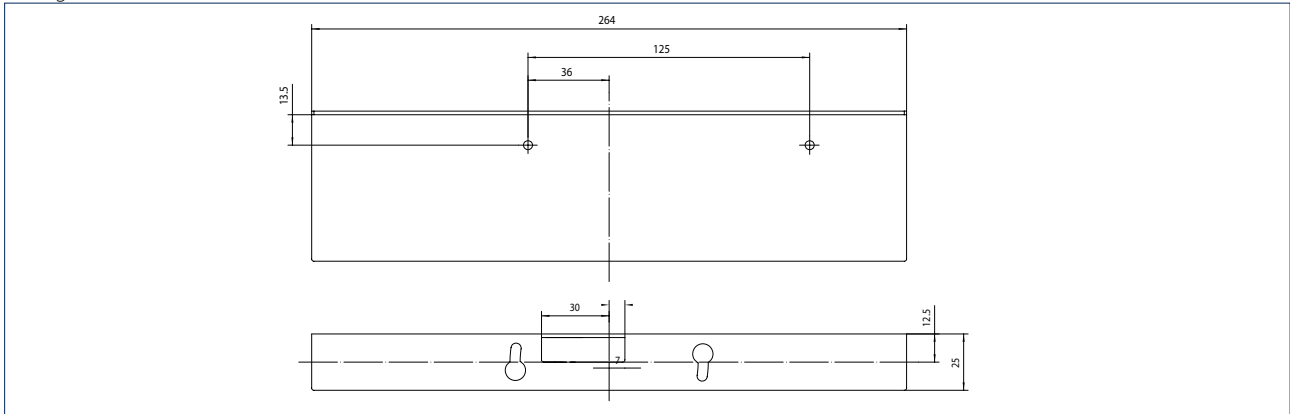

Weather hood for GC 365 / GC 341

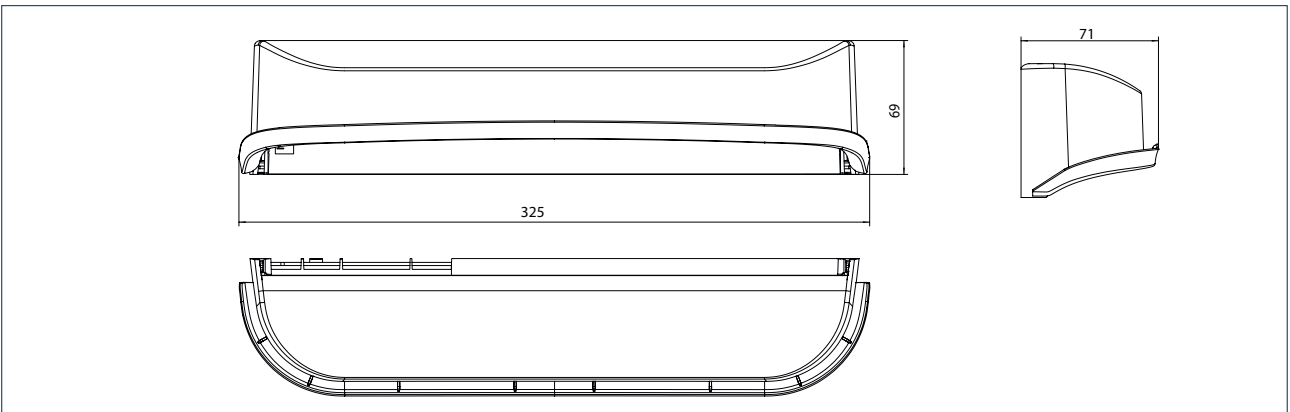
**GEZE GC 341 - Order information**

Description	Version	ID no.
GEZE GC 341 Self-monitored light curtain for the protection of doors		160285
<b>Accessories</b>		
Ceiling bracket GC 365 / GC 341	black	160286
Weather hood for GC 365 / GC 341 Protection against rainfall in the outdoor area	black	160287
Ceiling installation kit GC 365 / GC 341 Installation kit for integrating the detector into the ceiling	black	160288
GEZE infrared detector Device for determining the position of infrared curtains		112321

### GEZE GC 339 active infrared light curtain

#### Self-monitored light curtain for the protection of automatic doors, suitable for GEZE GC 363

GEZE GC 339 can be used as a safety sensor on automatic sliding, folding, revolving and curved sliding doors. It meets all demands of DIN 18650 and EN 16005. The sensor can be used on inside and outside areas. As a safety sensor on automatic doors without protective door leaf it guarantees safety in hazardous areas of the secondary closing edge. Light curtains have an invisible and non-contact protective device. Precise detection is possible through a clearly defined field, the size of which can be adjusted. Installation, configuration and design correspond to the GEZE GC 363 combined detector.

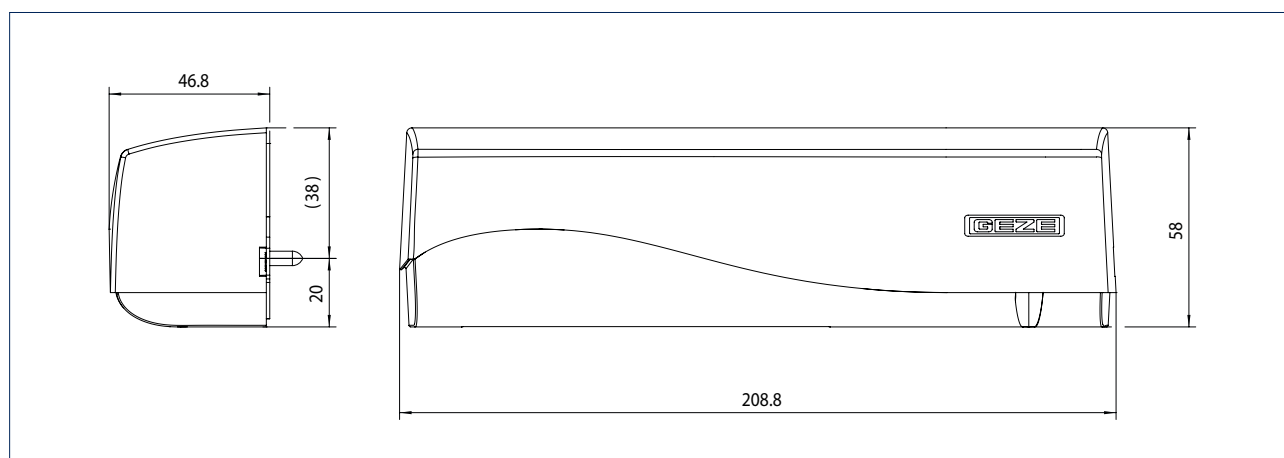

#### Area of application

- Protection and activation of automatic sliding, folding, revolving and curved sliding doors
- Use in hazardous areas on the secondary closing edge without protective leaf
- Pavements and passages, so that passing persons do not trigger an opening impulse
- Protection of revolving sliding doors in accordance with EN 16005

**Technical data**

Product features	GEZE GC 339
Technology	Active infrared beams
Operating voltage	12-24 V DC/AC
Operating current	approx. 125 mA at 24 V DC
Output	Electric relay, 42 V DC max. switching voltage, 100 mA max. switching current
Connection type	System plug-type connector
Height	58 mm
Width	209 mm
Depth	47 mm
Installation height (min.)	2000 mm
Installation height (max.)	3500 mm
Connection cable	2600 mm
Weight	250 g
IP rating	IP54
Operating temperature	-25 – 55 °C
Humidity	0-95 % relative, non-condensing
Approvals	DIN 18650, EN 16005

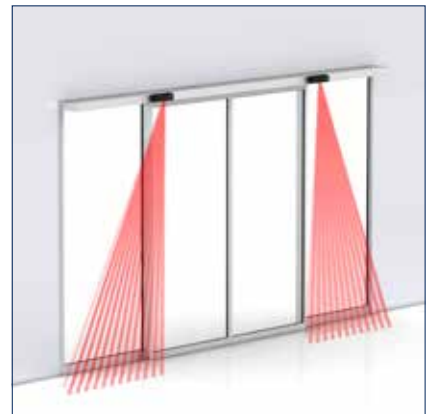
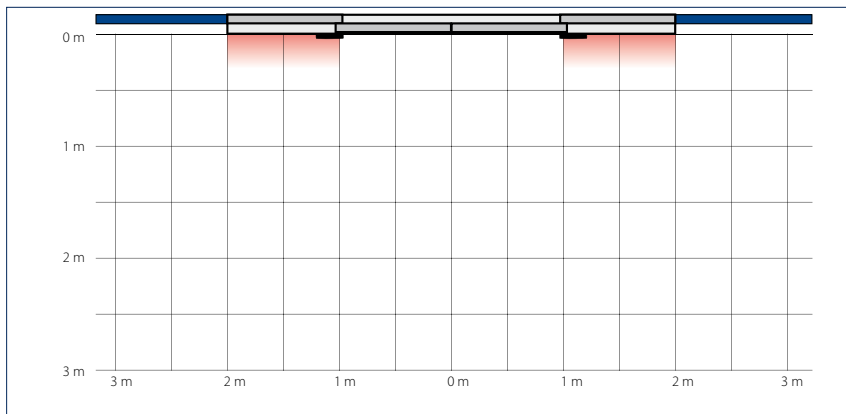
**Detection area and application example**

**Active infrared light curtain** Narrow field: 0.36 x 0.35 m, wide field: 2.2 x 0.35 m (W x D)

Given values measured at installation height 2.2 m

10 light curtain configurations can be set without additional light prisms

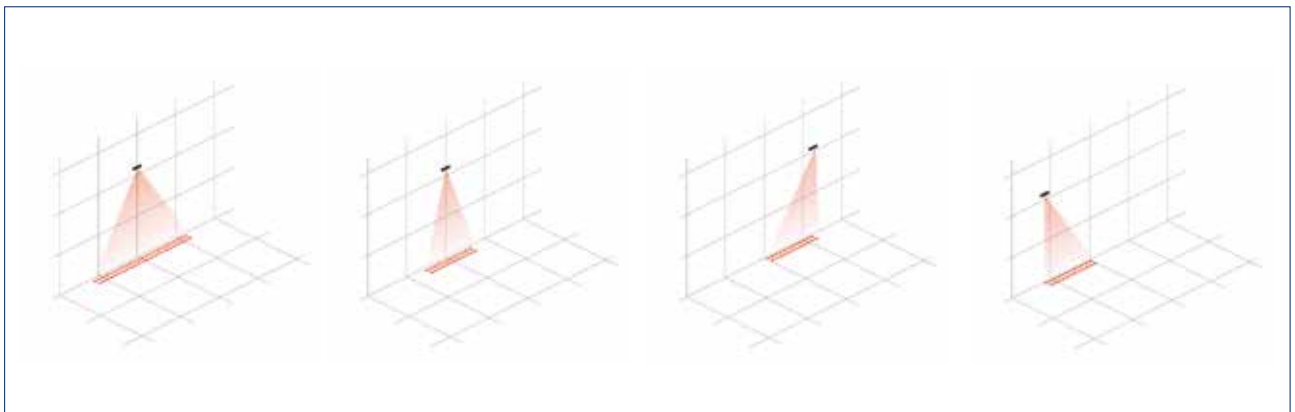

Dimensional drawings for accessories

Ceiling installation kit for GC 339

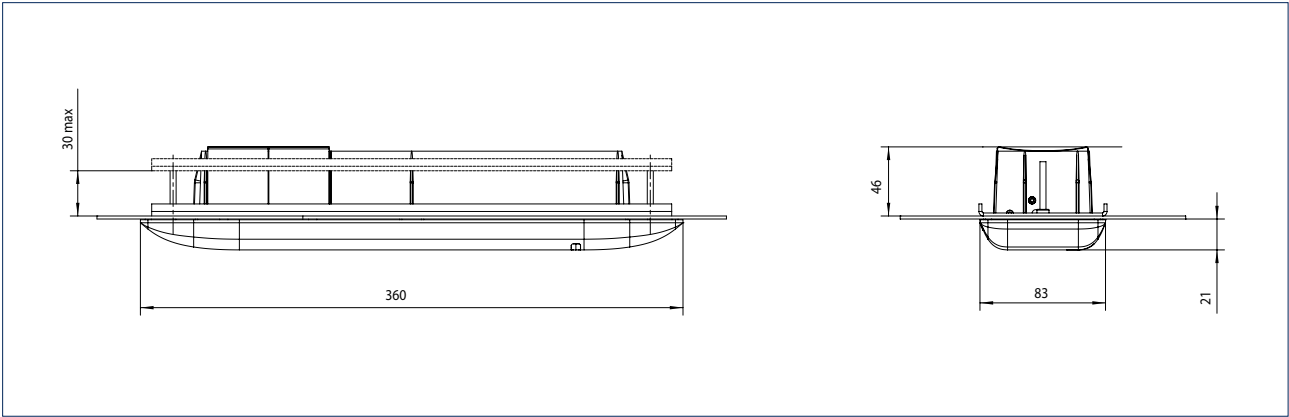

Ceiling bracket for GC 339

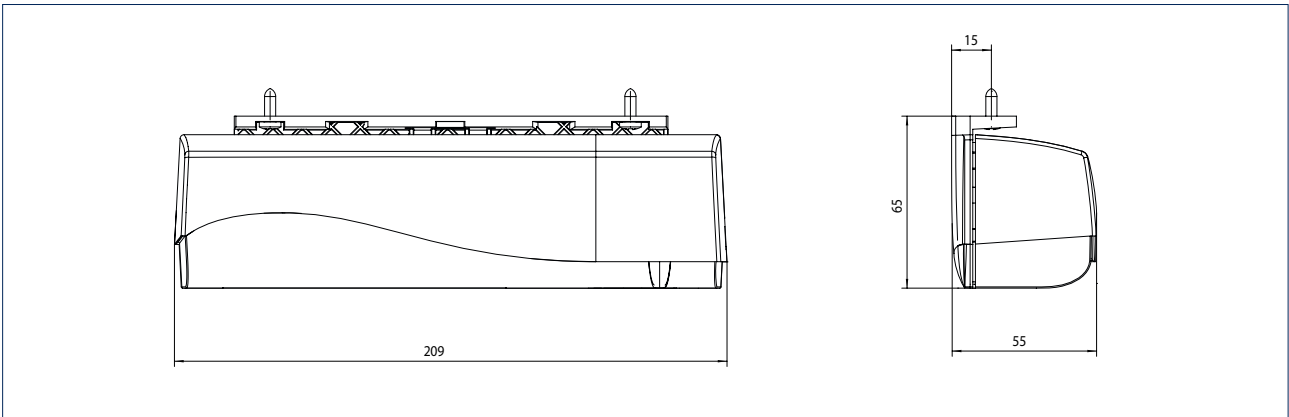

Rain cover for GC 339

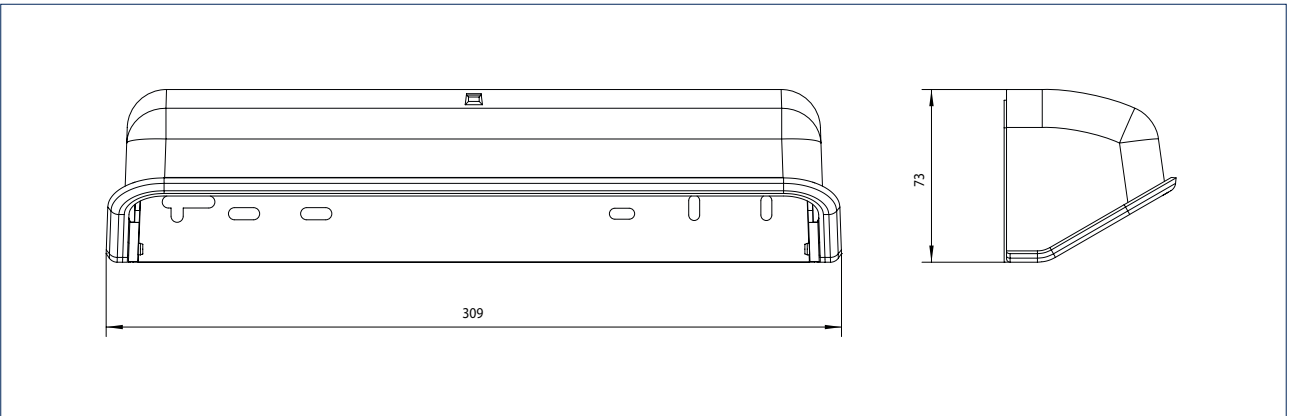

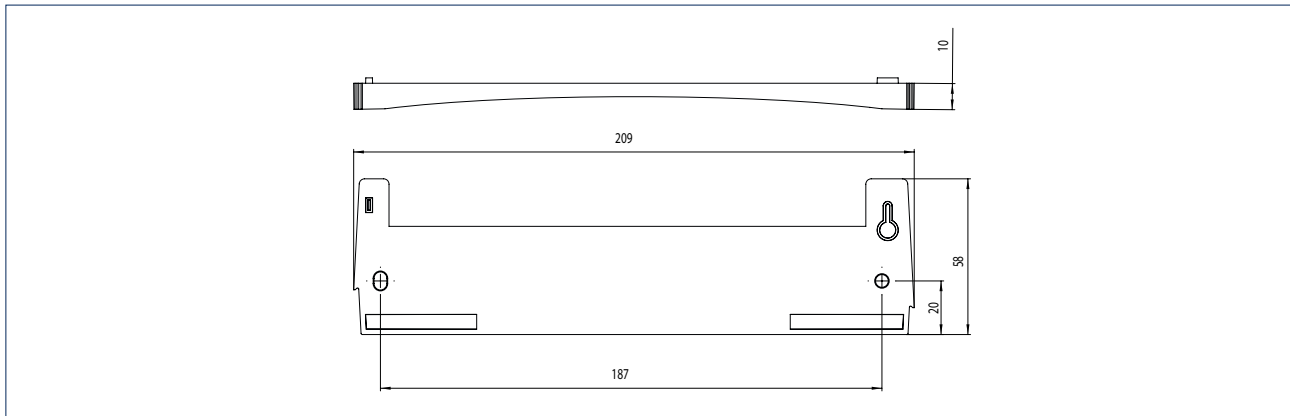

Curved adaptor for GC 339

**GEZE GC 339 - Order information**

Description	Version	ID.No.
GEZE GC 339	black	151251
Self-monitored light curtain for protecting automatic doors, suitable for GEZE GC 363	acc. to RAL	151252
<b>Accessories</b>		
Ceiling bracket GC 339	black	153568
Ceiling installation kit GC 363 / GC 339	white	151254
Installation kit for integrating the sensor into the ceiling	black	151253
Curved adaptor for GC 339		151540
Weather hood for GC 363, GC 339	transparent	126830
Remote control GC 363, GC 339, GC 304	black	100061
Setting and parameter setting of GC 363, GC 339 and GC 304. Compatible with GC 362, GC 333, GC 333 C and ACTIV S GE		
GEZE spot finder		112321
Device for determining the position of infrared curtains		

### GEZE GC 333 C active infrared light curtain

#### Self-monitored light curtain for the protection of the leading mullion of automatic revolving sliding doors

GEZE GC 333 C serves to protect the leading mullion of revolving sliding doors in accordance with DIN 18650. The sensor can be used on inside and outside areas and has an invisible and non-contact protective device. Precise detection is possible through a clearly defined field, the size of which can be adjusted.

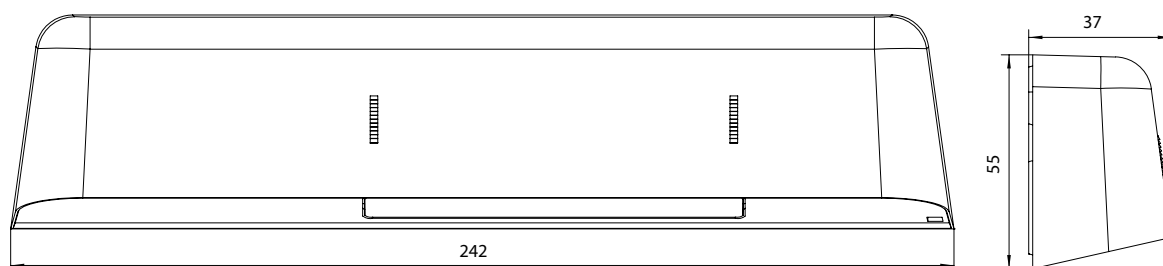

#### Area of application

- Protection of revolving sliding doors in accordance with DIN 18650
- Use in hazardous areas of revolving doors for the protection of the leading mullion

## GEZE PRESENCE DETECTORS

## Technical data

Product features	GEZE GC 333 C
Technology	Active infrared beams
Operating voltage	12-24 V DC/AC
Operating current	approx. 125 mA at 24 V DC
Output	Electric relay, 42 V DC max. switching voltage, 100 mA max. switching current
Height	55 mm
Width	242 mm
Depth	37 mm
Installation height (min.)	1800 mm
Installation height (max.)	2700 mm
Connection cable	2500 mm
Weight	250 g
IP rating	IP54
Operating temperature	-25 – 55 °C
Humidity	< 90 % relative, non-condensing
Approvals	CE according to EMC Directive 89/336 EEC

## Detection area and application example

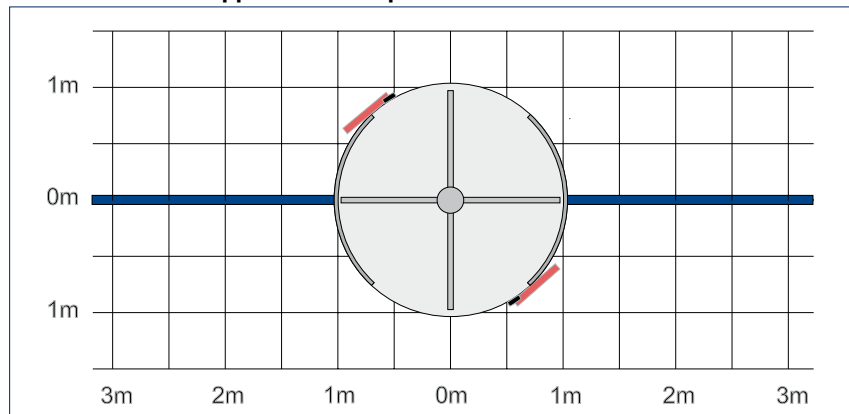

## Dimensional drawings for accessories

Curved adaptor for GC 333 C

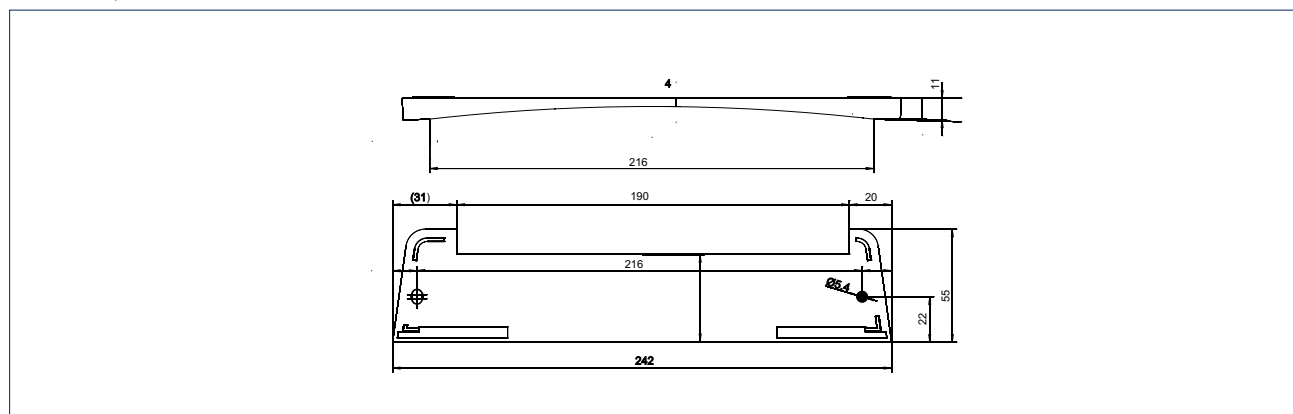

## GEZE GC 333 C - Order information

Description	Version	ID.No.
GEZE GC 333 C Self-monitored light curtain for the protection and activation of automatic doors	black	127093
<b>Accessories</b>		
GEZE infrared detector Device for determining the position of infrared curtains		112321
Remote control GC 363, GC 339, GC 304 Setting and parameter setting of GC 363, GC 339 and GC 304. Compatible with GC 362, GC 333, GC 333 C and ACTIV S GE	black	100061
Curved adaptor for GC 333 C		136404

## GEZE PRESENCE DETECTORS

### GEZE GZ 470 V / GZ 472 V safety photoelectric barrier

#### Safety photoelectric barriers as single and double beam version for automatic sliding doors

GEZE GZ 470 V, the photoelectric barrier with single beam, and GEZE GZ 472 V, the photoelectric barrier with double beam, provide simple and reliable protection for automatic sliding doors. The maximum range of these sensors is 5 m. The compact design makes flexible installation in a range of different door profiles possible. Attachment using double-sided adhesive tape is easy and straightforward. The integrated electronics guarantee fast installation and compact space requirements.



#### Area of application

- Protection of automatic sliding doors

#### Technical data

Product features	GEZE GZ 470 V / GZ 472 V
Technology	Active infrared beams
Number of IR	GZ 470 V: 1 channel GZ 472 V: 2 channels
Operating voltage	11-30 V
Operating current	GZ 470 V: approx. 40 mA at 24 V DC GZ 472 V: approx. 80 mA at 24 V DC
Output	PNP transistor output, < 30 V DC, < 100 mA
Connection type	Cable prepared for connection to screw terminal
Height	11.6 mm
Width	85 mm
Depth	11.5 mm
Installation height	GZ 470 V: min. 200 mm GZ 472 V: 200 and 1000 mm
Connection cable	8000 mm
Operating temperature	-20 – 60 °C
Humidity	< 90 % relative, non-condensing
Approvals	CE in accordance with EMV 2014/30/EU and EN 60947-5-2

### Detection area and application example

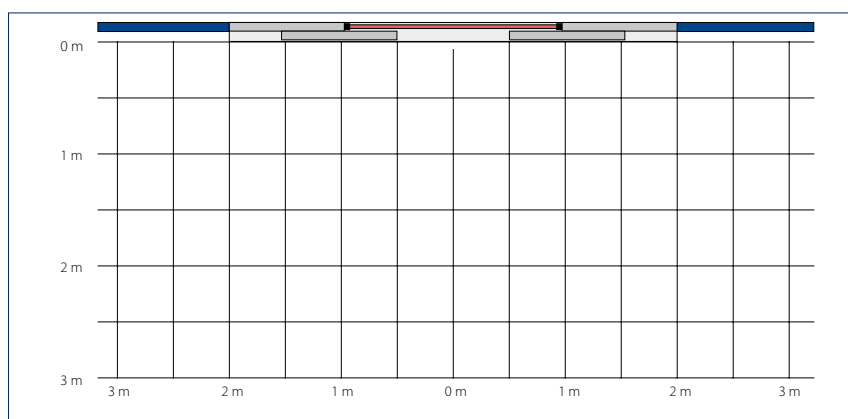

GEZE GZ 470 V



GEZE GZ 472 V



Recommended installation:  
Beam height at least 20 cm above the ground  
Maximum 5 m reciprocal spacing

### GEZE GZ 470 V / GZ 472 V - Order information

Description	Version	ID.No.
GZ 470 V, single channel light barrier Protection of automatic sliding doors with one transmitter and receiver	black	112726
GZ 472 V, two-channel light barrier Protection of automatic sliding doors with 2 transmitters and receivers	black	112727
<b>Accessories</b>		
Cover panel for light barrier	EV1	065312
	dark bronze	068739
	mill finish	068738
	acc. to RAL	099988

## GEZE COMBINED DETECTORS

### GEZE GC 365 combined detector

#### Combined detector for the activation and protection of automatic sliding doors

Combined detectors are radar movement detectors using an infrared light curtain. The new GEZE combined detector GC 365 fulfils the demands for the activation and protection of linear single and double-leaf sliding doors in accordance with DIN 18650 and EN 16005. It guarantees reliable detection even when mounted at a height of 3500 mm. Fewer sensors are necessary thanks to the large field width on the floor. The so-called „lookback curtain“, a third presence sensor, checks whether there is anyone present between the door leaves and thus increases safety in the closing section. The sensor does not have a graphic display for parameter setting or fault analysis and is thus a low-cost alternative. Installation and parameter setting are possible without installation instructions thanks to compact instructions on the sensor. Commissioning is carried out by simply removing the cover. The sensor can be used inside and outside.

#### Special version

GC 365 SF: offers maximum safety thanks to integrated self-monitoring function, and is thus approved for use on emergency exits.

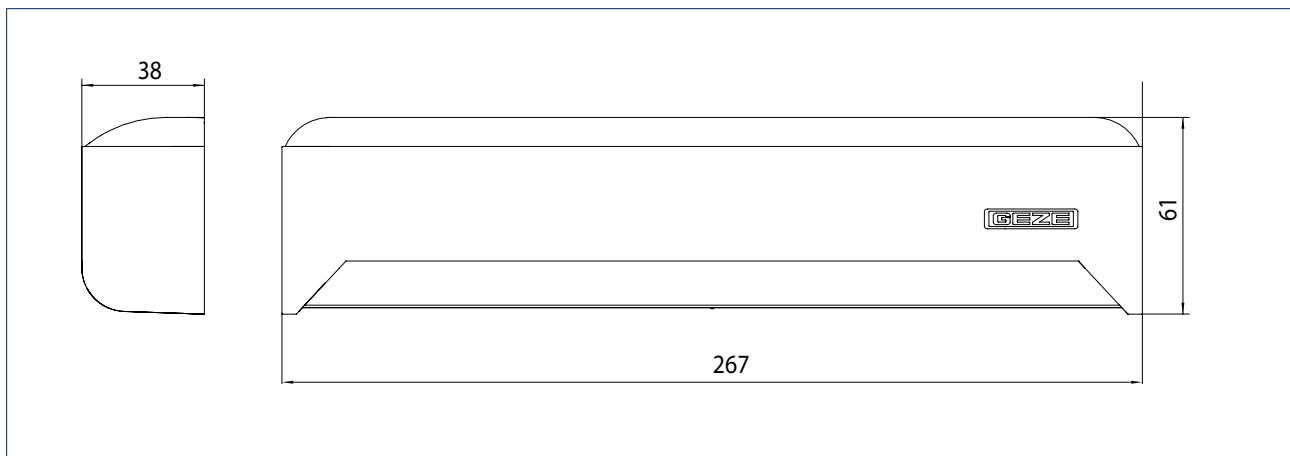

#### Area of application

- Activation and protection of automatic sliding doors
- Version SF: for use in emergency exits

## Technical data

Product features	GEZE GC 365
Technology	Electromagnetic radar waves/active infrared beams
Operating voltage	12-30 V DC / 12-24 V AC
Operating current	approx. 100 mA
Output	Radar GC 365 R: relay (potential-free contact), 50 V DC max. switching voltage, 300 mA max. output current Radar GC 365 SF: transistor (opto-coupler, potential-free), 50 V DC max. switching voltage, 300 mA max. output current Light curtain: electric relay, 50 V DC max. switching voltage, 100 mA max. output current
Connection type	System plug-type connector
Height	61 mm
Width	267 mm
Depth	38 mm
Installation height (min.)	2000 mm
Installation height (max.)	3500 mm
Connection cable	3000 mm
Weight	270 g
IP rating	IP54
Operating temperature	-20 - 55 °C
Humidity	0-80 % relative, non-condensing
Approvals	DIN 18650, EN 16005

## Detection area and application example

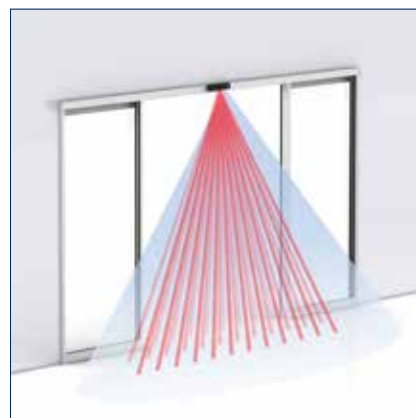
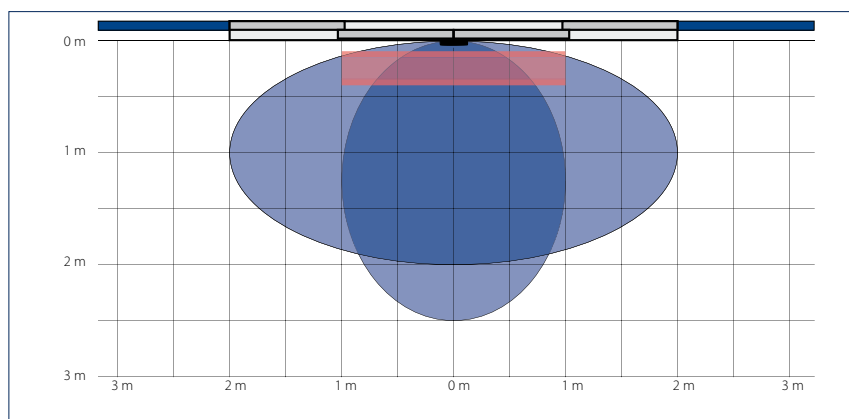

**Radar field** Narrow field (1): 2.0 x 2.5 m (B x T), wide field (2): 4.0 x 2.0 m (B x T)

**Active infrared light curtain** Narrow field: 1.12 x 0.25 m, wide field: 2.65 x 0.25 m

Given values measured at installation height 2.2 m

4 light curtain configurations can be set without additional light prisms

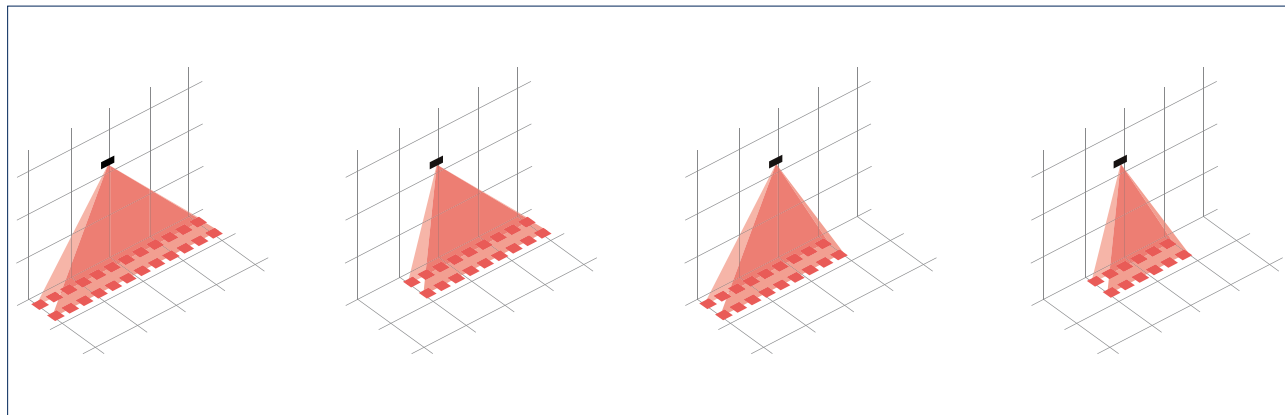

## GEZE COMBINED DETECTORS

## Dimensional drawings for accessories

Ceiling installation kit for GC 365 / GC 341

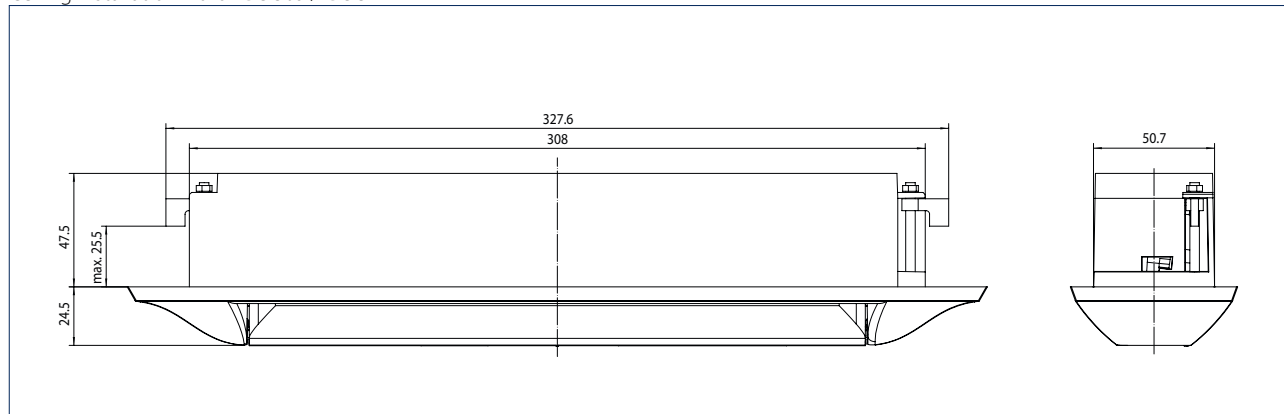

Ceiling bracket for GC 365 / GC 341

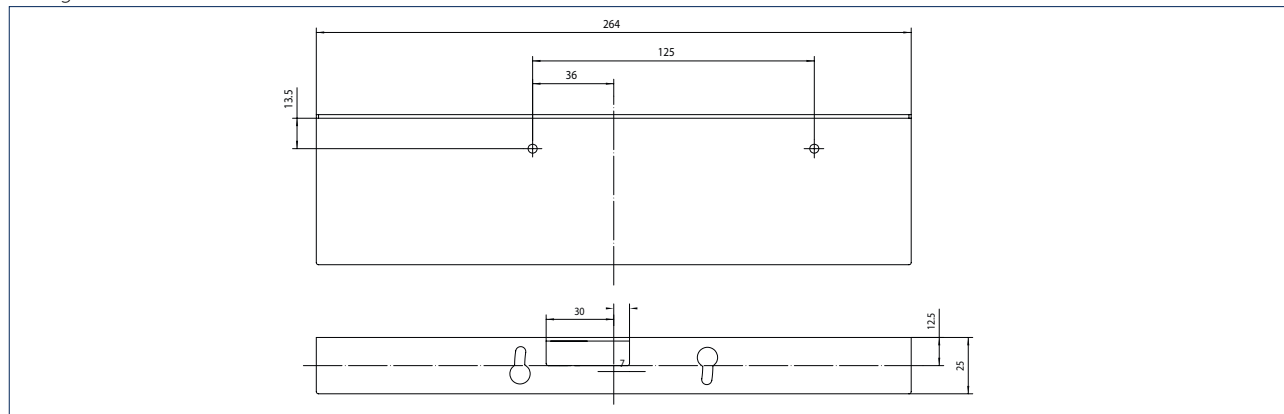

Weather hood for GC 365 / GC 341

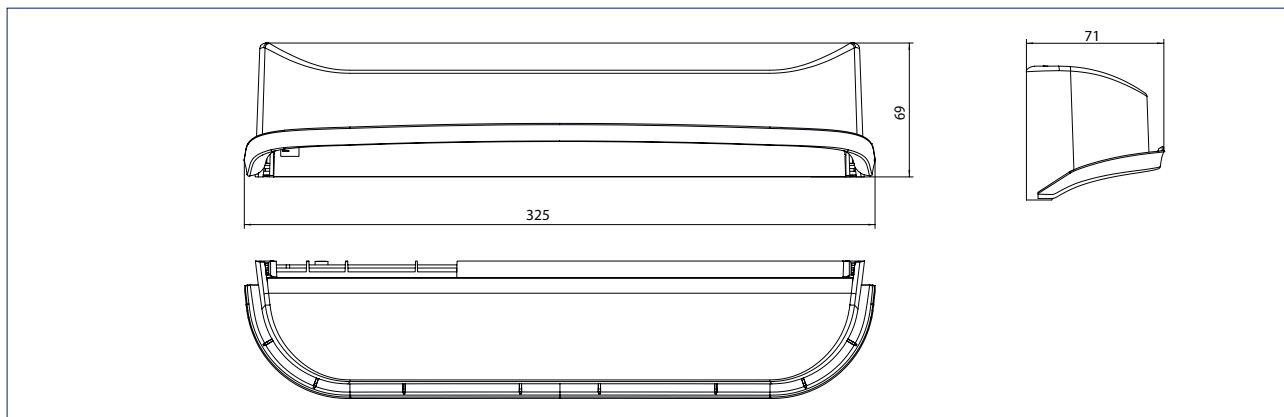

Description	Version	ID no.
GC 365 R combined detector Combined detector for the activation and protection of automatic sliding doors	black	160283
GC 365 SF combined detector Combined detector for the activation and protection of automatic sliding doors	black	160284
<b>Accessories</b>		
Ceiling bracket GC 365 / GC 341	black	160286
Weather hood for GC 365 / GC 341, Protection against rainfall in the outdoor area	black	160287
Ceiling installation kit GC 365 / GC 341 Installation kit for integrating the sensor into the ceiling	black	160288
GEZE spot finder, device for determining the position of infrared curtains		112321



## GEZE GC 363 combined detector

### Combined detector for the activation and protection of automatic sliding doors

Combined detectors are radar movement detectors using an infrared light curtain. GEZE GC 363 fulfils the demands for the activation and protection of automatic sliding doors in accordance with DIN 18650 and EN 16005. The sensor can be used inside and outside. It guarantees reliable detection with direction detection even in sensitive environments e.g. with reflective floors and HF lamps. The field size and immunity parameters can be used to set up cross-traffic fade-out to prevent doors opening unintentionally in narrow shopping arcades. Installation effort is reduced thanks to the combination of activation and protection in one device. Individual attachment possibilities through wall, ceiling or integrated ceiling recess installation provide lots of design freedom. The system is commissioned via remote control.

#### Special version

GC 363 SF: offers maximum security thanks to integrated self-monitoring, and is thus approved for use in emergency exits.



#### GEZE GC 363

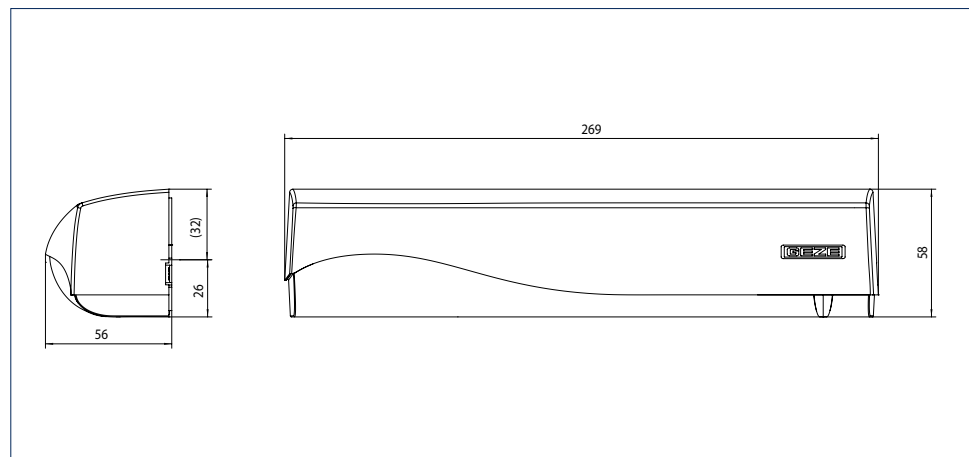

#### Area of application

- Activation and protection of automatic sliding doors
- Version SF: for use in emergency exits

# GEZE COMBINED DETECTORS

## Technical data

Product features	GEZE GC 363
Technology	Electromagnetic radar waves/active infrared beams
Operating voltage	12-24 V DC/AC
Operating current	approx. 125 mA at 24 V DC
Output	Radar GC 363 R: relay (potential-free contact), 42 V DC max. switching voltage, 1 A max. output current Radar GC 363 SF: transistor (opto-coupler, potential-free), 42 V DC max. switching voltage, 100 mA max. output current Light curtain: electric relay, 42 V DC max. switching voltage, 100 mA max. output current
Connection type	System plug-type connector
Height	58 mm
Width	270 mm
Depth	58 mm
Installation height (min.)	2000 mm
Installation height (max.)	3500 mm
Connection cable	2600 mm
Weight	250 g
IP rating	IP54
Operating temperature	-25 – 55 °C
Humidity	0-95 % relative, non-condensing
Approvals	DIN 18650, EN 16005

## Detection area and application example

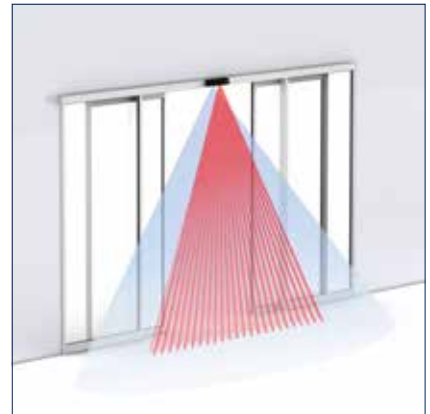
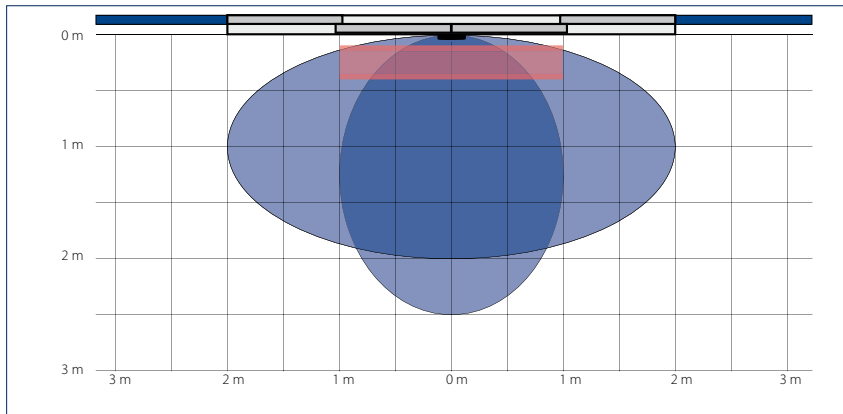

**Radar field** Narrow field (1): 2.0 x 2.5 m (W x D), wide field (2): 4.0 x 2.0 m (W x D)

**Active infrared light curtain** Narrow field: 0.36 x 0.35 m, wide field: 2.2 x 0.35 m (W x D)

Given values measured at installation height 2.2 m

10 light curtain configurations can be set without additional light prisms

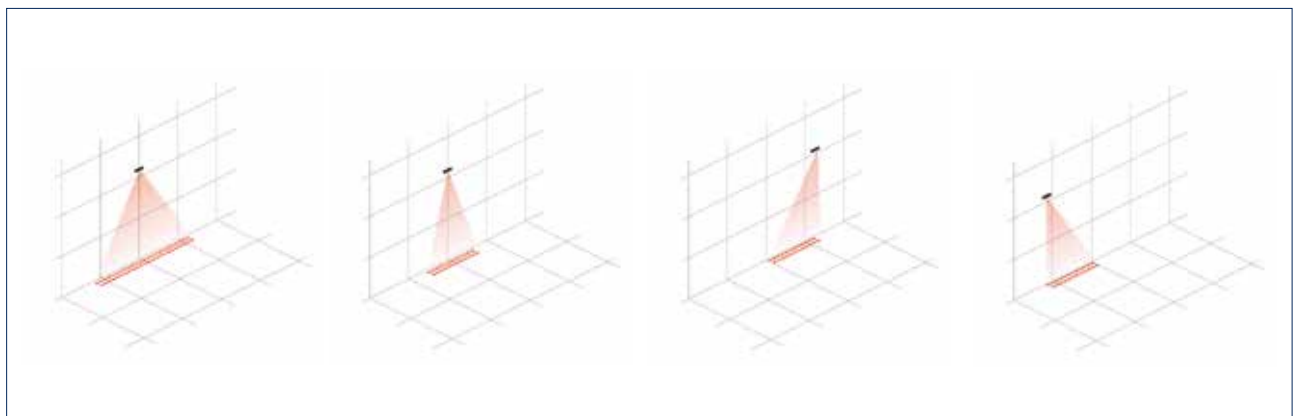

## Dimensional drawings for accessories

Ceiling installation kit for GC 363

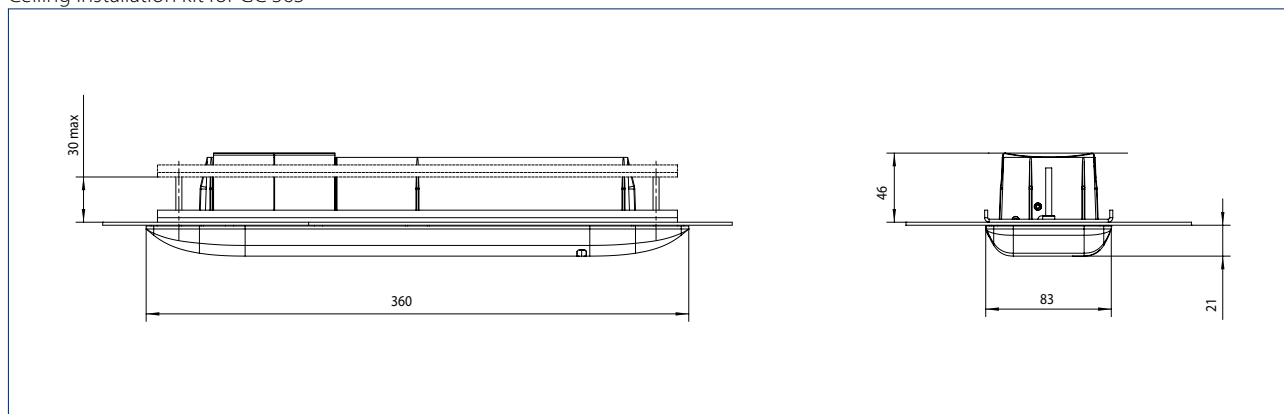

Ceiling bracket for GC 363

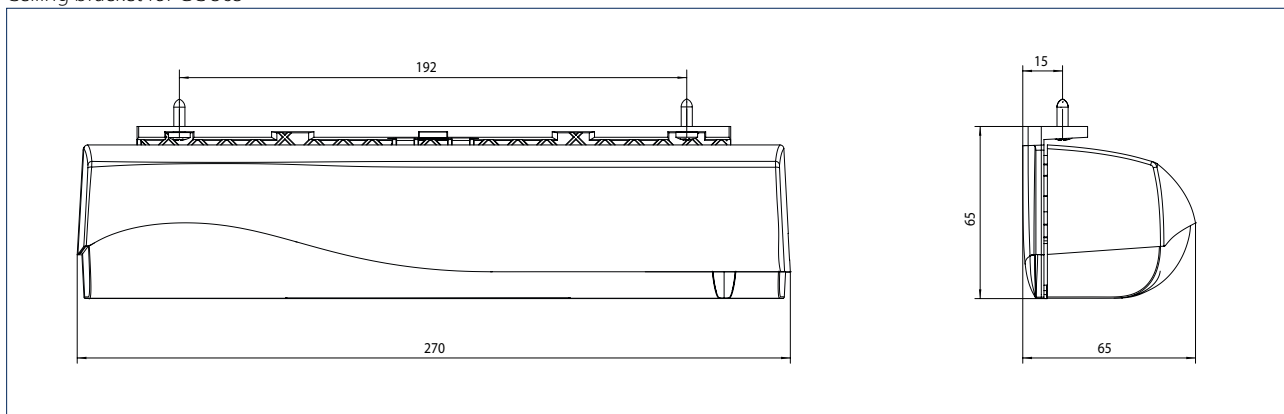

Weather hood for GC 363

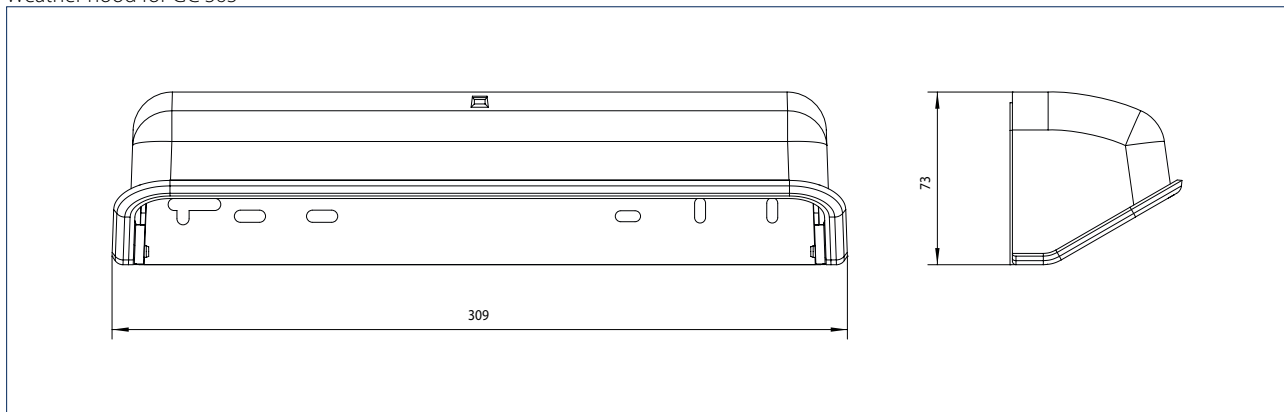

# GEZE COMBINED DETECTORS

Curved adaptor for GC 363

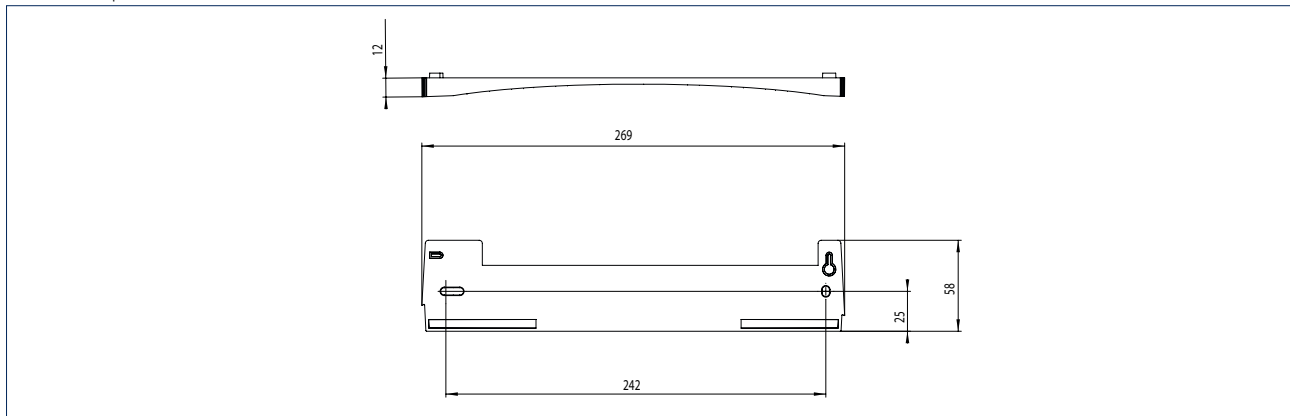

## GEZE GC 363 - Order information

Description	Version	ID.No.
GEZE GC 363 R combined detector Combined detector for the activation and protection of automatic sliding doors	black	151237
	acc. to RAL	151238
GEZE GC 363 SF combined detector Combined detector for the activation and protection of automatic sliding doors	black	151239
	acc. to RAL	151240
<b>Accessories</b>		
Ceiling bracket GC 363	black	151256
Ceiling installation kit GC 363 / GC 339 Installation kit for integrating the sensor into the ceiling	white	151254
	black	151253
Curved adaptor for GC 363		151255
Weather hood for GC 363, GC 339 Protection against rainfall in the outdoor area	black	158250
Remote control GC 363, GC 339, GC 304 Setting and parameter setting of GC 363, GC 339 and GC 304. Compatible with GC 362, GC 333, GC 333 C and ACTIV S GE	black	100061
GEZE spot finder Device for determining the position of infrared curtains		112321
Interface GC 363 S Interface for the series switching of several self-monitored GC 363 SF combined detectors for the variants FR-RWS, FR-LL and FR-DUO		151361

## GEZE programme switches

### Programme switches for selection of the operational state of automatic doors

GEZE offers programme switches for various individual requirements. The switches can be universally used - for surface and flush-mounting. The GEZE switch programme comprises display programme switches (DPS), keypad programme switches (TPS) and mechanical programme switches (MPS). Up to 5 different modes of operation can be set: Off, Night, Exit only, Automatic and Hold open. Key switches or switches with password protection are available for the authorised use in emergency exits.



Keypad programme switch (TPS)



Keypad programme switch with key switch (TPS-SCT)



Mechanical programme switch (MPS)



Mechanical programme switch with key (MPS-ST)



Mechanical program switch with rotary knob (MPS-D)



Mechanical programme switch with key (MPS-D-ST)



Display programme switch (DPS) with OFF button



Display programme switch with key switch (DPS-SCT) and OFF button

### Area of application

- For surface- and flush-mounting
- Compatible with: Jung AS 500, A plus, Gira: Standard 55, E2, Esprit, Event, stainless steel (with intermediate frame Gira 028920), Merten: M-Smart, M-Plan, Berker: B.1, B.7

## GEZE PROGRAMME SWITCHES

	TPS	TPS-SCT	MPS	MPS-ST	MPS-D	MPS-D-ST	DPS	DPS-SCT
<b>ECdrive</b> <b>Slimdrive SL</b> <b>Powerdrive</b>	•	•	•	•			•	•
<b>ECdrive-FR</b> <b>Slimdrive SL-FR</b> <b>Powerdrive FR</b>	•****	•		•			•****	•
<b>ECturn</b>	•	•						
<b>Slimdrive EMD / -F</b>	•	•	•	•	•	•	•	•
<b>TSA 160 NT / -F</b>	•**	•**	•	•	•	•	•**	•**
<b>TSA 150 / TSA 160</b>					•	•		
<b>Powerturn</b>			•	•	•	•	•	•
<b>TSA 325 NT</b>	•***	•***						
<b>Operation</b>	Push buttons	Push buttons + key	Rotary knob	Key	Rotary knob	Key	Push buttons	Push buttons + key
<b>Functionality</b>	Selection of mode of operation	Selection of mode of operation with authorisation	Selection of mode of operation	Selection of mode of operation with keyed alike key	Selection of mode of operation	Selection of mode of operation with keyed alike key	Parameter setting, commissi- oning and selection of the mode of operation	Parameter setting, commissi- oning and selection of the mode of operation with authorisation
<b>Error display</b>	via LED blink code	via LED blink code	via LED warning light	via LED warning light			via numerical code	via numerical code
<b>Version</b>	flush-/ surface- mounting*	flush-/ surface- mounting*	flush-/ surface- mounting*	flush-/ surface- mounting*	flush-/ surface- mounting*	flush-/ surface- mounting*	flush-/ surface- mounting*	flush-/ surface- mounting*
<b>IP rating</b>	IP40	IP40	IP40	IP40	IP40	IP40	IP40	IP40
<b>Dimensions (WxHxD)</b>	80 x 80 x 11 mm (flush- mounting) 80 x 80 x 47 mm (surface- mounting*)	80 x 152 x 11 mm (flush- mounting) 85 x 156 x 47 mm (surface- mounting*)	80 x 80 x 22 mm (flush- mounting) 80 x 80 x 58 mm (surface- mounting*)	80 x 80 x 18 mm (flush- mounting) 80 x 80 x 54 mm (surface- mounting*)	80 x 80 x 22 mm (flush- mounting) 80 x 80 x 58 mm (surface- mounting*)	80 x 80 x 18 mm (flush- mounting) 80 x 80 x 54 mm (surface- mounting*)	80 x 80 x 11 mm (flush- mounting) 80 x 80 x 47 mm (surface- mounting*)	80 x 152 x 11 mm (flush- mounting) 85 x 156 x 47 mm (surface- mounting*)
<b>Accessories</b>		Euro profile half cylinder ID no. 090176		Spare key, ID no. 137054		Spare key ID no.137055		Euro profile half cylinder ID no. 090176
<b>ID no.:</b>	113231	113232	113226	113227	118417	118418	151524 (with OFF key)	155810

\* For surface-mounting, please order surface-mounting box 120503 (single) or 128609 (double) for SCT versions separately.

\*\* Can be used from DCU5 with rev. B

\*\*\* Special version for revolving doors with "manual" operating state: TPS-KDT (ID no.: 126582), TPS-KDT-SCT (ID no.: 126583)

\*\*\*\* Can be used from DCU 1-2 M V 3.0 with password protection

## GEZE key switches

### Key switches for authorised opening of automatic doors

GEZE key switches are offered for a wide range of installations: wall, floor or ceiling installation. All key switches can be used for inside and outside areas.



Burglary-resistant key switch (1)



Burglary-resistant key switch (2)



Stainless steel key switch (1)



AS 500 plastic key switch



Stainless steel key switch (2)



Stainless steel key switch (3)



Main switch (1)



Main switch (2)

### Area of application

- Activation of automatic swing, sliding, folding, revolving and curved sliding doors
- Can be used for inside and outside areas as contact authorisation

## GEZE PROGRAMME SWITCHES

	Burglary-resistant key switch (1)	Burglary-resistant key switch (2)	Stainless steel key switch (2)	AS 500 plastic key switch
<b>Specification</b>	<ul style="list-style-type: none"> <li>1-pole closing contact</li> <li>Switching voltage: max. 230 V AC</li> <li>Switching current: max. 5 A</li> <li>One-sided switching operation</li> </ul>	<ul style="list-style-type: none"> <li>1-pole closing contact</li> <li>Switching voltage: max. 230 V AC</li> <li>Switching current: max. 5 A</li> <li>One-sided switching operation</li> </ul>	<ul style="list-style-type: none"> <li>1-pole closing contact</li> <li>Switching voltage: max. 230 V AC</li> <li>Switching current: max. 5 A</li> <li>One-sided switching operation</li> </ul>	<ul style="list-style-type: none"> <li>1-pole closing contact</li> <li>Switching voltage: max. 240 V AC</li> <li>Switching current: max. 4 A</li> <li>One-sided switching operation</li> </ul>
<b>Version</b>	flush-mounting (not for standard flush-mounting box)/surface-mounting	flush-mounting (not for standard flush-mounting box)/surface-mounting	flush-mounting	flush-mounting/surface-mounting*
<b>IP rating</b>	IP54	IP54	IP54	IP20
<b>Dimensions</b>	75 x 75 x 11 mm (flush-mounting) 75 x 75 x 50 mm (surface-mounting)	75 x 75 x 11 mm (flush-mounting) 75 x 75 x 50 mm (surface-mounting)	79 x 79 x 13 mm	80 x 80 x 11 mm
<b>Accessories</b>	<ul style="list-style-type: none"> <li>Euro profile cylinder, ID no. 090176</li> </ul>		<ul style="list-style-type: none"> <li>Euro profile cylinder, ID no. 090176</li> </ul>	<ul style="list-style-type: none"> <li>*Surface-mounted box, ID no. 120503</li> <li>Switching contact, ID no. 024467</li> <li>Profile cylinder, ID no. 090176</li> </ul>
<b>ID no.</b>	054240 (flush-mounting) 054532 (surface-mounting)	054245 (flush-mounting) 054533 (surface-mounting)	098870	117996

	Stainless steel key switch (2)	Stainless steel key switch (3)	Main switch (1)	Main switch (2)
<b>Specification</b>	<ul style="list-style-type: none"> <li>2-pole closing contact</li> <li>Switching voltage: max. 230 V AC</li> <li>Switching current: max. 5 A</li> <li>Latching, on both sides (key can be removed in position I)</li> </ul>	<ul style="list-style-type: none"> <li>2-pole closing contact</li> <li>Switching voltage: max. 230 V AC</li> <li>Switching current: max. 5 A</li> <li>Latching on both sides or spring return (key can be removed in position I)</li> </ul>	<ul style="list-style-type: none"> <li>Mains switch</li> <li>Switching voltage: max. 250 V AC</li> <li>Switching current: max. 16 A</li> <li>Key can be removed in position 1 and 0</li> </ul>	<ul style="list-style-type: none"> <li>Mains switch</li> <li>Switching voltage: max. 250 V AC</li> <li>Switching current: max. 16 A</li> <li>Key can be removed in position 1 and 0</li> </ul>
<b>Version</b>	flush-mounting	surface-mounting	flush-mounting	surface-mounting
<b>IP rating</b>	IP54	IP54	IP54	IP54
<b>Dimensions</b>	79 x 79 x 13 mm	75 x 74 x 66 mm	90 x 90 x 9 mm	90 x 121 x 72 mm
<b>Accessories</b>	<ul style="list-style-type: none"> <li>Euro profile cylinder, ID no. 090176</li> </ul>			
<b>ID no.</b>	111357	137056	018433	018354



## GEZE safety switches and buttons

**Safety switches and buttons used to deactivate the mains power and to enable emergency opening of automatic doors**

GEZE safety switches are equipped with a glass pane or a cover and thus offer protection against misuse. The switches are illuminated and can therefore be found easily even when it is dark.



Manual trigger switch



Emergency stop switch with glass pane



Manual trigger switch with glass pane



Emergency stop switch with palm button (1)



Emergency stop switch with palm button (2)



Emergency stop switch with palm button (3)



Main switch

### Area of application

- Protection of automatic swing, sliding, folding, revolving and curved sliding doors
- Use in emergencies for switching off the power supply
- Use in emergencies for opening automatic doors
- Use during maintenance work for switching off the power supply
- Use for hold-open systems for manual release of the hold-open mechanism

## GEZE PROGRAMME SWITCHES

	Manual trigger switch	Emergency stop switch with glass pane	Manual trigger switch with glass pane	Emergency stop switch with palm button (1)
<b>Specification</b>	<ul style="list-style-type: none"> <li>• 1-pole changeover contact</li> <li>• Switching voltage: max. 250 V AC</li> <li>• Switching current: approx. 10 A</li> <li>• incl. resistor</li> </ul>	<ul style="list-style-type: none"> <li>• 1-pole changeover contact</li> <li>• Switching voltage: max. 250 V AC</li> <li>• Switching current: max. 10 A</li> <li>• with glow lamp</li> </ul>	<ul style="list-style-type: none"> <li>• 1-pole changeover contact</li> <li>• Switching voltage: max. 250 V AC</li> <li>• Switching current: approx. 10 A</li> <li>• incl. resistor</li> </ul>	<ul style="list-style-type: none"> <li>• Contact system 1 opener / 1 closer</li> <li>• Switching voltage: max. 230 V AC</li> <li>• Switching current: max. 10 A</li> <li>• Lighting: 24 V DC at 15 mA</li> </ul>
<b>Version</b>	flush-mounting/surface-mounting*	flush-mounting/surface-mounting*	flush-mounting/surface-mounting*	flush-mounting
<b>IP rating</b>	IP40	IP20	IP20	IP40
<b>Dimensions</b>	80 x 80 x 9 mm	80 x 80 x 21 mm	80 x 80 x 21 mm	80 x 80 x 49 mm
<b>Accessories</b>	<ul style="list-style-type: none"> <li>• *Surface-mounted box, ID no.: 120503</li> </ul>	<ul style="list-style-type: none"> <li>• *Surface-mounted box, ID no.: 120503</li> <li>• Spare glass panel, ID no.: 010994</li> </ul>	<ul style="list-style-type: none"> <li>• *Surface-mounted box, ID no.: 120503</li> <li>• Spare glass panel, ID no.: 010994</li> </ul>	<ul style="list-style-type: none"> <li>• 2nd opening contact, ID no.: 100204</li> </ul>
<b>ID no.</b>	116266	120881	120880	123132

	Emergency stop switch with palm button (2)	Emergency stop switch with palm button (3)	Main switch
<b>Specification</b>	<ul style="list-style-type: none"> <li>• Contact system 1 opener / 1 closer</li> <li>• Switching voltage: max. 230 V AC</li> <li>• Switching current: max. 10 A</li> <li>• Lighting: 24 V DC at 15 mA</li> </ul>	<ul style="list-style-type: none"> <li>• Contact system 1 opener / 1 closer</li> <li>• Switching voltage: max. 230 V AC</li> <li>• Switching current: max. 10 A</li> <li>• Lighting: 24 V DC at 15 mA</li> </ul>	<ul style="list-style-type: none"> <li>• Contact system 3 closers</li> <li>• Switching voltage: max. 230 V AC</li> <li>• Switching current: max. 20 A</li> </ul>
<b>Version</b>	surface-mounting	surface-mounting	flush-mounting/surface-mounting
<b>IP rating</b>	IP65	IP30	IP54
<b>Dimensions</b>	94 x 94 x 122 mm	72 x 147 x 75.5 mm	90 x 90 x 9 mm (flush-mounting) 90 x 121 x 72 mm (surface-mounting)
<b>Accessories</b>	<ul style="list-style-type: none"> <li>• 2nd opening contact, ID no.: 100204</li> </ul>	<ul style="list-style-type: none"> <li>• 2nd opening contact, ID no.: 100204</li> </ul>	
<b>ID no.</b>	076777	024535	018433 (flush-mounting), 018354 (surface-mounting)

# GEZE SMOKE SWITCHES AND CONTROL UNITS

## GEZE RSZ 6 smoke switch control unit

### Smoke switch and power supply for all GEZE hold-open devices

The GEZE RSZ 6 smoke switch control unit in the typical GEZE design has an overall height of 30 mm. It is connected to the 230 V power supply system and supplies the connected hold-open devices reliably with 24 V DC voltage (max. 200 mA).

The smoke switch control unit is mounted on the vertical wall above the door opening, thus making the early detection of fire and smoke possible (please keep at least 20 mm clear of the ceiling). If an alarm is triggered, the voltage supply to the hold-open devices (e.g. electrical hold-open device in the guide rail or hold-open magnet) is interrupted and the doors close immediately. The connection of two additional ceiling-mounted detectors is possible depending on requirements. The integrated smoke switch has an automatic adaptation of the alarm threshold. This compensates light soiling of the smoke chamber and increases service life. The current state of the smoke switch is shown by an optical signal.

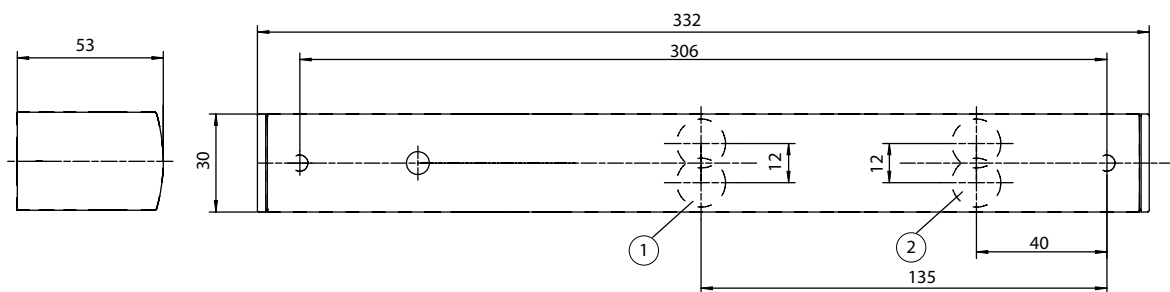

- 1 = Additional connections
- 2 = Power supply UP 230 V AC

### Area of application

- Approved for use with all GEZE hold-open devices

# GEZE SMOKE SWITCHES AND CONTROL UNITS

## GEZE smoke switch control unit RSZ 6 - Order information

Description	Version	ID no.
GEZE RSZ 6 smoke switch control unit Smoke switch and power supply for all GEZE hold-open devices	silver	099851
	dark bronze	099857
	white RAL 9016	099858
	simulated stainless steel <sup>1)</sup>	099856
	acc. to RAL <sup>2)</sup>	099859
GEZE RSZ 6 ECwire smoke switch control unit (set) Integrated smoke switch control unit ECwire for straightforward wiring using 2-wire technology, including 2 x ceiling smoke detectors type GC 162 (white)	silver	154976
	white RAL 9016	154979
	simulated stainless steel <sup>1)</sup>	154991
	acc. to RAL <sup>2)</sup>	154980
<b>Accessories</b>		
GEZE GC 152 smoke detector Complete with base, 24 V DC, 20 mA, tested in accordance with EN54-7, with general approval for use with all GEZE hold-open systems, integrated line monitoring, in accordance with DIN EN 14637	white	139850
GEZE GC 153 thermal detector Complete with base, 24 V DC, 20 mA, tested in accordance with EN54-5, with general approval for use with all GEZE hold-open systems, integrated line monitoring, in accordance with DIN EN 14637	white	139881
GEZE AS 500 manual trigger switch Surface-mounted version for the manual release of electrically controlled hold-open devices	alpine white/red	116266
Surface-mounted box, single Matching the AS 500 switch range	alpine white	120503
GEZE AS 500 manual trigger switch (with glass pane and 5 interchangeable labels) Surface-mounted version for the manual release of electrically controlled hold-open devices	alpine white/red	120880
Replacement glass pane for GEZE manual trigger switch 120880 and 120881		010994

1) Only for dry rooms

2) Surcharge for RAL special colours, see General Information in the Price List.



HafenCity University Hamburg, Germany (photo: S. Dauth)

## GEZE miscellaneous accessories

### Accessories for special requirements for the operation and safety of automatic doors

GEZE offers different accessories for special requirements. The cast casings and the metal keyboard of the number codelocks are especially helpful against vandalism.



Rotary switch contact



Euro profile cylinder for key switch



Euro profile cylinder for manual locking devices



Toplock CTI



Toplock CTI B with lighting



Toplock CTS V with metal keypad



Toplock CTI BV with lighting

### Area of application

- Activation and protection of automatic swing, sliding, folding, revolving and curved sliding doors
- Use as contactor when door handle is pressed
- Use for floor locking of sliding doors
- Use as access control for inside and outside areas

## GEZE ACTIVATION DEVICES / SENSOR SYSTEMS

	Rotary switch contact	Euro profile cylinder for key switch	Euro profile cylinder for floor locks
<b>Specification</b>	<ul style="list-style-type: none"> <li>• Closing contact</li> <li>• Switching voltage: max. 24 V DC</li> <li>• Switching current: max. 35 mA</li> <li>• 4 m connection cable</li> </ul>	<ul style="list-style-type: none"> <li>• Euro profile cylinder for key switch 40 mm (10/30) one-sided locking, with 3 keys, ID no. 090176</li> </ul>	<ul style="list-style-type: none"> <li>• Euro profile cylinder for manual locking devices 46 mm (9/37) one-sided locking, for ISO and toughened safety glass fittings, with 3 keys, ID no. 019053</li> <li>• Euro profile cylinder for manual locking devices 66 mm (31/35) two-sided locking, for toughened safety glass fittings, with 3 keys, ID no. 091052</li> <li>• Euro profile cylinder for manual locking devices 71 mm (31/40) two-sided locking, for ISO fittings, with 3 keys, ID no. 023356</li> <li>• Euro profile cylinder for manual locking devices 66 mm (31/35) two-sided locking, packed in pairs, for toughened safety glass fittings, with 3 keys, ID no. 074861</li> <li>• Euro profile cylinder for manual locking devices 71 mm (31/40) two-sided locking, packed in pairs, for ISO fittings, with 3 keys, ID no. 074862</li> </ul>
<b>Dimensions</b>	23 x 39 x 8 mm	see specification	see specification
<b>ID no.</b>	081024	see specification	see specification

	Toplock CT I	Toplock CT I B with lighting	Toplock CTS V with metal keypad	Toplock CTS BV with lighting
<b>Operating voltage</b>	12 - 24 V DC / 12 V AC	12 - 24 V DC / 12 V AC	230 V AC	230 V AC
<b>Output</b>	potential-free normally opened contact 24 V DC 1 A	potential-free normally opened contact 24 V DC 1 A	potential-free relay output 250 V 5 A	potential-free relay output 250 V 5 A
<b>IP rating</b>	IP65	IP65	IP65 (keypad), IP 43 (evaluation unit)	IP65 (keypad), IP43 (evaluation unit)
<b>Dimensions</b>	80 x 80 x 15 mm	60 x 126 x 22.5 mm	80 x 80 x 15 mm or 110 x 188 x 40 mm	60 x 126 x 22.5 mm or 110 x 188 x 40 mm
<b>ID no.</b>	090061	090063	090077	090079



### References



Vitra Haus, Weil am Rhein, Germany (photo: Oliver Look)

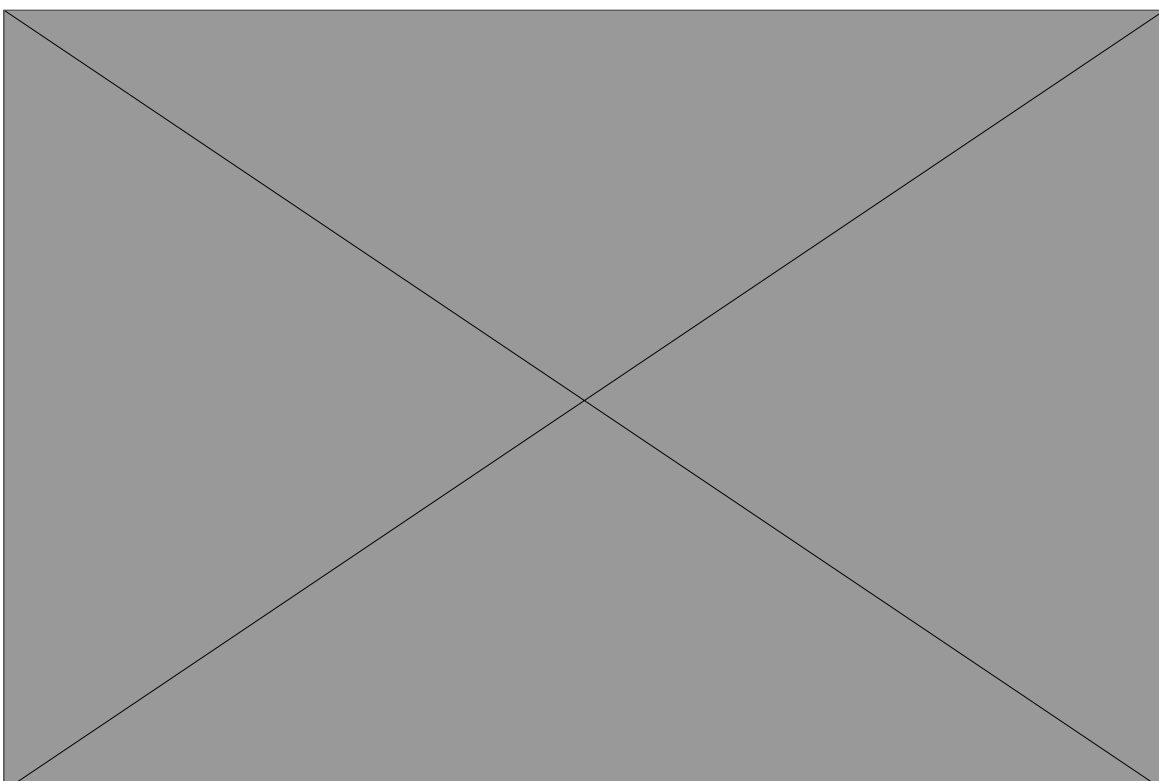

Catholic church administration building, Stuttgart, Germany (photo: Dirk Wilhelmy for GEZE GmbH)



## POTENTIAL APPLICATIONS OF GEZE PRODUCTS



Gelderlandplein, Amsterdam, Netherlands (photo: Erwin Kamphuis for GEZE GmbH)



Modern Art, Oxford, Great Britain (photo: GEZE GmbH)

# GEZE ACTIVATION DEVICES / SENSOR SYSTEMS

You will find more product information in the relevant brochures, see ID numbers.

## Door technology

01	Overhead door closers ID 091593, ID 091594
02	Hold-open systems ID 091593, ID 091594
03	Integrated door closers ID 091609
04	Floor springs and all-glass fittings ID 091607
05	Sliding fitting systems and linear guides ID 123605, ID 000586

## Automatic door systems

06	Swing doors ID 144785
07	Sliding, telescopic and folding doors ID 143639
08	Curved sliding doors ID 135772
09	Revolving doors ID 132050
10	Activation devices and sensors ID 142655

## Smoke and heat extraction and window technology

11	Fanlight opening systems ID 127787
12	Electric opening and locking systems ID 127785, ID 127789
13	Electrical spindle and linear drives ID 127785, ID 127789
14	Electric chain drives ID 127785, ID 127789
15	Smoke and heat extraction systems ID 127785, ID 139075

## Safety technology

16	Emergency exit systems ID 132408
17	Access control systems ID 132158
18	Panic locks ID 132848
19	Electric strikes ID 148666
20	Building management system ID 132408

## Glass systems

21	Manual sliding wall systems (MSW) ID 104377
22	Integrated all-glass systems (IGG) ID 104366

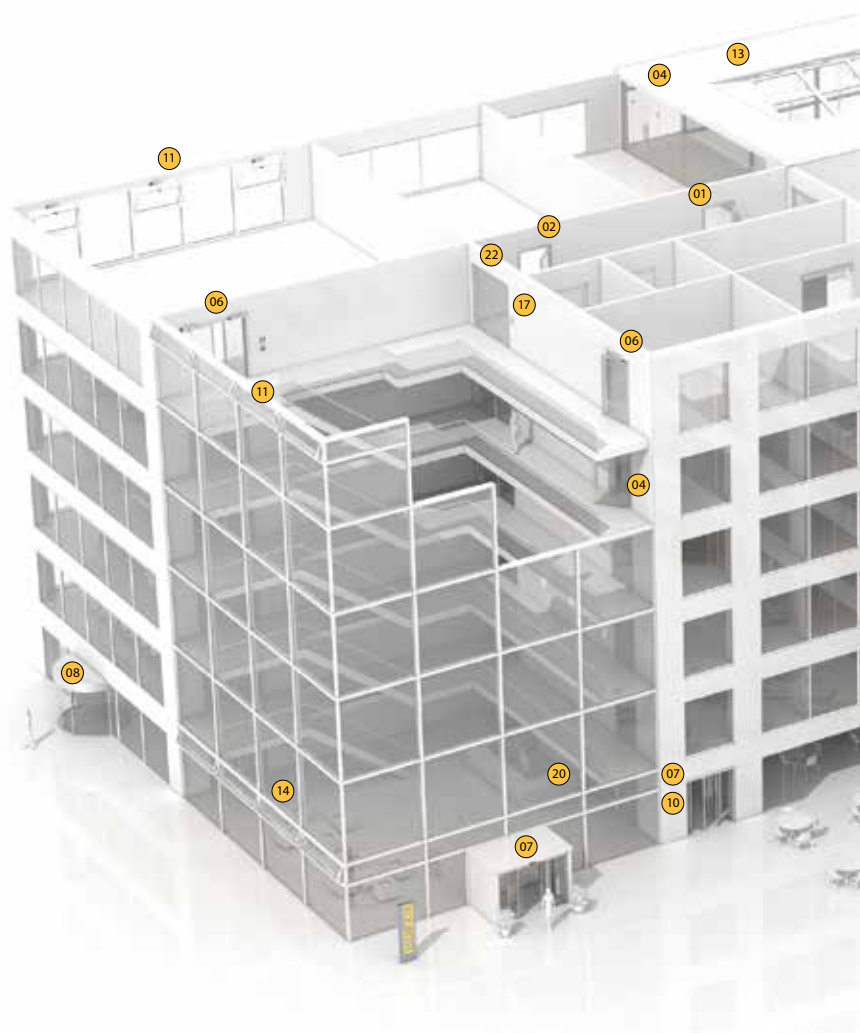

# POTENTIAL APPLICATIONS OF GEZE PRODUCTS



## Door technology

The functionality, superior performance and reliability of GEZE door closers are impressive. A common design across the range, the ability to use them on all common door leaf widths and weights, and the fact that they can be individually adjusted makes their selection simple. They are continually being improved and enhanced with up-to-date features. For example, the requirements of fire protection and accessibility are fulfilled with a door closer system.

## Automatic door systems

GEZE automatic door systems open up a huge variety of options in door design. The latest, innovative high-performance drive technology, safety, ease of accessibility and first class universal drive design set them apart. GEZE offers complete solutions for individual requirements.

## Smoke and heat extraction and window technology

GEZE smoke and heat extraction systems and ventilation technology provide complete systems solutions combining the many requirements of different types of windows. We supply a full range from energy efficient drive systems to natural ventilation and complete solutions for supplying and extracting air, also as certified SHEVs.

## Safety technology

GEZE safety technology sets the standards where preventative fire protection, access control and anti-theft security in emergency exits are concerned. For each of these objectives GEZE offers tailored solutions, which combine the individual safety requirements in one intelligent system and close doors and windows in case of danger in a coordinated manner.

## Building systems

In GEZE's Building Management System GEZE door, window and safety products can be integrated in to the security and control systems of the building. A central control and visualisation system monitors various automation components in the building and offers security through many different networking capabilities.

## Glass systems

GEZE glass systems stand for open and transparent interior design. They can either blend discreetly into the architecture of the building or stand out as an accentuated feature. GEZE offers a wide variety of technologies for functional, reliable and aesthetic sliding wall or sliding door systems providing security with lots of design scope.



**GEZE GmbH**  
P.O. Box 1363  
71226 Leonberg  
Germany

**GEZE GmbH**  
Reinhold-Vöster-Straße 21-29  
71229 Leonberg  
Germany  
Telefon +49 7152 203 0  
Telefax +49 7152 203 310  
www.geze.com

**Germany**  
GEZE GmbH  
Niederlassung Süd-West  
Breitwiesenstraße 8  
71229 Leonberg  
Tel. +49 7152 203 594  
Fax +49 7152 203 438  
leonberg.de@geze.com

GEZE GmbH  
Niederlassung Süd-Ost  
Parkring 17  
85748 Garching bei München  
Tel. +49 7152 203 6440  
Fax +49 7152 203 77050  
muenchen.de@geze.com

GEZE GmbH  
Niederlassung Ost  
Albert-Einstein-Ring 5  
14532 Kleinmachnow bei Berlin  
Tel. +49 7152 203 6840  
Fax +49 7152 203 76849  
berlin.de@geze.com

GEZE GmbH  
Niederlassung Mitte/Luxemburg  
Siemensstraße 14  
63263 Neu-Isenburg  
Tel. +49 7152 203 6888  
Fax +49 7152 203 6891  
frankfurt.de@geze.com

GEZE GmbH  
Niederlassung West  
Heltorfer Straße 12  
40472 Düsseldorf  
Tel. +49 7152 203 6770  
Fax +49 7152 203 76770  
duesseldorf.de@geze.com

GEZE GmbH  
Niederlassung Nord  
Albert-Schweitzer-Ring 24-26 (3. OG)  
22045 Hamburg  
Tel. +49 7152 203 6600  
Fax +49 7152 203 76608  
hamburg.de@geze.com

GEZE Service GmbH  
Niederlassung Süd-West  
Reinhold-Vöster-Straße 25  
71229 Leonberg  
Tel. +49 1802 923392  
Fax +49 7152 9233 359  
service-leonberg.de@geze.com

GEZE Service GmbH  
Niederlassung Süd  
Parkring 17  
85748 Garching bei München  
Tel. +49 1802 923392  
Fax +49 7152 9233 859  
service-muenchen.de@geze.com

GEZE Service GmbH  
Niederlassung Mitte/Luxemburg  
Siemensstraße 14  
63263 Neu-Isenburg  
Tel. +49 1802 923392  
Fax +49 7152 9233 659  
service-frankfurt.de@geze.com

GEZE Service GmbH  
Niederlassung West  
Heltorfer Straße 12  
40472 Düsseldorf  
Tel. +49 1802 923392  
Fax +49 7152 9233 559  
service-duesseldorf.de@geze.com

GEZE Service GmbH  
Niederlassung Ost  
Albert-Einstein-Ring 5  
14532 Kleinmachnow bei Berlin  
Tel. +49 1802 923392  
Fax +49 7152 9233 759  
service-berlin.de@geze.com

GEZE Service GmbH  
Niederlassung Nord  
Albert-Schweitzer-Ring 24-26 (3. OG)  
22045 Hamburg  
Tel. +49 1802 923392  
Fax +49 7152 9233 459  
service-hamburg.de@geze.com

**Austria**  
GEZE Austria  
Wiener Bundesstrasse 85  
A-5300 Hallwang  
Tel: +43 6225 87180  
Fax: +43 6225 87180 299  
austria.at@geze.com

**Baltic States –  
Lithuania / Latvia / Estonia**  
Tel. +371 678960 35  
baltic-states@geze.com

**Benelux**  
GEZE Benelux B.V.  
Industrieterrein Kapelbeemd  
Steenoven 36  
5626 DK Eindhoven  
Tel. +31 4026290 80  
Fax +31 4026290 85  
benelux.nl@geze.com

**Bulgaria**  
GEZE Bulgaria - Trade  
Representative Office  
Nickolay Haitov 34 str., fl. 1  
1172 Sofia  
Tel. +359 247043 73  
Fax +359 247062 62  
office-bulgaria@geze.com

**China**  
GEZE Industries (Tianjin) Co., Ltd.  
Shuangchenzhong Road  
Beichen Economic Development  
Area (BEDA)  
Tianjin 300400, P.R. China  
Tel. +86 22 26973995  
Fax +86 22 26972702  
chinasales@geze.com.cn

GEZE Industries (Tianjin) Co., Ltd.  
Branch Office Shanghai  
Jia Little Exhibition Center  
Room C 2-102  
Shenzhuan Rd. 6000  
201619 Shanghai, P.R. China  
Tel. +86 21 52340960  
Fax +86 21 64472007  
chinasales@geze.com.cn

GEZE Industries (Tianjin) Co., Ltd.  
Branch Office Guangzhou  
Room 17 C 3  
Everbright Bank Building, No.689  
Tian He Bei Road  
510630 Guangzhou, P.R. China  
Tel. +86 20 38731842  
Fax +86 20 38731834  
chinasales@geze.com.cn

GEZE Industries (Tianjin) Co., Ltd.  
Branch Office Beijing  
Room 04-05, 7th Floor  
Red Sandalwood Plaza  
No. 27 Jianguo Road  
Chaoyang District  
100024 Beijing, P.R.China  
Tel. +86 10 85756009  
Fax +86 10 85758079  
chinasales@geze.com.cn

**France**  
GEZE France S.A.R.L.  
ZAC de l'Orme Rond  
RN 19  
77170 Servon  
Tel. +33 1 606260 70  
Fax +33 1 606260 71  
france.fr@geze.com

**Hungary**  
GEZE Hungary Kft.  
Hungary-2051 Biatorbágy  
Vendel Park  
Huber u. 1.  
Tel. +36 23532 735  
Fax +36 23532 738  
office-hungary@geze.com

**Iberia**  
GEZE Iberia S.R.L.  
C/ Andorra 24  
08830 Sant Boi de Llobregat  
(Barcelona)  
Tel. +34 902194 036  
Fax +34 902194 035  
info@geze.es

**India**  
GEZE India Private Ltd.  
MF 2 & 3, Guindy Industrial Estate  
Ekkattuthangal  
Chennai 600 097  
Tamilnadu  
Tel. +91 44 406169 00  
Fax +91 44 406169 01  
office-india@geze.com

**Italy**  
GEZE Italia S.r.l.  
Sede di Vimercate  
Via Fiorbellina 20  
20871 Vimercate (MB)  
Tel. +39 0399530401  
Fax+39 039 9530459/419  
italia.it@geze.com

Sede di Roma  
Via Lucrezia Romana, 91  
00178 Roma  
Tel. +39 039 9530401  
Fax +39 039 9530449  
italia.it@geze.com

**Poland**  
GEZE Polska Sp. z o.o.  
ul. Marywilska 24  
03-228 Warszawa  
Tel. +48 224 404 440  
Fax +48 224 404 400  
geze.pl@geze.com

**Romania**  
GEZE Romania S.R.L.  
IRIDE Business Park,  
Str. Dimitrie Pompeiu nr. 9-9a,  
Building 10, Level 2, Sector 2,  
020335 Bucharest  
Tel.: +40 212507 750  
Fax: +40 316201 258  
office-romania@geze.com

**Russia**  
OOO GEZE RUS  
Letnikovskaya str. 10/2  
Floor 6, room VII  
115114 Moscow  
Tel: +7 495 741 40 61  
office-russia@geze.com

**Scandinavia – Sweden**  
GEZE Scandinavia AB  
Mallslingan 10  
Box 7060  
18711 Täby, Sweden  
Tel. +46 87323 400  
Fax +46 87323 499  
sverige.se@geze.com

**Scandinavia – Norway**  
GEZE Scandinavia AB avd. Norge  
Industriveien 34 B  
2073 Dal  
Tel. +47 63957 200  
Fax +47 63957 173  
norge.se@geze.com

**Scandinavia – Denmark**  
GEZE Danmark  
Branch office of GEZE Scandinavia AB  
Mårkærvej 13 J-K  
2630 Taastrup  
Tel. +45 463233 24  
Fax +45 463233 26  
danmark.se@geze.com

**Singapore**  
GEZE (Asia Pacific) Pte. Ltd.  
21 Bukit Batok Crescent  
#23-75 Wcga Tower  
Singapore 658065  
Tel: +65 6846 1338  
Fax: +65 6846 9353  
gezesea@geze.com.sg

**South Africa**  
Geze South Africa (Pty) Ltd.  
GEZE, Building 3, 1019 Morkels Close  
Midrand 1685  
Tel: +87 94337 88  
Fax: +86 66137 52  
info@gezesa.co.za

**Switzerland**  
GEZE Schweiz AG  
Zelglimatte 1A  
6260 Reiden  
Tel. +41 62 28554 00  
Fax +41 62 28554 01  
schweiz.ch@geze.com

**Turkey**  
GEZE Kapı ve Pencere Sistemleri  
San. ve Tic. Ltd. Sti.  
İstanbul Anadolu Yakası Organize  
Sanayi Bölgesi  
Gazi Bulvarı Caddesi 8.Sokak No:8  
Tuzla-İstanbul  
Tel. +90 216 45543 15  
Fax +90 216 45582 15  
office-turkey@geze.com

**Ukraine**  
GEZE Ukraine LLC  
45, Elektrotekhnicheskaya str.,  
Kiev, 02222  
Tel./Fax +38 445012225  
office-ukraine@geze.com

**United Arab Emirates/GCC**  
GEZE Middle East  
P.O. Box 17903  
Jebel Ali Free Zone  
Dubai  
Tel: +971 48833 112  
Fax +971 48833 240  
gezeme@geze.com

**United Kingdom**  
GEZE UK Ltd.  
Blenheim Way  
Fradley Park  
Lichfield  
Staffordshire WS13 8SY  
Tel. +44 15434430 00  
Fax +44 15434430 01  
info.uk@geze.com

GEZE REPRESENTATIVE