

Over lintel, general purpose and parapet horizontal cavity trays

A range to protect modern steel lintels, general purpose horizontal and parapet cavity applications

Free cavity tray
specification and
scheduling service
Contact Technical
on 01405 765 567

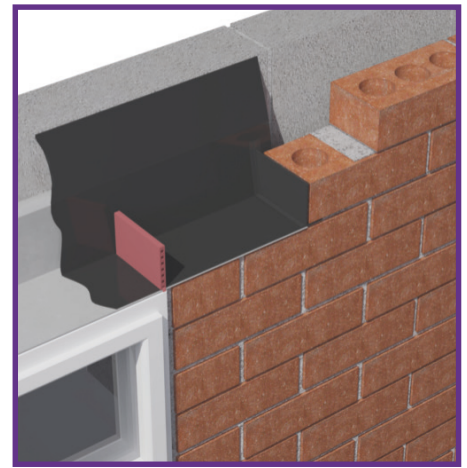

Use

- Over steel lintels in external cavity walls (LCT)
- General purpose horizontal cavity applications such as floor beams, abutments and meter boxes (GCT)
- For parapet walls (HPT)

Features and benefits

- Fully self supporting cavity tray system built independently from inner leaf
- Available for all coursing heights and styles with options available to suit all cavity variations
- Full range of cut to length sizes available
- No site fabrication, no waste, easy to handle and install
- Consistency and build quality maintained, cost effective

Quality

- Tough, durable, scratch resistant and puncture resistant
- Manufactured to BS ISO 9001 and BS EN 14001
- Meets all relevant British Standards
- Meets all documented cavity tray requirements
- Meets all NHBC recommendations

Material and colour choice

- Manufactured from black 2mm polypropylene
- A high quality product that is rigid yet durable for site conditions

Installation advice - Lintel Trays

- Lintel cavity trays must be combined with lintel stopends and proprietary weep hole units to achieve their full potential of being a system which offers maximum water catchment and discharge properties for above openings
- Standard length 2.5mtrs in one piece

Please see technical section for more details.

How to order

- Two stopends and weep holes at 450mm centres (minimum of two weep holes) are required per lintel/tray
- Consult lintel manufacturer to confirm lintel upstand height and select next available LCT height (either 100mm, 150mm or 225mm)
- Calculate the length of LCT required by adding a minimum of 300mm to length of lintel. This will give adequate cavity tray length to allow stopends to be inserted into the next perp joint away from the opening
- Add the appropriate LCT length to the product code before ordering
- The standard range of lintel cavity tray has been designed to suit the most popular types of steel lintel

Bill of quantity

F30 Accessories/sundry items for brick/block/stone walling

Clause

485^ PREFORMED CAVITY TRAY / ACCESSORIES

- Manufacturer: **Timloc Building Products, Timloc House, Ozone Park, Howden, East Yorkshire, DN14 7SD. T: 01405 765567 W: www.timloc.co.uk**
- To extend not less than 150mm beyond ends of lintels/bridgings.
- Reference: **LCT lintel cavity trays**
- Lintel Rise:.....(**100mm, 150mm or 225mm**)
- Cavity width:.....(**50mm, 75mm or 100mm**)

Product codes

LCT lintel, GCT and HPT horizontal cavity trays

| Description | Colour | Product codes to suit clear cavity widths of | | |
|------------------------|--------|---|------|-------|
| | | 50mm | 75mm | 100mm |
| LCT100 Lintel tray | Black | 5001 | 5002 | 5003 |
| LCT150 Lintel tray | Black | 5004 | 5005 | 5006 |
| LCT225 Lintel tray | Black | 5007 | 5008 | 5009 |
| GCT50 Horizontal tray | Black | 5201 | - | - |
| GCT75 Horizontal tray | Black | - | 5202 | - |
| GCT100 Horizontal tray | Black | - | - | 5203 |
| HPT50 Horizontal tray | Black | 5301 | - | - |
| HPT75 Horizontal tray | Black | - | 5302 | - |
| HPT100 Horizontal tray | Black | - | - | 5303 |

Trays to suit clear cavity widths of 101mm+ can be made to order.

Corners, stopends and joining tape are available to offer a fully sealed/ water tight system. Other variants of GCT available to order.

