

# The first Secured by Design and Plateau Added Security Range

Secured by Design

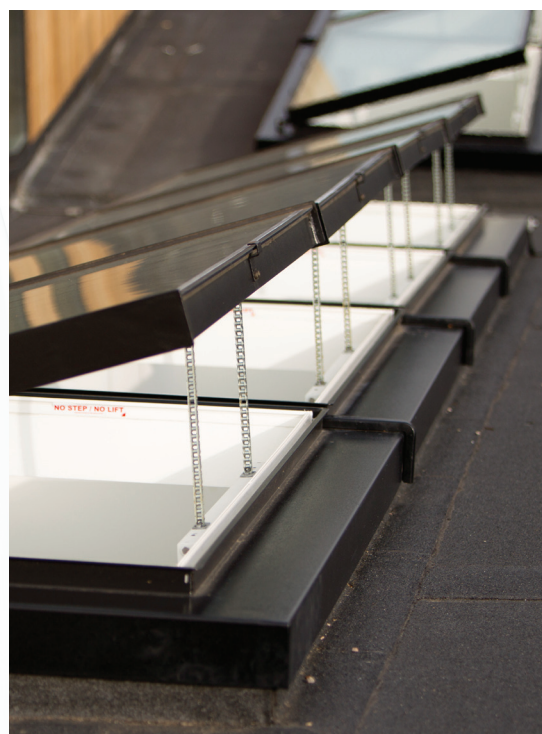

Official Police Security Initiative



## Plateau SBD Features include:

- The first rooflight to be SBD certified to Loss Prevention Standard 1175-6 Level 3.
- Standard double glazing includes outer pane conforming to CAT P6B BSEN356 combined with a low u-value.
- Fixed shut stainless steel frame.
- Obscure and anti-glare glazing options.
- Optional coated stainless security bars.
- Available in white, black, light and dark grey or any RAL colour.

## Plateau Added Security Features include:

- Openable rooflight with an ideal combination of aesthetics and security features.
- Glazing options include CAT P6B BSEN356 and obscure glass.
- Low profile casement standing only 95mm above kerb height.
- Available in white, black, light and dark grey or any RAL colour.
- Tamper proof hinges and security bars available.
- Optional protective glazing perimeter guard to increase security.
- Six standard sizes and bespoke design service readily available.

**the Rooflight Company**  
*The Professionals' Choice*

**01993 833108**  
**[www.therooflightcompany.co.uk](http://www.therooflightcompany.co.uk)**

# Plateau Secured By Design

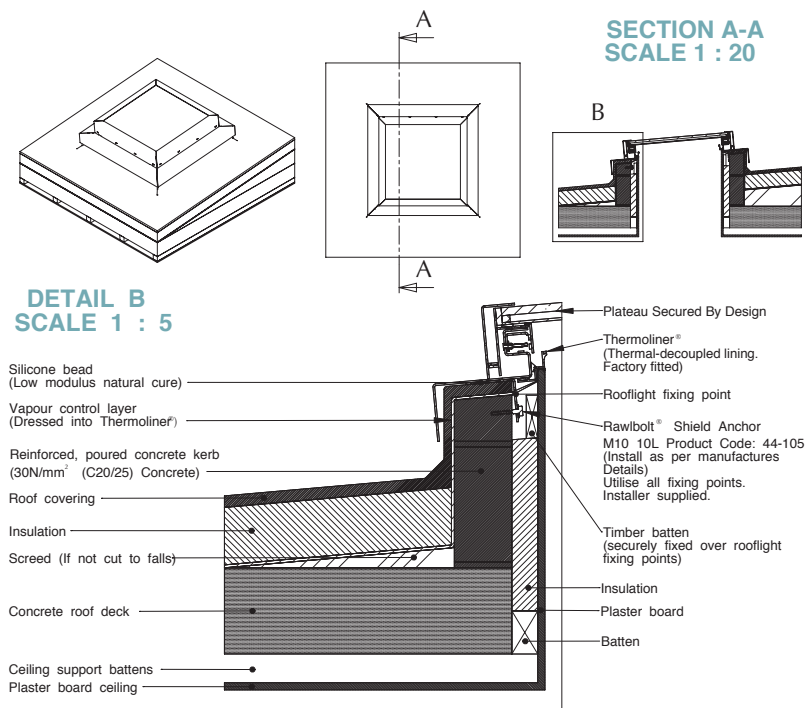

# Plateau Added Security

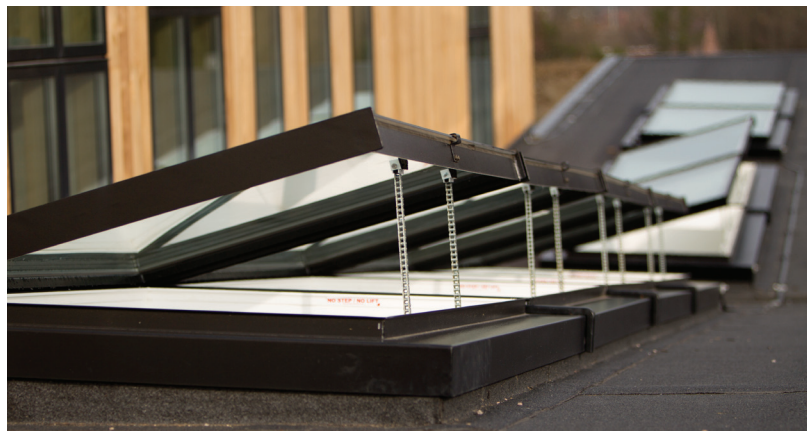

Plateau Added Security - suitable for all roof types.

# High Security

Where high security is paramount, for example secondary school projects in high crime areas, you have reassurance from specifying the only Secured By Design certified product.

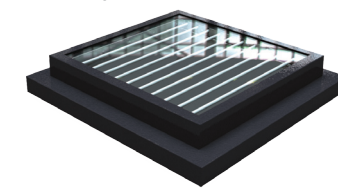

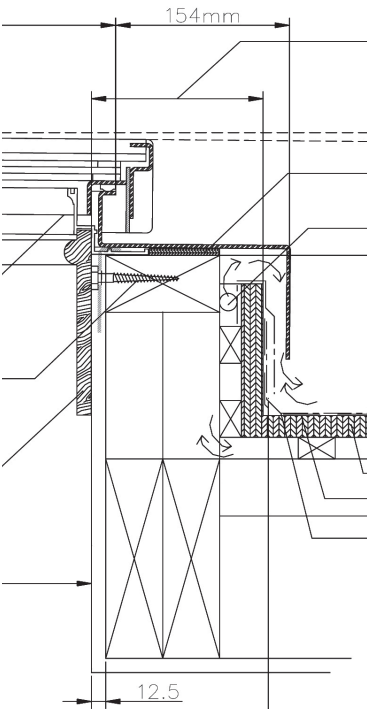

Optional Coated Stainless steel intruder bars

# Plateau Added Security Kerb Detail

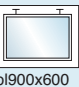

# Plateau Added Security Sizing

For Plateau Secured By Design sizing please contact Customer Service.

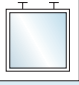
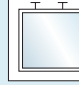
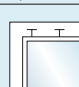
| Internal Kerb Length | Internal Kerb Width  |  |  |
|----------------------|--|--|--|
|                      | 600mm  | 900mm  | 1200mm   |
| 600mm                | <br>p1600 | <br>p1900x600 | <br>p1200x600 |
| 900mm                |  | <br>p1900     | <br>p1200x900 |
| 1200mm               |  |  | <br>p1200     |

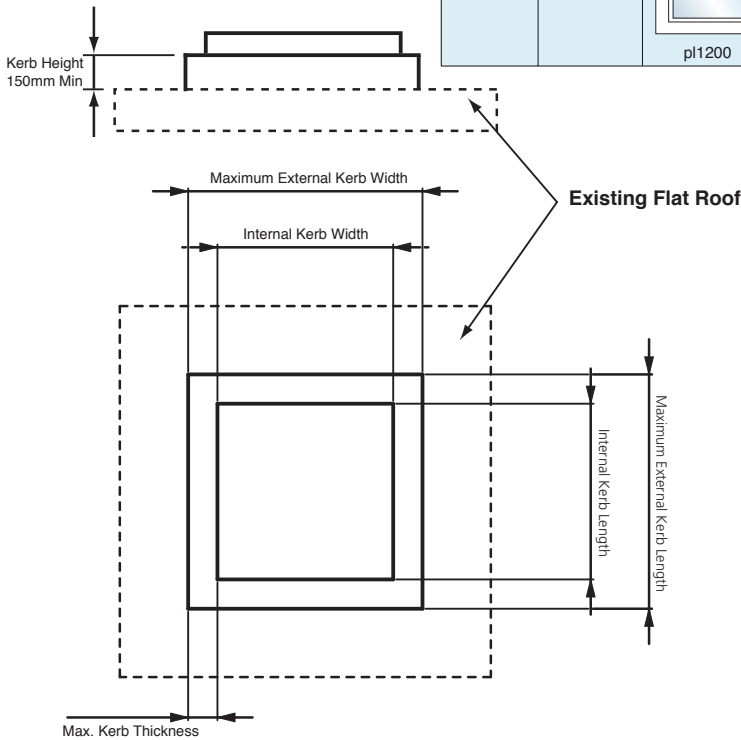

| Model       | Max.Kerb Thickness (mm) | Internal Kerb Width (mm) | Internal Kerb Length (mm) | Max.Ext. Kerb Width (mm) | Max.Ext. Kerb Length (mm) | Rooflight Weight (Kg) |
|-------------|-------------------------|--------------------------|---------------------------|--------------------------|---------------------------|-----------------------|
| p1600       | 150                     | 600                      | 600                       | 900                      | 900                       | 54                    |
| p1900       | 150                     | 900                      | 900                       | 1200                     | 1200                      | 89                    |
| p1200       | 150                     | 1200                     | 1200                      | 1500                     | 1500                      | 133                   |
| p1200 x 600 | 150                     | 1200                     | 600                       | 1500                     | 900                       | 85                    |
| p1200 x 900 | 150                     | 1200                     | 900                       | 1500                     | 1200                      | 109                   |
| p1900 x 600 | 150                     | 900                      | 600                       | 1200                     | 900                       | 70                    |