



HYGIENIC COATINGS SELECTION GUIDE

HIGH PERFORMANCE SOLUTIONS FOR WALLS AND CEILINGS IN
HYGIENE SENSITIVE AREAS USING Sikagard®

Sikagard® HYGIENIC COATINGS

Steridex, Sterisheen & Sterimatt have been rebranded to form part of the Sikagard® coatings range from Sika

TECHNOLOGY WITH HISTORY

Formerly of Liquid Plastics the Sikagard® hygienic coatings for walls and ceilings have been specifically designed to meet both functional and aesthetic needs for facilities where the highest standards of hygiene are required. Frequently used in facilities where health and safety is of utmost importance, such as healthcare, pharmaceutical and food manufacturing facilities the Sikagard® hygienic coatings range meet all relevant health and safety standards and regulations and will help ensure that a building's internal environment can be kept to the highest possible standards of hygiene.

SIMPLE AND EFFECTIVE

Based on over 40 years experience, Sikagard®-400 series is an ultra low emissions*, single component water based wall coating, that is easy to apply by brush, roller or airless spray.

Sikagard®-400 range represents one of the simplest and most effective methods of achieving a high performing surface, that is easy to clean, hard-wearing and free from joints, seams and other features that provide a hiding place for dirt and bacteria. This, coupled with the coatings organic in-film preservative, make it the ideal solution for areas where good hygiene is paramount.

DURABILITY AND MAINTENANCE CYCLE

In demanding hygiene environments like operating theatres, standard paints are no match for this range of specifically developed hygienic coatings. Offering far more than traditional paints, Sikagard® hygiene coatings are designed to provide exceptional durability as well as an enhanced resistance to cracking, splitting and flaking. This market leading durability and strength coupled with the fast drying properties of the products, which allow two coats to be applied within 24 hours, dramatically reduces downtime and extends the maintenance cycle, minimising disruption and the related materials, labour and downtime costs.

IMPACT RESISTANCE

For areas that may require enhanced impact resistance the Sikagard® hygiene coatings can be reinforced with Sika® Reemat glass fibre matting. Available in two grades – Sika® Reemat Lite and Sika® Reemat Premium – the mat is easily incorporated into the Sikagard® systems which once cured provide a high performance, seamless finish that is both highly durable and aesthetically pleasing.

COLOUR AND FINISH

Available in a wide spectrum of colours and two separate finishes – matt and mid-sheen – the Sikagard® hygienic coatings range offers the aesthetic flexibility and design adaptability to match your project needs.

KEY ADVANTAGES

- Ultra low emissions*
- Tough and highly durable
- Resists cracking and flaking
- Seamless - easy to clean
- Good resistance to repeated cleaning regimes, mild detergents and cleaning solutions
- Good water vapour permeability
- Matt finishes
- Easy application
- Fast drying: two coats in one working day
- Good covering and hiding power (opacity)
- Water based, low odour
- Fibreglass reinforcement options available for increased impact resistance
- Brush, roller or spray applied systems
- Compatible with most common substrates

TYPICAL AREAS OF USE

- Hospital and healthcare facilities (according to Health Building Note: HBN: 00-10, HTM 56 and SHTM 56)
- Food and beverage production
- Pharmaceutical and cosmetics industries
- Leisure facilities
- Chemical and electronics industries
- Agricultural and animal facilities
- Nuclear and other energy industries
- Prison and military facilities

* Tested in accordance with Émissions dans l'air intérieur (Decret DEVL 11019093D) and April 19, 2011 (DEVL 11034875A)

BUILD-UP OF SYSTEMS



BASIC Two Coat System

Basic two coat system used for lightly trafficked areas, with low impact demands and a limited/basic cleaning regime.

Sikagard Wallcoat AS-11
Hygienic:

2 x **Sikagard®-403 W**
2 x **Sikagard®-405 W**
2 x **Sikagard®-406 W**
2 x **Sikagard®-207 W**



INTERMEDIATE Three Coat System

Intermediate three coat system used for areas with low impact demands and a regular cleaning regime.

Sikagard Wallcoat AS-12
Hygienic:

1 x **Sikagard®-403 W**
2 x **Sikagard®-405 W**
2 x **Sikagard®-406 W**



ADVANCED Reinforced System

Reinforced system used for trafficked areas, with increased impact demands.

Sikagard Wallcoat PL-14:

1 x **Sikagard®-403 W**
+ **Reemat Lite** + 1 x
Sikagard®-403 W
and either
2 x **Sikagard®-405 W**
2 x **Sikagard®-406 W**

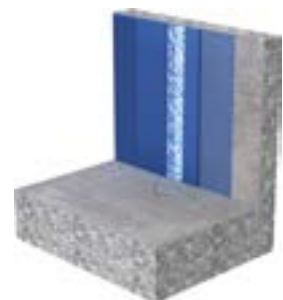

ADVANCED Double Reinforced System

Advanced reinforced system used for highly trafficked areas, with increased impact demands and a demanding cleaning regime.

Sikagard Wallcoat PL-15:

1 x **Sikagard®-403 W** +
Reemat Premium + **Reemat**
Lite + 1 x **Sikagard®-403 W**
and either
2 x **Sikagard®-405 W**
2 x **Sikagard®-406 W**



PROJECT RELATED REQUIREMENTS



Walls and ceilings have to fulfil the highest hygiene and increasingly very specific requirements for the prevention of contamination, particularly in the nuclear, pharmaceutical, cosmetic, food, beverage, chemical and electronics industries.



Coatings in the food and beverage industry have to be suitable for direct contact, or to be in close proximity to food stuffs, without adversely affecting them, in addition to being able to withstand intensive cleaning regimes and frequent exposure to chemical detergents.



Easy wall cleaning and ease of maintenance procedures provide the basis for an efficient production environment.

HYGIENIC COATINGS RANGE



| PRODUCTS | Description |
|-----------------------------------|---|
| Sikagard®-403 W | Sikagard®-403 W is highly flexible, in comparison to standard paints, providing enhanced resistance to cracking and flaking. It is a tough, highly durable, single component, waterborne, modified acrylic resin based coating that cures to form a high build, hard wearing membrane. Eminently versatile, this product has a dead matt finish and can be used as an embedment, intermediate, or a finishing top coat. |
| Sikagard®-405 W | Sikagard®-405 W is a single component, waterborne, acrylic resin based surface coating that contains an organic in-film preservative. It is as easy to apply as regular emulsion and cures without any strong odour to form an attractive, low-glare finish that combines decorative properties with ease of cleaning. |
| Sikagard®-406 W | Similar to Sikagard®-405 W, Sikagard®-406 W is also a single component, waterborne, acrylic resin based surface coating that contains an organic in-film preservative. As easy to apply as regular emulsion it and cures without any strong odour to form an attractive, matt finish that combines decorative properties with ease of cleaning. |
| Sikagard®-207 W (Biosheen) | This single component, waterborne, modified acrylic resin based surface coating for walls and ceilings, contains an organic in-film preservative. With a mid-sheen finish, it is ideal for use in domestic situations or for providing basic hygiene protection of large areas. |

Sika also supply a range of sealants compatible with the Sikagard® Hygiene Coatings. For more information please call 01707 394444.



SYSTEM SELECTION GUIDE

CHOOSING A HYGIENIC COATING

When choosing a hygienic coating the end use of the facility, any relevant regulations and the specific conditions that the coating will be exposed to must be considered for example internal walls and ceilings in food and beverage production plants must frequently withstand extreme situations, including high humidity and wet conditions due to the amount of water used for cleaning and flushing, plus thermal shocks, caused by the sudden changes in temperature. Whereas hygiene sensitive environments in healthcare facilities and the pharmaceutical industry place other highly specific demands on wall and ceiling coatings.

| | | Sikagard® Systems | | | |
|---------------------------------------|---|-------------------|--------|------------|-------------------|
| AREAS OF USE | | 2 coat | 3 coat | Reinforced | Double Reinforced |
| Healthcare | Clinical specialist - theatre suite | • | • | • | |
| | Clinical specialist - X-ray room | • | • | | |
| HBN: 00-10 Part B (see note below) | Clinical specialist - post-mortem room | | • | • | |
| | Clinical specialist - aseptic suite | | | | • |
| | Clinical - wet (high/medium impact) eg assisted bathroom/shower | | | • | • |
| | Clinical - wet (low impact) eg dirty utility | • | | | |
| | Clinical - dry eg multi and single bedrooms, consulting rooms | • | • | | |
| | Non-clinical - wet (high/medium impact) eg shower room (en-suite) | | | • | |
| | Non-clinical - wet (low impact) eg cleaner's room | • | | | |
| | Non-clinical - dry eg offices, stores | • | • | | |
| | Heavy traffic eg corridors, entrances, lobbies, stairs etc | • | • | • | |
| | | | | | |
| Food and beverage | Preparations and processing areas | • | • | | |
| | Storage and serving areas | • | • | | |
| | Refrigeration (not below 5°C) | • | • | | |
| | Kitchens/canteens | • | • | • | |
| Pharmaceutical | Corridors | • | • | • | |
| | Laboratories | • | • | • | • |
| | Storage | • | • | | |
| Leisure | Swimming pool environments | • | • | | |
| | Gyms | • | • | • | |
| General industrial/commercial | Prison cells | • | • | | |
| | Workshop/production areas | • | • | • | |
| | Changing areas | • | • | | |
| | Washrooms | • | • | | |
| | Splashbacks/continually wet areas | | | • | • |
| | Impact areas | | | • | • |
| | General areas | • | • | | |
| | Ceilings | • | | | |

NOTE: HBN 00-10 Part B outlines the policy and performance requirements for walls and ceilings used in healthcare facilities, superseding HTM 56 and several other building components HTMs.

† Areas of impact must be reinforced.

PRODUCT SELECTION GUIDE

| 2 COAT SYSTEMS | Products | Finish |
|----------------|--|-----------|
| Standard | 2 coats of Sikagard®-403 W @ 3.6m ² /litre per coat | Matt |
| | 2 coats of Sikagard®-405 W @ 6m ² /litre per coat | Mid-sheen |
| | 2 coats of Sikagard®-406 W @ 6m ² /litre per coat | Matt |
| | 2 coats of Sikagard®-207 W @ 10m ² /litre per coat | Mid-sheen |

| 3 COAT SYSTEMS | Products | Finish |
|----------------|---|---|
| Standard | 1 coat of Sikagard®-403 W @ 3.6m ² /litre per coat | Choice of 2 top coats from the Standard Range as above [§] |

| REINFORCED SYSTEMS | Products | Finish |
|--------------------|---|---|
| Standard | 1 coat of Sikagard®-403 W @ 4m ² /litre per coat, Sika® Reemat Lite, 1 coat of Sikagard®-403 W @ 4m ² /litre per coat | Choice of 2 top coats from the Standard Range as above [§] |

| DOUBLE REINFORCED SYSTEMS | Reinforcements | Top Coats |
|---------------------------|--|---|
| Standard | 1 coat of Sikagard®- 403 W @ 2m ² /litre per coat, Sika® Reemat Premium then Sika® Reemat Lite embedded with 1 coat of Sikagard®-403 W @ 0.1m ² /litre per coat (wet on wet) | Choice of 2 top coats from the Standard Range as above [§] |

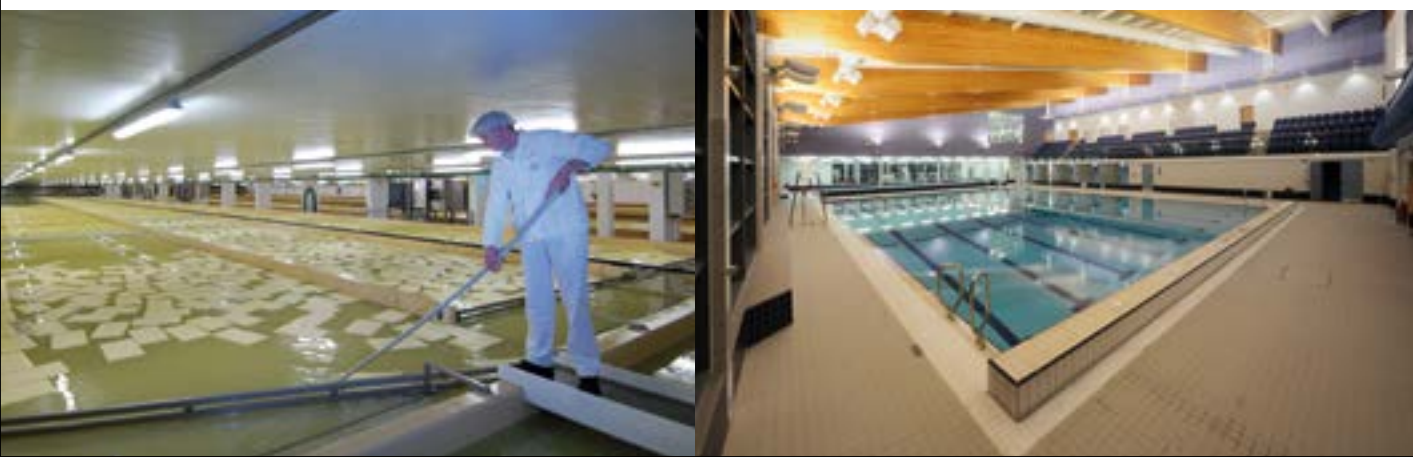

SIKA SOLUTIONS

PROTECTING CRITICAL CLEANROOM ENVIRONMENTS WITH LOW EMISSION SYSTEMS

In recent years Sika has developed advanced new flooring, wall and joint sealing solutions specifically for cleanroom environments. Manufacturing under cleanroom conditions is becoming increasingly widespread and ever more demanding with regards to VOC emissions, plus limiting AMC's (Airborne Molecular Contaminants) and particle emissions.



MORE VALUE, LESS IMPACT

Sika is dedicated to sustainable development, assuming responsibility to provide sustainable solutions in order to improve material, water and energy efficiency in construction and transportation. The company is committed to continuously measure, improve, report and communicate sustainable value creation. "More value, less impact" refers to Sika's commitment to maximise the value of the company's solutions and contributions to all stakeholders, while reducing risks and resource consumption along the whole supply chain and throughout the life span of its products. This is reflected in Sika's six strategic targets which focus on economic performance, sustainable solutions, local communities/society, energy, water/waste and occupational safety and are in line with the G4 of the Global Reporting Initiative (GRI G4). Further to this most companies within the Sika Group have been certified to ISO 9001, ISO 14001 & OHSAS 18001.

For more information on Sika and our products, or to discuss a current or forthcoming project with an Area Manager please call 01707 394444.

ULTRA LOW EMISSIONS

Good indoor air quality is vital, and can have a significant impact on health and resulting productivity. Building occupants can be exposed to a range of airborne pollutants, including chemicals, microorganisms and other particles from a variety of sources such as carpets, finishes, cleaning products, office equipment, etc. The various health implications associated with poor indoor air have been the subject of research for a long time and are well established. Design strategies that ensure good air quality, both by allowing a supply of fresh air through ventilation and stopping pollutants at source by

minimising emissions from materials, are essential for a healthy and productive working environment. With over 97% reduction in VOCs, Sikagard®-403 W, -405W and -406 W has an A+ rating, according to the Émissions dans l'air intérieur* labelling scheme, which is significantly ahead of any Europe-wide requirements.

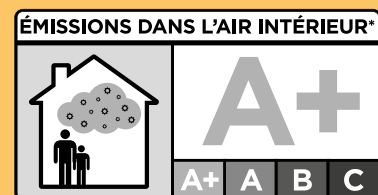

*Information représentative des émissions dans l'air intérieur des substances volatiles présentant un risque de toxicité par inhalation, sur une échelle de classe allant de C (fortes émissions) à A+ (très faibles émissions)



SIKA FULL RANGE SOLUTIONS FOR CONSTRUCTION:



WATERPROOFING



CONCRETE



REFURBISHMENT



MERCHANT



SEALING AND BONDING



FLOORING



ROOFING



INDUSTRY

FOR MORE Sikagard® INFORMATION:



WHO WE ARE

Sika Limited and Sika Ireland Limited are part of the global Sika Group, specialising in the manufacture and supply of chemical based products. Sika have a leading position in the development and production of systems and products for bonding, sealing, damping, reinforcing, and protecting in the building sector and the motor vehicle industry. Sika has subsidiaries in 93 countries around the world and manufactures in over 170 factories. With approximately 17,000 employees Sika generates annual sales of CHF 5.49 billion (£3.98bn). We are also committed to providing quality, service, safety and environmental care.

In the UK and Ireland, we provide market-leading solutions for concrete, waterproofing, roofing, flooring, refurbishment, sealing & bonding, and industry, and have manufacturing sites in Welwyn Garden City, Preston, Leeds and Dublin with more than 700 employees and a turnover of more than £130 million.

The information, and, in particular, the recommendations relating to the application and end use of Sika® products, are given in good faith based on Sika's current knowledge and experience of the products when properly stored, handled and applied under normal conditions. In practice, the differences in materials, substrates and actual site conditions are such that no warranty in respect of merchantability or of fitness for a particular purpose, nor any liability arising out of any legal relationship whatsoever, can be inferred either from this information, or from any written recommendations, or from any other advice offered. The proprietary rights of third parties must be observed. Please refer to our homepage www.sika.co.uk for our current standard terms & conditions applicable to all orders. Users should always refer to the most recent issue of the Product Data Sheet for the product concerned, copies of which will be supplied on request.



FM 12504



EMS 45308



OHS 585274

SIKA LIMITED

Head Office
Watchmead
Welwyn Garden City
Hertfordshire, AL7 1BQ
United Kingdom

Contact

Phone +44 1 707 394444
Fax +44 1 707 329129
E-Mail enquiries@uk.sika.com
www.sika.co.uk
@SikaLimited

SIKA IRELAND LIMITED

Sika House
Ballymun Industrial Estate
Dublin 11, D11 DA2V
Ireland

Contact

Phone +353 1 862 0709
Fax +353 1 862 0707
E-Mail info@ie.sika.com
www.sika.ie

BUILDING TRUST

