

CONNECT + CONTROL



Pegler Yorkshire



# XPRESS PRESS POWER TOOLS

CONNECT WITH CONFIDENCE

**XPress**





Pegler Yorkshire



# CONNECT WITH CONFIDENCE

With a wealth of expertise and the broadest range of solutions and systems on the market, Pegler Yorkshire's **Connect** products mean you'll complete your installation as seamlessly, efficiently and effectively as possible.

## TOTAL FUNCTIONALITY, COMPLETE EFFICIENCY

Pegler Yorkshire's range of **Connect** solutions offer innovatively designed, efficient and reliable products and systems that reduce installation time and cost without compromising quality, aesthetics or reliability.

Our **XPress** and **Tectite** product ranges are designed to perform faultlessly in a variety of applications and environments – so you can always be sure to connect with confidence whatever your challenge.

## GLOBAL EXPERIENCE, COMBINED EXPERTISE

With over 100 years of manufacturing and innovation combined with extensive industry knowledge and worldwide market experience, Pegler Yorkshire offers the most advanced and complete **Connect + Control** systems on a global scale.

As one of Britain's largest and most respected manufacturers and suppliers of products for the plumbing and heating industries, Pegler Yorkshire is confident we can provide you with all the connection, control and support your project needs.

For more information visit  
[www.pegler-yorkshire.co.uk](http://www.pegler-yorkshire.co.uk)





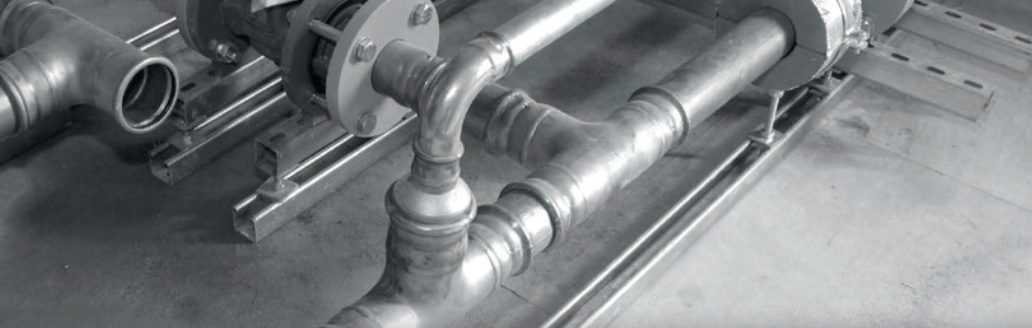

# XPress

CONNECT + CONTROL

## CONTENTS

Pegler Yorkshire is pleased to be associated with several influential industry organisations:



Association of Plumbing and Heating Contractors



The Bathroom Manufacturers Association



The UK Copper Board



Heating and Ventilating Contractors Association

**Brass**

The Brass Page for specifiers, designers, engineers and manufacturers



British Plumbing Employers Council



British Electrotechnical Allied Manufacturers Association



Construction Products Association



The Copper Development Association



Scottish and Northern Ireland Plumbing Employers Federation



Builders Merchants Federation



Institute of Plumbing



The UK District Energy Association



The Chartered Institution of Building Services Engineers



British Automatic Fire Sprinkler Association



Bundesverband Technischer Brandschutz e.V.



EUROPEAN FIRE SPRINKLER NETWORK  
European Fire Sprinkler Network

### POWER TOOLS

Tool/system compatibility

4-5

### PRESS TOOLING

Up to 35mm

6

Up to 54mm

7-8

Up to 108mm

9-12

Up to 168.3mm & Sprinkler applications

13

### ACCESSORIES

Batteries & chargers

14

### PRESS TOOL COMPATIBILITY

Press tools approved for pressing XPress

15-16

### INSTALLATION INSTRUCTIONS

Step by step process

17-21

Operating procedure

22-23

### TOOL/SYSTEM COMPATIBILITY

| Tool Type           | Material |            |              |            |               |          |            |
|---------------------|----------|------------|--------------|------------|---------------|----------|------------|
|                     | Copper   | Carbon     | Stainless    | Copper Gas | Stainless Gas | Solar    | Sprinkler  |
| ACO102<br>Battery   | 12-35mm  | 12-35mm    | 12-35mm      | 12-35mm    | 12-35mm       | 12-35mm  | 12-35mm    |
| ECO203<br>Mains     | 12-54mm  | 12-54mm    | 12-54mm      | 12-54mm    | 12-54mm       | 12-54mm  | 12-54mm    |
| ACO203<br>Battery   | 12-54mm  | 12-54mm    | 12-54mm      | 12-54mm    | 12-54mm       | 12-54mm  | 12-54mm    |
| ACO203XL<br>Battery | 12-108mm | 12-108mm   | 12-108mm     | 12-108mm   | 12-108mm      | 12-108mm | 12-54mm    |
| ECO301<br>Mains     | 12-108mm | 12-108mm   | 12-108mm     | 12-108mm   | 12-108mm      | 12-54mm  | 12-54mm    |
| ACO401<br>Battery   | -        | 76.1-108mm | 76.1-168.3mm | -          | 76.1-108mm    | -        | 76.1-108mm |

| Tool Type | Product             |                        |                        |                          |                          |                          |                              |                              |                             |                                |                          |                          |  |                          |                          |  |
|-----------|---------------------|------------------------|------------------------|--------------------------|--------------------------|--------------------------|------------------------------|------------------------------|-----------------------------|--------------------------------|--------------------------|--------------------------|--|--------------------------|--------------------------|--|
|           | S11 PB1<br>PB1 Jaws | S227<br>ECOTEC<br>Jaws | S327<br>ECO301<br>Jaws | S288<br>Snap On<br>Sling | S330<br>Snap On<br>Sling | S322<br>Cu Only<br>Sling | S323<br>Sling Set<br>139.7mm | S324<br>Sling Set<br>168.3mm | S410 HP<br>Snap On<br>Sling | S411 HP401<br>Snap On<br>Sling | S229<br>ZB203<br>Adaptor | S331<br>ZB323<br>Adaptor | S332<br>ZB324<br>Adaptor<br>(2nd<br>Press) | S329<br>ZB303<br>Adaptor | S231<br>ZB221<br>Adaptor | S232<br>ZB222<br>Adaptor<br>(2nd<br>Press) |
| ACO102    | 12-35mm             | -                      | -                      | -                        | -                        | -                        | -                            | -                            | -                           | -                              | -                        | -                        | -  | -                        | -                        | -  |
| ECO203    | -                   | 15-35mm                | -                      | 42-54mm                  | -                        | -                        | -                            | -                            | 35-54mm                     | -                              | 35-54mm                  | -                        | -  | -                        | -                        | -  |
| ACO203    | -                   | 15-35mm                | -                      | 42-54mm                  | -                        | -                        | -                            | -                            | 35-54mm                     | -                              | 35-54mm                  | -                        | -  | -                        | -                        | -  |
| ACO203XL  | -                   | 15-35mm                | -                      | 42-54mm                  | 66.7-108mm               | 108mm                    | -                            | -                            | 35-54mm                     | -                              | 35-54mm                  | -                        | -  | -                        | 66.7-<br>108mm           | 108mm                                      |
| ECO301    | -                   | -                      | 15-35mm                | 42-54mm                  | 66.7-108mm               | 108mm                    | -                            | -                            | 35-54mm                     | -                              | -                        | 66.7-<br>108mm           | 108mm                                      | 35-54mm                  | -                        | -  |
| ACO401    | -                   | -                      | -                      | -                        | -                        | *                        | 139.7mm                      | 168.3mm                      | ^                           | ^<br>76.1-108mm                | -                        | -                        | -  | -                        | -                        | -  |

\* Cu Only. ^ Not for Cu

|          | S351 203<br>42/54mm<br>Jaw & Sling Set | S352 301<br>76.1/88.9<br>Jaw & Sling Set | S352 301 108<br>Jaw & Sling Set        | S211 PB1 Jaw<br>Set 15-35mm | S227 ECOTEC<br>Jaw Set<br>15-35mm | S353 203XL<br>66.7-88.9 Sling +<br>Adaptor Set | S353 203XL 108<br>Sling &<br>Adaptor Set |
|----------|--|--|--|-----------------------------|-----------------------------------|--|--|
| ACO102   | -                                      | -  | -                                      | 15-35mm Jaws                | -                                 | -  | -  |
| ECO203   | 42-54mm Slings +<br>ZB203 Adaptor      | -  | -                                      | -                           | 15-35mm Jaws                      | -  | -  |
| ACO203   | 42-54mm Slings +<br>ZB203 Adaptor      | -  | -                                      | -                           | 15-35mm Jaws                      | -  | -  |
| ACO203XL | 42-54mm Slings +<br>ZB203 Adaptor      | -  | -                                      | -                           | 15-35mm Jaws                      | 66.7-88.9 Slings +<br>ZB221 Adaptor            | 108 Sling +<br>ZB222 Adaptor             |
| ECO301   | 42-54 Slings +<br>ZB203 Adaptor        | 76.1-88.9mm<br>Slings + ZB323<br>Adaptor | 108mm S330<br>Sling + ZB324<br>Adaptor | -                           | -                                 | -  | -  |
| ACO401   | -                                      | -  | -                                      | -                           | -                                 | -  | -  |

Pegler Yorkshire recommends the preferred XPress branded tooling for jointing XPress fitting Systems utilising the XPress Slings, Jaws and Tools. New and improved, they provide greater performance whilst being lighter and easier to handle. Incorporating an 'X' symbol, they provide an instant visual aid indicating the joint has been pressed using the preferred XPress tooling. The maintenance of tooling is critical to the joint integrity, therefore the installer should ensure the tools are maintained in accordance with the manufacturer's instructions and serviced by a recommended tool-hire service centre.

### ACO102



| Power  | Charging Time | Piston Force             | Piston Stroke | Item Code   |
|--|---------------|--------------------------|---------------|---|
| Battery 12V UPCR<br>Li-Ion 1.5/3.0Ah   | 60 min        | Max. 19kN                | 30mm          | 39195   |
| Compatible with XPress Systems   |               | Tool Dimensions          |               | Other   |
| Copper, Carbon Steel, Stainless Steel,<br>Copper Gas, Stainless Steel Gas<br>and Solar             |               | 350 x 62 x 80mm<br>1.7Kg |               | LED display for<br>battery status<br>and press error<br>indicator |
| Contains   |               |                          |               |   |
| S210 ACO102, 2 x Batteries, Battery Charger<br>Carry Case 480 x 350 x 110mm<br>Total Weight: 4.1Kg |               |                          |               |   |

### S211 PB1 Jaws

| Size | a   | b   | c  | Kg | Code  |
|------|-----|-----|----|----|-------|
| 12mm | 122 | 101 | 35 | 1  | 39191 |
| 15mm | 122 | 101 | 35 | 1  | 39188 |
| 18mm | 124 | 101 | 35 | 1  | 39189 |
| 22mm | 126 | 101 | 35 | 1  | 39202 |
| 28mm | 131 | 101 | 35 | 1  | 39203 |
| 35mm | 143 | 101 | 35 | 1  | 39209 |

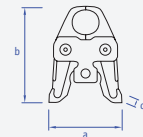

The full kit of 15-35mm jaws is available under product code 39065

### Domestic Tool Box 15-28mm

| Size    | Height | Width | Depth | Kg | Code  |
|---------|--------|-------|-------|----|-------|
| 15-28mm | 290    | 510   | 130   | 12 | 84727 |

#### Contains

Rems Mini Press Tool Acc + Spare Battery + Charger  
15-28mm Jaws + Installation accessories



## PRESS TOOLING UP TO 54mm

### ACO203



| Power  | Charging Time             | Piston Force | Piston Stroke  | Item Code |
|--|---------------------------|--------------|--|-----------|
| Battery 18V Li-Ion 1.5/3.0Ah   | 60 min                    | Max. 32kN    | 40mm   | 39201     |
| Compatible with XPress Systems   | Tool Dimensions           |              | Other  |           |
| Copper, Carbon Steel, Stainless Steel, Copper Gas, Stainless Steel Gas and Solar               | 408 x 80 x 125mm<br>3.3Kg |              | Visible electronic sensor for jaw locking bolt.<br>Contains electronic log book for analysis |           |
| Contains   |                           |              |  |           |
| S226 ACO203, 1 x Battery, Battery Charger, Carry Case 557 x 422 x 132mm<br>Total Weight: 7.9Kg |                           |              |  |           |

### S227 ECOTEC PB2 Jaws

| Size | a   | b   | c  | Kg | Code  |
|------|-----|-----|----|----|-------|
| 12mm | 143 | 110 | 39 | 2  | 39179 |
| 15mm | 143 | 110 | 39 | 2  | 39180 |
| 18mm | 143 | 110 | 39 | 2  | 39181 |
| 22mm | 147 | 110 | 39 | 2  | 39182 |
| 28mm | 147 | 110 | 39 | 2  | 39183 |
| 35mm | 154 | 110 | 39 | 2  | 39184 |

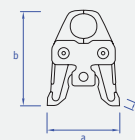

A full kit of ACO203 tool with the 15-35mm jaws is available under product code 39040

A full kit of 15-35mm jaws is available under product code 39068

### S228 Snap On sling

| Size | a   | b   | c  | Kg | Code  |
|------|-----|-----|----|----|-------|
| 42mm | 112 | 100 | 41 | 1  | 39186 |
| 54mm | 124 | 112 | 41 | 2  | 39187 |

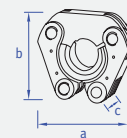

### S410 HP Snap On sling

Not suitable for copper \*For Sprinkler applications

| Size | a   | b   | c  | Kg | Code  |
|------|-----|-----|----|----|-------|
| 42mm | 125 | 120 | 41 | 2  | 39269 |
| 54mm | 125 | 122 | 41 | 2  | 39271 |

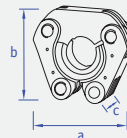

### S229 ZB203 Adaptor

| Size    | a   | b   | c  | Kg | Code  |
|---------|-----|-----|----|----|-------|
| 35-54mm | 142 | 124 | 33 | 1  | 39190 |

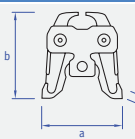

### S351 42-54mm Kit (S228 42 and 54mm Slings and ZB203 Adaptor)

| Size    | Height | Width | Depth | Kg | Code  |
|---------|--------|-------|-------|----|-------|
| 42-54mm | 355    | 410   | 110   | 5  | 39041 |



### ECO203



| Power  | Piston Force              | Piston Stroke | Item Code   |
|--|---------------------------|---------------|---|
| Mains 110V, 450W   | Max. 32kN                 | 40mm          | 39244   |
| Compatible with XPress Systems   | Tool Dimensions           |               | Other   |
| Copper, Carbon Steel, Stainless Steel, Copper Gas, Stainless Steel Gas and Solar | 430 x 75 x 111mm<br>3.9Kg |               | Visible electronic sensor for jaw locking bolt. Contains electronic log book for analysis |
| Contains   |                           |               |   |
| S225 ECO203<br>Carry Case 430 x 75 x 111mm<br>Total Weight: 5.5Kg                |                           |               |   |

### S227 ECOTEC PB2 Jaws

| Size | a   | b   | c  | Kg | Code  |
|------|-----|-----|----|----|-------|
| 12mm | 143 | 110 | 39 | 2  | 39179 |
| 15mm | 143 | 110 | 39 | 2  | 39180 |
| 18mm | 143 | 110 | 39 | 2  | 39181 |
| 22mm | 147 | 110 | 39 | 2  | 39182 |
| 28mm | 147 | 110 | 39 | 2  | 39183 |
| 35mm | 154 | 110 | 39 | 2  | 39184 |

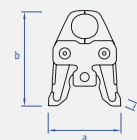

A full kit of 15-35mm jaws is available under product code 39068

### S228 Snap On sling

| Size | a   | b   | c  | Kg | Code  |
|------|-----|-----|----|----|-------|
| 42mm | 112 | 100 | 41 | 1  | 39186 |
| 54mm | 124 | 112 | 41 | 2  | 39187 |

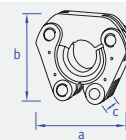

### S410 HP Snap On sling

Not suitable for copper \*For Sprinkler applications

| Size | a   | b   | c  | Kg | Code  |
|------|-----|-----|----|----|-------|
| 35mm | 112 | 100 | 41 | 2  | 39268 |
| 42mm | 125 | 120 | 41 | 2  | 39269 |
| 54mm | 125 | 122 | 41 | 2  | 39271 |

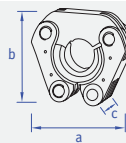

### S229 ZB203 Adaptor

| Size    | a   | b   | c  | Kg | Code  |
|---------|-----|-----|----|----|-------|
| 35-54mm | 142 | 124 | 33 | 1  | 39190 |

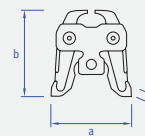

### S351 42 and 54mm Kit (S228 42 and 54mm Slings and ZB203 Adaptor)

| Size    | Height | Width | Depth | Kg | Code  |
|---------|--------|-------|-------|----|-------|
| 42-54mm | 355    | 410   | 110   | 5  | 39041 |





# PRESS TOOLING UP TO 108mm

## ACO203XL



| Power  | Charging Time | Piston Force              | Piston Stroke | Item Code  |
|--|---------------|---------------------------|---------------|--|
| Battery 18V Li-Ion<br>1.5/3.0Ah  | 60 min        | Max. 32kN                 | 40 or 80mm    | 39285  |
| Compatible with XPress Systems   |               | Tool Dimensions           |               | Other  |
| Copper, Carbon Steel, Stainless Steel,<br>Copper Gas, Stainless Steel Gas and<br>Solar                 |               | 487 x 79 x 116mm<br>4.6Kg |               | Visible electronic<br>sensor for jaw<br>locking bolt.<br>Contains<br>electronic log<br>book for analysis |
| Contains   |               |                           |               |  |
| S230 ACO202XL, 2 x Batteries, Battery Charger,<br>Carry Case 639 x 446 x 151mm<br>Total Weight: 10.6Kg |               |                           |               |  |

## S227 ECOTEC PB2 Jaws

| Size | a   | b   | c  | Kg | Code  |
|------|-----|-----|----|----|-------|
| 12mm | 143 | 110 | 39 | 2  | 39179 |
| 15mm | 143 | 110 | 39 | 2  | 39180 |
| 18mm | 143 | 110 | 39 | 2  | 39181 |
| 22mm | 147 | 110 | 39 | 2  | 39182 |
| 28mm | 147 | 110 | 39 | 2  | 39183 |
| 35mm | 154 | 110 | 39 | 2  | 39184 |

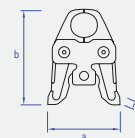

A full kit of 15-35mm jaws is available under product code 39068

## S228 Snap On sling

| Size | a   | b   | c  | Kg | Code  |
|------|-----|-----|----|----|-------|
| 42mm | 112 | 100 | 41 | 1  | 39186 |
| 54mm | 124 | 112 | 41 | 2  | 39187 |

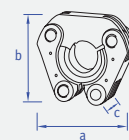

## S330 Snap On sling

| Size   | a   | b   | c  | Kg  | Code  |
|--------|-----|-----|----|-----|-------|
| 66.7mm | 151 | 143 | 61 | 4   | 39220 |
| 76.1mm | 164 | 155 | 61 | 4   | 39221 |
| 88.9mm | 175 | 167 | 55 | 4   | 39224 |
| 108mm  | 209 | 205 | 77 | 6.3 | 39225 |



66.7 - 88.9mm



108mm

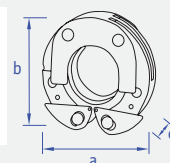

\*S330 in size 108mm is not suitable for copper, use S322

## S322 Sling (copper only)

| Size  | a   | b   | c  | Kg | Code  |
|-------|-----|-----|----|----|-------|
| 108mm | 200 | 200 | 60 | 5  | 39222 |

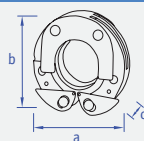

## S410 HP Snap On sling

Not suitable for copper

| Size | a   | b   | c  | Kg | Code  |
|------|-----|-----|----|----|-------|
| 35mm | 112 | 100 | 41 | 2  | 39268 |
| 42mm | 125 | 120 | 41 | 2  | 39269 |
| 54mm | 125 | 122 | 41 | 2  | 39271 |

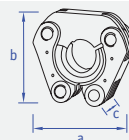

### ACO203XL continued

#### S229 ZB203 Adaptor

| Size    | a   | b   | c  | Kg | Code  |
|---------|-----|-----|----|----|-------|
| 35-54mm | 142 | 124 | 33 | 1  | 39190 |

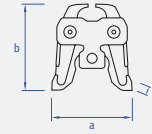

#### S231 ZB221 Adaptor

| Size       | a   | b   | c  | Kg | Code  |
|------------|-----|-----|----|----|-------|
| 66.7-108mm | 155 | 216 | 43 | 5  | 39286 |

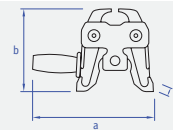

#### S232 ZB222 Adaptor (2nd press)

| Size  | a   | b   | c  | Kg | Code  |
|-------|-----|-----|----|----|-------|
| 108mm | 155 | 216 | 43 | 5  | 39287 |

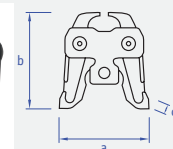

#### S351 42-54mm Kit (S228 42 and 54mm Slings and ZB203 Adaptor)

| Size    | Height | Width | Depth | Kg | Code  |
|---------|--------|-------|-------|----|-------|
| 42-54mm | 355    | 410   | 110   | 5  | 39041 |



#### S336 ACO203XL & Slings Kit (S330 66.7-108mm Slings and ZB221 and ZB222 Adaptors)

| Size       | Height | Width | Depth | Kg | Code  |
|------------|--------|-------|-------|----|-------|
| 66.7-108mm | 583    | 639   | 446   | 37 | 39240 |



#### S353 66.7-88.9mm Kit (S330 66.7-88.9mm Slings and ZB221 Adaptor)

| Size        | Height | Width | Depth | Kg | Code  |
|-------------|--------|-------|-------|----|-------|
| 66.7-88.9mm | 360    | 545   | 280   | 20 | 39045 |



#### S353 108mm Kit (S330 108mm Sling and ZB222 Adaptor)

| Size  | Height | Width | Depth | Kg | Code  |
|-------|--------|-------|-------|----|-------|
| 108mm | 360    | 545   | 280   | 14 | 39046 |



# PRESS TOOLING UP TO 108mm

## ECO301



| Power  | Piston Force              | Piston Stroke | Item Code  |
|--|---------------------------|---------------|--|
| Mains 110V, 560W   | Max. 45kN                 | 45mm          | 39199  |
| Compatible with XPress Systems   | Tool Dimensions           |               | Other  |
| Copper, Carbon Steel, Stainless Steel, Copper Gas, Stainless Steel Gas and Solar, Sprinkler ≤ 54mm Carbon Steel and Sprinkler ≤ 54mm Stainless Steel | 420 x 85 x 110mm<br>5.0Kg |               | Fast pressing cycle for quick installation.<br>Microprocessor driven for constant optimisation of pressing performance |
| Contains   |                           |               |  |
| S303 ECO301<br>Carry Case 639 x 466 x 151mm<br>Total Weight: 12.3Kg  |                           |               |  |

## S327 ECO301 PB3 Jaws

| Size | a   | b   | c  | Kg | Code  |
|------|-----|-----|----|----|-------|
| 12mm | 150 | 128 | 39 | 2  | 39194 |
| 15mm | 150 | 128 | 39 | 2  | 39204 |
| 18mm | 150 | 128 | 39 | 2  | 39205 |
| 22mm | 154 | 127 | 39 | 2  | 39206 |
| 28mm | 154 | 127 | 39 | 2  | 39207 |
| 35mm | 163 | 129 | 39 | 2  | 39208 |

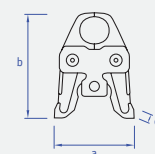

## S228 Snap On sling

| Size | a   | b   | c  | Kg | Code  |
|------|-----|-----|----|----|-------|
| 42mm | 112 | 100 | 41 | 1  | 39186 |
| 54mm | 124 | 112 | 41 | 2  | 39187 |

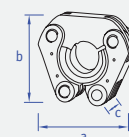

## S330 Snap On sling

| Size   | a   | b   | c  | Kg  | Code  |
|--------|-----|-----|----|-----|-------|
| 66.7mm | 151 | 143 | 61 | 4   | 39220 |
| 76.1mm | 164 | 155 | 61 | 4   | 39221 |
| 88.9mm | 175 | 167 | 55 | 4   | 39224 |
| 108mm  | 209 | 205 | 77 | 6.3 | 39225 |



66.7 - 88.9mm

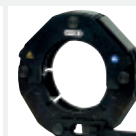

108mm

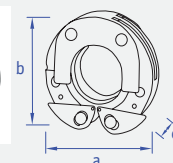

\*S330 in size 108mm is not suitable for copper, use S322

## S322 Sling (copper only)

| Size  | a   | b   | c  | Kg | Code  |
|-------|-----|-----|----|----|-------|
| 108mm | 200 | 200 | 60 | 5  | 39222 |

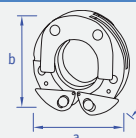

## S410 HP Snap On sling

Not suitable for copper

| Size | a   | b   | c  | Kg | Code  |
|------|-----|-----|----|----|-------|
| 35mm | 112 | 100 | 41 | 2  | 39268 |
| 42mm | 125 | 120 | 41 | 2  | 39269 |
| 54mm | 125 | 122 | 41 | 2  | 39271 |

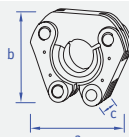

### ECO301 continued

#### S331 ZB323 Adaptor

| Size       | a   | b   | c  | Kg | Code  |
|------------|-----|-----|----|----|-------|
| 66.7-108mm | 136 | 195 | 43 | 4  | 39213 |

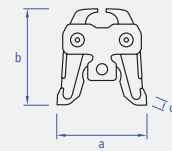

#### S332 ZB324 Adaptor (2nd Press)

| Size  | a   | b   | c  | Kg | Code  |
|-------|-----|-----|----|----|-------|
| 108mm | 136 | 188 | 53 | 4  | 39214 |

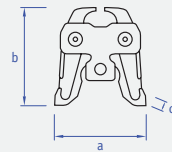

#### S329 ZB303 Adaptor

| Size    | a   | b   | c  | Kg | Code  |
|---------|-----|-----|----|----|-------|
| 35-54mm | 144 | 129 | 39 | 1  | 39227 |

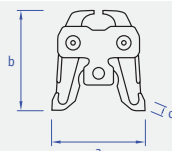

#### S352 76.1-88.9mm Kit (S330 76.1-88.9mm Slings and ZB324 Adaptor)

| Size        | Height | Width | Depth | Kg | Code  |
|-------------|--------|-------|-------|----|-------|
| 76.1-88.9mm | 355mm  | 470mm | 110mm | 14 | 39042 |



#### S352 108mm Kit (S330 108mm Sling and ZB324 Adaptor)

| Size  | Height | Width | Depth | Kg | Code  |
|-------|--------|-------|-------|----|-------|
| 108mm | 355mm  | 470mm | 110mm | 13 | 39043 |





## PRESS TOOLING UP TO 168.3mm & SPRINKLER APPLICATIONS

### ACO401



| Power   | Piston Force                | Piston Stroke | Item Code  |
|---|-----------------------------|---------------|--|
| Battery 18V Li-Ion  | Max. 100kN                  | 60mm          | 39267  |
| Compatible with XPress Systems  | Tool Dimensions             |               | Other  |
| Sprinkler; Carbon Steel and Sprinkler;<br>Stainless Steel in sizes 76.1 – 168mm | 660 x 100 x 250mm<br>13.0Kg |               | Microprocessor<br>driven for constant<br>optimisation of<br>pressing performance |
| Contains  |                             |               |  |
| S400 ACO401<br>Carry Case 630 x 130 x 465mm<br>Total Weight: 25Kg               |                             |               |  |

## LARGE SIZE APPLICATION

### S323 Sling Set 139.7mm

| Size    | a   | b   | c   | Kg | Code  |
|---------|-----|-----|-----|----|-------|
| 139.7mm | 250 | 250 | 110 | 10 | 39038 |

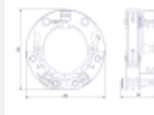

NEW

### S324 Sling Set 168.3mm

| Size    | a   | b   | c   | Kg | Code  |
|---------|-----|-----|-----|----|-------|
| 168.3mm | 283 | 277 | 111 | 12 | 39039 |

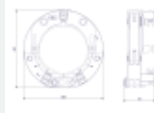

NEW

## SPRINKLER SYSTEM APPLICATION

### S411 HP401 Snap On Sling

Not suitable for copper

| Size   | a   | b   | c   | Kg  | Code  |
|--------|-----|-----|-----|-----|-------|
| 76.1mm | 290 | 400 | 100 | 7.8 | 39273 |
| 88.9mm | 290 | 400 | 100 | 8.4 | 39277 |
| 108mm  | 290 | 400 | 100 | 9.4 | 39279 |



All 108mm fittings, regardless of material, require a 2nd press using the respective adaptor, with the exclusion of the S400 ACO401 as this is supplied with an internal adaptor.

### BATTERIES

#### S340 ACO102 Battery

| Size             | Code  |
|------------------|-------|
| Li-Ion 12V 1.5Ah | 39288 |
| Li-Ion 12V 3Ah   | 39289 |

S340 – for use with ACO102 tool

#### S342 ACO203 Battery 203XL 401

| Size      | Code  |
|-----------|-------|
| 18V 1.5Ah | 39292 |
| 18V 3Ah   | 39293 |

S342 – for use with ACO203/203XL/401 tools. ACO203XL and ACO401 must use the 3.0Ah battery.

### CHARGERS

#### S341 ACO102 Charger

| Size           | Code  |
|----------------|-------|
| 12V (220-240v) | 39290 |

#### S343 ACO203/401 Charger 203XL

| Size | Code  |
|------|-------|
| 230V | 39291 |

#### SS110 Depth gauge

Suitable for copper



| Size       | Code  |
|------------|-------|
| 12 - 108mm | 39173 |

#### S122 Copper tube preparation kit



| Size      | Code  |
|-----------|-------|
| 35 - 54mm | 39233 |

#### S120 Deburring tool



| Size      | Code  |
|-----------|-------|
| 12 - 54mm | 39168 |

#### S115 Tube stripper

For use with SC660 tube



| Size      | Code  |
|-----------|-------|
| 15mm      | 39260 |
| 18mm      | 39261 |
| 22mm      | 39262 |
| 28mm      | 39263 |
| 35 - 54mm | 39264 |

#### SS111 Depth gauge

Suitable for carbon and stainless steel



| Size       | Code  |
|------------|-------|
| 12 - 108mm | 39174 |

#### S135 Dri-slide lubricant

For use with jaws and slings only



| Size  | Code  |
|-------|-------|
| 115ml | 39169 |

# PRESS TOOL COMPATIBILITY

| PRESS TOOLS APPROVED FOR PRESSING XPRESS |              |   |   |                   |                                    |                                 |
|--|--------------|---|---|-------------------|------------------------------------|---------------------------------|
| Dimension (mm)                           | Manufacturer | Press Tool  | Systems   | Jaws (up to 35mm) | Sling Jaw adaptor (42mm and above) | Sling (Copper Stainless/Carbon) |
| 12 - 35mm                                | REMS         | REM-578012 Mini-Press ACC Battery powered (14.4V) | -   | Mini M12 - M35*   | -                                  | -                               |
| 1 - 54mm                                 | REMS         | REM-571013 Akku-Press Battery powered (14.4V)     | -   | M12 - M35*        | Z2                                 | M42 (PR-3S) M54 (PR-3S)         |
|  |              | REM-571014 Akku-Press ACC Battery powered (14.4V) | -   | M12 - M35*        | Z3                                 | M42 (PR-3S) M54 (PR-3S)         |
|  |              | REM-577011 Power-Press                            | -   | M12 - M35*        | Z3                                 | M42 (PR-3S) M54 (PR-3S)         |
|  |              | REM-572110 Power-Press E                          | -   | M12 - M35*        | Z3                                 | M42 (PR-3S) M54 (PR-3S)         |
|  |              | REM-577010 Power-Press ACC                        | -   | M12 - M35*        | Z3                                 | M42 (PR-3S) M54 (PR-3S)         |
| 12 - 28mm                                | Novopress    | AFP101 Battery powered (9.6V)                     | -   | PB1               | -                                  | -                               |
|  |              | ACO102 Battery powered (12V)                      | -   | PB1               | -                                  | -                               |
| 12 - 54mm                                | Novopress    | EFP2 (230V)                                       | -   | PB2 (ECOTEC)      | ZB201/ZB203                        | 35 (HP only) / 42 / 54**        |
|  |              | EFP201 / 202 / (230V)                             | -   | PB2 (ECOTEC)      | ZB201/ZB203                        | 35 (HP only) / 42 / 54**        |
|  |              | AFP201 / 202 (14.4V)                              | -   | PB2 (ECOTEC)      | ZB201/ZB203                        | 35 (HP only) / 42 / 54**        |
|  |              | ECO203  | -   | PB2 (ECOTEC)      | ZB201/ZB203                        | 35 (HP only) / 42 / 54**        |
|  |              | ACO203  | -   | PB2 (ECOTEC)      | ZB201/ZB203                        | 35 (HP only) / 42 / 54**        |
| 12 - 54mm                                | Novopress    | ACO203XL  | -   | PB2 (ECOTEC)      | ZB201/ZB203                        | 35 (HP only) / 42 / 54**        |
|  |              | ECO301  | -   | PB3 (ECO301)      | ZB303                              | 35 (HP only) / 42 / 54**        |
| 66.7mm                                   | Novopress    | ACO203XL  | -   | -                 | ZB221                              | 66.7mm Sling***                 |
|  |              | ECO301  | -   | -                 | ZB323                              | 66.7mm Sling***                 |
| 76.1 - 108mm                             | Novopress    | ACO203XL  | -   | -                 | ZB221                              | 76.1 / 88.9 / 108               |
|  |              | ECO301  | -   | -                 | ZB323                              | 76.1 / 88.9 / 108               |
| 108mm (2nd)                              | Novopress    | ACO203XL  | -   | -                 | ZB222                              | Snap On Sling (Copper specific) |
|  |              | ECO301  | -   | -                 | ZB324                              | Snap On Sling (Copper specific) |
| 76.1 - 168.3mm                           | Novopress    | ACO401  | Carbon / Stainless / Sprinkler only   | -                 | Integral adaptor on machine        | HP401 Snap On Sling             |
| 15 - 54mm                                | Ridgid       | RP 340  | Not approved with Ridgid jaws - only with compatible Novopress / REMS jaws and slings |                   |                                    |                                 |

\*For 18 and 28mm, only use jaws with marking '108' (Q1,2008) or '208' (Q2 2008) and higher.

\*\*HP Snap On Sling for Stainless / Carbon applications only.

\*\*\*See page 16 for guidance on pressing 66.7mm fittings.

All 108mm fittings require a 2nd press using the respective adaptor. Copper uses the S322 copper only sling.

### \*66.7mm (67mm) Sling (S330 Snap On sling)

Novopress offers alternative slings for use on different press systems. As such Pegler Yorkshire reinforces the following instruction.

Where 66.7mm slings are required for crimping XPress fittings, installers must only use the following XPress/Novopress slings and adaptors:

| Novopress Reference | Sling Marking   | Novopress Adaptor |
|---------------------|-----------------|-------------------|
| 36516-50            | "Woeste" 67mm   | ZB302 42-66.7mm   |
| 45184-50            | "XPress" 66.7mm | ZB323 66.7-108mm  |

Under no circumstances should any other brand of sling be used with our 66.7mm fittings as these will lead to an incorrect crimp resulting in an immediate joint failure and invalidate the Pegler Yorkshire warranty.

XPress 66.7mm fittings that have inadvertently been crimped with the wrong brand of sling cannot be successfully re-crimped with the XPress 66.7 sling and will unfortunately have to be cut out and replaced with a new fitting using the correct sling.

Note: Pegler Yorkshire 66.7mm will be referred to as 66.7mm and/or 67mm.



### POWER SUPPLY

It is essential when preparing to undertake an installation using XPress fittings and tools that a suitable constant power source is available. If the supply of power is not constant it may affect the performance of the joint.

Checking the power source is particularly important prior to joining with the ECO203 and ECO301 tool as it includes safety software, which detects the amount of power available to the machine. If there is not enough for the tool to initiate the pressing cycle and complete a sound joint the tool will not commence the pressing operation. This feature is particularly useful when installing large size press fittings, as the pressure required to press these fittings is significantly greater than for smaller fittings, hence the power supply to the tool must be guaranteed.

It is therefore recommended that when using a portable transformer to provide power to the press tool, the transformer should be a minimum of 3KVA rated in order that a continuous uninterrupted power supply is always available.

When a semi-permanent source of power such as a generator is being used it is essential the plant is well maintained. The maximum cable size from generator to outlet and the minimum length of cable between the power outlet and the tool should be used.



# XPRESS INSTALLATION INSTRUCTIONS FOR SIZES UP TO 108mm

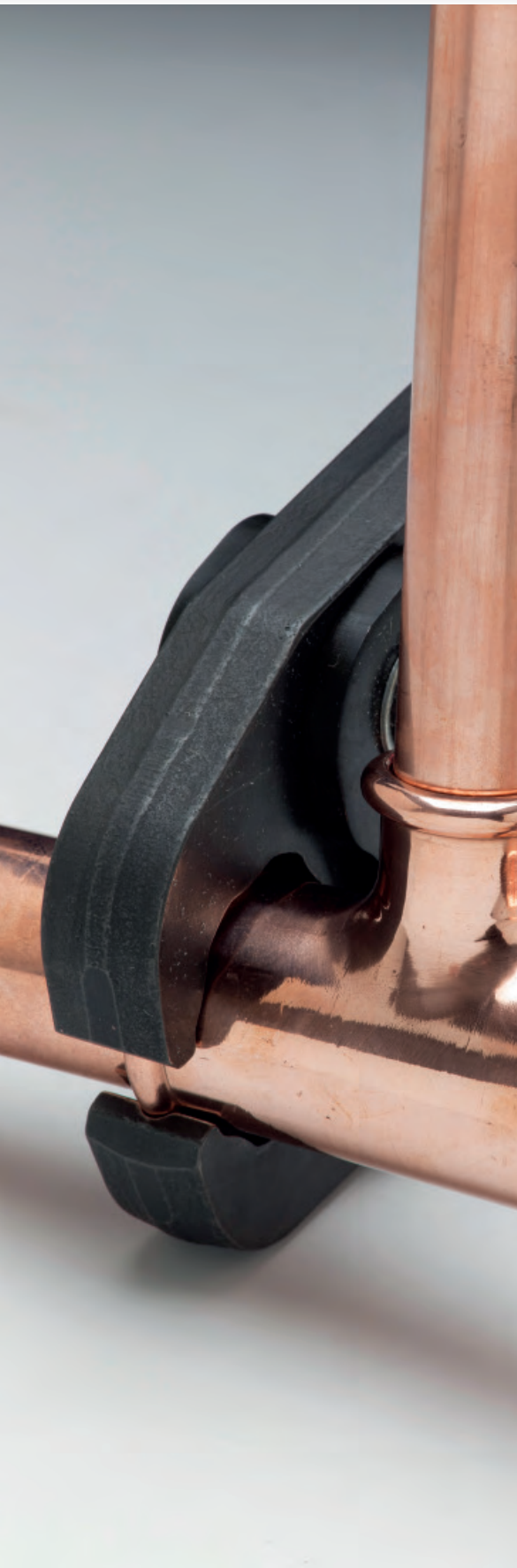

Select the correct size of tube and fitting for the job. Ensure that both are clean, in good condition and free from damage and imperfections.



## 1. CHECK THE FITTING

Keep all fittings in their bag prior to installation to ensure the lubrication does not dry out. Ensure the "O" ring is seated correctly within the fitting socket.

## 2. CUT THE TUBE SQUARE:

It is essential to cut the tube square using a rotary tube cutter. Pegler Yorkshire recommends using a Rems Cento with the correct cutter wheel for the specific material being cut.



**NOTE: The tube must always be cut completely. Never partially cut and then broken as this could cause corrosion. Do not use a hacksaw, oil cooled saws, abrasive wheels or flame cutting.**

## ACCEPTABLE METHODS OF CUTTING TUBE INCLUDE:

Rotary tube cutter.

Rems Cento.

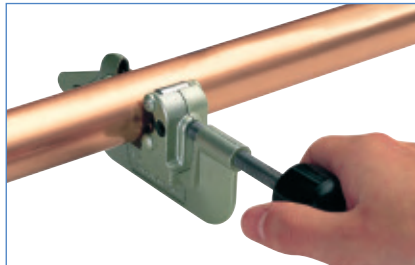

**NOTE: Use TC155 for cutting carbon steel tube.**

### 3. DEBURR AND CHECK THE TUBE ENDS:

Both the internal and external tube ends should be deburred then wiped clean of all swarf and debris to avoid damage to the "O" ring upon tube insertion. Also check that the tube end is clean and free from damage such as scores, tape, labels or adhesive residue.

#### ACCEPTABLE METHODS OF DEBURRING INCLUDE:

S120 - 15 to 54mm internal and external.

S122 - 15 to 54mm external only but can re-round damaged tube. Use on copper only.



TC150: 15 to 22mm external only, very good for carbon steel tube. TC143 and TC147 internal only.

Hand file.



**NOTE: If using plastic coated carbon steel system tube the plastic coating must be removed from the socket depth of the fitting using the S115 stripping tool from the XPress accessories range.**



Use the S115 Tube stripper for removing the plastic from plastic coated carbon steel tube.

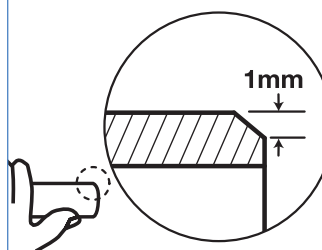

Having deburred as above you will be left with a 1mm chamfer on the outside of the tube as indicated in the diagram. Wipe clean the tube end of remove all swarf and debris.

### 4. MARK THE SOCKET DEPTH:

Ensuring full socket depth is achieved is vital for the integrity of the joint. To check that the tube and fitting remains in the correct position throughout the pressing process you must mark the socket depth with a 'V-Tail' mark.



S110 - Orange socket depth tool for copper tube



S111 - Blue socket depth tool for carbon and stainless steel tube



By hand

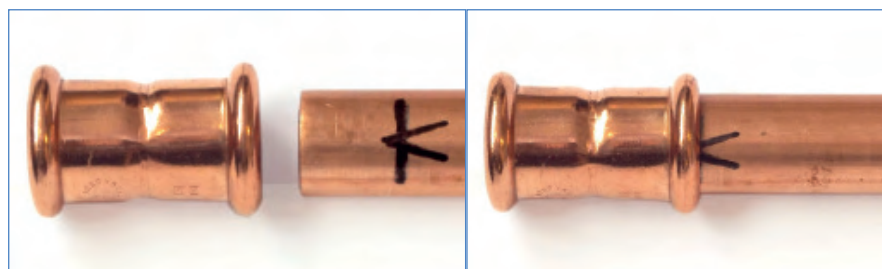

| Size                      | Depth |
|---------------------------|-------|
| 12mm                      | 17mm  |
| 15mm                      | 20mm  |
| 18mm                      | 20mm  |
| 22mm                      | 21mm  |
| 28mm                      | 23mm  |
| 35mm                      | 26mm  |
| 42mm                      | 30mm  |
| 54mm                      | 35mm  |
| 66.7mm                    | 50mm  |
| 76.9mm (Copper)           | 50mm  |
| 76.9mm (Stainless/Carbon) | 55mm  |
| 88.9mm                    | 64mm  |
| 108mm (Copper)            | 64mm  |
| 108mm (Stainless/Carbon)  | 78mm  |

# XPRESS INSTALLATION INSTRUCTIONS

## 5. ASSEMBLE THE JOINT:

Insert the tube into the fitting until it meets the tube stop, using the insertion depth mark as a visual aid.

Only when the tube reaches the tube stop should the pressing operation be commenced.

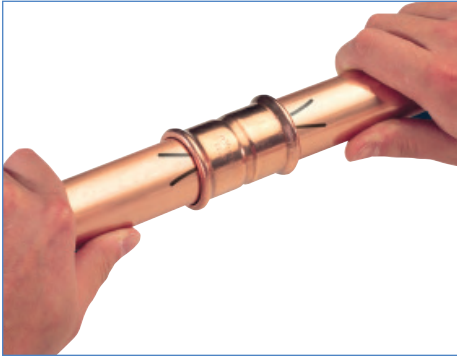

## 7. DRI-SLIDE LUBRICANT

Use of S135 Dri-Slide lubricant is essential when jointing large sized fittings. The pressing profile groove of the sling jaws should be cleaned and lubricated after every 50 joints for 42mm to 76.1mm sizes, and every 5 joints for 108mm. Dri-Slide should also be applied between the main sling arms and the moving segments; and along the pivot pins between the arms. Wipe clean any excess lubricant so that it does not come into contact with the fitting "O" ring.

**NOTE:** Dri-Slide lubricant should never be used to lubricate the "O" ring.

## 6. PREPARE THE PRESS-FIT TOOL:

Select the correct combination of press-tool, jaws, slings and adaptors for the joint being made.

See notes on page 5 regarding 67mm slings and copper only slings at 108mm.



**NOTE:** Always refer to the manufacturer's instructions for detailed information on how to operate your press-tool safely.



**NOTE:** Check that the press tool and relevant jaws/slides have been maintained in accordance with their servicing/calibration schedule.

Make the tool safe by isolating it from the power supply. Select the correct jaws/sling jaws/sling jaw adaptor for the joint being made, checking that they are free from damage. Attach the jaws/sling jaws/sling jaw adaptor to your press-tool, following the instructions for your particular press-tool, and reconnect the power supply when ready.



### 8. PRESS THE JOINT:

Mount the jaws/sling jaws over the bead at the mouth of the fitting. With the tool fully supported and not hanging from the pipework, and with your hands safely away from the joint, press the trigger or button to start the jointing cycle. When the jaws/sling jaws fully enclose the mouth of the fitting, the joint is complete. The jaw should then be released from around the fitting.



15 to 35mm.

Pegler Yorkshire recommend the use of Sling Jaws for sizes 42 to 108mm.



- ⚠ **NOTE: The 108mm joint is not fully made until the fitting has been through two pressing operations.**
- ⚠ **NOTE: Maintain a 90° angle between the tube and jaws at all times, this is to ensure the integrity of the joint as well as protect the operator from 'kickback'.**
- ⚠ **NOTE: The pressing operation should only be carried out when the tube is adequately supported by brackets, not when the tube is suspended in the fitting socket alone.**
- ⚠ **NOTE: Allow press-fit jaws to be attached without hindrance.**

### 9. CHECK THE JOINT:

Inspect the finished joint making sure all is in order, when satisfied the joint has been made correctly mark the joint as complete.

- ✚ The socket depth mark you made indicates that full socket depth has been maintained throughout the pressing cycle.
- ✚ The fitting and pipe bear the witness marks from your jaws/sling jaws.
- ✚ We recommend all systems are thoroughly pressure tested before hand over to end user.



## XPRESS INSTALLATION INSTRUCTIONS FOR SIZES 139.7 - 168.3

Remove the fitting from its packaging and check the fitting and "O" ring for any damage or debris.

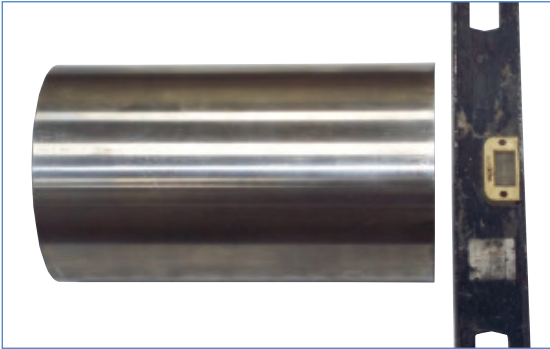

**1.** Cut tube square to the required length using a fine tooth electric saw and deburr the outer and inner end in order to prevent any damage to the "O" ring.



**2.** Measure and mark required depth on the tube using a tape measure and marker pen.



**3.** Add a 'V' to the mark.  
NB: Depth for 139.7mm fitting is 100mm.  
Depth for 168.3mm fitting is 121mm.

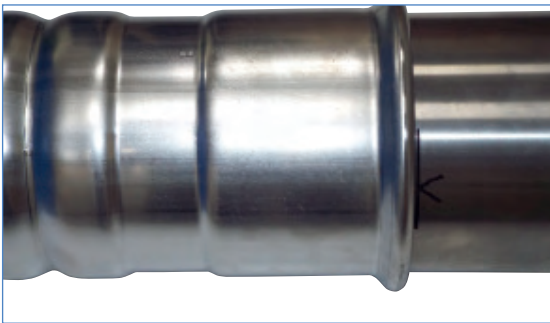

**4.** Insert the tube into the fitting until it meets the fitting stop and check that the line and 'V' marking is visible.  
Refer to the XPress Tooling Operating Procedure on page 15 of XPress Press-fit systems, for large application.

Please see the Pegler Yorkshire website for full installation training video

5. Check the press machine and pressing collar for any signs of damage. If any of these components appear to be damaged, do not continue with the pressing procedure. Be sure to check the tool is within calibration date.

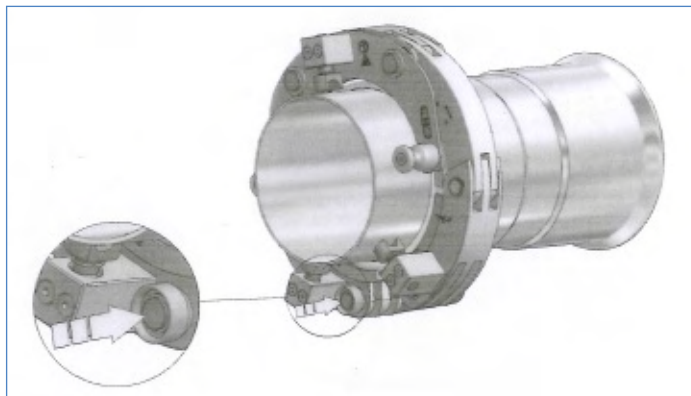
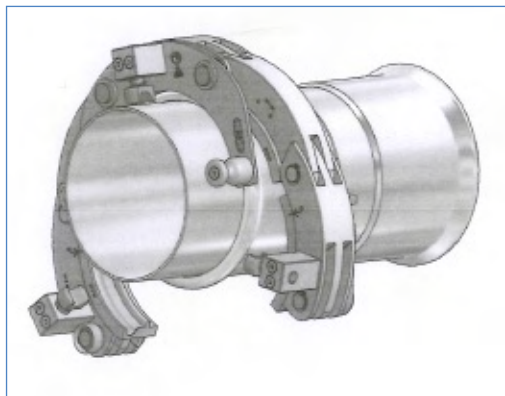

6. Open the collar and place it on the bead of the fitting (the collar joints are spring pre-loaded). Make sure that the wheels are positioned on the tube side of the fitting.

7. Close the collar and press the lock button.

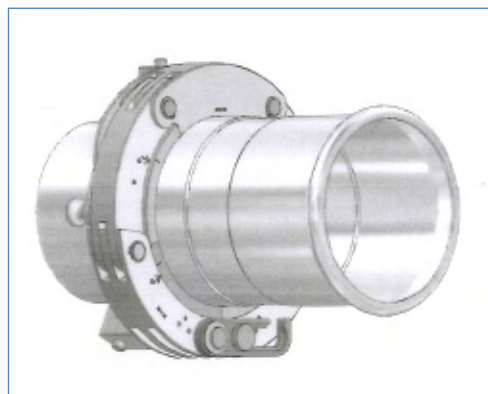
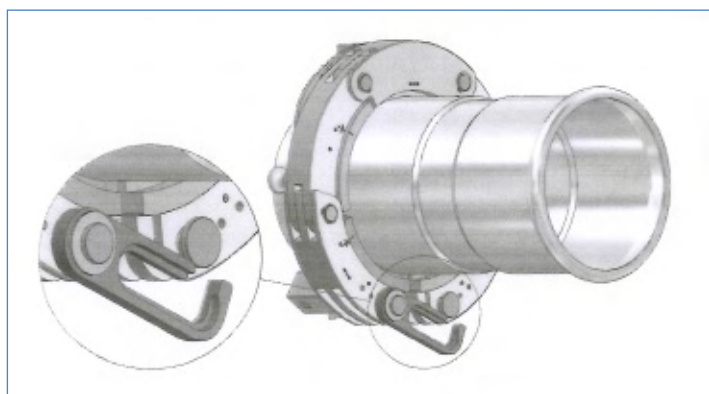

8. Attach the press tool to the mouth of the fitting - use the handle at the top of the press tool to open the jaws on the adaptor. Swivel the catch inwards and secure the lock. The claws of the adaptor jaw must be firmly gripped onto the press collar.

9. Perform pressing operation 1, release the catch and remove the collar. Inspect the finished joint. There will be visible witness marks from your press slings.

### DRI-SLIDE LUBRICANT

Use of S135 Dri-Slide lubricant is essential when jointing large sizes only. The pressing profile groove of the sling jaws should be cleaned and lubricated after every 5 joints.



**NOTE:** Dri-Slide lubricant should never be used to lubricate the "O" ring.



## XPRESS TOOLING OPERATING PROCEDURE FOR SIZES 139.7 - 168.3

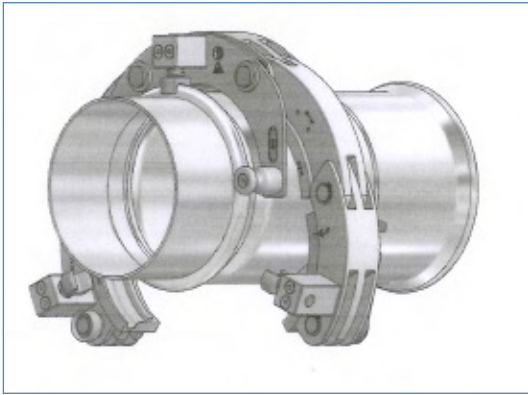

**10.** Open the mouth of the sling and slide the sling down the fitting until the wheel guides are sitting against the end socket of the fitting.

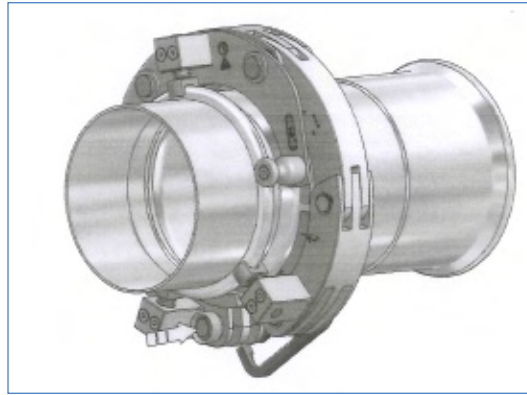

**11.** Close the collar, press the lock button, swivel the catch inwards and secure the lock.

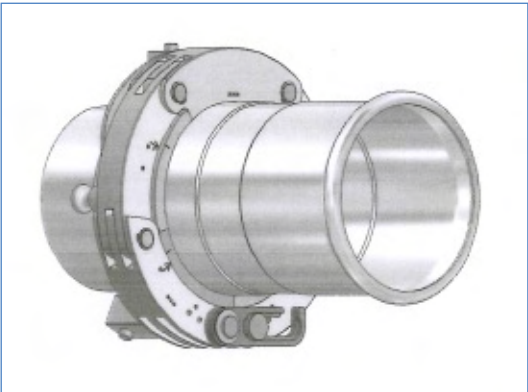

**12.** Attach the press tool to the mouth of the fitting- use the handle at the top of the press tool to open the jaws on the adapter. The claws of the adapter jaw must be firmly gripped onto the press colour. Perform pressing operation 2.

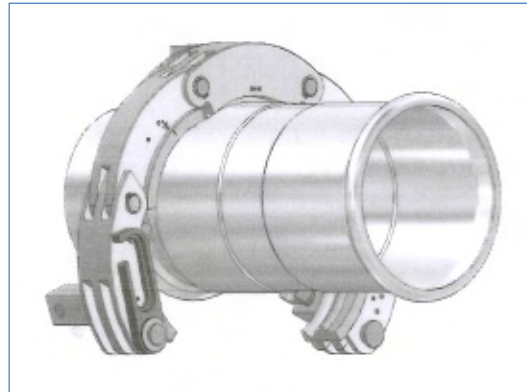

**13.** Open the lock, swivel the catch away, open the collar and remove it from the fitting.

### **14. CHECK THE JOINT:**

Inspect the finished joint making sure all is in order, when satisfied the joint has been made correctly mark the joint as complete.

- ✚ The socket depth mark you made indicates that full socket depth has been maintained throughout the pressing cycle.
- ✚ The fitting and pipe bear the witness marks from your jaws/sling jaws.
- ✚ We recommend all systems are thoroughly pressure tested before hand over to end user.



# Pegler Yorkshire

Follow us on



CONNECT  CONTROL

## UK ENQUIRIES

### UK SALES

Free Phone: 0800 156 0010

Free Fax: 0808 156 1011

Email: [uk.sales@pegler-yorkshire.co.uk](mailto:uk.sales@pegler-yorkshire.co.uk)

### TECHNICAL HELP

Free Phone: 0800 156 0050

Free Fax: 0808 156 1012

Email: [tech.help@pegler-yorkshire.co.uk](mailto:tech.help@pegler-yorkshire.co.uk)

### BROCHURE HOTLINE

Free Phone: 0800 156 0020

Free Fax: 0808 156 1011

Email: [info@pegler-yorkshire.co.uk](mailto:info@pegler-yorkshire.co.uk)

## INTERNATIONAL ENQUIRIES

### EXPORT

Tel: +44 (0) 1302 855 656

Fax: +44 (0) 1302 730 513

Email: [export@pegler-yorkshire.co.uk](mailto:export@pegler-yorkshire.co.uk)

**Tectite**

**XPress**

**Terrier**

**Ballorex**

**Pegler**

**Prestex**

**Yorkshire**

**Endex**

**Kuterlite**

**Francis Pegler**

**Performa**

## HEAD OFFICE

### Pegler Yorkshire Group Limited

St. Catherine's Avenue, Doncaster,  
South Yorkshire DN4 8DF, England

Tel: +44 (0) 1302 560 560

Fax: +44 (0) 1302 560 203

Email: [info@pegler-yorkshire.co.uk](mailto:info@pegler-yorkshire.co.uk)

[www.pegler-yorkshire.co.uk](http://www.pegler-yorkshire.co.uk)

Registered in England Company No. 00401507

Registered Office: St. Catherine's Avenue,  
Doncaster, South Yorkshire DN4 8DF, England

All brand names and logo styles are registered trademarks. Maintaining a policy of continual product development, Pegler Yorkshire reserves the right to change specifications, design and materials of products listed in this publication without prior notice.

LIT. REF:880177.04.17