



HEATING VALVES

MYSON have over 45 years' experience in manufacturing high quality heating valves. We produce millions of valves each year from our recently developed valve specification factory in Newcastle West, Ireland. From neat, cost-effective manual valves, right through to thermostatically controlled valves and decorative options, we have a solution for any application.

Our range of valves includes innovative products, such as the A-rated TRV 2-WAY, as well as a complete range of pushfit valves. We have a range of attractive manual and thermostatically controlled decorative valves, perfect for when you need that extra special finishing touch. We also offer valves specifically designed for use with our LSTs.

All MYSON valves are produced under ISO 9001:2008, so whichever of our products you choose, you are guaranteed it will be the highest quality.



MATCHMATE

The MATCHMATE range of radiator valves is ideal for use within central heating systems in the domestic housing market. They are available in a number of different models, including straight and angled, to suit varying specification requirements. All products feature impact resistant valve caps, providing highest quality at competitive prices. Drain off option also available on most products.

GENERAL SPECIFICATION



CERTIFICATION

Produced under a quality management system - ISO 9001:2008. Pressure tested in accordance with BS 2767.



GUARANTEE

2 year guarantee from date of purchase against manufacturing defects.



COLOUR

Finished in nickel or brass.



CONNECTIONS

Compression or pushfit.



OPERATING PRESSURES

Tested to a maximum pressure of 10 bar (compression), 3 bar (pushfit).



OPERATING TEMPERATURE

Maximum 120°C (compression), 92°C (pushfit).



DELIVERY

2 - 5 working days.

For more general information, please see page 276.

DIMENSIONS

Wheel Head

8/10/15mm Angle

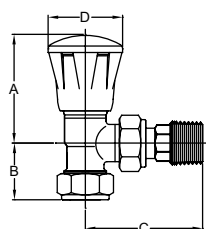

15mm Straight

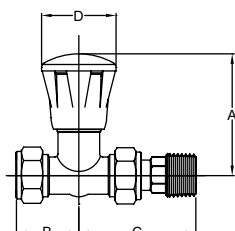

Model	A (mm)	B (mm)	C (mm)	D (mm)
8/10/15mm Angle	54.0	28.0	58.0	37.0
15mm Straight	60.5	30.5	58.0	37.0

Lockshield

8/10/15mm Angle with Drain Off

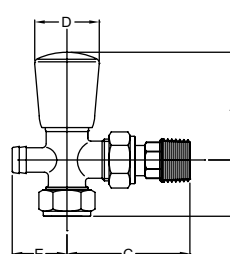

15mm Straight

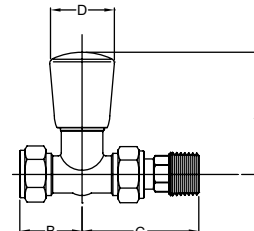

Model	A (mm)	B (mm)	C (mm)	D (mm)	E (mm)
8/10/15mm Angle/Drain	54.0	28.0	58.0	32.2	28.0
15mm Straight	60.5	30.5	58.0	32.2	-

NB: All measurements are nominal.



MM10LANDPF90

MM10LANPF90



MATCHMATE

Description	Metal Finish	Wheel Head Order Code	Lockshield Order Code	Minimum Order Qty
8mm Angle	Nickel	MM8WAN	MM8LAN	10
8mm Angle with Drain Off	Nickel	-	MM8LAND	10
10mm Angle	Brass	MM10WAB	MM10LAB	10
10mm Angle with Drain Off	Brass	-	MM10LABD	10
10mm Angle	Nickel	MM10WAN	MM10LAN	10
10mm Angle with Drain Off	Nickel	-	MM10LAND	10
15mm Angle	Brass	MM15WAB	MM15LAB	10
15mm Angle with Drain Off	Brass	-	MM15LABD	10
15mm Angle	Nickel	MM15WAN	MM15LAN	10
15mm Angle with Drain Off	Nickel	-	MM15LAND	10
15mm Straight	Nickel	MM15WSN	MM15LSN	10
10mm (90° Comp Elbow) Angle	Nickel	MM10WAN90	MM10LAN90	20
10mm (90° Comp Elbow) Angle with Drain Off	Nickel	-	MM10LAND90	20
Wheelhead Valve Top Only	White Plastic	MMTOPWH	-	20
Lockshield Valve Top Only	White Plastic	-	MMTOPLS	20

MATCHMATE PUSHFIT



10mm Angle	Nickel	MM10WANPF	MM10LANPF	20
10mm Angle with Drain Off	Nickel	-	MM10LANDPF	20
10mm (90° Pushfit Elbow) Angle	Nickel	MM10WANPF90	MM10LANPF90	20
10mm (90° Pushfit Elbow) Angle with Drain Off	Nickel	-	MM10LANDPF90	20
10mm Straight	Nickel	MM10WSNPF	MM10LSNPF	20
15mm Angle	Nickel	MM15WANPF	MM15LANPF	20
15mm (90° Pushfit Elbow) Angle	Nickel	MM15WANPF90	MM15LANPF90	20
15mm (90° Pushfit Elbow) Angle with Drain Off	Nickel	-	MM15LANDPF90	20



MR10WAC

MATCHMASTER

MATCHMASTER is a high quality range of heating valves ideal for when a more robust specification is required. The valve uses a graphite gland packing which can be easily compressed by tightening the gland nut to ensure many years of trouble free operation. There is a wide choice of compression, pushfit and screwed iron connections, as well as drain off options. Straight and angled options are also available.

GENERAL SPECIFICATION



CERTIFICATION

Produced under a quality management system - ISO 9001:2008. Conforms to BS 2767-10.



GUARANTEE

2 year guarantee from date of purchase against manufacturing defects.



COLOUR

Finished in chrome or brass.



CONNECTIONS

Compression, pushfit and screwed iron.



OPERATING PRESSURES

Tested to a maximum pressure of 10 bar (compression and screwed iron), 3 bar (pushfit).



OPERATING TEMPERATURE

Maximum 120°C (compression and screwed iron), 92°C (pushfit).



DELIVERY

2 - 5 working days.

For more general information, please see page 276.

DIMENSIONS

Wheel Head

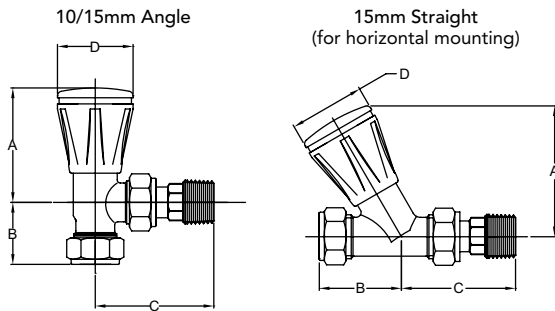

Model	A (mm)	B (mm)	C (mm)	D (mm)
10/15mm Angle	55.7	31.0	58.0	37.0
15mm Straight	63.5	40.0	56.5	37.0



Lockshield

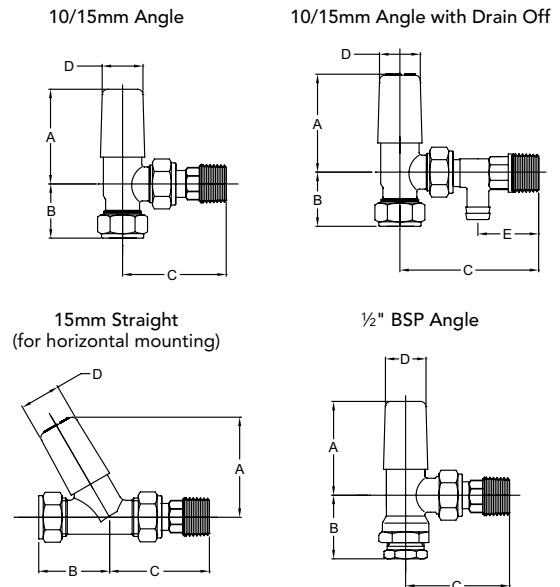

Model	A (mm)	B (mm)	C (mm)	D (mm)	E (mm)
10/15mm Angle	53.0	31.0	58.0	23.5	-
10/15mm Angle/Drain	53.0	31.0	76.6	23.5	34.0
15mm Straight	55.5	40.0	56.5	23.5	-
1/2" BSP Angle	53.0	27.0	58.0	23.0	-

NB: All measurements are nominal.

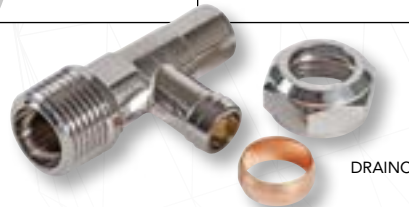

MATCHMASTER

Description	Metal Finish	Wheel Head Order Code	Lockshield Order Code	Minimum Order Qty
10mm Angle	Brass	MR10WAB	MR10LAB	10
10mm Angle with Drain Off	Brass	-	MR10LABD	10
10mm Angle	Chrome	MR10WAC	MR10LAC	10
10mm Angle with Drain Off	Chrome	-	MR10LACD	10
15mm Angle	Brass	MR15WAB	MR15LAB	10
15mm Angle with Drain Off	Brass	-	MR15LABD	10
15mm Angle	Chrome	MR15WAC	MR15LAC	10
15mm Angle with Drain Off	Chrome	-	MR15LACD	10
15mm or 1/2" BSP Angle (for iron and copper pipe)	Chrome	MR15WACIP	MR15LACIP	10
15mm Straight	Chrome	MR15WSC	MR15LSC	10
10mm (90° Comp Elbow) Angle	Chrome	MR10WAC90	MR10LAC90	20
10mm (90° Comp Elbow) Angle with Drain Off	Chrome	-	MR10LACD90	20
Drain Off Tail Only	Brass	-	DRAINB	1
Drain Off Tail Only	Chrome	-	DRAIN C	1
Wheelhead Valve Top Only	White Plastic	MRTOPWH	-	20
Lockshield Valve Top Only	White Plastic	-	MRTOPLS	20

MATCHMASTER PUSHFIT



10mm Angle	Chrome	MR10WACPF	MR10LACPF	20
10mm Angle with Drain Off	Chrome	-	MR10LACDPF	20
10mm (90° Pushfit Elbow) Angle	Chrome	MR10WACPF90	MR10LACPF90	20
10mm (90° Pushfit Elbow) Angle with Drain Off	Chrome	-	MR10LACDPF90	20
10mm Straight	Chrome	MR10WSCPF	MR10LSCPF	20
10mm (90° Pushfit Elbow) Straight	Chrome	MR10WSCPF90	MR10LSCPF90	20
15mm Angle	Chrome	MR15WACPF	MR15LACPF	20
15mm Angle with Drain Off	Chrome	-	MR15LACDPF	20
15mm (90° Pushfit Elbow) Angle	Chrome	MR15WACPF90	MR15LACPF90	20
15mm (90° Pushfit Elbow) Angle with Drain Off	Chrome	-	MR15LACDPF90	20
15mm (90° Pushfit Elbow) Straight	Chrome	MR15WSCPF90	MR15LSCPF90	20



FF15WAC

FULLFLOW

FULLFLOW radiator valves are designed and manufactured to meet the requirements of commercial installations. They feature a non-rising spindle, double EPDM 'O' ring gland seals with an additional 'O' ring back seating arrangement, this enables the FULLFLOW valve to be serviced without the requirement for draining the system, perfect for commercial applications. The range includes compression and screwed iron connections, as well as drain off options. Straight and angle versions are also available.



FF15LACD

DIMENSIONS

Wheel Head

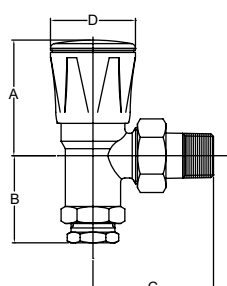
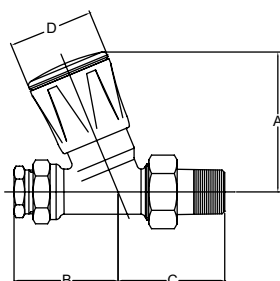
15mm or ½"/22mm or ¾"
BSP Angle15mm or ½"/22mm or ¾"
BSP Straight (for horizontal
mounting)

Model	A	B	C	D
	(mm)	(mm)	(mm)	(mm)
15mm or ½" BSP Angle	55.5	39.0	54.8	40.0
22mm or ¾" BSP Angle	56.0	45.2	61.1	40.0
15mm or ½" BSP Straight	69.0	47.0	47.8	40.0
22mm or ¾" BSP Straight	72.1	54.5	54.1	40.0

Lockshield

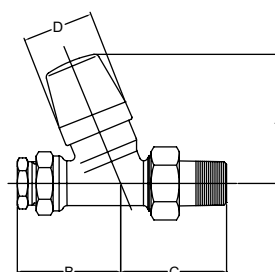
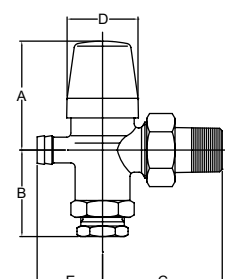
15mm or ½"/22mm or ¾"
BSP Straight (for horizontal
mounting)15mm or ½" BSP Angle
with Drain Off

Model	A	B	C	D	E
	(mm)	(mm)	(mm)	(mm)	(mm)
15mm or ½" BSP Straight	62.0	47.0	47.8	34.0	-
22mm or ¾" BSP Straight	65.1	54.5	54.1	34.0	-
15mm or ½" BSP Angle/Drain	52.5	39.0	54.8	34.0	30.0

NB: All measurements are nominal.

GENERAL SPECIFICATION



CERTIFICATION

Produced under a quality management system - ISO 9001:2008. Conforms to BS 2767-10.



GUARANTEE

2 year guarantee from date of purchase against manufacturing defects.



COLOUR

Finished in polished chrome or brass.



CONNECTIONS

Compression or screwed iron.



OPERATING PRESSURES

Tested to a maximum pressure of 10 bar.



OPERATING TEMPERATURE

Maximum 120°C.



DELIVERY

2 - 5 working days.



FF15WSC

For more general information, please see page 276.

FULLFLOW

Description	Metal Finish	Wheel Head Order Code	Lockshield Order Code	Minimum Order Qty
15mm or ½" BSP Angle	Brass	FF15WAB	FF15LAB	10
15mm or ½" BSP Angle	Polished Chrome	FF15WAC	FF15LAC	10
15mm or ½" BSP Angle with Drain Off	Polished Chrome	-	FF15LACD	10
15mm or ½" BSP Angle with Drain Off	Brass	-	FF15LABD	10
15mm or ½" BSP Straight	Brass	FF15WSB	FF15LSB	10
15mm or ½" BSP Straight	Polished Chrome	FF15WSC	FF15LSC	10
22mm or ¾" BSP Angle	Brass	FF22WAB	FF22LAB	5
22mm or ¾" BSP Angle	Polished Chrome	FF22WAC	FF22LAC	5
22mm or ¾" BSP Straight	Polished Chrome	FF22WSC	FF22LSC	5
22mm or ¾" BSP Straight	Brass	-	FF22LSB	5
Wheelhead Valve Top Only	White Plastic	FFT0PWH	-	20
Lockshield Valve Top Only	White Plastic	-	FFT0PLS	20



EV10LAN

EURO LOCKSHIELD

The Euro Lockshield is a lockshield valve designed primarily for TRVs and TRV packs. Lockshield valves help to keep the heating system balanced by controlling the flow of water, ensuring all radiators heat up at the same time. Euro Lockshield valves come in 10mm and 15mm sizes with drain off options available and are finished in nickel.

DIMENSIONS

Euro Lockshield

10/15mm Angle

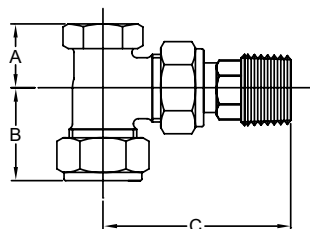

Model	A	B	C
	(mm)	(mm)	(mm)
10/15mm Angle	19.0	28.0	57.0

Euro Lockshield with Drain Off

10/15mm Angle

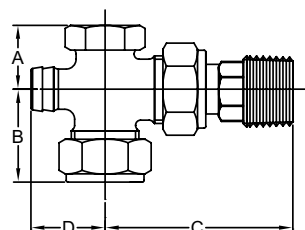

Model	A	B	C	D
	(mm)	(mm)	(mm)	(mm)
10/15mm Angle/Drain	19.0	28.0	57.0	23.0

NB: All measurements are nominal.

GENERAL SPECIFICATION



CERTIFICATION
Produced under a quality management system - ISO 9001:2008.



OPERATING PRESSURES
Tested to a maximum pressure of 10 bar.
Pressure tested in accordance with BS 2767.



GUARANTEE
2 year guarantee from date of purchase against manufacturing defects.



OPERATING TEMPERATURE
Maximum 120°C.



COLOUR
Finished in nickel.



DELIVERY
2 - 5 working days.



CONNECTIONS
Compression.

For more general information, please see page 276.



EV10LAND

EURO LOCKSHIELD

Description	Metal Finish	Order Code	Minimum Order Qty
10mm Angle	Nickel	EV10LAN	10
10mm Angle with Drain Off	Nickel	EV10LAND	10
15mm Angle	Nickel	EV15LAN	10
15mm Angle with Drain Off	Nickel	EV15LAND	10



DECORATIVE

MYSON offer a selection of DECORATIVE valves for projects that need that extra special finishing touch. Manufactured from solid brass, they are beautifully finished in highly polished chrome. The range includes compression and screwed iron connections, with straight and angle options available.

GENERAL SPECIFICATION



CERTIFICATION

Produced under a quality management system - ISO 9001:2008. Conforms to BS 2767-10.



GUARANTEE

2 year guarantee from date of purchase against manufacturing defects.



COLOUR

Finished in polished chrome.



CONNECTIONS

Compression or screwed iron.



OPERATING PRESSURES

Tested to a maximum pressure of 10 bar.



OPERATING TEMPERATURE

Maximum 120°C.



DELIVERY

2 - 5 working days.

For more general information, please see page 276.

DIMENSIONS

Handwheel

15mm or 1/2" BSP Angle

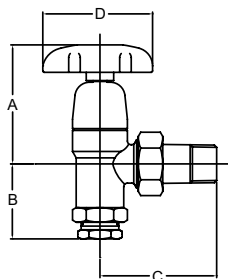

15mm or 1/2" BSP Straight
(for vertical mounting)

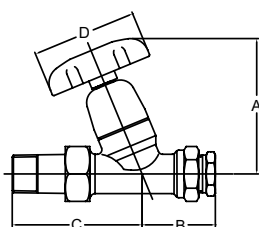

15mm or 1/2" BSP Straight
(for horizontal mounting)

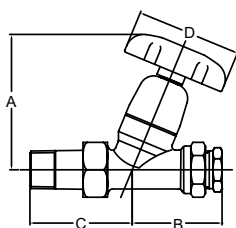

Model	A (mm)	B (mm)	C (mm)	D (mm)
15mm or 1/2" BSP Angle	65.0	41.0	55.0	60.0
15mm or 1/2" BSP Straight (Vert)	74.0	40.0	71.0	60.0
15mm or 1/2" BSP Straight (Horiz)	74.0	49.0	56.0	60.0

Lockshield

15mm or 1/2" BSP Angle

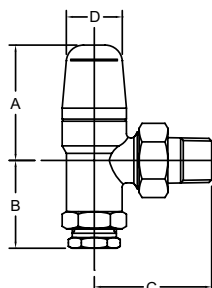

15mm or 1/2" BSP Straight
(for vertical mounting)

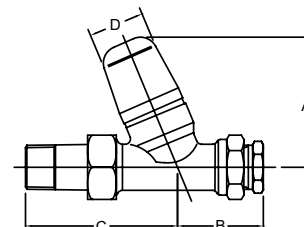

15mm or 1/2" BSP Straight
(for horizontal mounting)

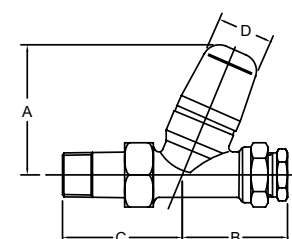

Model	A (mm)	B (mm)	C (mm)	D (mm)
15mm or 1/2" BSP Angle	54.0	41.0	55.0	26.0
15mm or 1/2" BSP Straight (Vert)	61.0	40.0	71.0	26.0
15mm or 1/2" BSP Straight (Horiz)	61.0	49.0	56.0	26.0

NB: All measurements are nominal.



DEC15HSHC



DEC15LAC

DECORATIVE

Description	Metal Finish	Order Code	Minimum Order Qty
15mm or 1/2" BSP Angle Handwheel	Polished Chrome	DEC15HAC	1
15mm or 1/2" BSP Angle Lockshield	Polished Chrome	DEC15LAC	1
15mm or 1/2" BSP Straight Handwheel (for Vertical Mounting)	Polished Chrome	DEC15HSVC	1
15mm or 1/2" BSP Straight Handwheel (for Horizontal Mounting)	Polished Chrome	DEC15HSHC	1
15mm or 1/2" BSP Straight Lockshield (for Vertical Mounting)	Polished Chrome	DEC15LSVC	1
15mm or 1/2" BSP Straight Lockshield (for Horizontal Mounting)	Polished Chrome	DEC15LSHC	1
Pipe Sleeving Kit 180mm	Polished Chrome	DEC180SLV	1



DECSL15HAC

SLIMLINE DECORATIVE

MYSON offer a choice of SLIMLINE DECORATIVE valves designed to complement our range of modern towel warmers and contemporary radiators. Manufactured from quality brass, they are finished in highly polished chrome. Available in straight and angle versions.

GENERAL SPECIFICATION



CERTIFICATION

Produced under a quality management system - ISO 9001:2008. Conforms to BS 2767-1.



GUARANTEE

2 year guarantee from date of purchase against manufacturing defects.



COLOUR

Finished in polished chrome.



CONNECTIONS

Compression, pushfit or screwed iron.



OPERATING PRESSURES

Tested to a maximum pressure of 10 bar (compression and screwed iron), 3 bar (pushfit).



OPERATING TEMPERATURE

Maximum 120°C (compression and screwed iron), 92°C (pushfit).



DELIVERY

2 - 5 working days.

For more general information, please see page 276.

DIMENSIONS

SLIMLINE DECORATIVE

15mm Angle

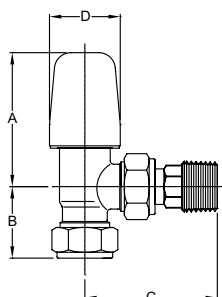

15mm Straight
(for vertical mounting)

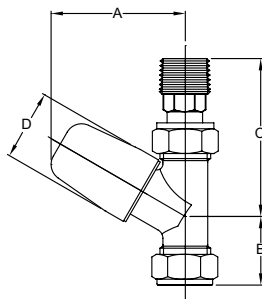

Model	A (mm)	B (mm)	C (mm)	D (mm)
15mm Angle	57.0	30.0	56.0	30.0
15mm Straight	57.0	29.0	67.0	30.0

SLIMLINE DECORATIVE Pushfit

10/15mm Angle

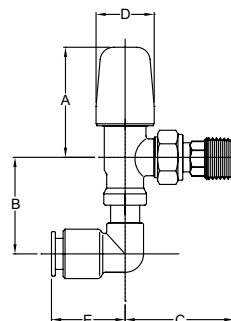

10/15mm Straight
(for vertical mounting)

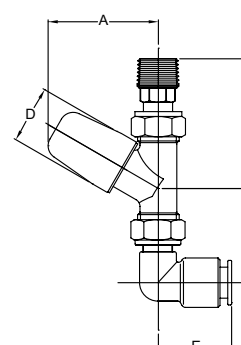

Model	A (mm)	B (mm)	C (mm)	D (mm)	E (mm)
10mm Angle	57.0	43.0	56.0	30.0	32.0
10mm Straight	57.0	43.0	67.0	30.0	32.0
15mm Angle	57.0	50.0	56.0	30.0	38.0
15mm Straight	57.0	49.0	67.0	30.0	38.0

NB: All measurements are nominal.



DECSSL15HSC

DECSSL10HACPF90



PUSHFIT
OPTION
AVAILABLE

SLIMLINE DECORATIVE

Description	Metal Finish	Order Code	Minimum Order Qty*
15mm Angle Combined Wheelhead/Lockshield Manual Valve	Polished Chrome	DECSSL15HAC	1
15mm Straight Combined Wheelhead/Lockshield Manual Valve	Polished Chrome	DECSSL15HSC	1

SLIMLINE DECORATIVE PUSHFIT



10mm (90° Pushfit Elbow) Angle Combined Wheelhead/Lockshield Manual Valve	Polished Chrome	DECSSL10HACPF90	1
10mm (90° Pushfit Elbow) Straight Combined Wheelhead/Lockshield Manual Valve	Polished Chrome	DECSSL10HSCPF90	1
15mm (90° Pushfit Elbow) Angle Combined Wheelhead/Lockshield Manual Valve	Polished Chrome	DECSSL15HACPF90	1
15mm (90° Pushfit Elbow) Straight Combined Wheelhead/Lockshield Manual Valve	Polished Chrome	DECSSL15HSCPF90	1

*One valve per box.

For Radiator
Valve Packs
please see
page 256

TRV 2-WAY

Our TRV 2-WAY is A-rated for maximum efficiency. The MYSON TRV 2-WAY is the most complete thermostatic radiator valve range available for today's central heating systems. Incorporating our unique '2-way' engineering, including our patented 'bonding' technique, the MYSON TRV 2-WAY simplifies installation and removes the worry of costly callbacks. It has a liquid sensor fitted at its heart, guaranteeing years of accurate temperature control. It is available in a polished chrome, nickel or brass finish. An impaired dexterity version is also available, for applications where this is required.



GENERAL SPECIFICATION



CERTIFICATION

Produced under a quality management system - ISO 9001:2008. Conforms to BS 2767-10 and complies to EN 215.



GUARANTEE

2 year guarantee from date of purchase against manufacturing defects.



COLOUR

Finished in chrome, nickel or brass.



CONNECTIONS

Compression or pushfit.



OPERATING PRESSURES

Tested to a maximum pressure of 10 bar (compression), 3 bar (pushfit).



OPERATING TEMPERATURE

Maximum 120°C (compression), 92°C (pushfit).



DELIVERY

2 - 5 working days.

For more general information, please see page 276.

DIMENSIONS

Angle TRV 2-WAY (Includes Pushfit)

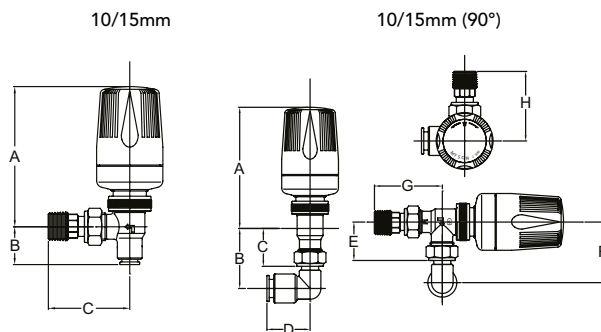

Model	A (mm)	B (mm)	C (mm)	D (mm)	E (mm)	F (mm)	G (mm)	H (mm)
10/15mm Chrome/Nickel	107.0	39.0	61.0	-	-	-	-	-
10mm Chrome/Nickel PF	107.0	33.0	61.0	-	-	-	-	-
15mm Chrome/Nickel PF	107.0	33.0	61.0	-	-	-	-	-
10mm (90°) Nickel PF	107.0	47.0	33.0	30.0	34.0	50.0	60.0	61.0
10mm (90°) Chrome PF	107.0	47.0	33.0	30.0	34.0	50.0	60.0	61.0
15mm (90°) Nickel PF	107.0	53.0	33.0	38.0	34.0	56.0	60.0	61.0
15mm (90°) Chrome PF	107.0	53.0	33.0	38.0	34.0	56.0	60.0	61.0
10mm (90°) Chrome Compression	107.0	47.0	33.0	31.0	34.0	50.0	60.0	61.0

Straight TRV 2-WAY (Includes Pushfit)

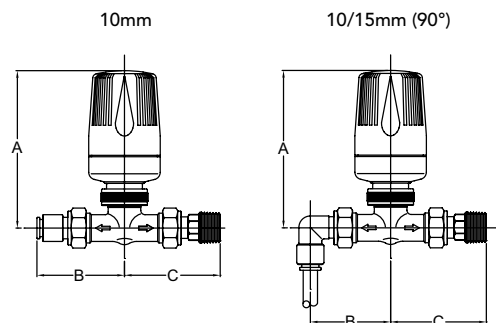

Model	A (mm)	B (mm)	C (mm)
10mm Chrome PF	110.0	61.0	67.0
10mm (90°) Chrome PF	110.0	56.0	67.0
15mm (90°) Chrome PF	110.0	62.0	67.0

2TRV10CPF90



NB: All measurements are nominal.

TRV 2-WAY

Description	Metal Finish	Order Code	Minimum Order Qty
8/15mm Angle	Chrome	2TRV8C	1
10/15mm Angle	Chrome	2TRV10C	1
15mm Angle	Chrome	2TRV15C	1
15mm Straight	Chrome	2TRV15SC	1
10mm (90° Comp Elbow)	Chrome	2TRV10C90	1
10/15mm Angle	Brass	2TRV10B	1
15mm Angle	Brass	2TRV15B	1

TRV 2-WAY CONTRACT

8/10/15mm Angle	Nickel	2TRVUS	1
10/15mm Angle	Nickel	2TRV10N	1
10/15mm Straight	Nickel	2TRV10NS	1
15mm Angle	Nickel	2TRV15N	1
10mm (90° Comp Elbow)	Nickel	2TRV10N90	1

TRV 2-WAY PUSHFIT



10mm (90° Pushfit Elbow) Angle	Chrome	2TRV10CPF90	1
10mm Angle	Chrome	2TRV10CPF	1
10mm (90° Pushfit Elbow) Straight	Chrome	2TRV10SCPF90	1
10mm Straight	Chrome	2TRV10SCPF	1
15mm (90° Pushfit Elbow) Angle	Chrome	2TRV15CPF90	1
15mm Angle	Chrome	2TRV15CPF	1
15mm (90° Pushfit Elbow) Straight	Chrome	2TRV15SCPF90	1

TRV 2-WAY CONTRACT PUSHFIT



10mm (90° Pushfit Elbow) Angle	Nickel	2TRV10NPF90	1
10mm Angle	Nickel	2TRV10NPF	1
15mm (90° Pushfit Elbow) Angle	Nickel	2TRV15NPF90	1
15mm Angle	Nickel	2TRV15NPF	1

For Radiator
Valve Packs
please see
page 256



PETITE

The MYSON PETITE Thermostatic Radiator Valve is a beautifully designed TRV for today's heating systems. The PETITE combines attractive design with total reliability, it also incorporates our 2-way flow technology. The PETITE is available as a single valve or a convenient 'TRV & manual' valve pack (see page 256), in either 10mm or 15mm sizes and finished in a bright nickel. Available in straight and angle versions.

GENERAL SPECIFICATION



CERTIFICATION

Produced under a quality management system - ISO 9001:2008 and complies to EN 215.



GUARANTEE

2 year guarantee from date of purchase against manufacturing defects.



COLOUR

Finished in nickel.



CONNECTIONS

Compression or pushfit.



OPERATING PRESSURES

Tested to a maximum pressure of 10 bar (compression), 3 bar (pushfit).



OPERATING TEMPERATURE

Maximum 120°C (compression), 92°C (pushfit).



DELIVERY

2 - 5 working days.

For more general information, please see page 276.

DIMENSIONS

PETITE

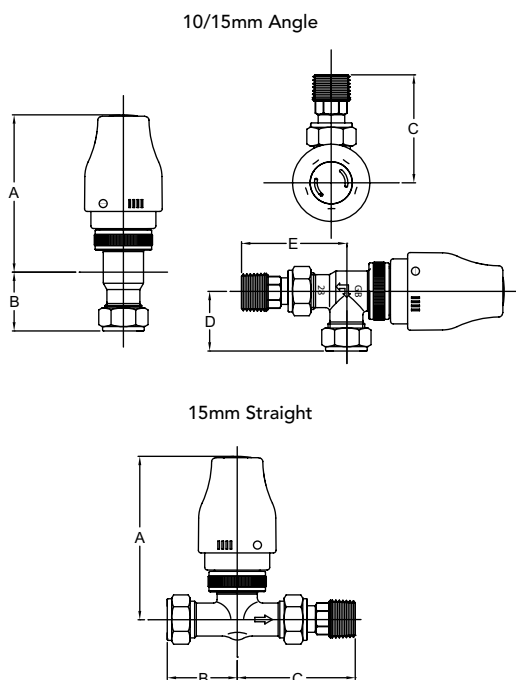

Model	A (mm)	B (mm)	C (mm)	D (mm)	E (mm)
10mm Angle	89.0	33.0	61.0	34.0	60.0
15mm Angle	89.0	33.0	61.0	34.0	60.0
15mm Straight	93.0	40.0	67.0	-	-

PETITE Pushfit

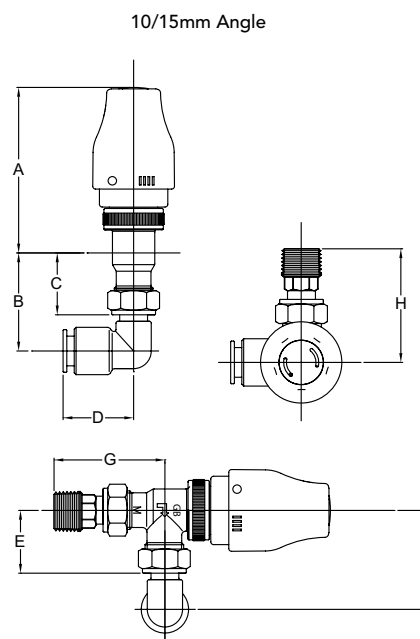

Model	A (mm)	B (mm)	C (mm)	D (mm)
10mm Angle	89.0	33.0	61.0	30.0
15mm Angle	89.0	39.0	61.0	36.0

Model	E (mm)	F (mm)	G (mm)	H (mm)
10mm Angle	34.0	50.0	60.0	61.0
15mm Angle	34.0	56.0	60.0	61.0

NB: All measurements are nominal.

PETTRV10NPF90



PETITE

Description	Metal Finish	Order Code	Minimum Order Qty
10mm PETITE TRV Angle	Nickel	PETTRV10N	10
15mm PETITE TRV Angle	Nickel	PETTRV15N	10
15mm PETITE TRV Straight	Nickel	PETTRV15NS	10

PETITE PUSHFIT



10mm PETITE (90° Pushfit Elbow) Angle	Nickel	PETTRV10NPF90	10
15mm PETITE (90° Pushfit Elbow) Angle	Nickel	PETTRV15NPF90	10



2TRVSL15DEC

SLIMLINE DECORATIVE TRV

Utilising the same sensing and operating performance of the thermostatic valve, the SLIMLINE DECORATIVE TRV combines both technology and elegance. With a beautiful, highly polished chrome finish, the range incorporates a choice of valve designs to meet the needs of the different styles of modern radiators. Straight, angle and horizontal versions are available.

GENERAL SPECIFICATION



CERTIFICATION

Produced under a quality management system - ISO 9001:2008 and complies to EN 215-1.



GUARANTEE

2 year guarantee from date of purchase against manufacturing defects.



COLOUR

Finished in polished chrome.



CONNECTIONS

Compression, pushfit or screwed iron.



OPERATING PRESSURES

Tested to a maximum pressure of 10 bar (compression and screwed iron), 3 bar (pushfit).



OPERATING TEMPERATURE

Maximum 120°C (compression and screwed iron), 92°C (pushfit).



DELIVERY

2 - 5 working days.

For more general information, please see page 276.

DIMENSIONS

SLIMLINE DECORATIVE TRV

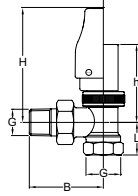
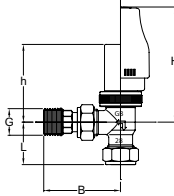
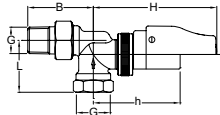
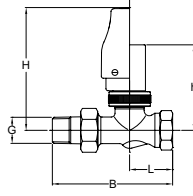
15mm or ½" BSP
Vertical Angle15mm or ½" BSP
Angle15mm or ½" BSP
Straight15mm or ½" BSP
Horizontal Angle

Model	G (in)	B (mm)	L (mm)	H* (mm)	h* (mm)
15mm or ½" BSP Vertical Angle	½	58.0	26.0	109.0	75.0
15mm or ½" BSP Angle	½	64.0	32.0	108.0	72.0
15mm or ½" BSP Straight	½	95.0	33.0	113.0	77.0
15mm or ½" BSP Horizontal Angle	½	53.0	37.0	115.0	79.0

SLIMLINE DECORATIVE TRV

15mm Vertical Angle

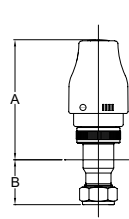

15mm Straight

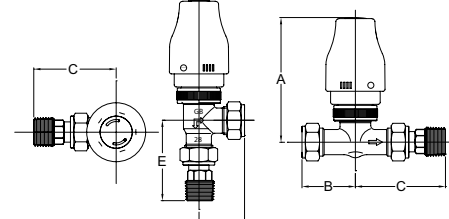

Model	A (mm)	B (mm)	C (mm)	D (mm)	E (mm)
15mm Vertical Angle	89.0	33.0	61.0	34.0	60.0
15mm Straight	93.0	40.0	67.0	-	-

SLIMLINE DECORATIVE Pushfit TRV

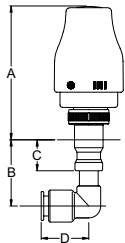
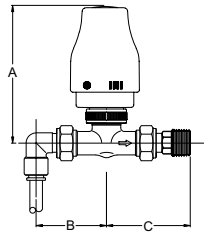
10/15mm TRV
(90° Pushfit Elbow)10/15mm TRV
(90° Pushfit Elbow) Straight

OVERHEAD VIEW

Model	A (mm)	B (mm)	C (mm)	D (mm)	E (mm)
10mm TRV (90° Pushfit Elbow)	94.0	46.0	33.0	32.0	61.0
15mm TRV (90° Pushfit Elbow)	94.0	52.0	33.0	38.0	61.0
10mm TRV (90° Pushfit Elbow) Straight	97.0	56.0	67.0	-	-
15mm TRV (90° Pushfit Elbow) Straight	97.0	62.0	67.0	-	-

NB: All measurements are nominal.

H* Fitted with 2TRVHEAD or 2TRVRSHEAD

h* Fitted with 2TRVADJHEAD



2TRVSL15STDEC

TRVSL15DECPF90



SLIMLINE DECORATIVE TRV

Description	Metal Finish	Order Code	Minimum Order Qty
15mm or ½" BSP Vertical Angle	Polished Chrome	2TRV15DEC	1
15mm or ½" BSP Angle Body	Polished Chrome	2TRV15ADEC	1
15mm or ½" BSP Straight TRV	Polished Chrome	2TRV15STDEC	1
15mm or ½" BSP Horizontal Angle TRV	Polished Chrome	2TRV15HDEC	1
Decorative TRV Head Only	Polished Chrome	2TRVHDEC	1
15mm Vertical Angle TRV	Polished Chrome	2TRVSL15DEC	1
15mm Straight TRV	Polished Chrome	2TRVSL15STDEC	1

SLIMLINE DECORATIVE PUSHFIT TRV



10mm TRV (90° Pushfit Elbow)	Polished Chrome	TRVSL10DECPF90	1
10mm TRV (90° Pushfit Elbow) Straight	Polished Chrome	TRVSL10STDECPF90	1
15mm TRV (90° Pushfit Elbow)	Polished Chrome	TRVSL15DECPF90	1
15mm TRV (90° Pushfit Elbow) Straight	Polished Chrome	TRVSL15STDECPF90	1



Kits supplied with 'A' rated TRVs for energy efficiency

LST TRV KITS

DIRECTFIT

MYSON offer a flexible and comprehensive range of TRV kits that are specifically designed to maximise the effectiveness of our range of LST radiators. For information on our LST range please see page 43.

We offer two designs, the Universal Close Coupled Kit, which allows the case to be removed for cleaning without removing the TRV head, and the competitively priced Direct Fit Kit. Both come with our A-rated TRV and are expertly designed for precision control.

The kits allow the thermal sensing head of a MYSON Thermostatic Radiator Valve to be mounted directly onto the LST enclosure of a MYSON Low Surface Temperature Radiator. They also feature a locking facility that prevents unauthorised adjustment in public areas.

GENERAL SPECIFICATION



CERTIFICATION

Produced under a quality management system - ISO 9001:2008. Manual valve conforms to BS 2767-10 and TRV complies to EN 215-1.



GUARANTEE

2 year guarantee from date of purchase against manufacturing defects.



COLOUR

Finished in nickel or brass.



CONNECTIONS

Compression or screwed iron.



OPERATING PRESSURES

Tested to a maximum pressure of 10 bar.



OPERATING TEMPERATURE

Maximum 120°C.



DELIVERY

2 - 5 working days.

For more general information, please see page 276.

DIRECT FIT TRV KIT

Suitable for TBOE connection only.

This kit allows a MYSON TRV to be mounted directly onto the internal radiator, making it an integral part of the LST radiator.

This option utilises the 38mm knock out in the LST casing.



Direct Fit TRV Kit comprises:

- 1 x Horizontal angle TRV body
- 1 x TRV head
- 1 x Extension adaptor
- 1 x Plastic bush
- 1 x MATCHMASTER lockshield valve

Order Code: DIRECTFIT

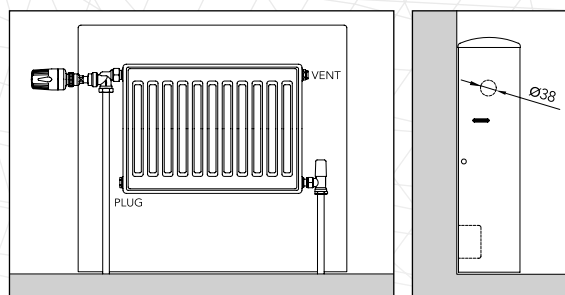

Direct Fit Kit

UNIVERSAL CLOSE COUPLED KIT*

Suitable for TBOE, TBSE or BOE connections.

This kit allows the MYSON TRV to be mounted directly onto the LST casing, with a choice of positions for both the TRV head and TRV straight valve body.

This option utilises the 23mm knock out on the LST casing.



Universal Close Coupled TRV:

- 1 x TRV head
- 1 x TRV straight body
- 1 x LST capillary unit/actuator/sensor head adaptor
- 1 x MATCHMASTER straight lockshield valve
- 2 x Integration elbows
- 2 x Locking pins

Order Code: UNICCKTC

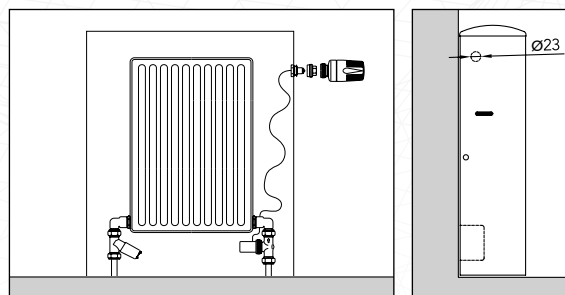

Universal Close Coupled Kit

*For LST Vertical instructions, please refer to page 49.

REMOTE SENSOR



This allows the TRV head to be fitted inside the LST casing. The TRV valve body must be fitted on the bottom opposite end of the radiator. It is NOT suitable for top end connection. The sensor may be positioned up to 5 metres from the casing.

Order Code:

- 2TRVRSHEAD5 (5 METRE)
- 2TRVRSHEAD2 (2 METRE)

REMOTE ADJUSTER



Suitable for TBOE or BOE connections. The TRV head/sensor is mounted directly onto a wall plate and may be fitted up to 5 metres from the emitter.

Order Code:

- 2TRVADJHEAD5 (5 METRE)
- 2TRVADJHEAD2 (2 METRE)

Description	Order Code	Minimum Order Qty
15mm or 1/2" BSP Universal Close Coupled TRV Kit	UNICCKTC	1
15mm or 1/2" BSP Direct Fit TRV Kit (now includes BS lockshield)	DIRECTFIT	1
Replacement Capillary for CCKTC	2TRVLSTCAP	1
Extended 2.5m Capillary for CCKTC. Use with TBOE connections 1800mm radiators and above	2TRVLSTCAP2.5	1
Replacement head locating body for CCKTC	2TRVLSTHLB	1
Theft Resistant Ring	2TRVRING	1
Theft Resistant Collar	2TRVCOLLAR	1



REMOTE THERMOSTATS

2TRVRSHEAD2

The MYSON remote sensor incorporates a traditional TRV head which can be set to the desired temperature. The room temperature is monitored via a 2, 5 or 10 metre capillary connected to the sensing element which can be mounted in a convenient and temperature representative area of the room. Remote sensor heads are ideal for use when it is difficult for a traditional TRV to operate, such as behind furniture or in direct sunlight, and are primarily used with LST radiators.

DIMENSIONS

Remote Adjuster

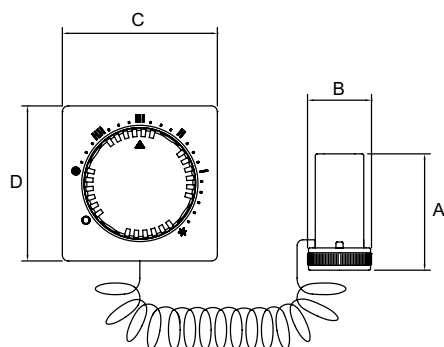

Model	A (mm)	B (mm)	C (mm)	D (mm)
2/5m Capillary	53.5	32.5	80.0	80.0

Remote Sensor

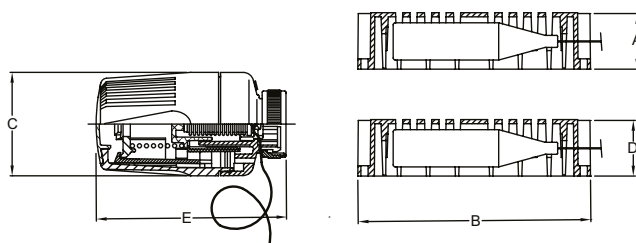

Model	A (mm)	B (mm)	C (mm)	D (mm)	E (mm)
2/5/10m Capillary	28.0	112.0	50.0	28.0	90.0

NB: All measurements are nominal.

GENERAL SPECIFICATION



CERTIFICATION

Produced under a quality management system - ISO 9001:2008.



GUARANTEE

2 year guarantee from date of purchase against manufacturing defects.



DELIVERY

2 - 5 working days.



2TRVADJHEAD2

For more general information, please see page 276.

Description	Order Code	Minimum Order Qty
Remote Sensor 2m Capillary	2TRVRSHEAD2	1
Remote Sensor 5m Capillary	2TRVRSHEAD5	1
Remote Sensor 10m Capillary (special order)	2TRVRSHEAD10	1
Remote Adjuster 2m Capillary	2TRVADJHEAD2	1
Remote Adjuster 5m Capillary	2TRVADJHEAD5	1

RADIATOR VALVE PACKS

Our radiator valve packs provide a total radiator solution. Included in each pack is one TRV and one lockshield valve. There are a range of packs available depending on individual requirements, with PETITE, pushfit and decorative options. We also offer a selection of radiator packs with drain off valves.

GENERAL SPECIFICATION

- ✓

CERTIFICATION
Produced under a quality management system - ISO 9001:2008. Pressure tested in accordance with BS 2767.
- 2

GUARANTEE
2 year guarantee from date of purchase against manufacturing defects.
- 🔧

COLOUR
Finished in nickel (PETITE) and chrome (Radpack).
- 🔌

CONNECTIONS
Compression.
- 🔥

OPERATING PRESSURES
Tested to a maximum pressure of 10 bar (compression), 3 bar (pushfit).
- 🌡️

OPERATING TEMPERATURE
Maximum 120°C (compression), 92°C (pushfit).
- 🚚

DELIVERY
2 - 5 working days.
- For more general information, please see page 276.



RADPACK



PETITE PUSHFIT PACKS

Description	Order Code	Minimum Order Qty
PETITE Pushfit 10mm Radpak TRV & Lockshield in one pack (90° Pushfit Elbow)	PETPAK10NPF90	10
PETITE Pushfit 10mm Radpak TRV & Lockshield Drain Off in one pack (90° Pushfit Elbow)	PETPAK10NDPF90	10

TRV & LOCKSHIELD VALVE PACKS

PETITE Radpak 10mm PETITE TRV & Euro Lockshield in one pack	PETPAK10N	10
PETITE Radpak 10mm PETITE TRV & Euro Lockshield Drain Off in one pack	PETPAK10ND	10
PETITE Radpak 15mm PETITE TRV & Euro Lockshield in one pack	PETPAK15N	10
PETITE Radpak 15mm PETITE TRV & Euro Lockshield Drain off in one pack	PETPAK15ND	10
PETITE Radpak Straight 15mm PETITE TRV & Euro Lockshield in one pack	PETPAK15NS	1
Radpak 10/15mm TRV 2-WAY & MATCHMASTER Lockshield in one pack	RADPACK	1

DECORATIVE CHROME TRV & LOCKSHIELD VALVE PACKS

All chrome Angle PETITE TRV & Lockshield Valve Pack	PETPAK15DEC	1
All chrome Straight PETITE TRV & Lockshield Valve Pack	PETPAK15DECS	1



ABV22

AUTOMATIC BYPASS VALVES

MYSON offer a selection of Automatic Bypass Valves (ABVs). Our automatic bypass valves are designed for use in domestic central heating systems and are available in either an angled or straight version. Its purpose is to maintain constant pump pressure and flow rate within the system. ABVs also reduce system noise and increase efficiency.

DIMENSIONS

Automatic Bypass Valve Angle

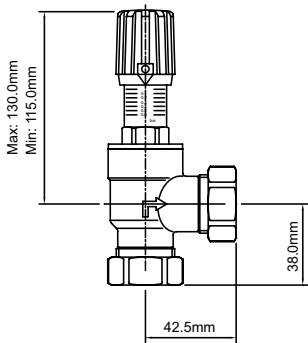

Automatic Bypass Valve Straight

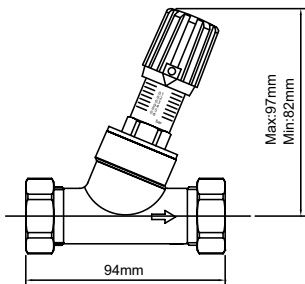

NB: All measurements are nominal.

GENERAL SPECIFICATION

- CERTIFICATION**
Produced under a quality management system - ISO 9001:2008. Pressure tested in accordance with BS 2767.
- CONNECTIONS**
Compression.
- OPERATING PRESSURES**
Tested to a maximum pressure of 10 bar.
- GUARANTEE**
2 year guarantee from date of purchase against manufacturing defects.
- OPERATING TEMPERATURE**
Maximum 120°C.
- COLOUR**
Finished in brass.
- DELIVERY**
2 - 5 working days.

For more general information, please see page 276.

Description	Metal Finish	Order Code	Minimum Order Qty
Automatic Bypass Valve Angle	Brass	ABV22	1
Automatic Bypass Valve Straight	Brass	ABV22S	1



2TRV22AN

TRV BODIES & ACCESSORIES

MYSON offer a range of TRV bodies and accessories to accompany radiators throughout the range.

All TRV bodies conform to EN 215-1, are available as angled, horizontal angled, straight and also come in a range of finishes.

The impaired dexterity TRV head is ideal for use in care homes and nursing homes.



DIMENSIONS

Standard/Straight Bodies

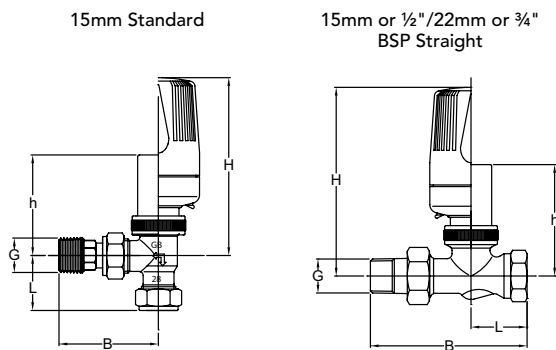

Model	G (in)	B (mm)	L (mm)	H* (mm)	h* (mm)
15mm Standard	1/2	64.0	32.0	108.0	72.0
15mm or 1/2" BSP Straight	1/2	95.0	33.0	113.0	77.0
22mm or 3/4" BSP Straight	3/4	106.0	37.0	116.0	80.0

Horizontal/Vertical Angle Bodies

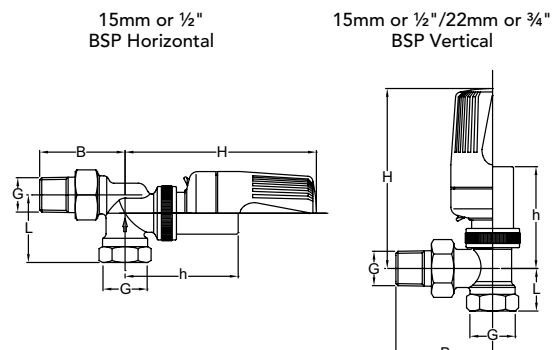

Model	G (in)	B (mm)	L (mm)	H* (mm)	h* (mm)
15mm or 1/2" BSP Horizontal	1/2	53.0	37.0	115.0	79.0
15mm or 1/2" BSP Vertical	1/2	58.0	26.0	109.0	75.0
22mm or 3/4" BSP Vertical	3/4	66.0	29.0	111.0	87.0

H* Fitted with 2TRVHEAD or 2TRVRSHEAD
h* Fitted with 2TRVADJHEAD

NB: All measurements are nominal.

TRV head not included.

GENERAL SPECIFICATION FOR TRV BODIES



CERTIFICATION
Produced under a quality management system - ISO 9001:2008 and complies to EN 215-1.



OPERATING PRESSURES
Tested to a maximum pressure of 10 bar.



GUARANTEE
2 year guarantee from date of purchase against manufacturing defects.



OPERATING TEMPERATURE
Maximum 120°C.



DELIVERY
2 - 5 working days.



COLOUR
Finished in nickel or chrome plate.

For more general information, please see page 276.



CONNECTIONS
Compression or pushfit.



2TRV15SN

TRV BODIES

Description	Metal Finish	Order Code	Minimum Order Qty
15mm or 1/2" BSP Vertical Angle	Nickel	2TRV15AN	1
15mm or 1/2" BSP Horizontal Angle	Nickel	2TRV15IN	1
15mm or 1/2" BSP Straight	Nickel	2TRV15SN	1
15mm Standard TRV 2-WAY Body	Chrome	2TRVBOC	1
15mm Standard TRV 2-WAY Body	Nickel	2TRVBON	1
22mm or 3/4" BSP Vertical Angle (one way flow)	Nickel	2TRV22AN	1
22mm or 3/4" BSP Straight (one way flow)	Nickel	2TRV22SN	1
M28 TRV Body	Nickel	2TRVADAP	1

ACCESSORIES

Standard TRV Head Only	-	2TRVHEAD	1
PETITE TRV Head Only	-	PETTRVHEAD	1
Standard TRV Head 'Contract' Only	-	2TRVHEADCON	1
Theft Resistant Ring	-	2TRVRING	1
Theft Resistant Collar	-	2TRVCOLLAR	1
Commissioning Cap	-	2TRVCAP	1
Impaired Dexterity TRV Head Only	-	2TRVHEADDEX	1