LPCB LPS 1175

APPROVED PRODUCTS

LPCB LPS 1175 covers physical security products and services, and comprises of a number of security ratings from 1 - 8 and these are known as Security Ratings (SR).

The ratings are measured in terms of attack tool and time available to the attacker and enables specifiers to select products according to the risks that the project might face. The LPS 1175 standard can be used in a range of applications from residential through to critical infrastructure projects.

SR1 & SR2

Products provide the minimum levels of recognised resistance to opportunist attempts at forced entry using a range of techniques including those that create noise.

SR3

Products provide moderate resistance to determined attempts of forced entry using a range of techniques, including those that involve creation of noise.

SR4 & SR5

Products resist experienced attempts at forced entry using a wide range of tools including battery powered tools lasting up to 10 minutes depending on the security rating sought.

BARBICAN® SR1



Our Barbican® SR1 LPS 1175 systems feature a welded pale-through-rail construction for strength and security integrity. Barbican® SR1 is an ideal option for commercial properties, city schools, or great for architects who want a minimalist contemporary fence which meets LPS 1175 standard set by the Loss Prevention Certification Board (LPCB).

- LPS 1175 SR1 Approved
- Secured by Design Preferred Specification
- Fully welded pale-through-rail construction
- Seamless, concealed vandal proof rail to post fixing
- Anti-climb design
- 25-year service life guarantee

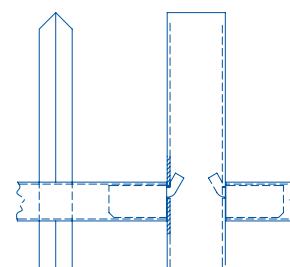

Post to panel fixings

APPLICATIONS

- ▶ Schools
- ▶ Perimeter security
- ▶ Commercial premises

PANELS

Barbican® SR1 panels are up to 3000mm high and have two horizontal hollow section rails 60 x 40mm (3 rails if 3000mm high). Vertical rectangular hollow section 25 x 25mm pales are passed through the rails with standard spacing at 129mm centres. The tops of pales are cut at 45 degrees and left open as standard to form a point.

GATES

SR1 gates available

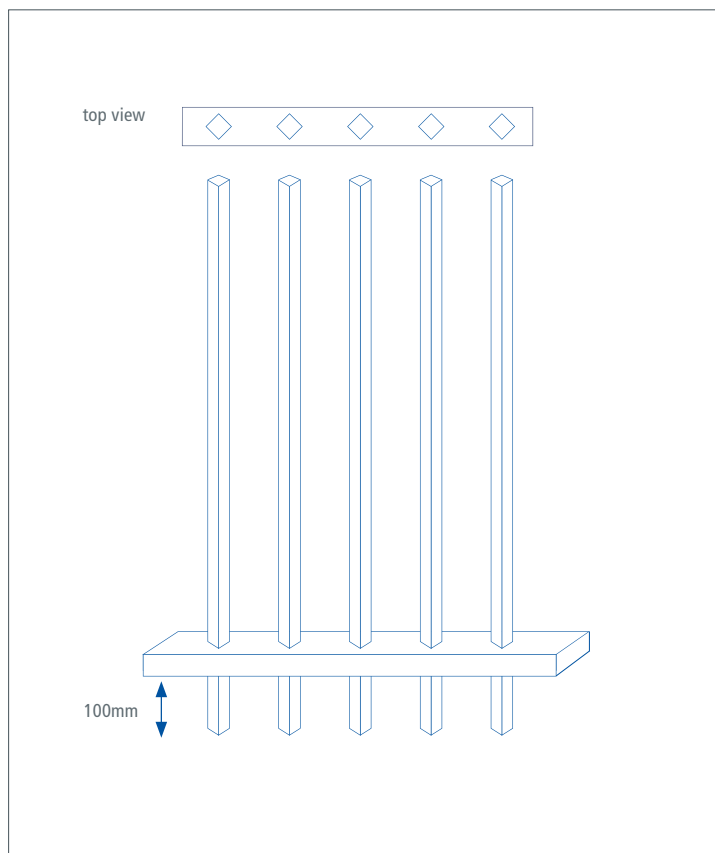

HEIGHT (MM)	POST CENTRES (MM)	POST DIMENSIONS (MM)	OVERALL POST LENGTH (MM)
1800	3000	60 x 60	2500
2000	3000	60 x 60	2800
2500	3000	80 x 60	3300
3000	2484	80 x 60	3800

FINISHES

- Hot dip galvanised to BS EN ISO 1461 as standard
- Hot dip galvanised and powder coated to BS EN 13438
- Marine coat for installations within 500m of salt water or an estuary

STANDARD COLOURS

- Black RAL 9005
- Green RAL 6005
- Other colours are available on request

APPROVALS

LPS 1175 SR1



BARBICAN IMPERIAL® SR1

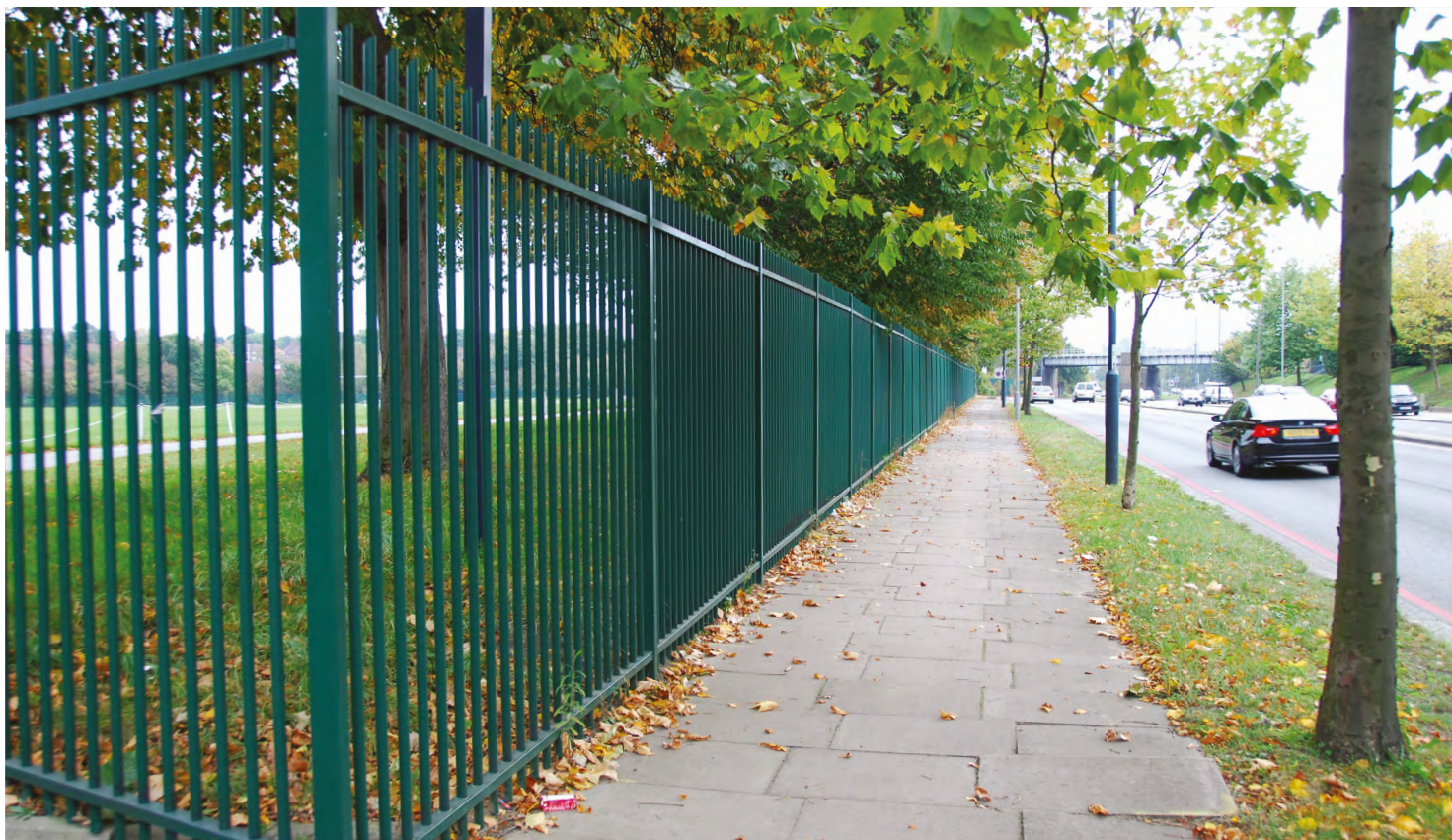

Barbian Imperial® LPS 1175 SR1 system of fencing and gates features a welded pale-through-rail construction for strength and security integrity. The horizontal railed are sleeved on to the upright posts with concealed fixings to provide timeless design suitable for most settings.

- LPS 1175 SR1 Approved
- Secured by Design Preferred Specification
- Fully welded pale-through-rail construction
- Seamless, concealed rail to post fixing
- Anti-climb design
- **25-year service life guarantee**

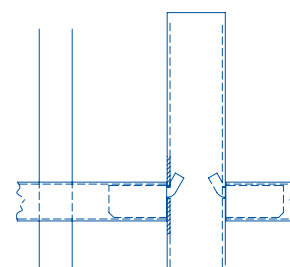

Post to panel fixings

APPLICATIONS

- ▶ Medium risk
- ▶ Schools
- ▶ Retail
- ▶ Public spaces

PANELS

Barbian Imperial® SR1 has vertical round hollow section \varnothing 32mm diameter pales up to 2000mm high at 129mm centres and 32mm for 2100mm+ with 129mm centres which complies with Building Regulations.

GATES

SR1 gates available

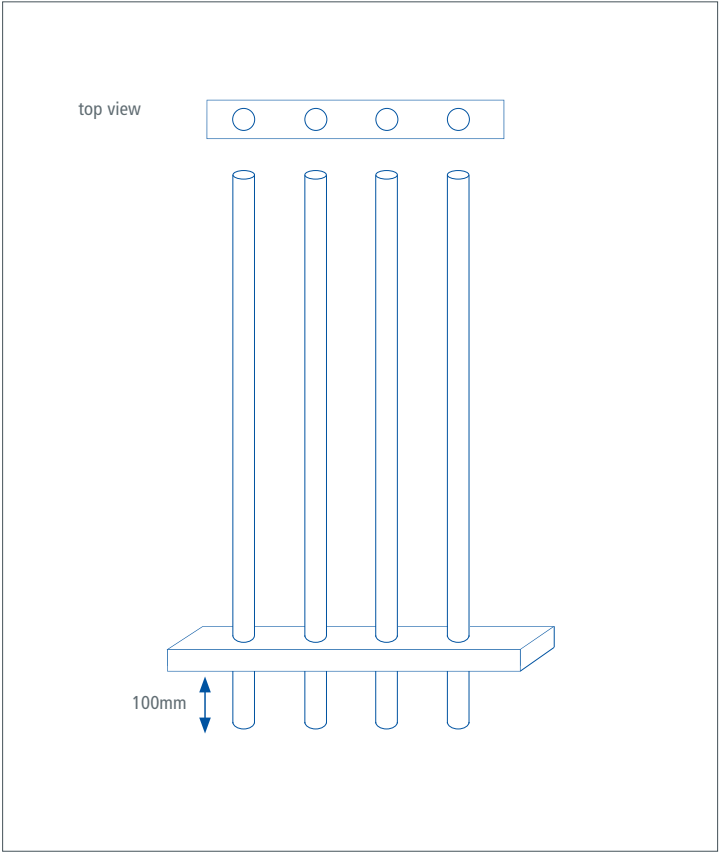

HEIGHT (MM)	POST CENTRES (MM)	POST DIMENSIONS (MM)	OVERALL POST LENGTH (MM)
1800	3000	60 x 60	2500
2000	3000	60 x 60	2800
2500	3000	80 x 60	3300
3000	2484	80 x 60	3800

FINISHES

- Hot dip galvanised to BS EN ISO 1461 as standard
- Hot dip galvanised and powder coated to BS EN 13438
- Marine coat for installations within 500m of salt water or an estuary

STANDARD COLOURS

- Black RAL 9005
- Green RAL 6005
- Other colours are available on request

APPROVALS

LPS 1175 SR1



BARBICAN® EXTRA SR1



Barbian® Extra LPS 1175 SR1 security fence panels are identical to standard Barbian® panels, but with an important difference; the additional pales through the top rail ensure that even the smallest hands or feet cannot gain access making it virtually impossible to climb or scale.

- LPS 1175 SR1 Approved
- Secured by Design Preferred Specification
- Seamless, concealed rail to post fixing
- Anti-climb design
- **25-year service life guarantee**

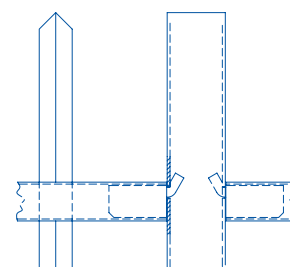

Post to panel fixings

APPLICATIONS

- ▶ Medium risk
- ▶ Transport
- ▶ Public spaces

PANELS

Barbian® Extra SR1 panels are up to 3000mm high and have two horizontal hollow section rails 60 x 40mm (3 rails if 3000mm high). Vertical rectangular hollow section 25 x 25mm pales are passed through the rails with standard spacing at 129mm centres, with additional pales through top rail and between each full pale.

GATES

SR1 gates available.

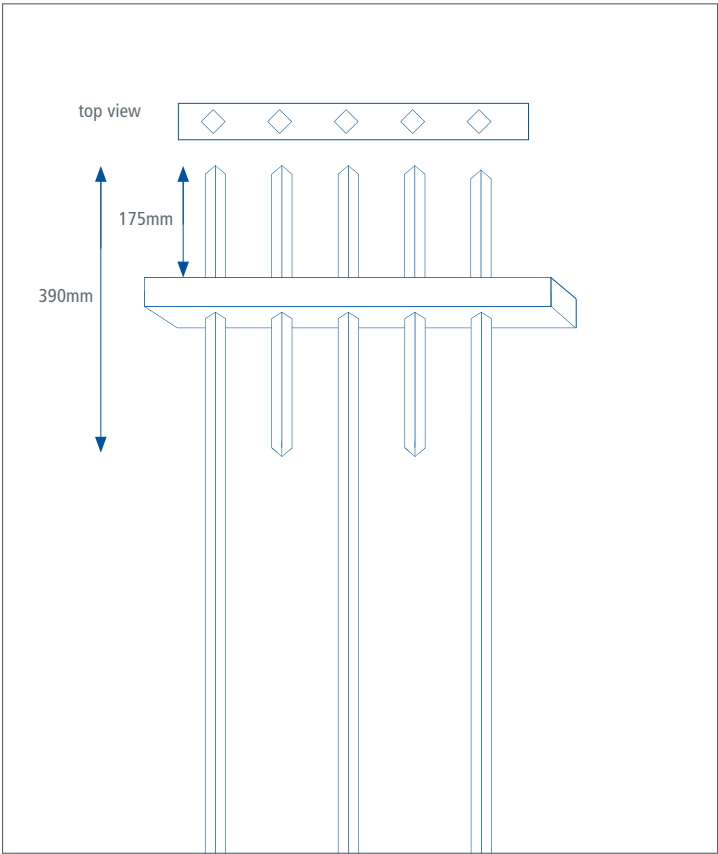

HEIGHT (MM)	POST CENTRES (MM)	POST DIMENSIONS (MM)	OVERALL POST LENGTH (MM)
2500	3000	80 x 60	3300
3000	2484	80 x 60	3800

FINISHES

- Hot dip galvanised to BS EN ISO 1461 as standard
- Hot dip galvanised and powder coated to BS EN 13438
- Marine coat for installations within 500m of salt water or an estuary

STANDARD COLOURS

- Black RAL 9005
- Green RAL 6005
- Other colours are available on request

APPROVALS

LPS 1175 SR1



BARBICAN® WITH FINIALS SR1



Barbican® with Finials SR1 LPS 1175 fencing and railings features a welded pale-through-rail design which means there are no bolts to be forced or palings cannot be removed.

The horizontal rails are sleeved on to the upright post with concealed fixings to provide a seamless design that is both stylish and incredibly strong.

- LPS 1175 SR1 Approved
- Secured by Design Preferred Specification
- Fully welded pale-through-rail construction
- Seamless, concealed vandal-proof rail to post fixing
- Anti-climb design
- Classic Saxon finial projects traditional railing design
- 25-year service life guarantee

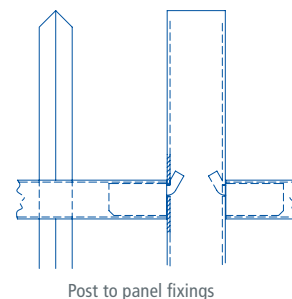

APPLICATIONS

- ▶ Commercial developments
- ▶ Public spaces

PANELS

Barbican® with Finials SR1 are up to 3000mm high and have two horizontal hollow sections rails 60 x 40mm (3 rails if 3000mm high). Vertical rectangular hollow section 25 x 25mm pales are passed through the rails with standard spacing at 129mm centres. The tops of pales are welded Saxon finials for additional security.

GATES

SR1 gates available

FINIAL



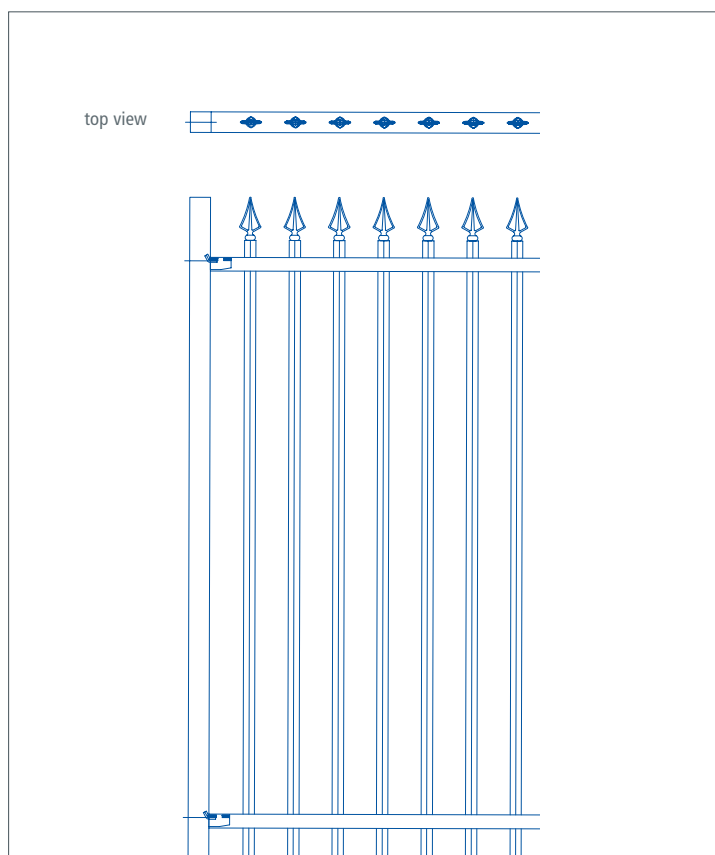

HEIGHT (MM)	POST CENTRES (MM)	POST DIMENSIONS (MM)	OVERALL POST LENGTH (MM)
1800	3000	60 x 60	2500
2000	3000	60 x 60	2800
2500	3000	80 x 60	3300
3000	2484	80 x 60	3800

FINISHES

- Hot dip galvanised to BS EN ISO 1461 as standard
- Hot dip galvanised and powder coated to BS EN 13438
- Marine coat for installations within 500m of salt water or an estuary

STANDARD COLOURS

- Black RAL 9005
- Green RAL 6005
- Other colours are available on request

APPROVALS

LPS 1175 SR1



BARBICAN® BARBED TOP SR1



Barbican® Barbed Top SR1 fencing with its menacing barbs welded to the top of the pales acts as a highly effective deterrent and barrier to intruders.

- LPS 1175 SR1 Approved
- Secured by Design Preferred Specification
- Anti-climb design
- Fully welded pale-through-rail construction
- **25-year service life guarantee**

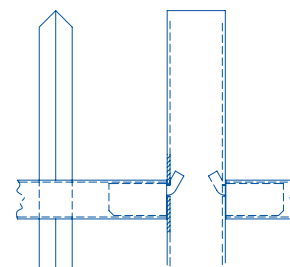

Post to panel fixings

APPLICATIONS

- ▶ Medium risk
- ▶ Utilities
- ▶ Construction sites

PANELS

Barbican® Barbed Top panels are up to 3000mm high and have two horizontal hollow section rails 60 x 40mm (3 rails if 3000mm high). Vertical rectangular hollow section 25 x 25mm pales are passed through the rails with standard spacing at 129mm centres, which has a 10mm round pointed bar added to each pale.

GATES

SR1 gates available

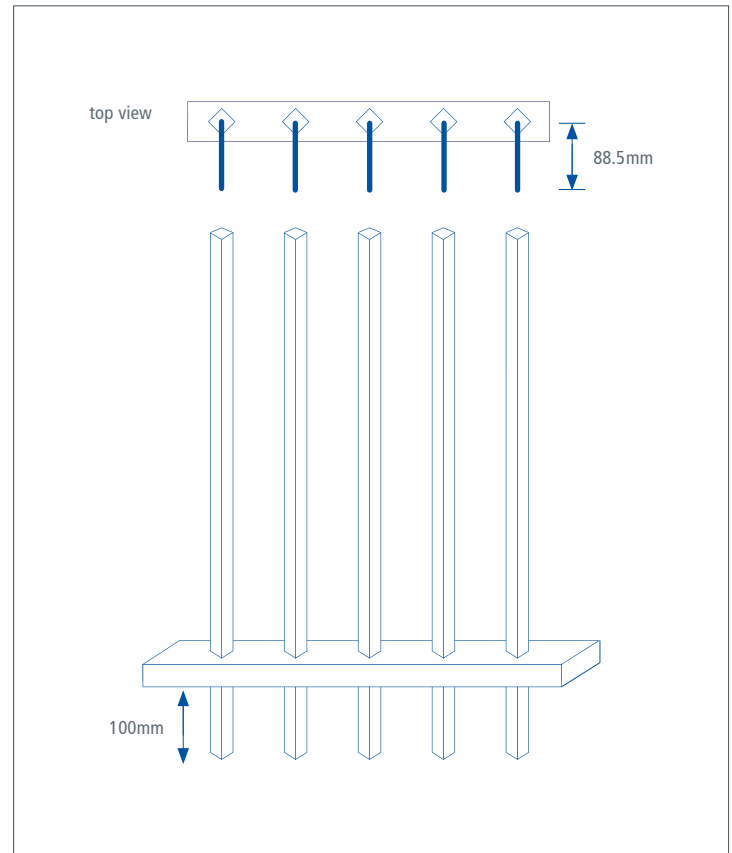

HEIGHT (MM)	POST CENTRES (MM)	POST DIMENSIONS (MM)	OVERALL POST LENGTH (MM)
2500	3000	80 x 60	3300
3000	2484	80 x 60	3800

FINISHES

- Hot dip galvanised to BS EN ISO 1461 as standard
- Hot dip galvanised and powder coated to BS EN 13438
- Marine coat for installations within 500m of salt water or an estuary

STANDARD COLOURS

- Black RAL 9005
- Green RAL 6005
- Other colours are available on request

APPROVALS

LPS 1175 SR1



BARBICAN® DEFENDER XTREME SR1



Barbican Defender® Xtreme SR1 projects a powerful visual statement in perimeter protection with a clear anti climb design. The security fence has curved square bar pales which are designed to prevent intruders from climbing or scaling the fence, whichever side it is approached.

- LPS 1175 SR1 approved
- Secured by Design Preferred Specification
- Seamless, concealed vandal-proof rail to post fixing
- Projecting cranked top pales make a powerful visual statement which deters scaling over
- Anti-climb design
- **25-year service life guarantee**

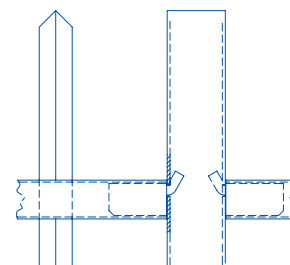

Post to panel fixings

APPLICATIONS

- ▶ High risk
- ▶ Commercial premises
- ▶ Utilities sites

PANELS

Constructed as per Barbican® panels but pales are extended and cranked 320mm from the top rail, with each one cut at 45 degrees to form a point.

GATES

SR1 gates available

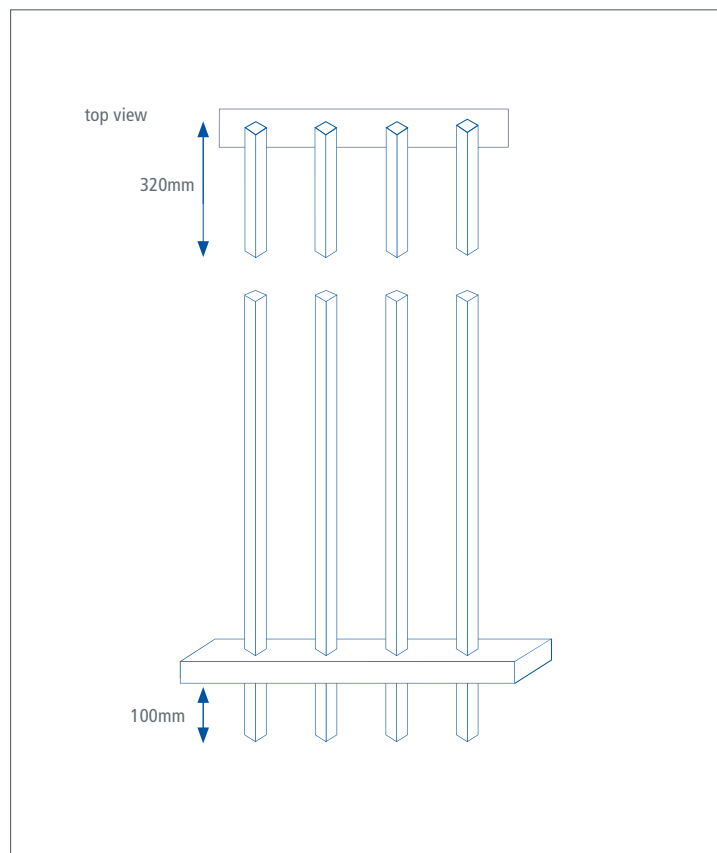

HEIGHT (MM)	POST CENTRES (MM)	POST DIMENSIONS (MM)	OVERALL POST LENGTH (MM)
2250	2484	80 x 60	3050
2500	2484	80 x 60	3300
3000	2484	80 x 60	3800

FINISHES

- Hot dip galvanised to BS EN ISO 1461 as standard
- Hot dip galvanised and powder coated to BS EN 13438
- Marine coat for installations within 500m of salt water or an estuary

STANDARD COLOURS

- Black RAL 9005
- Green RAL 6005
- Other colours are available on request

APPROVALS

LPS 1175 SR1



SENTRY® SR1



Jacksons Sentry® SR1 system offers a security rated vertical bar stopped pale-through-rail solution with a flat top which provides a surface suitable for a wide variety of security toppings. It's simple minimalist design is equally appropriate for contemporary or more traditional settings and is a great alternative to traditional physical security measures whilst providing improved boundary security.

- LPS 1175 SR1 Approved
- Secured by Design Preferred Specification
- Seamless, concealed vandal proof rail to post fixing
- Anti-climb design
- Fully welded pale-through-rail construction
- Double row of 25mm high sharp-pointed steel double comb for additional security comes as standard
- **25-year service life guarantee**

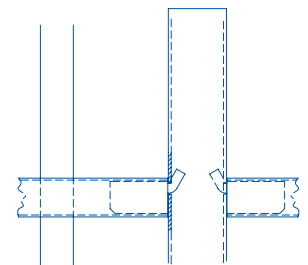

Post to panel fixings

APPLICATIONS

- ▶ Medium risk
- ▶ Perimeters
- ▶ Commercial premises

PANELS

Sentry® panels up to 3000mm high have two horizontal rectangular hollow section rails 60 x 40mm (3 rails if 3000mm high); Vertical round hollow section 32mm pales are passed through the rails with standard spacing at 129mm centres. Panels from 1800mm high have a security comb (double row of sharp steel points 23mm x 2mm thick).

GATES

SR1 gates available

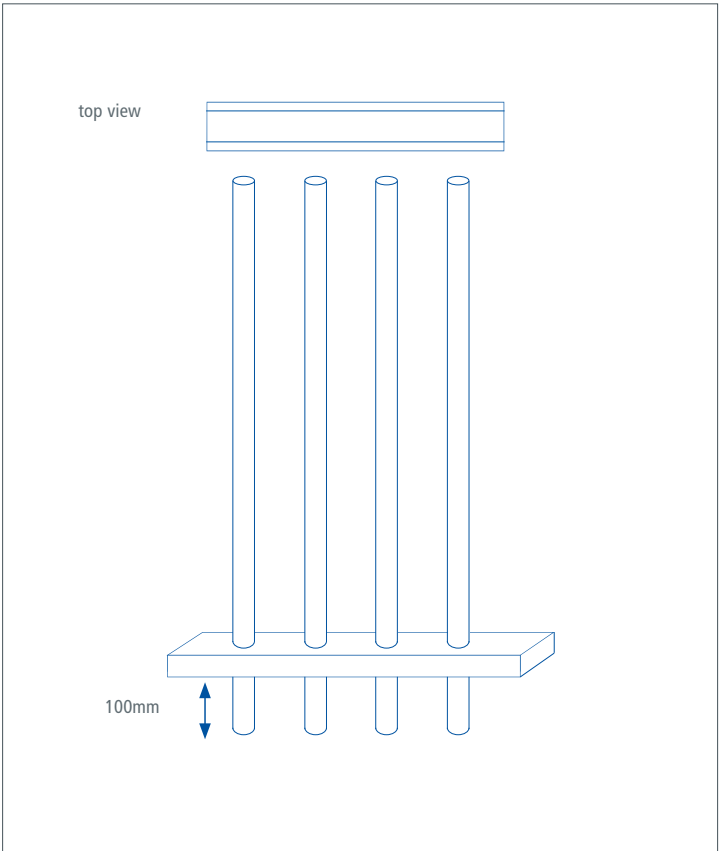

HEIGHT (MM)	POST CENTRES (MM)	POST DIMENSIONS (MM)	OVERALL POST LENGTH (MM)
1800	3000	60 x 60	2500
2000	3000	60 x 60	2800
2500	3000	80 x 60	3300
3000	2484	80 x 60	3800

FINISHES

- Hot dip galvanised to BS EN ISO 1461 as standard
- Hot dip galvanised and powder coated to BS EN 13438
- Marine coat for installations within 500m of salt water or an estuary

STANDARD COLOURS

- Black RAL 9005
- Green RAL 6005
- Other colours are available on request

APPROVALS

LPS 1175 SR1



EUROGUARD® PLATFORM HEAVY SR1



EuroGuard® Flatform Heavy SR1 system features a flat profile with heavy gauge double horizontal wire for added strength and rigidity. It is ideal for sites requiring good visibility and security.

- LPS 1175 SR1 Approved
- Secured by Design Preferred Specification
- Mesh size 200 x 50mm
- Anti-climb design
- **25-year service life guarantee**

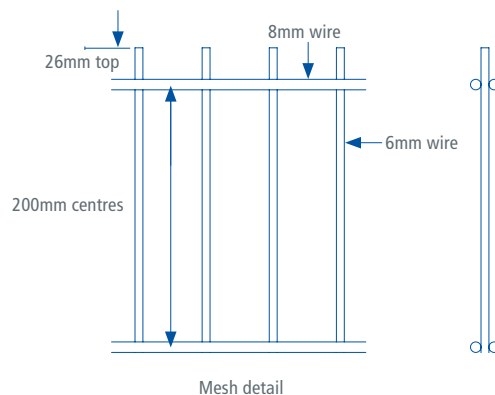

APPLICATIONS

- ▶ Commercial premises
- ▶ Schools
- ▶ Perimeters

PANELS

EuroGuard® Flatform SR1 consists of 200mm x 50mm mesh, double 8mm horizontal wire, 6mm vertical wire.

GATES

SR1 gates available

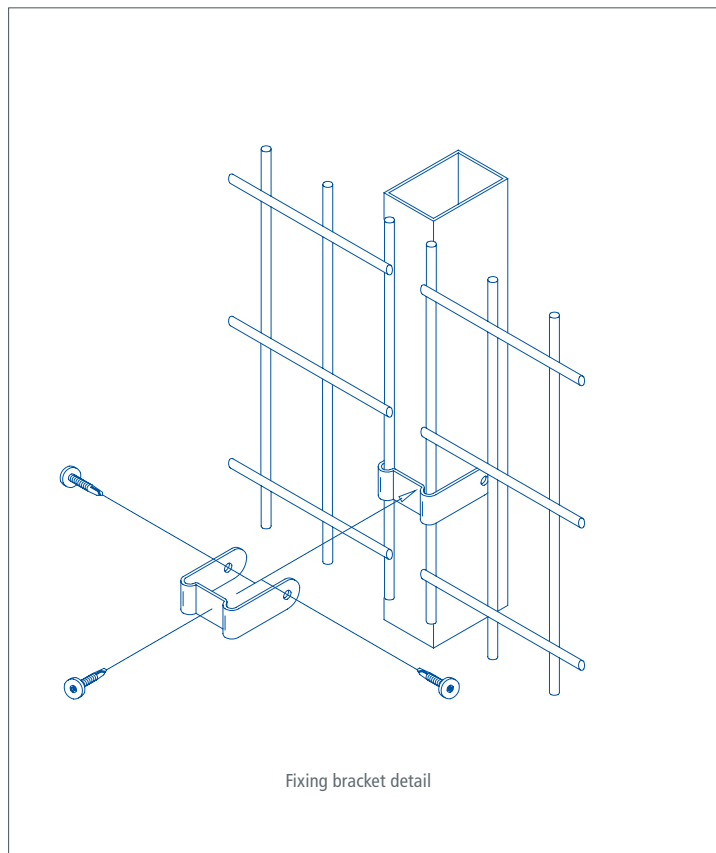

HEIGHT (MM)	POST CENTRES (MM)	POST DIMENSIONS (MM)	OVERALL POST LENGTH (MM)
2030	3034	60 x 40	2800
2430	3054	80 x 60	3300

FINISHES

- Panels are Galvan[®] zinc alloy coated to BS EN 10244-2:2009 class A as standard
- Powder coated to BS EN 13438
- Marine coat for installations within 500m of salt water or an estuary

STANDARD COLOURS

- Black RAL 9005
- Green RAL 6005
- Other colours are available on request

APPROVALS

LPS 1175 SR1



EUROGUARD® COMBI SR1



EuroGuard® Combi SR1 LPS 1175 fencing brings our experience and reputation in steel and timber fencing and gates together in a design that combines natural wooden slats with the strength of steel mesh.

The combination of robust welded mesh panels and closely spaced, substantial timber slats provide a flat facing surface with no foot or hand holds.

- LPS 1175 SR1 Approved
- Secured by Design Preferred Specification
- Jakcure® treated timber slats
- **25-year service life guarantee**

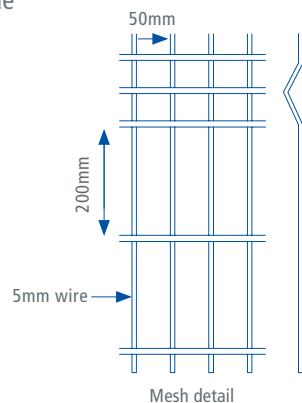

APPLICATIONS

- ▶ Commercial premises
- ▶ Medium risk
- ▶ Schools

PANELS

EuroGuard® Combi SR1 panels 3m wide with 200mm x 45mm mesh, 5mm wires with 2 - 4 reinforcing folds according to height.

GATES

SR1 gates available

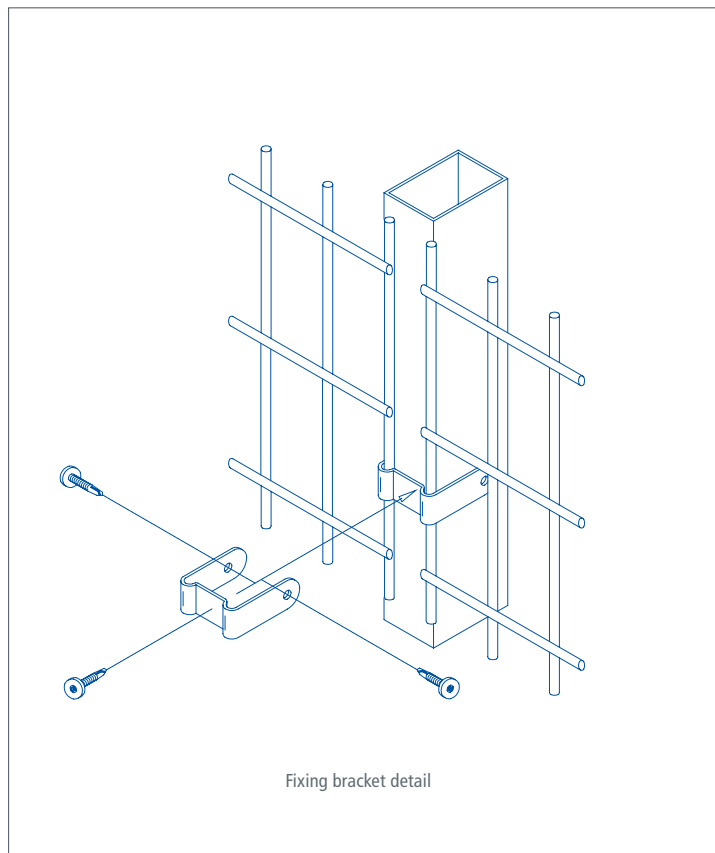

HEIGHT (MM)	POST CENTRES (MM)	POST DIMENSIONS (MM)	OVERALL POST LENGTH (MM)
2070	3054	80 x 60 + spur post	2800
2470	3054	80 x 60 + spur post	3300
3110	3054	120 x 60 + spur post	4000

FINISHES

- Panels are Galfan® zinc alloy coated to BS EN 10244-2:2009 class A as standard
- Powder coated to BS EN 13438
- Marine coat for installations within 500m of salt water or an estuary

STANDARD COLOURS

- Black RAL 9005
- Green RAL 6005
- Other colours are available on request

APPROVALS

LPS 1175 SR1



SECURI-MESH® PLUS SR2

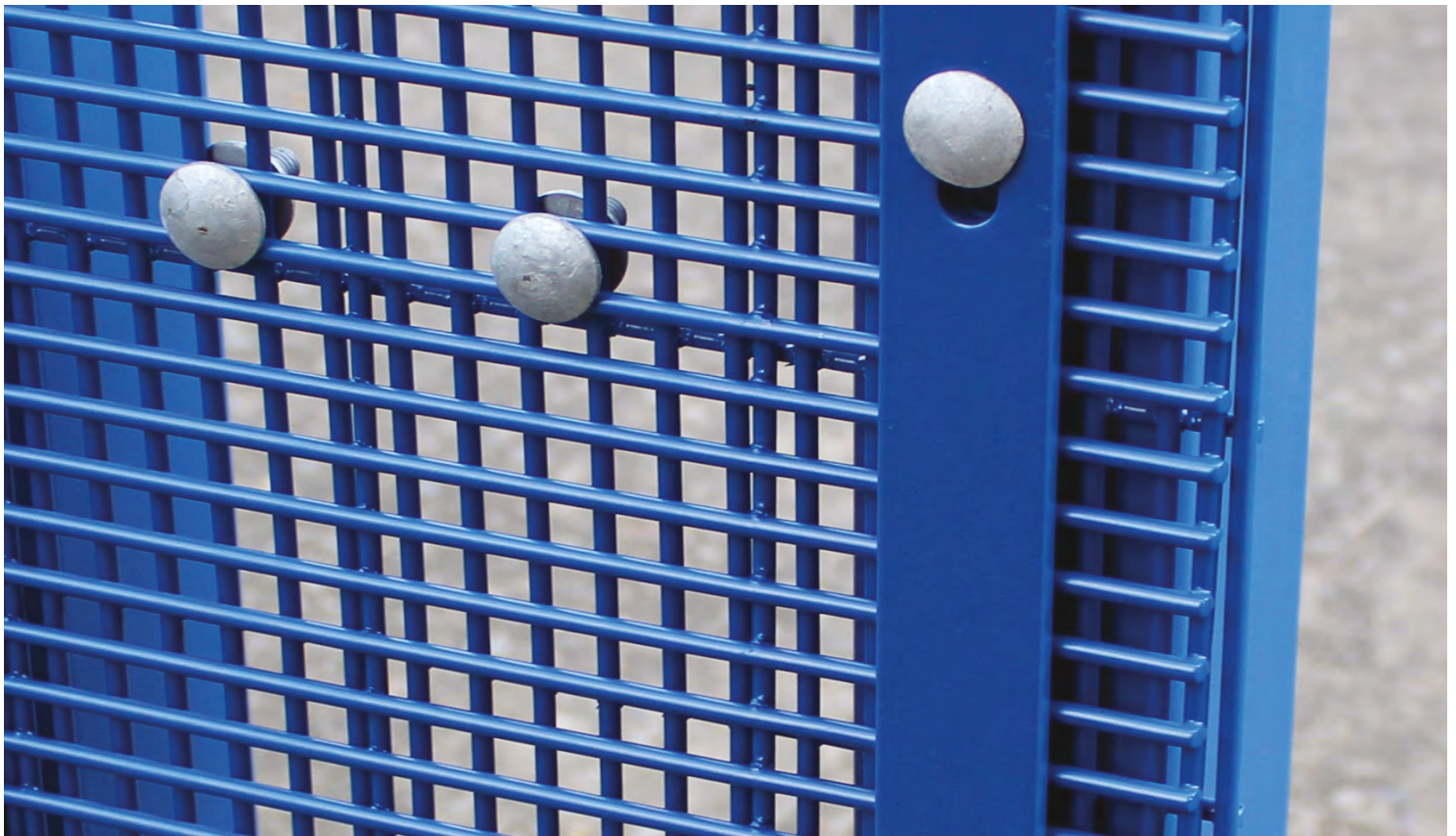

The Securi-Mesh® Plus SR2 rated system provides an ideal solution for a wide variety of higher security perimeter applications with its double layer of "358" mesh and small apertures which eliminate foot and finger holds and prevent objects from being passed through. The vertical steel clamp bars employed in the panel to post fixing and to bond the mesh layers together provide increased rigidity to the design and make the system particularly resistant to cutting through using conventional hand and portable power tools.

- LPS 1175 SR2 Approved
- Secured by Design Preferred Specification
- Stainless steel fixings
- Jaktronic® PIDS compatible
- **25-year service life guarantee**

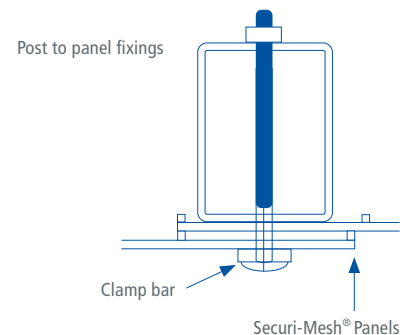

APPLICATIONS

- ▶ High risk
- ▶ Perimeters
- ▶ Utilities sites

PANELS

The Securi-Mesh® Plus SR2 has staggered double skin of 76.2mm x 12.7mm resistance mesh welded at each intersection up to 2400mm only. Second panel is an internal skin only, single skin then from 2400mm upwards.

GATES

SR2 gates available

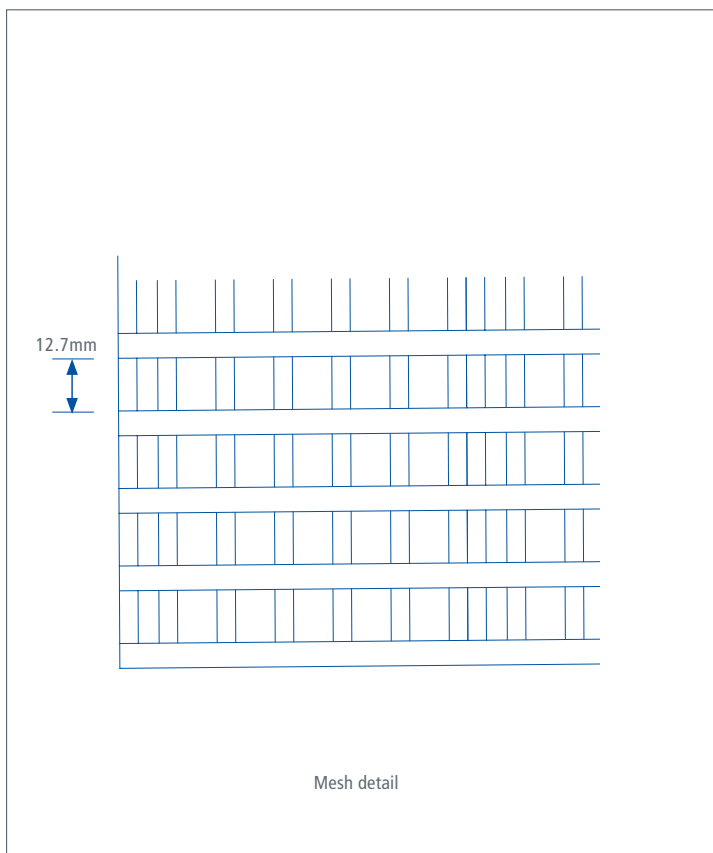
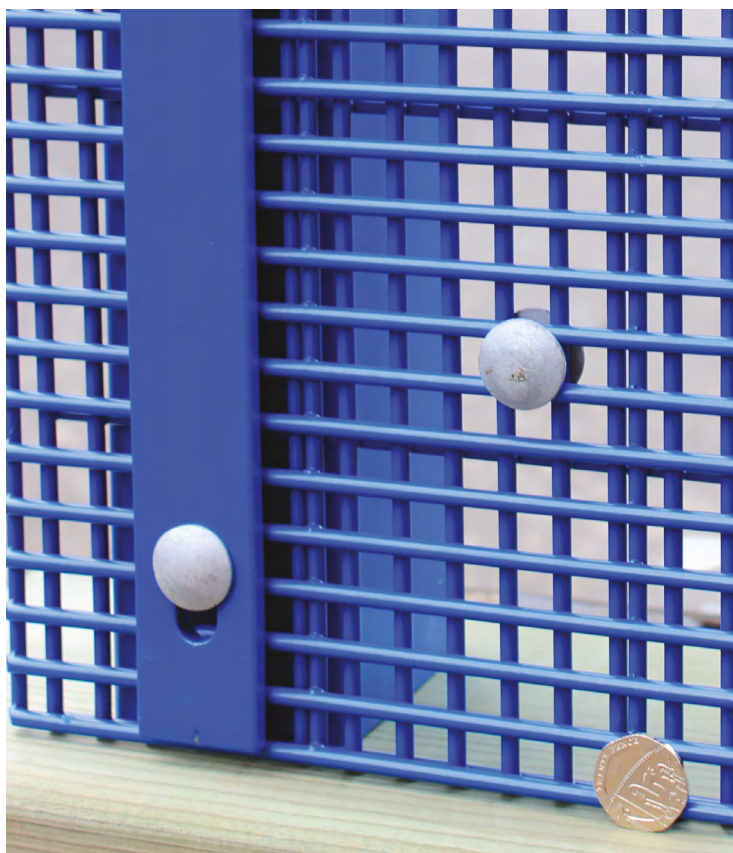

HEIGHT (MM)	POST CENTRES (MM)	POST DIMENSIONS (MM)	OVERALL POST LENGTH (MM)
2442	2442	120 x 60 or 80 x 60 to suit site	3250

FINISHES

- Panels are Galfan® zinc alloy coated to BS EN 10244-2:2009 class A as standard
- Powder coated to BS EN 13438
- Marine coat for installations within 500m of salt water or an estuary

STANDARD COLOURS

- Black RAL 9005
- Green RAL 6005
- Other colours are available on request

APPROVALS

LPS 1175 SR2



JAKOUSTIC® CLASS 3



Jakoustic® Class 3 has been approved to Security Rating 3, products certified to these standards resist experienced attempts at forced entry using a wide range of tools.

Jakoustic® Class 3 is an acoustic fence which can reduce sound by up to 28dB* which has also has resisted experienced attempts at forced entry using a wide range of tools including battery powered tools lasting up to 5 minutes.

- LPS 1175 SR3 Approved
- Secured by Design Preferred Specification
- Flat face allowing no foot or hand holds
- Up to 28 dB in noise*
- Can accommodate changes in level or profile
- Rota Spike® optional
- 25 year Jakcure® treatment guarantee

APPLICATIONS

- ▶ Commercial premises
- ▶ Medium risk - High risk
- ▶ Schools

PANELS

Constructed from our unique Jakoustic reflective boards, using an interlocking "V" system. The special profile has been carefully developed to locate boards in such a way that it eliminates gaps that sound could easily travel through.

GATES

Matching single leaf and double leaf gates available



*Jakoustic® barrier certified laboratory results:

Rating according to BS EN 1793-2:1998

Category = B3

Laboratory sound reduction 28 dB

Superficial mass 25kg/m²

HEIGHT (MM)	NOMINAL POST CENTRES (MM)
2500	2410
2750	2410
3000	2410
3250	2410

FINISH

Natural Jakcure® finish as standard

POSTS

To suit fence height

APPROVALS

LPS 1175 SR3



UHS HEAVY MESH SR3



UHS Heavy Mesh SR3 has been designed and tested to withstand forced entry using tools which include battery power tools. The SR3 mesh system is constructed from 250mm wire double skinned mesh with clamp bars added at 250mm centres and anti tamper fixings.

- Heavy gauge wire-welded mesh security fencing system
- LPS 1175 SR3 Approved
- Secured by Design Preferred Specification
- Double skinned - providing a high level of security
- Designed to be used in high security applications
- Stainless steel fixings
- Anti-climb design
- Double 50 x 28mm mesh - creating a smaller aperture
- Clamp bars fitted at 250mm centres

FINISHES

- ▶ Panels are Galfan® zinc alloy coated as standard
- ▶ Optional powder coating to BS EN 13438
- ▶ Optional marine coat for installations within 500m of salt water or an estuary

POST OPTIONS

- ▶ Over length set in concrete as standard
- ▶ Base plated to bolt down onto concrete

GATES

Matching single leaf and double leaf gates available

UHS EXTREME MESH SR3



UHS Extreme Mesh SR3 has been designed and tested to withstand forced entry using tools which include battery power tools. The SR3 mesh system is constructed from double skinned mesh providing a high level of security. The fencing and gate system has been developed to meet with demands to give a robust level of security around high security applications.

- LPS 1175 SR3 Approved
- Secured by Design Preferred Specification
- Double skinned - providing a high level of security
- Designed to be used in high security applications
- Anti-climb design
- Stainless steel fixings
- Double 50 x 30mm mesh - creating a smaller aperture

FINISHES

- ▶ Panels are Galfan® zinc alloy coated as standard
- ▶ Optional powder coating to BS EN 13438
- ▶ Optional marine coat for installations within 500m of salt water or an estuary

POST OPTIONS

- ▶ Over length set in concrete as standard
- ▶ Base plated to bolt down onto concrete

GATES

Matching single leaf and double leaf gates available

TRIDENT® 4 & TRIDENT® 5



Vertical Bar and Welded Mesh panel security fencing systems.

Fence panels comprise of reinforced 32mm tubular vertical bars welded within 60mm x 40mm horizontal rails. The panels incorporate '358' mesh and are welded on both faces, with an 800mm concertina barbed tape topping.

- Closely spaced pales of substantial wall thickness
- Incorporating cut-delay technology (self healing)
- Jaktronic® PIDS compatible
- **25-year service life guarantee**

APPLICATIONS

- ▶ High risk
- ▶ Transport
- ▶ Government
- ▶ Utilities
- ▶ Ports

GATES

Matching single leaf and double leaf gates available

FINISHES

- Hot dip galvanised to BS EN ISO 1461 as standard
- Hot dip galvanised and powder coated to BS EN 13438
- Marine coat for installations within 500m of salt water or an estuary



Trident® 4

- LPS 1175 SR4 Approved
- Securi-Mesh® fencing clad on both sides

HEIGHT (MM)	PANEL WIDTH (MM)	POST DIMENSIONS (MM)	TOPPING
3600	2450	120 x 120	Concertina barbed wire

Trident® 5

- LPS 1175 SR5 Approved
- Securi-Mesh® fencing clad on both sides

HEIGHT (MM)	PANEL WIDTH (MM)	POST DIMENSIONS (MM)	TOPPING
4200	2450	120 x 120	Concertina barbed wire

STANDARD COLOURS

- Black RAL 9005
- Green RAL 6005
- Other colours are available on request

APPROVALS

LPS 1175 SR4

LPS 1175 SR5

