

Profiles for maintenance free movement joints

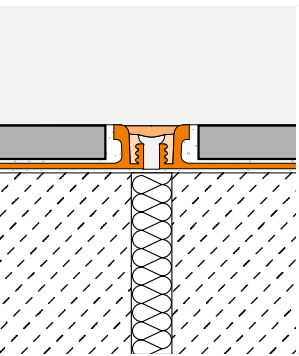

Schlüter®-DILEX



Colour swatch

	BW brilliant white RAL 9010
	CG yellow RAL 10211
	G grey RAL 7030
	GS black RAL 9011
	HB light beige RAL 1019
	PG pastel grey no RAL
	SP soft peach no RAL
	ZR brick red RAL 8004

Anodised finishes

AE = anodised alu.
ACG = polished chrome anodised alu.
ACGB = brushed chrome anodised alu.



Movement joints are essential

Although at first glance they don't appear to move, tiles, screed, and concrete are "living" materials. Even massive structures made of these materials are constantly subject to form changes (deformation). Such deformations are caused by drying, loads, changes in moisture content and temperature fluctuations, which can combine and compound one another.

To ensure that deformation does not cause damage, screed and covering assemblies e.g., tiled floors, must include movement joints, which allow movement to occur limiting stresses which could cause damage to the covering. The requirements listed in BS 5385 parts 1-5, must be observed. These information documents also include specific recommendations regarding the width and positioning arrangements of the joints.

Schlüter®-Systems offers the option of producing movement joints with Schlüter®-DILEX profiles. In contrast to conventional sealant joints, such joints are permanently maintenance free. They are established in conjunction with the installation of the tiles, eliminating the need for additional installation requirements. This information brochure illustrates the installation of profiles to create movement joints as an alternative to the use of elastic sealants.

Movement profiles are distinguished by function

Structural joints (expansion joints) are joints required for static or engineering reasons, which divide a building in various movement segments. They run through all load bearing and non load bearing parts of a building and must be continued in the screed construction and the floor covering at the identical location and in the specified width.

Intermediate joints create a pattern of limited fields in large areas of screed and covering. They must be continued from the surface of the covering to the separating layer under the screed or to the covering of the insulation or waterproofing layer. In door transition areas, the screed should contain movement joints, which are continued in the covering to reduce stresses occurring at these locations and to prevent the transmission of impact sound. Movement joints in the substrate may not be closed or covered with flooring materials.

Perimeter joints are movement joints placed in the screed and the covering along walls and construction elements that penetrate the screed, such as columns. They reduce impact sound transmission and absorb the movements of the floor assembly. Edge joints may not be rigidly closed, since this may lead to the formation of sound bridges and tensions in the covering construction.

Our range of movement joints includes cove-shaped profiles for wall/floor transitions and inside wall corners. They are designed to allow for especially easy cleaning.

Connection joints are movement joints placed in the screed and the covering at construction elements such as window openings, doorframes, shower trays and bath tubs.



This type of damage is preventable with Schlüter®-DILEX movement profiles.



Structural joints



Schlüter®-DILEX-KSBT is a structural movement profile with edge protection, consisting of side anchoring legs of aluminium, or stainless steel connected to a 20 mm or 30 mm wide movement zone of soft synthetic rubber (check suitability for areas exposed to high point loads, e.g. stiletto heels).

Length supplied (= H):

Stainless steel: 8 - 10 - 12.5 - 14 - 16 - 18.5 - 21 - 25 - 30 mm

Aluminium: 8 - 10 - 12.5 - 14 mm

Colours*: G - GS - HB

Accessories: Stainless steel insert for the movement zone of KSBT 30

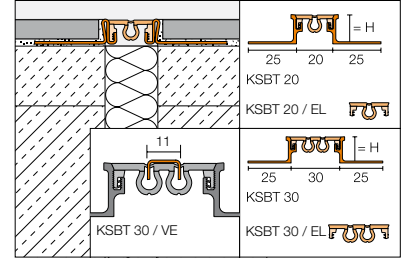

Schlüter®-DILEX-BT is a structural expansion joint made of aluminium or brass with lateral joint connections to a sliding telescopic centre section. This allows for absorption of three dimensional movement.

Length supplied (= H):

Aluminium: 8 - 10 - 12.5 - 15 - 17.5 - 20 mm

Anodised aluminium: 8 - 10 - 12.5 - 15 - 17.5 - 20 mm

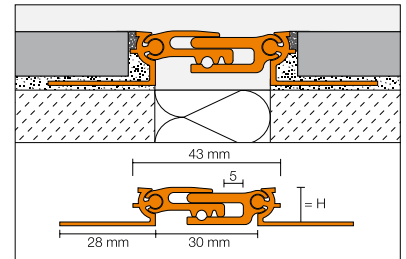

Intermediate joints

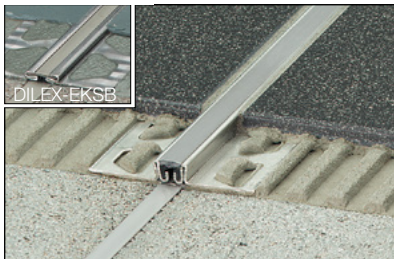

Schlüter®-DILEX-KS is a movement profile with edge protection consisting of lateral anchoring legs made of aluminium, or stainless steel, which are connected to a replaceable movement zone made of soft rubber.

Length supplied (= H):

Stainless steel: 8 - 10 - 11 - 12.5 - 14 - 16 - 18.5 - 21 - 25 - 30 mm

Aluminium: 8 - 10 - 11 - 12.5 - 14 mm

Colours*: G - GS - HB - PG

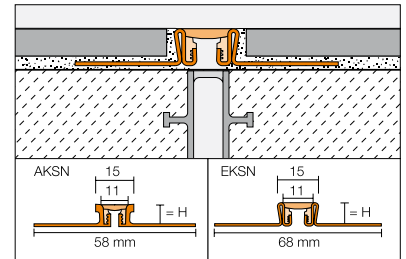

Schlüter®-DILEX-AKWS is a movement profile with side anchoring legs of aluminium connected to a soft PVC movement zone.

Length supplied (= H):

H = 8 - 9 - 10 - 11 - 12.5 - 14 - 16 - 21 mm

Colours*:

G - GS - HB - PG

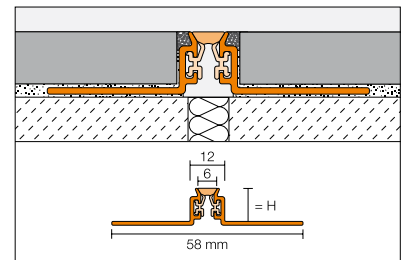

Schlüter®-DILEX-EDP is a stainless steel movement profile, which allows horizontal movement through a tongue and groove connection.

Length supplied (= H):

H = 8 - 9 - 10 - 11 - 12.5 - 14 - 16 - 18.5 - 21 - 25 - 30 mm

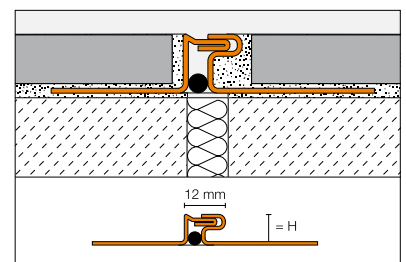



Intermediate joints



Schlüter®-DILEX-BWB is a movement joint profile with side sections of rigid, recycled plastic. The top movement zone is made of soft CPE and creates the 10 mm wide visual surface.

Length supplied (= H):

H = 6 - 8 - 10 - 12.5 - 15 - 20 mm

Colours*: BW - G - GS - HB - PG - SP

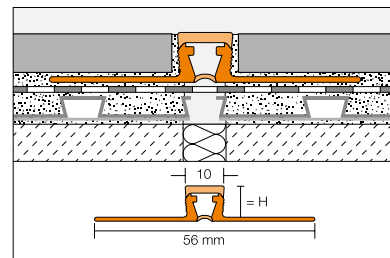

Schlüter®-DILEX-BWS is a movement joint profile with side sections of rigid, recycled plastic. The movement zone consists of soft CPE and creates the 5 mm wide visual surface.

Length supplied (= H):

H = 4.5 - 6 - 8 - 9 - 10 - 11 - 12.5 mm

Colours*: BW - G - GS - HB - PG - SP

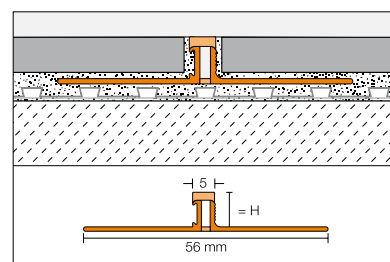

Schlüter®-DILEX-EP is a movement joint profile for application in floating or bonded screeds. The side sections consist of rigid, recycled plastic connected on the top and bottom with soft, grey CPE movement zones.

Length supplied (= H):

H = 30 - 40 - 50 mm

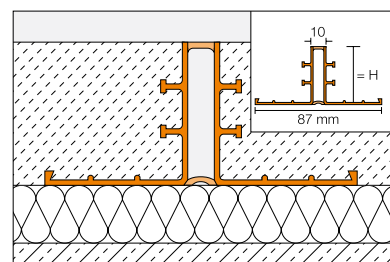

Schlüter®-DILEX-MOP is an expansion joint profile with serrated side walls made of rigid, recycled PVC and a grey, soft PVC expansion zone for use in screed applications.

The profile is able to absorb compression stresses, but not tensile stresses.

Length supplied (= H):

H = 35 - 50 - 65 mm

Colours*: G

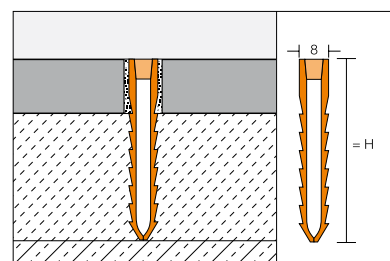

Schlüter®-DILEX-MP/-MPV is an expansion joint profile with undercut side walls made of rigid, recycled PVC and a soft CPE expansion zone, complete with extension profiles for use in the laying of screeds.

The profile is able to absorb compression stresses, but not tensile stresses.

Profile height:

DILEX-MP 35 mm

Extensions:

DILEX-MPV 15 und 25 mm

Colours*:

G - GS - HB - ZR

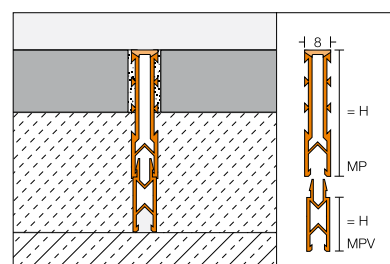



Intermediate joints



Schlüter®-DILEX-EMP is a stainless steel movement profile for screeds. The tongue and groove connections accommodate horizontal movement.

Length supplied (=H):
H = 35 - 50 - 65 mm

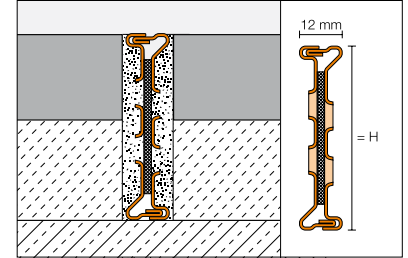

Schlüter®-DILEX-EZ 70 is a stress relieving and decorative profile with undercut side walls made of rigid PVC and a soft PVC expansion zone for use in screeds. The extension segments can be removed to adjust the profile height to the height of the assembly. The profile is able to absorb compression stresses, but not tensile stresses.

Length supplied (=H): 70 mm
Colours: G (grey); M (brass insert); C (chrome insert)

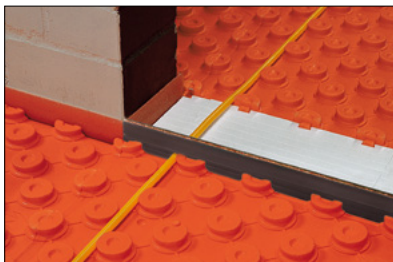
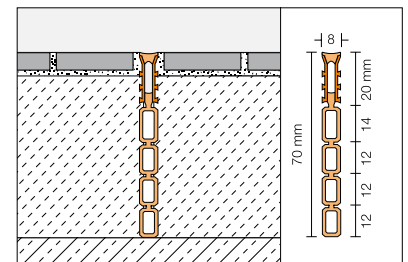

Schlüter®-DILEX-DFP is a movement joint profile to be installed at door areas or used to divide screed areas.

Length supplied (= H):
H = 60 - 80 - 100 mm

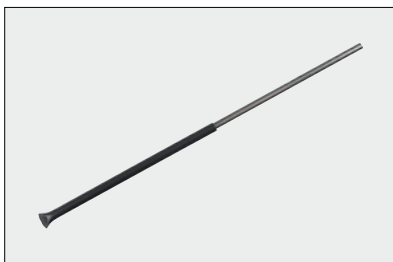
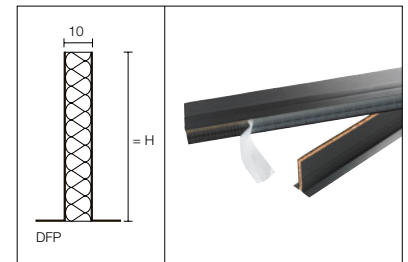

Schlüter®-DILEX-HVD a height offset dowel for installation in the screed, helps prevent height discrepancies between two screed sections in the area of a movement joint.

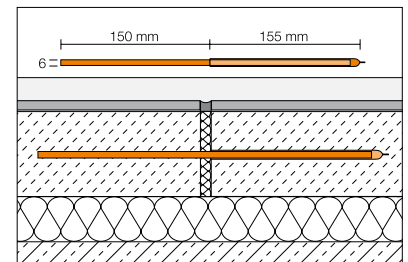

Perimeter and corner joints



Schlüter®-DILEX-RF is a two-part corner profile made of recycled, rigid PVC and soft CPE for durable, flexible, and maintenance free perimeter joints between floors and walls.

Length supplied (=U/O):
U = 10 - 12.5 - 15 - 18 - 22 mm
O = 8 - 10 - 12.5 - 15 - 18 mm

Colours*: G - PG

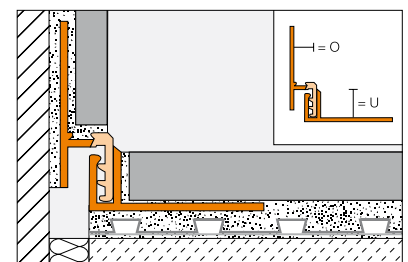



Perimeter and corner joints



Schlüter®-DILEX-EK is a two-part corner profile made of recycled, rigid PVC and soft CPE for durable, flexible, and maintenance free perimeter joints between floors and walls or floors and skirtings.

Length supplied (=U/O):

U = 8 - 11 - 15 mm

O = 7 - 10 - 14 mm

Colours*:

BW - G - GS - HB - PG

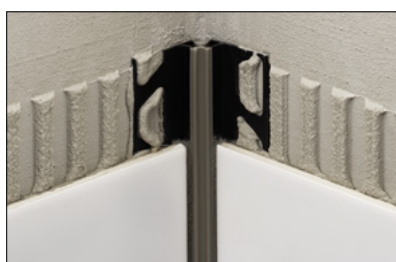
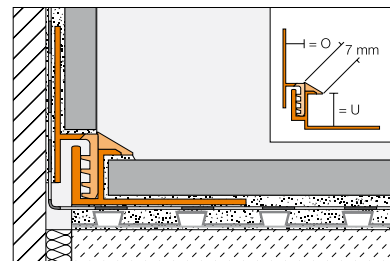

Schlüter®-DILEX-EF is a flexible, single piece corner profile of rigid and soft PVC for inside wall corners of floor/wall transitions, which can be used for non-floating covering assemblies.

Length supplied (=H):

H = 8 - 10 - 12.5 - 15 mm

Colours*: BW - G - HB - PG - SP

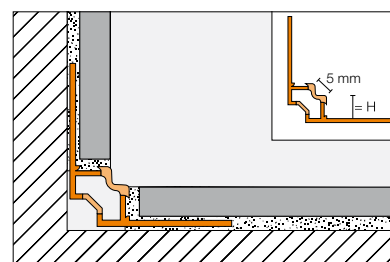

Schlüter®-DILEX-EKE is a corner movement profile that effectively absorbs movement at inside wall corners and at floor/wall transitions in applications where no large movement is expected.

Length supplied (=U/O):

U 8 / O 7 mm U 9 / O 8 mm

U 11 / O 10 mm U 13 / O 12 mm

U 15 / O 14 mm

Colours*: BW - G - GS - HB - PG - SP

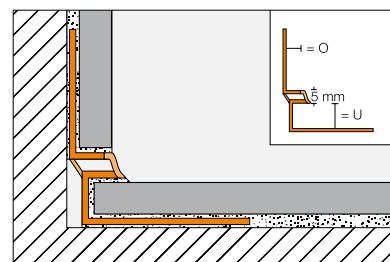

Schlüter®-DILEX-HKW is a cove shaped profile for internal wall corners and wall/floor joints in applications where only slight movement occurs.

Length supplied (=U/O):

U 7 / O 7 mm

U 9 / O 9 mm

U 11 / O 11 mm

Colours*: BW - G - HB - PG

Accessories: Inside and outside corners, end caps

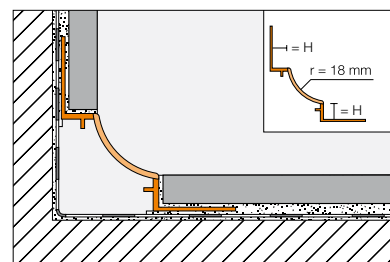

Schlüter®-DILEX-HK is a cove shaped profile for wall/floor joints, which conforms to the hygienic requirements of commercial bathrooms and the food processing industry.

Length supplied (=U/O):

U 12 / O 9 mm

Colours*: BW - G - HB

Accessories: Inside and outside corners, end caps, and connectors

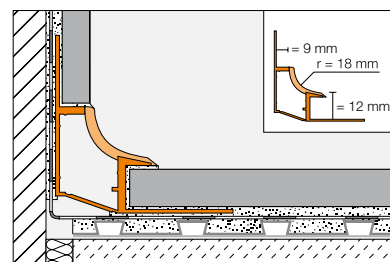



Corner joints



Schlüter®-DILEX-HKS is a cove shaped, stainless steel profile with a maintenance free movement zone for floor/wall connections in ceramic tile coverings. Also available in brushed finishes.

Length supplied (=U/O):

U = 8 - 10 - 12 - 14 - 16 - 18 - 21 - 25 - 30 mm

O = 7 - 9 - 11 mm

Colours*: G - GS - HB - PG

Accessories: Inside and outside corners, connectors

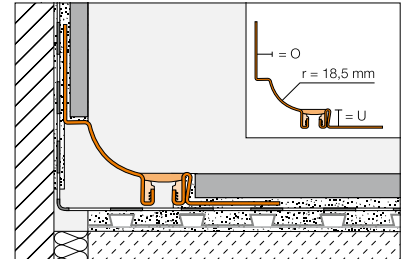

Schlüter®-DILEX-EHK is a stainless steel, cove shaped profile for internal wall corners or for floor/wall transitions with high hygienic requirements. Also available in brushed finishes.

Length supplied (=U/O):

U 7/ O 7 mm, U 9/ O 9 mm, U 11/ O 11 mm

Accessories: Inside and outside corners, connectors

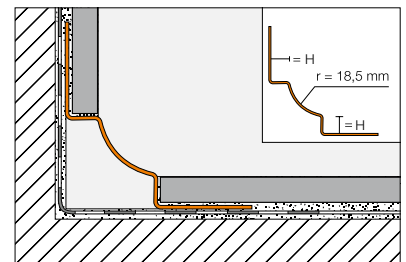

Schlüter®-DILEX-HKU is a cove shaped profile entirely made of stainless steel for internal wall corners and floor wall transitions with stringent hygiene requirements. Due to its inner anchoring leg, the profile can be variably used for different tile thicknesses. Also available in brushed finishes.

Length supplied (=H):

H = 8 mm

Accessories: Inside and outside corners, connectors

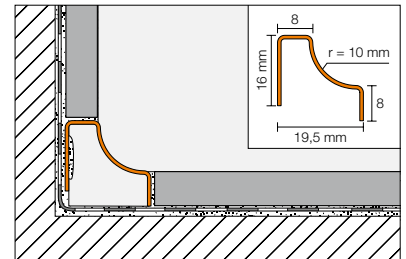

Schlüter®-DILEX-AHKA is a cove shaped aluminium profile for internal wall corners, kitchen worktops or surfaces with ceramic coverings. It is available in a variety of anodised finishes and can be connected to existing coverings on one side.

Length supplied (=H):

H = 8 - 10 - 12.5 - 15 mm

Oberflächen*: AE, ACGB

Accessories: Outside corners, end caps

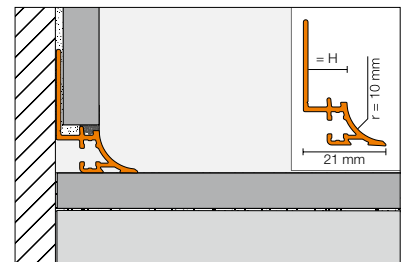

Schlüter®-DILEX-AHK is a cove shaped aluminium profile for inside wall corners. It is available with a variety of anodised surfaces.

Length supplied (=U/O):

H = 8 - 10 - 12.5 mm

Finishes*: AE, ACG, ACGB

Accessories: Outside corners

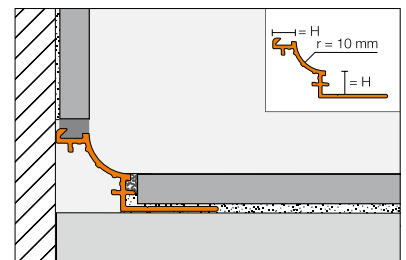



Connection joints



Schlüter®-DILEX-KSA is a connection profile with edge protection. The profile's anchoring legs, made of brass, aluminium, or stainless steel, are connected to a replaceable movement zone made of soft PVC. The profile is used for creating transitions between coverings and fixed structures, such as windows.

Length supplied (=H):

Stainless steel: 8 - 10 - 11 - 12.5 - 14 - 16 - 18.5 - 21 - 25 - 30 mm

Aluminium: 8 - 10 - 11 - 12.5 - 14 mm

Colours*: G - GS - HB - PG

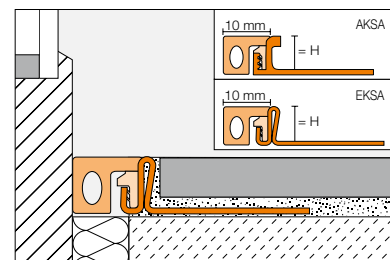

Schlüter®-DILEX-BWA provides a flexible connection between tiled surfaces and existing coverings or structures, such as door and window frames.

Length supplied (=H):

H = 4,5 - 6 - 8 - 10 - 12,5 mm

Colours*: BW - G - GS - HB - PG

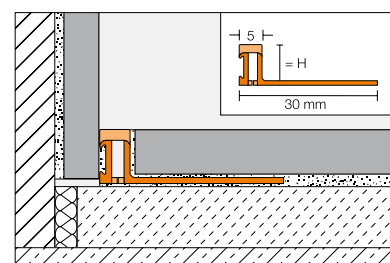

Schlüter®-DILEX-AS is a joining profile for creating flexible joints to fixtures such as shower trays, baths, door and window frames.

For tile thicknesses 6 - 12 mm.

Colours*: BW

Accessories: Inside corners and end caps

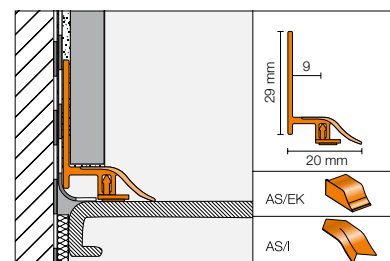

Schlüter®-DILEX-EZ 6 + 9 combine decorative design with a stress relieving function for tile and natural stone surfaces laid in a thin bed of adhesive.

Length supplied (=H): 6 - 9 mm

Colour combinations:** M/G (brass insert / grey),

C/CG (chrome insert / yellow)

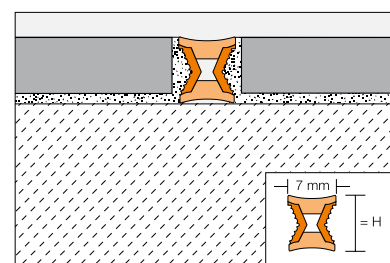

* See annex for colour code

** The profiles have two exposed areas that may vary in colour