

# Fundo Top Slim-Kit

A practical complete set for the perfect shower

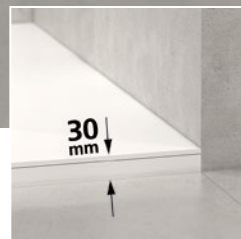

NEW

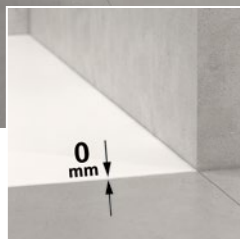
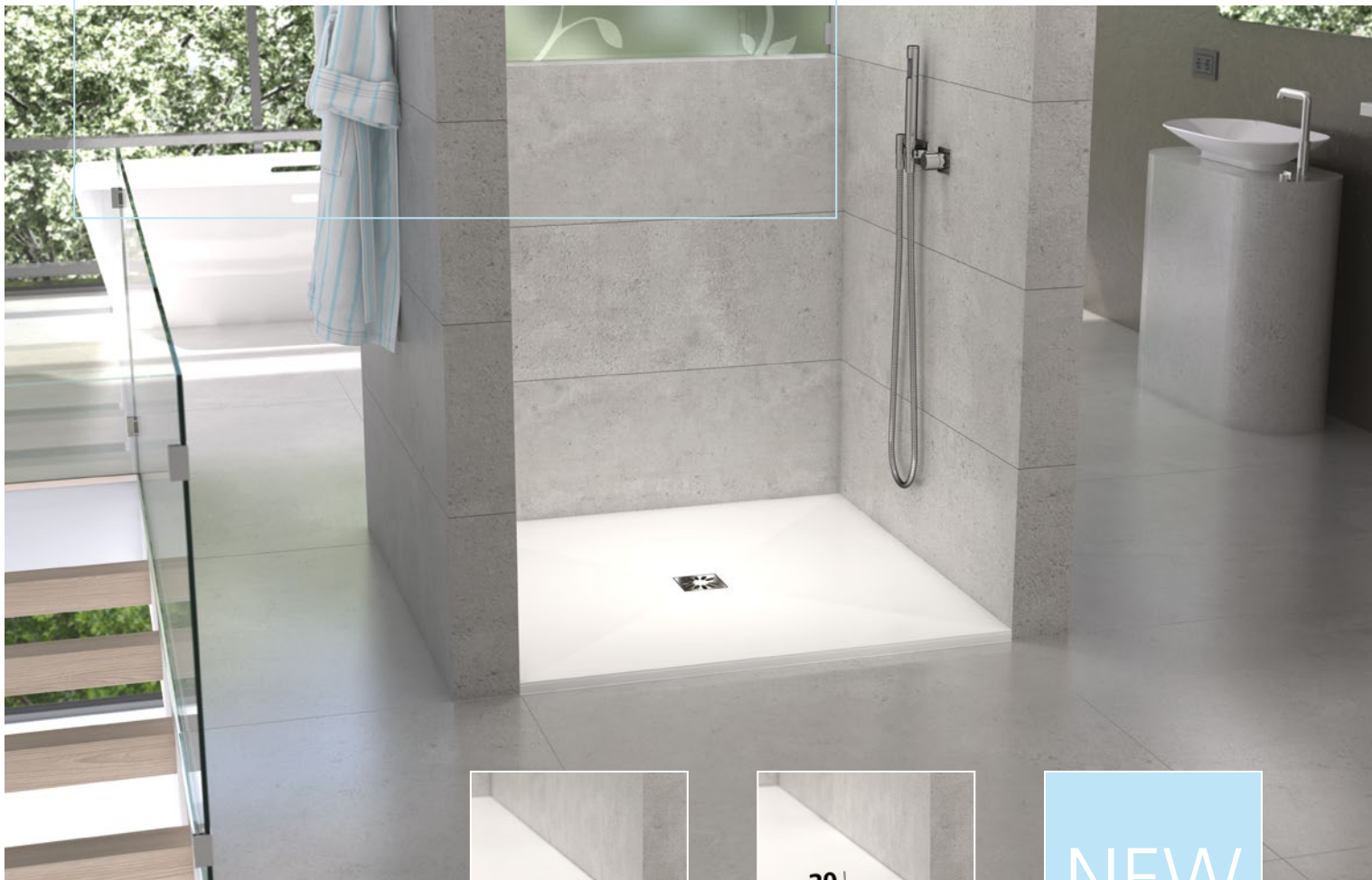

**Fundo Top Slim-Kit** **wedi**

**ALL SLIM  
ALL IN!**

**10 YEAR**

**INCLUDES:**

- 1x Fundo Top Slim-Kit
- 1x Fundo Top Slim-Kit
- 2x Fundo Top Slim-Kit
- 2x Fundo Top Slim-Kit
- 1x Fundo Top Slim-Kit

**INSTALLATION:**

1. Prepare the wall surface.

2. Apply the Fundo Top Slim-Kit.

3. Install the Fundo Top Slim-Kit.

4. Finish the installation.

**WARRANTY:**

10 Year Warranty

**CONTACT:**

Wedi GmbH | Industriestraße 51 | D-48332 Emmerich | T +49 (0) 2532 1554-0 | F +49 (0) 2532 1554-133 | info@wedi.de | www.wedi.de

# All slim. All in!

## The first wedi Fundo® kit with matching design surface

The Fundo Top Slim-Kit combines a high-quality Fundo Top mineral surface with a tried and tested Fundo shower element.

The unique combination of the slim shower element and the seamless ready-to-install surface offers a high degree of flexibility during installation – it can be easily cut to required dimensions and can be installed either on top of or flush with the existing substrate including suspended timber floors.

Its main character is the low construction height of the entire system – the combined height of these two elements is only 30 mm. Skirting strips for cladding of the visible edges on step-up shower installations plus accessories for sealing and adhesion are also included in the kit to simplify the installation process.

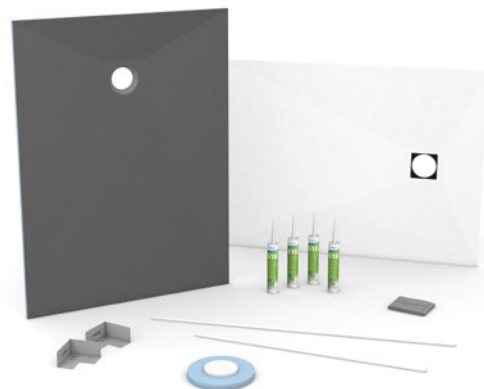

# Unique advantages at a glance



## Unique set

The kit consists of a ready-to-install Fundo Top surface and a wedi Fundo Slim shower element with matching cladding/skirting strips and installation accessories.

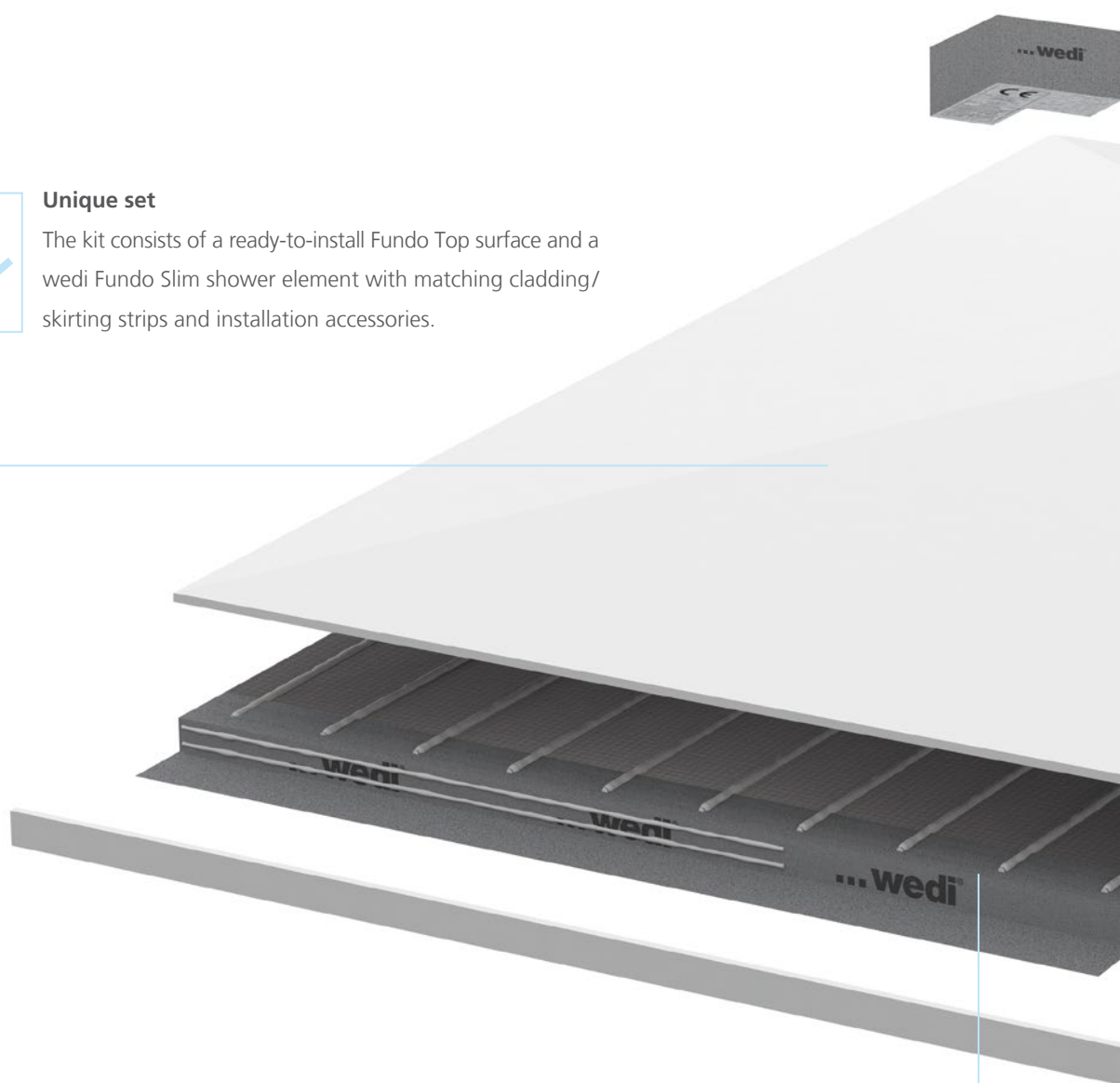

## Stylish, safe and versatile

The Fundo Top element offers a seamless, naturally warm and non-slip surface and with the Fundo Slim shower element that is especially developed for this purpose, the kit can be installed on top of or flush with the existing substrate whether it be screed or suspended timber floor.

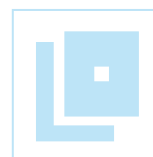



### Quick and easy installation

Thanks to the pre-integrated slope and its weight being much less than a conventional shower tray the installation effort and processing time is significantly reduced.



### Can easily be adjusted to the desired size

The Fundo shower element and the matching ready-to-install surface can be cut to the desired final size without any loss of function or forfeiture of guarantee.

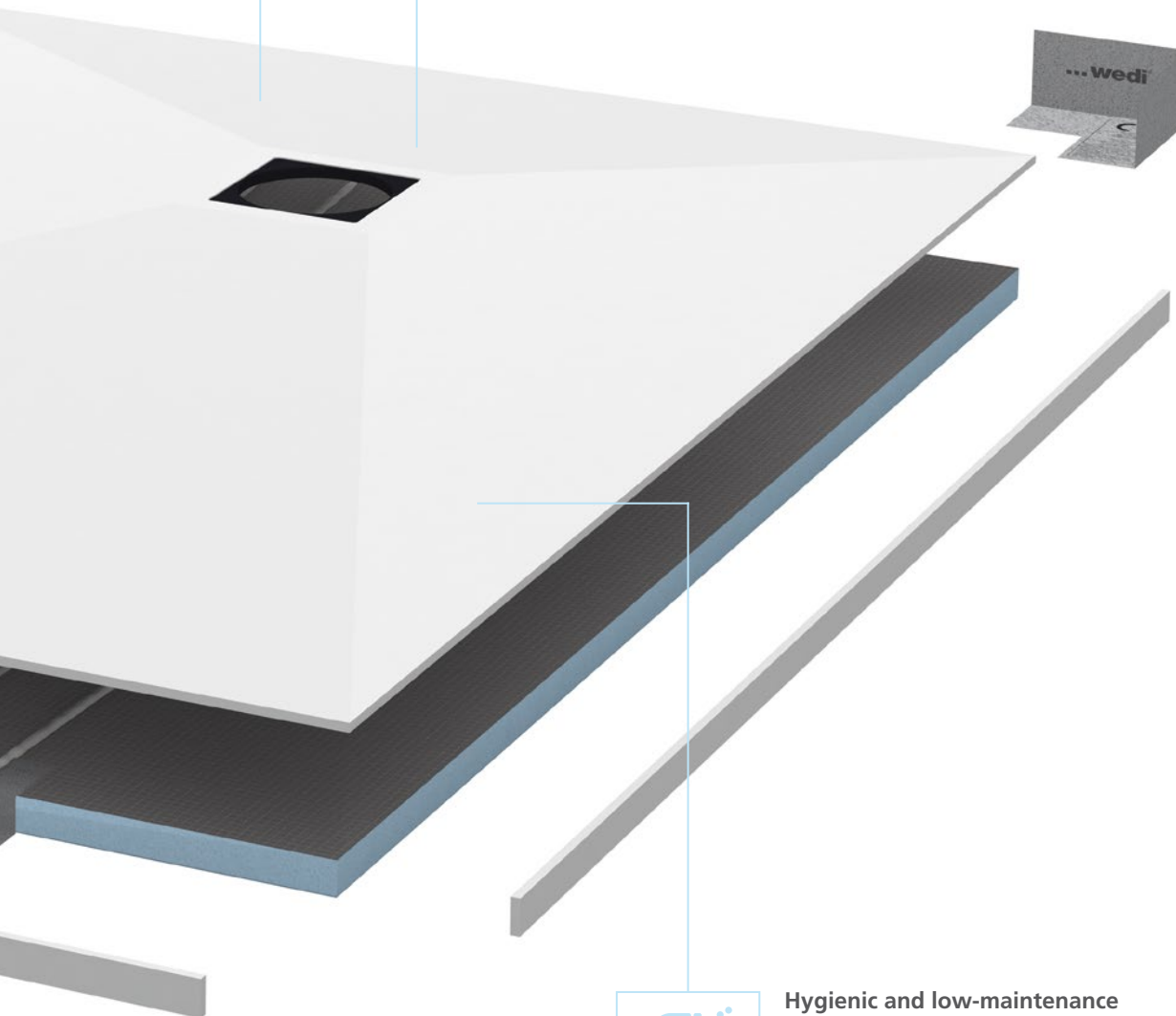

### Hygienic and low-maintenance

The scratch-resistant seamless surface is also resistant to detergents and has an antibacterial effect.

# System construction on screed

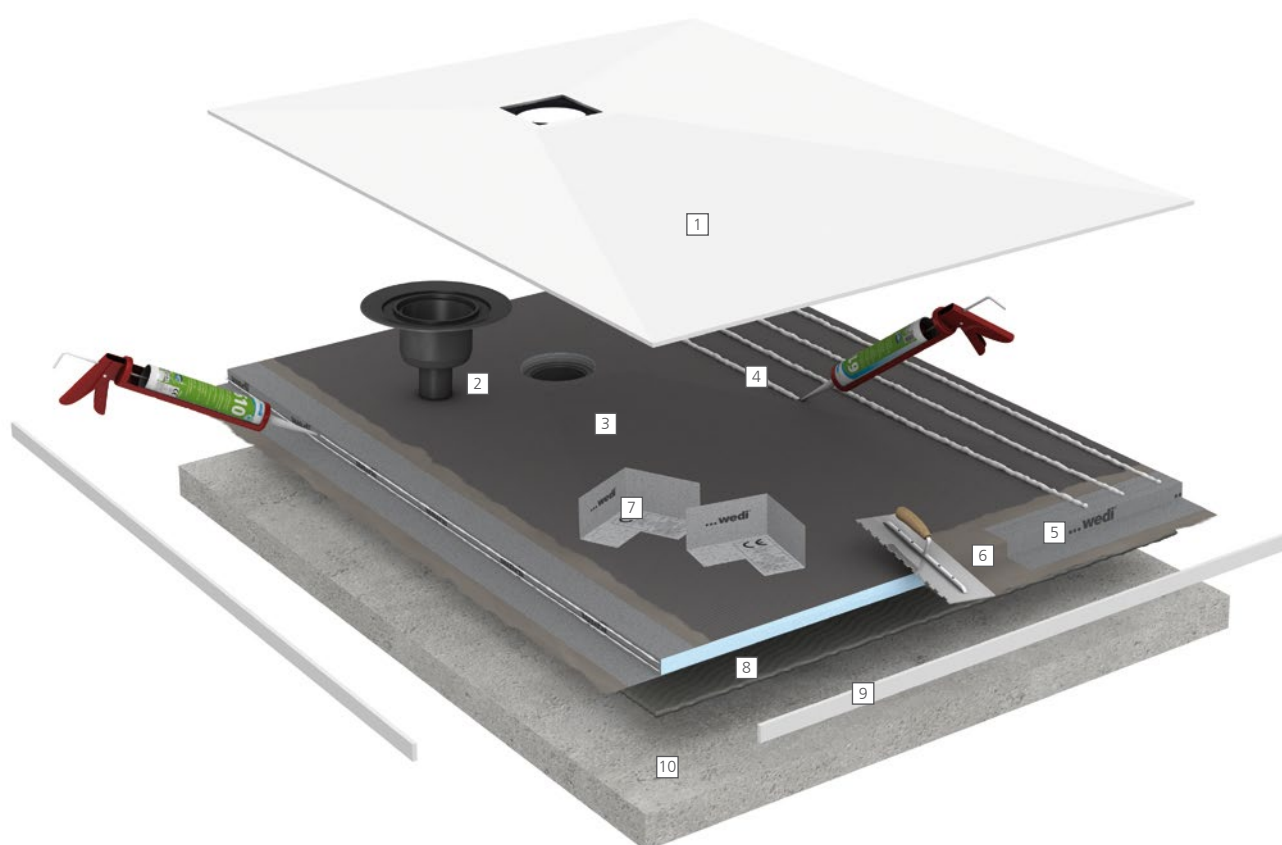

## Products used

- [1] **Fundo Top** ▪ ready-to-install surface for wedi Fundo shower elements
- [2] **wedi Fundo drain** ▪ in this case with a vertical DN 50 drain
- [3] **Fundo Slim** ▪ extremely slim shower element with point drainage
- [4] **wedi 610** ▪ adhesive sealant for adhering the Fundo Top to the Fundo Slim shower element
- [5] **wedi Tools sealing tape** ▪ for secure sealing of all joints in wet areas

- [6] **wedi 520** ▪ flexible waterproof sealant for the sealing of fleece tapes
- [7] **wedi Tools corners** ▪ for reliable sealing of corner joints
- [8] **wedi 320 flexible cement based adhesive** ▪ for full-surface bonding of the wedi Fundo elements to the substrate
- [9] **Fundo Top cladding** ▪ for cladding of the visible edges on step-up shower enclosures
- [10] **Screed**



All materials contained in the Fundo Top Slim-Kit are 100 % wedi system components – the slope is already integrated into the wedi Fundo Slim shower element meaning that it simply needs to be sealed and have the Fundo Top surface with its perfectly matched slope adhered to it. The size of each element can be individually adjusted and any visible edges e.g. in case of step-up showers, can also be clad with the enclosed cladding/skirting strips that conveniently match the size of the main components. The result is an extremely slim, 100 % waterproof shower area.

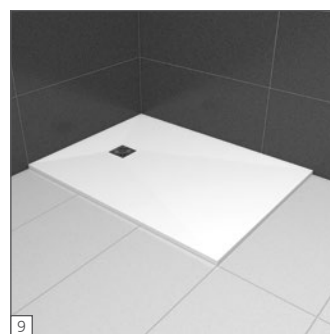
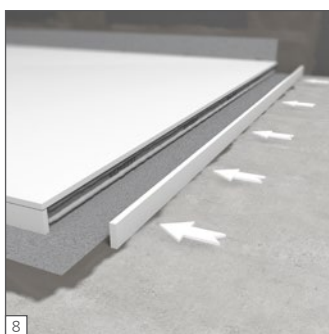
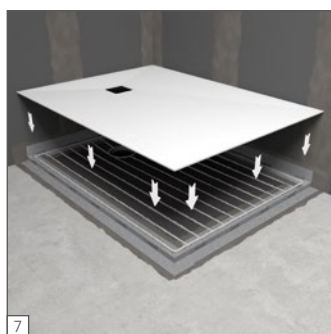
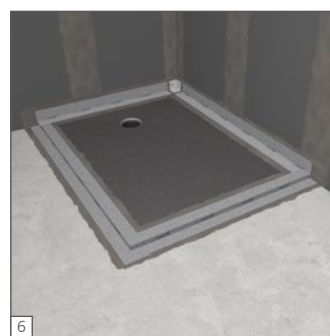
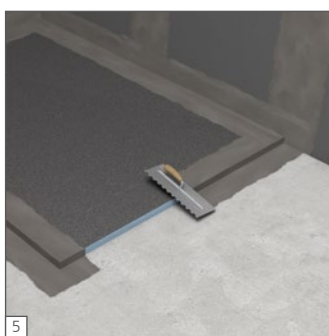
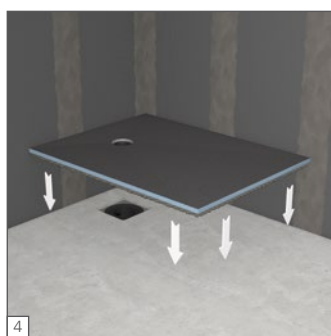
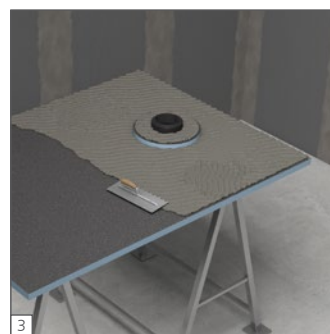
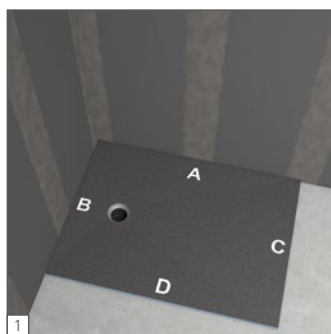

# System construction in screed

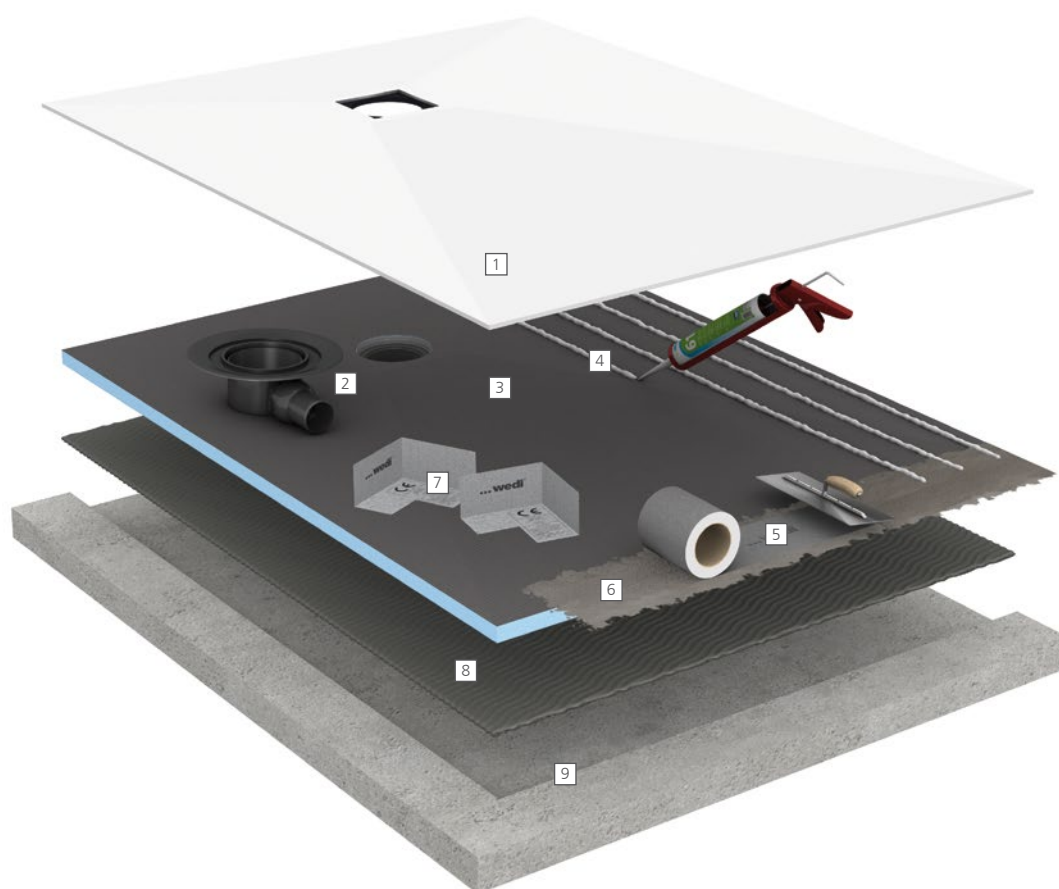

## Products used

- 1 **Fundo Top** ▪ ready-to-install surface for wedi Fundo shower elements
- 2 **wedi Fundo drain** ▪ in this case with a horizontal DN 50 drain
- 3 **Fundo Slim** ▪ extremely slim shower element with point drainage
- 4 **wedi 610** ▪ adhesive sealant for adhering the Fundo Top to the Fundo Slim shower element
- 5 **wedi Tools sealing tape** ▪ for secure sealing of all joints in wet areas
- 6 **wedi 520** ▪ flexible waterproof sealant for the sealing of fleece tapes
- 7 **wedi Tools corners** ▪ for reliable sealing of corner joints
- 8 **wedi 320 flexible cement based adhesive** ▪ for full-surface bonding of the wedi Fundo elements to the substrate
- 9 **Screed**



The Fundo Top Slim-Kit allows for the straightforward and fast creation of reliable and stylish flush to floor showers. Thanks to both the Fundo Slim shower element and the Fundo Top surface being individually customisable, the entire system can be adjusted to almost any site requirement. The enclosed cladding/skirting strips are naturally not required for this type of installation. The result is a 100 % waterproof, seamless flush-to-floor shower area.

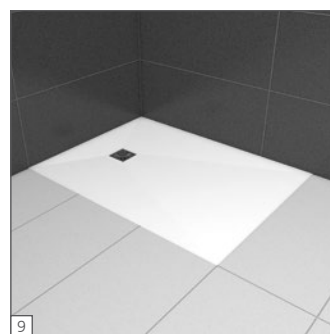
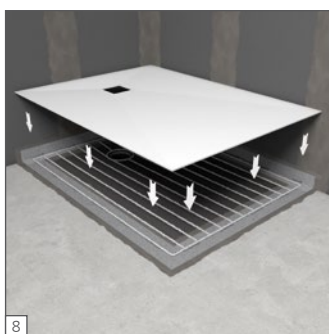
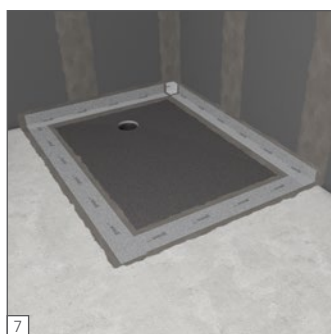
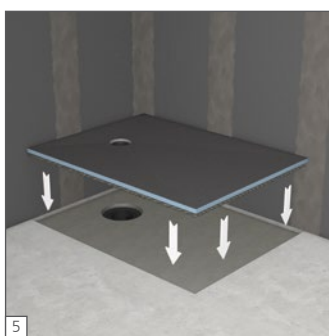
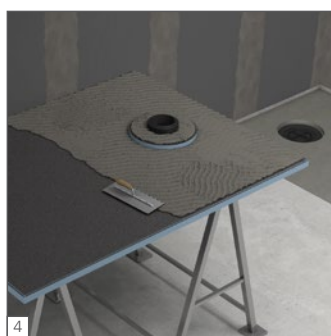
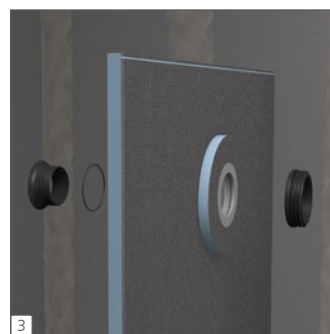
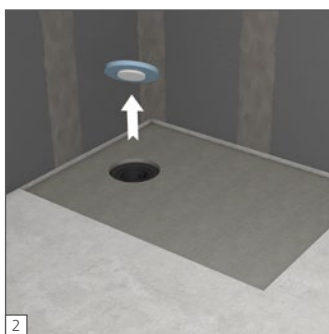
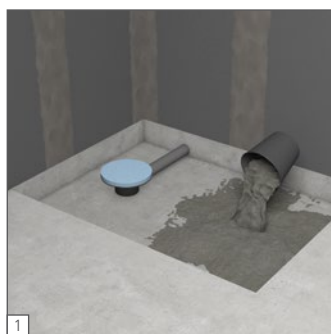

# System construction in suspended timber floors

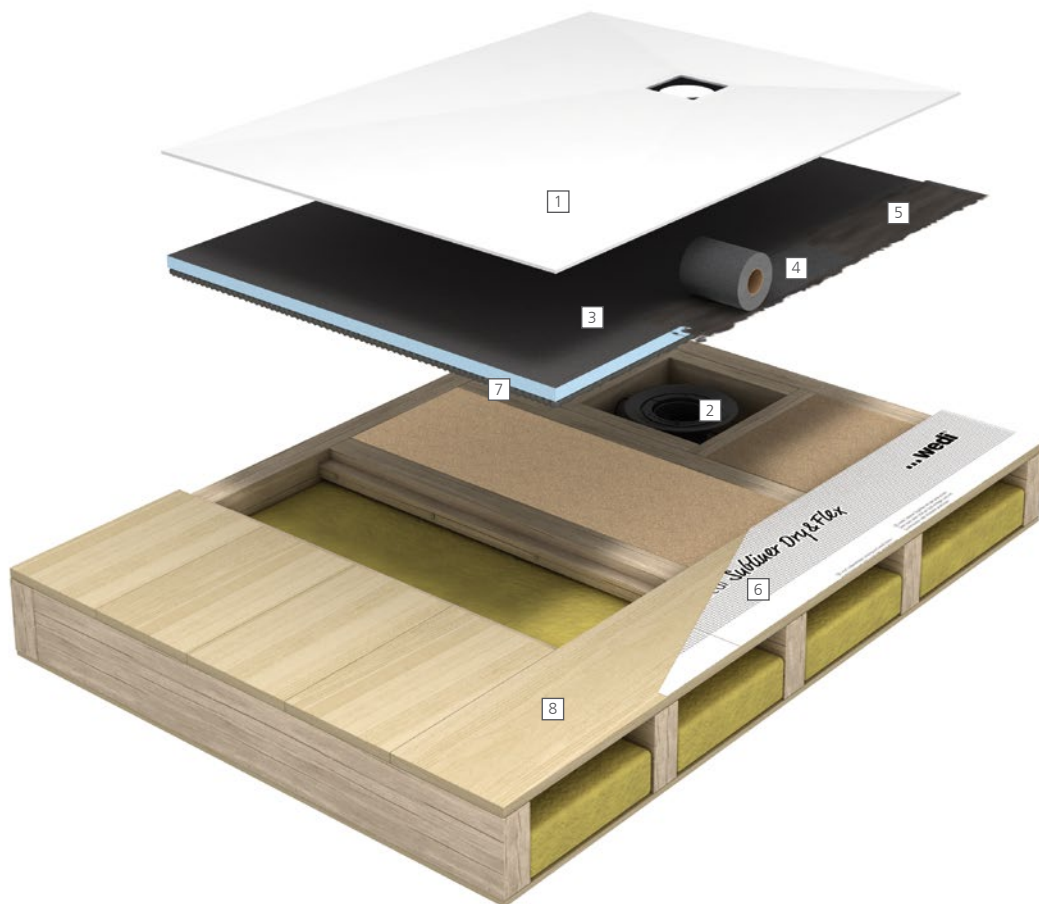

## Products used

- 1** [Fundo Top](#) ▪ ready-to-install surface for wedi Fundo shower elements
- 2** [wedi Fundo drain](#) ▪ in this case with a horizontal DN 50 drain
- 3** [Fundo Slim](#) ▪ extremely slim shower element with point drainage
- 4** [wedi Tools sealing tape](#) ▪ for secure sealing of all joints in wet areas
- 5** [wedi 520](#) ▪ flexible waterproof sealant for the sealing of fleece tapes
- 6** [wedi Subliner Dry & Flex](#) ▪ crack-bridging sealing and decoupling membrane
- 7** [wedi 320 flexible cement based adhesive](#) ▪ for full-surface bonding of the wedi Fundo elements to the substrate
- 8** [Suspended timber floors](#)

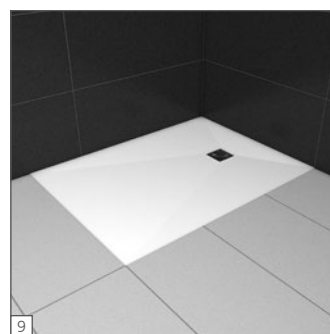
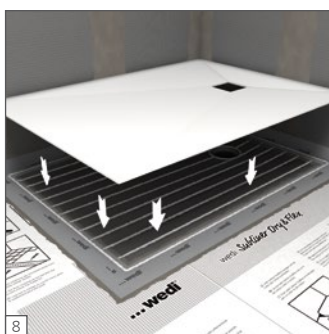
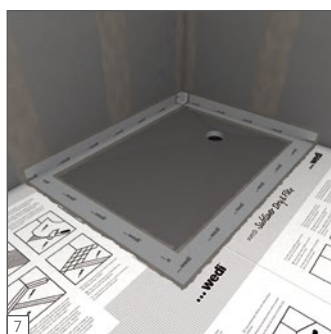
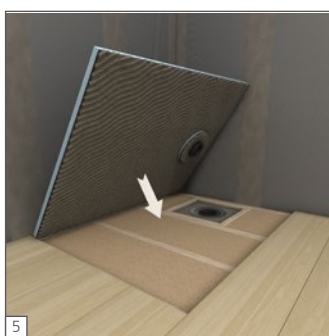
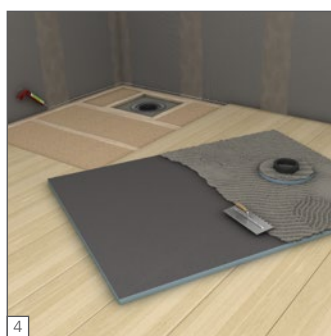
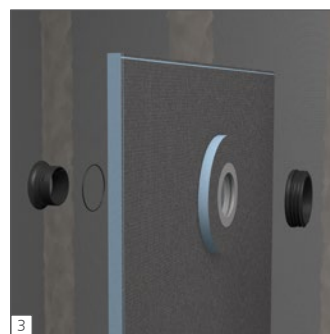
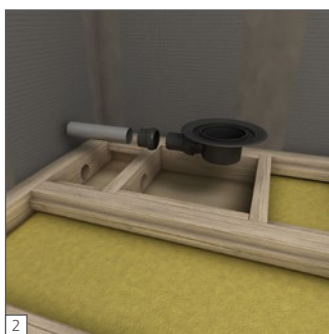
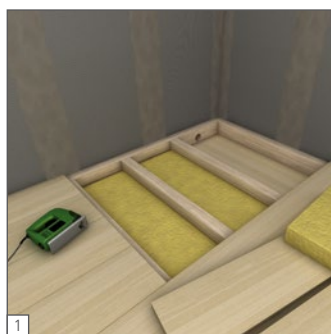

The Fundo Top Slim-Kit is a real all-rounder and is equally suitable for both old and new buildings with suspended timber floors. The kit is tailored to the covering timber layer and can be integrated perfectly into it without the need to build up additional height. Time-consuming levelling measures are therefore not required, resulting in a straightforward and quick installation. The result is a 100 % waterproof, seamless flush-to-floor shower area.









## Fundo Top® Slim-Kit

	Length × Width × Thickness		Content	Order no.
	square, central drain	900 × 900 × 30 mm	1 Set	072060000
	square, central drain	1.200 × 1.200 × 30 mm	1 Set	072060002
	rectangular, offset drain	1.200 × 900 × 30 mm	1 Set	072060001
	rectangular, offset drain	1.400 × 900 × 30 mm	1 Set	072060003
	rectangular, offset drain	1.600 × 1.000 × 30 mm	1 Set	072060004
	rectangular, offset drain	1.800 × 900 × 30 mm	1 Set	072060005
	<p> Scope of delivery: 1 × Fundo Slim shower element, 1 × Fundo Top ready-to-install surface, 2 × Fundo Top cladding, 2 – 4 × wedi 610 cartridges, 6 m wedi Tools sealing tape, 2 × wedi Tools inside corners, 1 × Installation aid</p>			

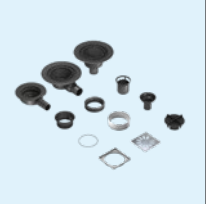
## Necessary accessories

	Content		Order no.
	wedi Fundo Point drain, vertical, DN 50	1 unit	077000033
	wedi Fundo Point drain fire protection collar, vertical, DN 50	1 unit	073749002
	wedi Fundo Point drain, vertical, DN 70	1 unit	077000010
	wedi Fundo Point drain, horizontal, DN 50	1 unit	077000034
	wedi Fundo Point drain Mini Max, horizontal, extra flat, DN 40	1 unit	077000015

	Content		Order no.
	wedi 320, flexible cement based Adhesive	25 kg/bag	110025320

	Content		Order no.
	wedi 520, cement based Waterproof Membrane	20 kg bag + 10 l drum	119900520





# The new wedi design surfaces

## Fundo Top® and wedi Top Wall

The ready-to-install finished surface that is the key component of the Fundo Top Slim-Kit is just one of the many design surfaces the wedi Top series offers. Fundo Top elements are available in different colours and sizes for several wedi Fundo shower elements in either point or linear design. wedi Top Wall elements are perfect for the stylish cladding of wall surfaces in the shower or bathroom.

All of these surfaces create a seamless, thus not only attractive but hygienic and low maintenance finish. Different shades and textures allow for a wide range of variations thus individually tailored designs. A homogeneous white floor surface can be combined with anthracite or grey variants in a natural stone look on the walls for example. What's more, thanks to the Top Wall surfaces being so easy to cut, they could also be combined in desired shapes and colours to achieve a pattern tailored to individual requirements.

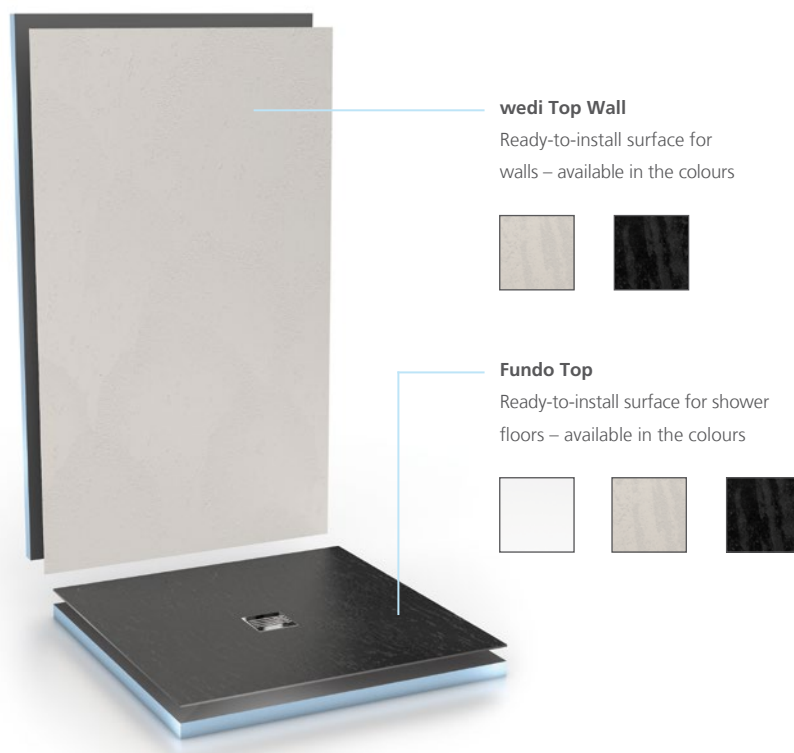

### More information about the wedi Top series

More information about the wedi design surfaces can be found in the respective brochures. Talk to your wedi contact person now or have a look at [www.wedi.co.uk](http://www.wedi.co.uk).



- Australia
- Austria
- Belgium
- Bosnia Herzegovina
- Canada
- Croatia
- Czech Republic

- Denmark
- Estonia
- Finland
- France
- Germany
- Great Britain
- Greece

- Hungary
- Iceland
- Ireland
- Italy
- Latvia
- Lithuania
- Luxembourg

- Netherlands
- Norway
- Poland
- Portugal
- Romania
- Russia
- Serbia

- Slovenia
- Spain
- Sweden
- Switzerland
- Turkey
- Ukraine
- USA



#### **wedi GmbH**

Hollefeldstraße 51  
48282 Emsdetten  
Germany

Telephone +49 2572 156-0  
Fax +49 2572 156-133

info@wedi.de  
www.wedi.eu

#### **wedi Systems (UK) Ltd**

Unit 4 Mercury Park · Mercury Way  
Trafford Park · M41 7LY  
Great Britain

Telephone + 44 161 864 2336  
Fax + 44 161 864 1323

info@wedi.co.uk  
www.wedi.co.uk

