



2019 Parts List

PROFILED SHEETING FEBRUARY 2019 PARTS LIST

Use this simple checklist to get what you need faster

To process your orders swiftly, please provide the following information:

- Full delivery address including house number and postcode
- Where possible, site contact name and telephone number
- Quote reference
- Quote price supplied against each item
- Order in pallet, banded or pack quantities
- Clear product descriptions including colour
- Delivery restrictions/specific vehicle requirements
- Include site contact details with vehicle offload
- Preferred delivery date

Contents	
Open Protected Ridges	3
E-Luminate	4
Colour ranges	5
Product selector	6
Profile 6 sheets & fittings	3
Profile 3 sheets & fittings	14
Applications	16
Resources	18
Ordering and delivery	19

P6 | P3

PROFILED SHEETING



Eternit has been backing British farming for more than 100 years with the only fibre cement profiled sheeting made in Britain. It's here to stay.



APPROVED
VENTILATION
SYSTEM
DESIGN

Protected Open Ridge

For effective outlet ventilation
in agricultural buildings

As the external air of a building moves up the slope of the roof due to wind or heat, the air is deflected away by the open ridge upstands. This increases the draw of air through the open vent from within the building. Not only does this aid internal ventilation it prevents rain and unwanted elements from entering the building.

In addition to the traditional fibre cement soffit strip, a polycarbonate alternative is available from Eternit to allow more natural light into the building.

Eternit can assist with design and technical advice to obtain optimum air space for livestock, machinery and storage of goods while adhering to health and safety guidance.

The protected open ridge is one of the ventilation design systems available from our vast range of products.

Please speak to your Area Sales Manager regarding soffit width options available.

See page 10 for additional product information.



New E-Luminate™

Brighter working environments



Designed to maximise light

The more we can replicate the natural environment inside a livestock or stable building, the better it is for the animals and you.

At Eternit, we have been investigating ways that we can help improve the living conditions for animals whilst retaining the performance of the building and not adding additional overheads like electricity and maintenance. E-Luminate increases natural light reducing energy costs, making a brighter future for brighter working environments.

E-Luminate is a technical product solution which can be used with P6/P3 painted sheet colour options in the following sizes:

P6 1220mm, 1375mm, 1525mm, 1675mm, 1825mm

P3 1525mm, 2450, 3050mm.

Maximum sheet quantities apply per order. POA.

Please call your Area Sales Manager for information.

Applications

- Roofs & Cladding
- Storage
- Garages & Sheds
- Stables



P6 | P3

PROFILED SHEETING

COLOUR RANGES

Request a sample

You can simply visit: eternit.co.uk

Painted colour range

Experience gained over many years has shown that the Eternit colour range will meet the wide ranging design requirements in both rural and urban areas. All the colours have been chosen for their ability to harmonise with the most commonly used building materials – brick, slate, stone, concrete and timber. Use colour codes (in brackets) when creating product codes.

Black
(GQ 60)



Van Dyke Brown
(BS 08 B 29)



Gunmetal Grey
(BS 18 B 25)



Brown
(GQ 78)



Cloud Grey
(GS 92)



Tawny Brown
(GQ 80)



Slate Blue
(BS 18 B 29)



Laurel Green
(BS 12 B 29)



Architect's
choice

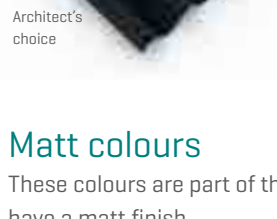

Matt colours

These colours are part of the standard colour range but have a matt finish.

Bracken (12)



Sherwood (17)



Natural Grey

Natural Grey is the standard unpainted finish for Profile 6 and Profile 3.

Natural Grey



Farmscape

Anthracite sheets have a pigmented surface layer. Together with subtle variations in tone inherent in any natural cementitious product, the appearance will blend with almost any landscape from the day the building is erected. Only available for Profile 6.

Anthracite (Pigmented
surface layer on
Profile 6 only)



E-Luminate™

Off-white is the colour used on the underside of painted P6 and P3 sheets – see opposite page for sheet sizes.

Off-White



E-Luminate™

E-Luminate* products feature a special off-white paint coating to a painted sheet underside, researched and designed to increase light to internal livestock areas or agricultural buildings. Only available on painted sheets in specific lengths. POA.

For further information please contact customer services.

* IMPORTANT: E-Luminate - the permeability of the surface exposed to the weather should not be any less than the permeability of the inner surface, otherwise the sheets could bow excessively as they absorb moisture from rain and possibly cracks could form. Although the specialist paint is vapour permeable, it does reduce the permeability of the products and so, when the underside of fibre cement sheets are painted, the top surface also has to be painted. Therefore E-Luminate is not suitable with non-painted sheets.

PRODUCT SELECTOR

NEW

Topfix

Profiled sheet fixings designed for Steel and Timber sub-structure buildings. See page 14.

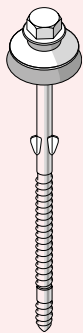

This product selector is not exhaustive. See following pages for full range of available products

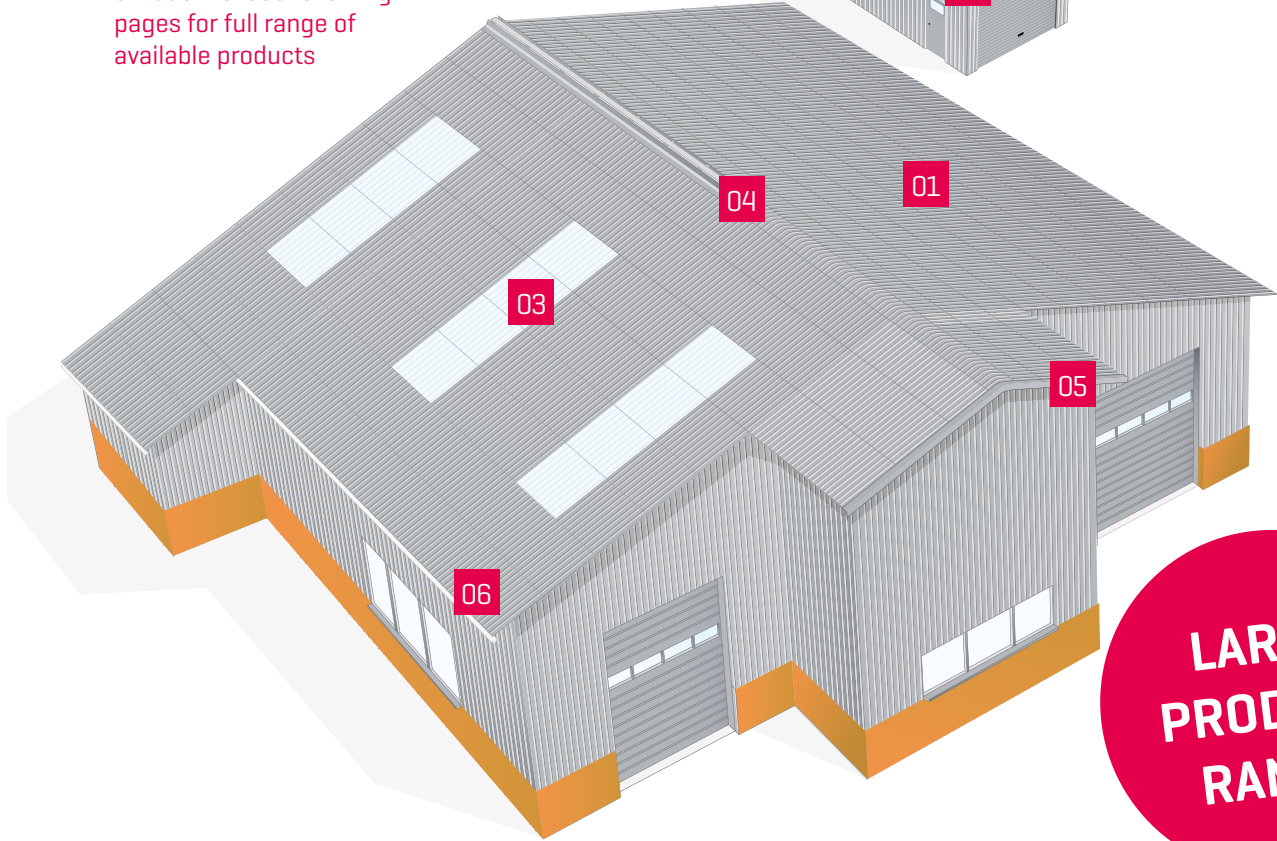
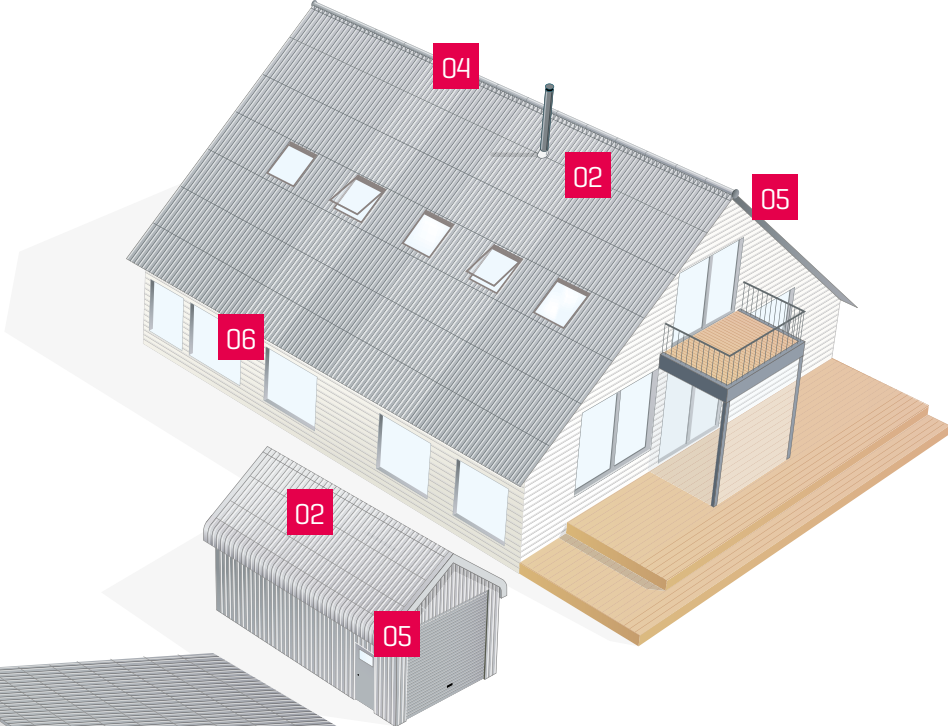

LARGE
PRODUCT
RANGE

04



Cranked crown sheet
Page 9

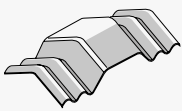

Ventilating cranked crown sheet
Page 9

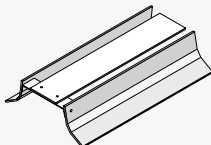

Open protected or protected ridge
For agricultural use.
Page 10

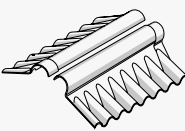

Two piece close fitting ridge
Pages 10 & 14

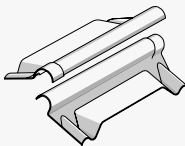

Two piece ventilating ridge
Pages 10 & 14

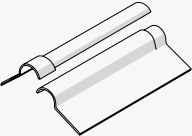

Two piece plain wing ridge
Pages 10 & 15

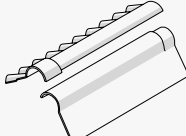

Two piece north light ridge
Page 10 & 15

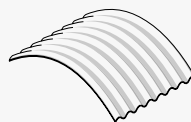

Curved Profile 6
Page 8

05

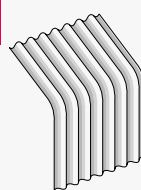

Eaves bend sheet
Page 8

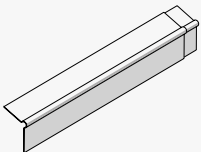

Roll top bargeboard
Page 11 & 15

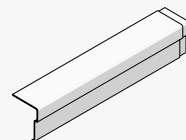

Vergeline bargeboard
Page 12

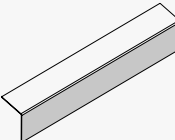

Plain bargeboard
Page 12 & 15

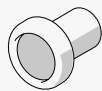

Disc type ridge finial
Pages 10 & 15. To suit two piece adjustable ridges.

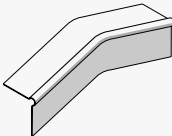

Roll top cranked crown bargeboard
Page 11

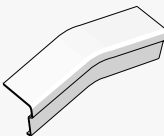

Vergeline cranked crown bargeboard
Page 12

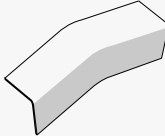

Plain cranked crown bargeboard
Page 12

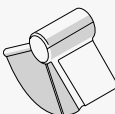

Two piece hooded ridge finial
Page 10
To suit roll top bargeboards



Roll top eaves bend bargeboard
Page 11

06

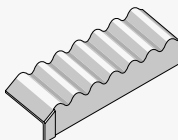

Eaves corrugation closure piece
Various back lengths available
Page 13 & 14

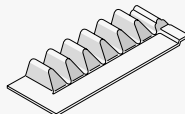

Eaves filler piece
Page 13 & 15

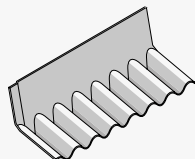

Apron flashing piece
Page 13 & 15

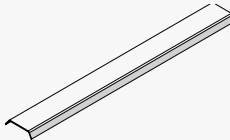

Movement joints
Page 13

01

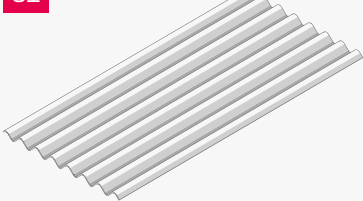

Profile 6
Lengths available: 1220, 1375, 1525, 1675, 1825, 1975, 2125, 2275, 2440, 2600, 2750, 2900, 3050 – Page 8

02

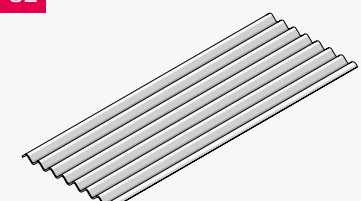

Profile 3
Lengths available: 1525, 2450, 3050 – Page 14

03

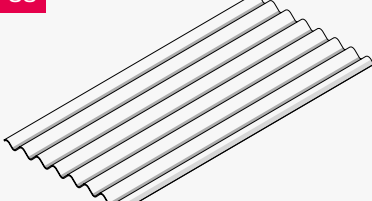

GRP translucent sheet
Profile 6 only – Page 14

PROFILE 6 SHEETS & FITTINGS

Products may be subject to availability, please contact Customer Services. ✓ Standard product POA (Price on application) Available as E-Luminate (POA)

PROFILE 6 SHEETS†						
	Overall width	Thickness	Length	Natural Grey	Farmscape Anthracite	Painted
	1086mm (Net covering width 1016mm)	6.7mm	1220mm	✓*	●	✓*
			1375mm	✓	●	✓
			1525mm	✓*	✓*	✓*
			1675mm	✓	✓	✓
			1825mm	✓	●	✓
			1975mm	✓	●	✓
			2125mm	✓	●	✓
			2275mm	✓	●	✓
			2440mm	✓	✓	✓
			2600mm	✓	●	✓
			2750mm	✓	✓	✓
			2900mm	✓	✓	✓
			3050mm	✓	✓	✓

TRIMMED PROFILE 6 SHEETS				
Where a spaced roof is required, Eternit can provide a range of trimmed [Natural Grey, Anthracite, and Painted] Profile 6 sheets for use in this application.	Overall width		Natural Grey	Farmscape Anthracite
	1000mm		●	●

CURVED PROFILE 6** MTO 8-10 weeks					
	Max. girth	Min. radius	Natural Grey	Farmscape Anthracite	Painted
	3050mm	1375mm	●	●	●

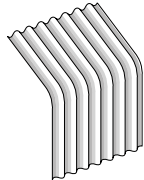
EAVES BEND SHEET MTO 6-8 weeks					
	Radius	Roof Pitch	Natural Grey	Farmscape Anthracite	Painted
	300mm (Girth 1525mm)	5°	●	●	●
		7.5°	●	●	●
		10°	●	●	●
		12.5°	●	●	●
		15°	●	●	●
		17.5°	●	●	●
		20°	●	●	●
		22.5°	●	●	●

† **Product codes**
Natural Grey: EU_P6 + length + R, e.g. EU_P63050R
Painted: EU_P6 + length + R + colour code, e.g. EU_P63050R26
Anthracite: EU_LCC6 + length + R + A, e.g. EU_LCC63050RA

* Available pre-mitred
** Made subject to acceptance of special order. For all types of semi-circular roofs, jack roofs, etc. Supply A + B + girth or radius + girth [all dimensions to be taken to the underside of a trough corrugation].

PROFILE 6 FITTINGS

Products may be subject to availability, please contact Customer Services. ✓ Standard product POA (Price on application) Available as E-Luminate (POA)

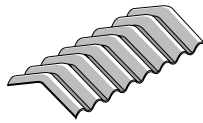
CRANKED CROWN SHEET†						
	Cover width	Girth	Roof pitch	Natural Grey	Farmscape Anthracite	Painted
	1016mm (overall width 1100mm)	750mm	5°	✓	●	✓
			7.5°	✓	●	✓
			10°	✓	✓	✓
			12.5°	✓	✓	✓
			15°	✓	✓	✓
			17.5°	✓	✓	✓
			20°	✓	✓	✓
			22.5°	✓	✓	✓
		900mm	5°	✓	●	✓
			7.5°	✓	●	✓
			10°	✓	✓	✓
			12.5°	✓	✓	✓
	1016mm (overall width 1100mm)	900mm	15°	✓	✓	✓
			17.5°	✓	✓	✓
			20°	✓	✓	✓
			22.5°	✓	✓	✓
		1800mm	5°	✓	●	✓
			7.5°	✓	●	✓
			10°	✓	●	✓
			12.5°	✓	●	✓
		1800mm	15°	✓	●	✓
			17.5°	✓	●	✓
			20°	✓	●	✓
			22.5°	✓	●	✓

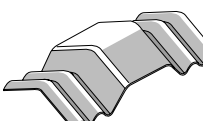
VENTILATING CRANKED CROWN SHEET††						
	Cover width	Girth	Roof pitch	Natural Grey	Farmscape Anthracite	Painted
	1016mm (overall width 1100mm)	750mm	5°	✓	●	✓
			7.5°	✓	●	✓
			10°	✓	✓	✓
			12.5°	✓	✓	✓
			15°	✓	✓	✓
			17.5°	✓	✓	✓
			20°	✓	✓	✓
			22.5°	✓	✓	✓
		900mm	5°	✓	●	✓
			7.5°	✓	●	✓
			10°	✓	✓	✓
			12.5°	✓	✓	✓
	1016mm (overall width 1100mm)	900mm	15°	✓	✓	✓
			17.5°	✓	✓	✓
			20°	✓	✓	✓
			22.5°	✓	✓	✓
		1800mm	5°	✓	●	✓
			7.5°	✓	●	✓
			10°	✓	●	✓
			12.5°	✓	●	✓
		1800mm	15°	✓	●	✓
			17.5°	✓	●	✓
			20°	✓	●	✓
			22.5°	✓	●	✓

† **Product codes**
Natural Grey: EU_P6CC + girth + pitch (whole no. only), e.g. EU_P6CC75012
Painted: EU_P6CC + girth + pitch (whole no. only) + colour code, e.g. EU_P6CC7501226
Anthracite: EU_LCCP6 + girth + pitch (whole no. only) + A, e.g. EU_LCCP6CC75012A

†† **Product codes**
Natural Grey: EU_P6CV + girth + pitch (whole no. only), e.g. EU_P6CV75012
Painted: EU_P6CV + girth + pitch (whole no. only) + colour code, e.g. EU_P6CV7502226
Anthracite: EU_LCCP6CV + girth + pitch (whole no. only) + A, e.g. EU_LCCP6CV75012A

PROFILE 6 FITTINGS

Products may be subject to availability, please contact Customer Services. ✓ Standard product POA (Price on application) Available as E-Luminate (POA)

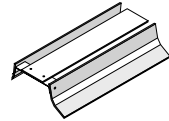
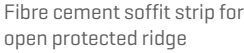
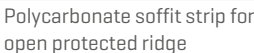
OPEN PROTECTED OR PROTECTED RIDGE						
These comprise of the following components. For agricultural use						
	Cover length	Overall length		Natural Grey	Farmscape Anthracite	Painted
	2200mm	2300mm		✓ [single flashing]	✓ [single flashing]	✓ [single flashing]
	Cover length	Cover width	Thickness	Natural Grey	Farmscape Anthracite	Painted
	2400mm	300mm	9mm	✓	POA	✓
	2400mm	350 and 400mm	9mm	● [MT0]	● [MT0]	● [MT0]
	Cover length	Cover width	Thickness	Translucent		
	2400mm	300mm	6mm		●	
For other soffit width enquiries please speak to your Area Sales Manager						

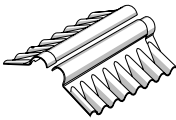
TWO PIECE CLOSE FITTING RIDGE						
	Cover width	Overall width		Natural Grey	Farmscape Anthracite	Painted
	1016mm	1124mm	Small roll	✓**	✓**	✓**
			Large roll	✓**	✓**	✓**

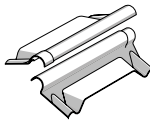
TWO PIECE VENTILATING RIDGE						
	Cover width	Overall width		Natural Grey	Farmscape Anthracite	Painted
	1016mm	1124mm	Small roll	✓**	✓**	✓**
			Large roll	✓**	✓**	✓**

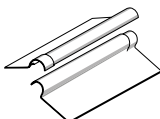
TWO PIECE PLAIN WING RIDGE						
As plain wings do not close the corrugations, this ridge allows a measure of ventilation.						
	Cover width	Overall width		Natural Grey	Farmscape Anthracite	Painted
	1016mm	1090mm	Small roll	✓**	✓**	✓**
			Large roll	✓**	✓**	✓**

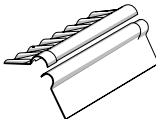
TWO PIECE NORTH LIGHT RIDGE						
	Dimensions		Colour availability			
	Cover width	Overall width		Natural Grey	Farmscape Anthracite	Painted
	1016mm	1124mm	Small roll	✓**	✓**	✓**
			Large roll	✓**	✓**	✓**

DISC TYPE RIDGE FINIAL						
				Natural Grey	Farmscape Anthracite	Painted
				✓	●	✓

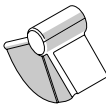
TWO PIECE HOODED RIDGE FINIAL						
				Natural Grey	Farmscape Anthracite	Painted
			Small roll	✓**	✓**	✓**
			Large roll	✓**	✓**	✓**

** Two parts required when placing an order

PROFILE 6 FITTINGS

Products may be subject to availability, please contact Customer Services. ✓ Standard product POA (Price on application) Available as E-Luminate (POA)

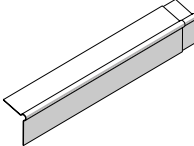
ROLL TOP BARGEBOARD†						
	Size	Length	Natural Grey	Farmscape Anthracite	Painted	Universal handling
	200 x 200mm	1525mm	✓	✓	✓	
		2440mm	✓	✓	✓	
		3000mm	✓	✓	✓	

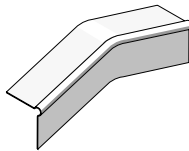
ROLL TOP CRANKED CROWN BARGEBOARD††						
	Girth	Roof pitch	Natural Grey	Farmscape Anthracite	Painted	Universal handling
	1050mm (wing 200 x 200mm)	5°	●	●	●	
		7.5°	●	●	●	
		10°	✓	✓	✓	
		12.5°	✓	✓	✓	
		15°	✓	✓	✓	
		17.5°	✓	✓	✓	
		20°	✓	✓	✓	
	1300mm (wing 200 x 200mm)	22.5°	✓	✓	✓	
		5°	✓	●	✓	
		7.5°	✓	●	✓	
		10°	✓	✓	✓	
		12.5°	✓	✓	✓	
		15°	✓	✓	✓	
		17.5°	✓	✓	✓	
	2200mm (wing 200 x 200mm)	20°	✓	✓	✓	
		22.5°	✓	✓	✓	
		5°	✓	●	✓	
		7.5°	✓	●	✓	
		10°	✓	●	✓	
		12.5°	✓	●	✓	
		15°	✓	●	✓	
		17.5°	✓	●	✓	
		20°	✓	●	✓	
		22.5°	✓	●	✓	

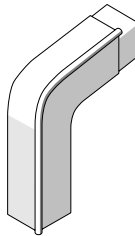
ROLL TOP EAVES BEND BARGEBOARD						
MT0 6-8 weeks			Left and right hand available. Left hand illustrated.			
	Radius	Girth	Roof pitch	Natural Grey	Farmscape Anthracite	Painted
	354mm (wing 200 x 200mm)	1575mm	5°-22.5° [in 2.5° increments]	✓	●	✓

† Product codes
Natural Grey: EU_RT200 + length e.g. EU_RT2003000
Painted: EU_RT200 + length + colour code e.g. EU_RT200300026
Anthracite: EU_LCCRT200 + length + A e.g. EU_LCCRT2003000A

†† Product codes
Natural Grey: EU_CRT200 + first two digits of girth + pitch (whole no. only) e.g. EU_CRT2001312
Painted: EU_CRT200 + first two digits of girth + pitch (whole no. only) + colour code e.g. EU_CRT200131226
Anthracite: EU_LCCCRT200 + first two digits of girth + pitch (whole no. only) + A e.g. EU_LCCCRT2001312A

PROFILE 6 FITTINGS

Products may be subject to availability, please contact Customer Services. ✓ Standard product POA (Price on application) Available as E-Luminate (POA)

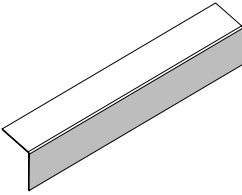
PLAIN BARGEBOARD						Universal handing
	Wing	Length	Natural Grey	Farmscape Anthracite	Painted	
	200 x 200mm	1800mm	✓	✓	✓	
		2440mm	✓	✓	✓	
		3000mm	✓	✓	✓	
	300 x 300mm	1800mm	✓	●	✓	
		2440mm	✓	●	✓	
		3000mm	✓	●	✓	

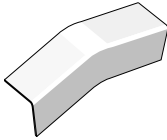
PLAIN CRANKED CROWN BARGEBOARD						Universal handing
	Wing dimensions	Roof Pitch	Natural Grey	Farmscape Anthracite	Painted	
	200 x 200mm [Girth 1300mm]	5°	✓	●	✓	
		7.5°	✓	●	✓	
		10°	✓	✓	✓	
		12.5°	✓	✓	✓	
		15°	✓	✓	✓	
		17.5°	✓	✓	✓	
		20°	✓	✓	✓	
	300 x 300mm [Girth 1300mm]	22.5°	✓	✓	✓	
		5°	✓	●	✓	
		7.5°	✓	●	✓	
		10°	✓	●	✓	
		12.5°	✓	●	✓	
		15°	✓	●	✓	
		17.5°	✓	●	✓	
		20°	✓	●	✓	
		22.5°	✓	●	✓	

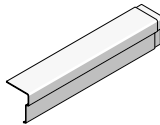
VERGELINE BARGEBOARD						MTD 6-8 weeks	Left and right hand available. Left hand illustrated.
	Wing dimensions	Length	Natural Grey	Farmscape Anthracite	Painted		
	300 x 300mm	1800mm	✓	✓	✓		
		2440mm	✓	✓	✓		
		3000mm	✓	✓	✓		

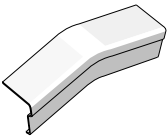
VERGELINE CRANKED CROWN BARGEBOARD						MTD 6-8 weeks	Left and right hand available. Left hand illustrated.
	Girth	Roof pitch	Natural Grey	Farmscape Anthracite	Painted		
	300 x 310mm [Girth 1300mm]	5°	✓	✓	✓		
		7.5°	✓	✓	✓		
		10°	✓	✓	✓		
		12.5°	✓	✓	✓		
		15°	✓	✓	✓		
		17.5°	✓	✓	✓		
		20°	✓	✓	✓		
		22.5°	✓	✓	✓		

VERGELINE BARGEBOARD STOP END					MTD 6-8 weeks	Left and right hand available. Left hand illustrated.
			Natural Grey	Farmscape Anthracite	Painted	
			✓	●	✓	

PROFILE 6 FITTINGS

Products may be subject to availability, please contact Customer Services. ✓ Standard product POA (Price on application) Available as E-Luminate (POA)

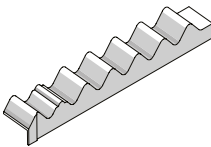
EAVES CORRUGATION CLOSURE PIECE							Universal handing
	Cover width	Overall width	Back	Natural Grey	Farmscape Anthracite	Painted	
	1016mm	1055mm	65mm	✓	●	✓	
			100mm	✓	●	✓	
			150mm	✓	●	✓	
			250mm	✓	●	✓	

EAVES FILLER PIECE					Universal handing
	Cover width		Natural Grey	Farmscape Anthracite	Painted
	1016mm		✓	●	✓

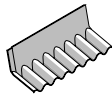
APRON FLASHING PIECE						Universal handing
	Cover width	Overall width	Natural Grey	Farmscape Anthracite	Painted	
	1016	1068	✓	✓	✓	

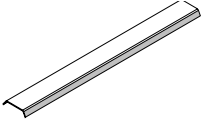
MOVEMENT JOINT					
	Width	Length	Natural Grey	Farmscape Anthracite	Painted
	311mm	1525mm	✓	✓	✓
		2440mm	✓	✓	✓
		3000mm	✓	✓	✓

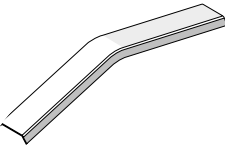
CRANKED MOVEMENT JOINT					
	Width	Roof Pitch	Natural Grey	Farmscape Anthracite	Painted
	330mm [Girth 1300mm]	5°	✓	●	✓
		7.5°	✓	●	✓
		10°	✓	✓	✓
		12.5°	✓	✓	✓
		15°	✓	✓	✓
		17.5°	✓	✓	✓
		20°	✓	✓	✓
		22.5°	✓	✓	✓

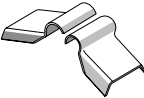
MOVEMENT JOINT TWO PIECE RIDGE					MTD 6-8 weeks
	Width		Natural Grey	Farmscape Anthracite	Painted
	330mm		✓*	✓*	✓*

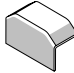
MOVEMENT JOINT STOP END					MTD 6-8 weeks
	Width		Natural Grey	Farmscape Anthracite	Painted
	310mm		✓	✓	✓

JAMB FILLER PIECE NO. 2						MTD 6-8 weeks	For use around doors and windows
	Length	Width x height	Natural Grey	Farmscape Anthracite	Painted		
	3000	210 x 70mm	✓	●	✓		

* Part ordered as a pair

PROFILE 6 FITTINGS

Products may be subject to availability, please contact Customer Services. ✓ Standard product POA (Price on application) E-Luminate (POA)

UNDER GLAZING FLASHING PIECE <small>MTD 6-8 weeks</small>						
	Cover width	Overall width	Handing	Natural Grey	Farmscape Anthracite	Painted
	1016mm	1068mm	Left hand	✓	•	✓
			Right hand	✓	•	✓

GRP TRANSLUCENT SHEET						
	Overall width	Net covering width	Grade	Length	Agrisheet	Farmlite
	1086mm	1016mm	2.4kg/m² [SAB class 3]	1525mm	✓	✓
				1675mm	✓	✓
				1825mm	✓	✓
				2440mm	✓	✓
				2750mm	✓	✓
				2900mm	✓	✓
				3050mm	✓	✓

PROFIED SHEETING FIXINGS					
	Substructure	P6 Fixing types	Code	Quantity	Standard availability
	Timber	Topfix carbon steel 130mm	4069994	100	✓
	Timber	Topfix stainless steel 130mm	4069996	100	✓
	NEW Steel	Topfix carbon steel 105mm	4069999	100	✓
	NEW Steel	Topfix stainless steel 120mm	4070003	100	✓
	NEW Depth setting drill bit		4071041	1	✓
	[sold individually, but also available in boxes of 20]			[Box of 20]	

PROFILE 3 SHEETS & FITTINGS

Products may be subject to availability, please contact Customer Services. E-Luminate products [POA] POA (Price on application)

PROFILE 3 STANDARD SHEETS					
	Overall width	Thickness	Length	Natural Grey	Painted
	782mm [Net covering width 651mm]	5.8mm	1525mm	✓	E •
			2450mm	✓	E •
			3050mm	✓	E •

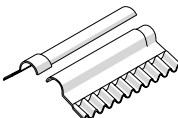
TWO PIECE CLOSE FITTING RIDGE					
	Overall width	Net covering width		Natural Grey	Painted
	713mm	651mm	Small roll	✓**	●
			Large roll	✓**	●

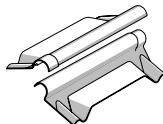
TWO PIECE VENTILATING RIDGE					
	Overall width	Net covering width		Natural Grey	Painted
	713mm	651mm	Small roll	✓**	●
			Large roll	✓**	●

** Two parts required when placing an order

PROFILE 3 FITTINGS

Products may be subject to availability, please contact Customer Services. ✓ Standard product POA (Price on application) E-Luminate (POA)

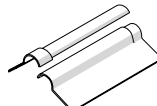
TWO PIECE PLAIN WING RIDGE					As the plain wings do not close the corrugations, this ridge allows a measure of ventilation.	
	Overall width	Net covering width		Natural Grey	Painted	
	713mm	651mm	Small roll	✓**	●	
			Large roll	✓**	●	

TWO PIECE NORTH LIGHT RIDGE					
	Overall width	Net covering width		Natural Grey	Painted
	713mm	651mm	Small roll	✓**	●
			Large roll	✓**	●

DISC TYPE RIDGE FINIAL			
			Painted
	Natural Grey	Painted	
	✓	•	

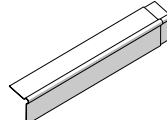
ROLL TOP BARGEBOARD					
	Wing dimensions		Length	Natural Grey	Painted
	200 x 200mm		1525mm	✓	●
			2440mm	✓	●
			3000mm	✓	●

PLAIN BARGEBOARD

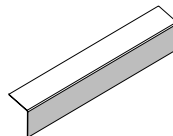

Wing dimensions	Length	Natural Grey	Painted
200 x 200mm	1800mm	✓	●
	2440mm	✓	●
	3000mm	✓	●
300 x 300mm	1800mm	✓	●
	2440mm	✓	●
	3000mm	✓	●

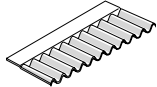
UNDER GLAZING FLASHING PIECE <small>MTD 6-8 weeks</small>				
	Overall width	Net covering width	Natural Grey	Painted
	711mm	651mm	✓	•

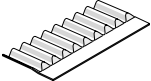
EAVES FILLER <small>MTD 6-8 weeks</small>				
	Overall width	Cover width	Natural Grey	Painted
	648mm	651mm	✓	•

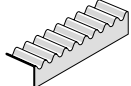
EAVES CORRUGATION CLOSURE PIECE <small>MTD 6-8 weeks</small>				
	Cover width	Overall width	Natural Grey	Painted
	651mm	648mm	✓	•

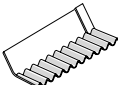
APRON FLASHING <small>MTD 6-8 weeks</small>				
	Cover width	Overall width	Natural Grey	Painted
	651mm	750mm	✓	•

* Part ordered as a pair

FOR ADVICE, LITERATURE AND SAMPLES, VISIT ETERNIT.CO.UK

APPLICATIONS



The Studio, private residence using Profile 3

Hereford using Profile 6



Ensworth House using Profile 3 and Farmscape

Ashford Grange Farm, using Profile 6 with spaced roof ventilation system



Tokavaig using Profile 3



RESOURCES

tools and assets that make design and specification as straightforward as possible

Fixing instructions

Comprehensive sitework, fixing and installation literature: eternit.co.uk

Literature

All current product and technical literature can be downloaded: eternit.co.uk

Book your CPD

Understand our recommendations relating to British Standards and Codes of Practice: email infouk@etexgroup.com

Samples

Samples are available for P6 and P3 subject to stocks at time of order: eternit.co.uk

Stockist information

To find details for stockists of Eternit products, visit: eternit.co.uk

CAD details

Access to CAD drawings can be obtained by emailing techuk@etexgroup.co.uk

SERVICES

Getting our knowledge to you and your project smoothly and efficiently

Customer Services

Eternit is committed to providing outstanding customer care and is staffed by experienced personnel:

E-mail infouk@etexgroup.com

To find your nearest stockist, please visit: eternit.co.uk

Technical Advisory Team

Specifiers require prompt, knowledgeable and detailed responses to a vast range of enquiries covering everything from the embodied energy of a typical roof tile, to the different ventilation options available.

Email techuk@etexgroup.co.uk

Our Technical Advisory Team is staffed by a qualified team with specialist knowledge not only of all Eternit products, but also crucially, how those systems integrate with other roofing components and comply with Building Regulations, Health and Safety, environmental and other critical roofing criteria.

E-mail techuk@eternit.co.uk

SUSTAINABILITY & STANDARDS

Credits, credentials and clarity of information

Quality standard

The Eternit UK factory is ISO 9001, 14001 and ISO OHSAS 18001 accredited. It achieves the highest standards in quality, health and safety and the environment.

CE Marking

All of our products covered by an EN Standard carry an appropriate CE Mark. This means that our products meet the performance requirements and have a guaranteed level of quality.

BREEAM and the Code for Sustainable Homes

Credits gained from specifying our A-rated products, combined with additional credits from BES 6001 make our products more beneficial to the specifier.

01 ORDERING

- All orders must be emailed through
- Email ordersuk@etexgroup.com
- Verbal orders will not be accepted
- When your order is processed, an order acknowledgement will automatically be sent
- Discrepancies should be communicated to Customer Services immediately
- Items marked POA (price on application) are represented by pale red or green shading. Please speak to your Area Sales Manager for a quotation
- Items marked POA are not available

Amendments to orders

- Amendments to delivery orders cannot be accepted the day prior to the planned delivery date
- Amendments to orders can only be accepted if the order has not been shipped and in the case of additions, there is adequate space remaining on the vehicle

Cancellations

- 24 hours notice of cancellation of an order placed by the purchaser is required to be given to the Company. Failure to provide such notice before the scheduled delivery date will entitle Eternit to charge 25% of the cancelled order value
- Persistent cancellation of placed orders by the purchaser, even with 24 hours notice, could result in future orders not being accepted
- No cancellations will be accepted for MTO products

Made to order products

- Made to order items are not stocked as standard and may be subject to a lead time and minimum order quantity. Please check these details with Customer Services
- Orders cannot be amended or cancelled once production has commenced
- The lead time for the supply of made to order products will be confirmed at the time of order
- Written confirmation, accepting our made to order terms of sale, will be required prior to order

02 DELIVERY

- Deliveries must comply with Eternit's minimum order quantities
- Deliveries below minimum order quantities may be subject to an additional small order surcharge
- All deliveries are made between 8:00am - 5:00pm at unspecified times
- Deliveries are made to kerbside and require hardstanding ground
- Charges will be applied to all deliveries which take over 1 hour
- A member of staff needs to be on site to accept delivery
- Drivers have the right to refuse to offload material if deemed unsafe
- Orders must be delivered on the same delivery date, in full to the same location
- Eternit endeavour to deliver on the agreed date. However, the date or time cannot be guaranteed and we do not accept liability of consequential losses
- Customers must inform Eternit of vehicle/access restrictions

Small order charges

- The minimum order value is £1000. There will be a delivery surcharge of £150 for any orders below this amount. Please speak to our Customer Service Team for delivery options that may help avoid these surcharges

Lead times

- Standard items are typically available within 3-5 working days
- Painted items are typically available within 10-15 working days
- E-Luminate items are typically available within 20-25 working days.

03 COLLECTIONS

- Collection orders will be available from the date provided by your Customer Service Advisor
- To avoid loading delays, customers need to provide at least 24 hours notice of their arrival time

Information required on collection:

- The Eternit sales document number (supplied on your order acknowledgement) or alternatively your customer order number
- An overview of what is being collected to allow the driver to check their load prior to leaving site

Vehicle loading

All drivers collecting products must adhere to the on site health and safety instructions as summarised below:

- Follow instructions given by loading team at all times
- Remain in the cab of their vehicle with their engine switched off and parking brake applied during delivery
- Ensure that they do not move their vehicle until instructed by the loader
- We will not permit standing on top of the load at any Etex Group site without the use of a fall arrest system or netting station
- Customers should employ methods of load security that do not require the driver to access the rear of the vehicle
- The driver will only access the rear of the vehicle when the forklift truck has withdrawn.
- For full details of Eternit's Vehicle Loading Policy and Customer Collection Policy, please contact Customer Services

Personal protective equipment

All drivers collecting materials on site are required to use personal protective equipment (PPE) as listed below:

- Hi-Visibility vest or jacket
- Safety glasses or goggles (normal prescription glasses are not accepted as suitable eye protection)
- Safety footwear must be worn whilst out of the cab
- A hard hat with chinstrap must be worn whilst on the back of the vehicle (including crane)

04 PAYMENT

- All prices are net and exclusive of VAT
- This price list does not constitute an offer. All products are sold subject to the Company's conditions of sale

05 AFTERSALES

- Notification of claims for damaged material must in all cases be made within 24 hours of receipt
- Once a delivery ticket is signed, Eternit do not accept responsibility for damage or discrepancy

Full terms and conditions can be supplied on request. Please email ordersuk@etexgroup.com

VEHICLES

Customers are required to advise if they require a restricted or unrestricted vehicle.

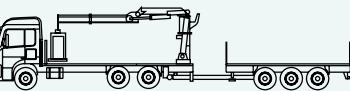

Wagon and drag

- Can carry around 22 tonnes
- Wagon and drag with offload facility depending on availability
- Where a moffett is chosen by Eternit, the max. travel distance is 50 metres
- Trailer will only be dropped with prior agreement and may be subject to a charge
- Allow 2 extra days rolling

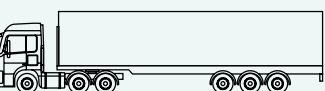
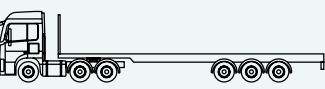

Artic

- Flat bed or taut-liner
- Largest carrying capacity and availability
- Can carry up to 26 tonnes
- Customer to provide offloading facility

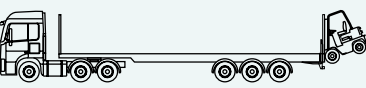

Unrestricted with offload

- Artic with moffett
- Can carry around 25 tonnes
- Offloaded with a moffett depending on availability
- Where a moffett is chosen by Eternit, the max. travel distance is 50 metres

MANUFACTURING & STOCKING LOCATION



Meldreth

Eternit Ltd, Meldreth, Nr. Royston, Hertfordshire, SG8 5RL

Opening times

Mon-Thur: 7:00am - 16:00pm

Fri: 7:00am - 15:00pm

This publication is based on the latest data available at the time of printing. Due to product changes, improvements and other factors, the Company reserves the right to change or withdraw information contained herein without prior notice. For specific applications users should refer to the Technical Advisory Team and relevant Standards and Codes of Practice for guidance. The photography shown in the document should not necessarily be taken as recommendations of good practice. The printing process restricts the exact representation of colours. For true colour reference, please request product samples.



Tel 01283 501501
Email infouk@etexgroup.com
Visit eternit.co.uk

Etex [Exteriors] UK, Wellington Road, Burton-upon-Trent, Staffordshire DE14 2AP