

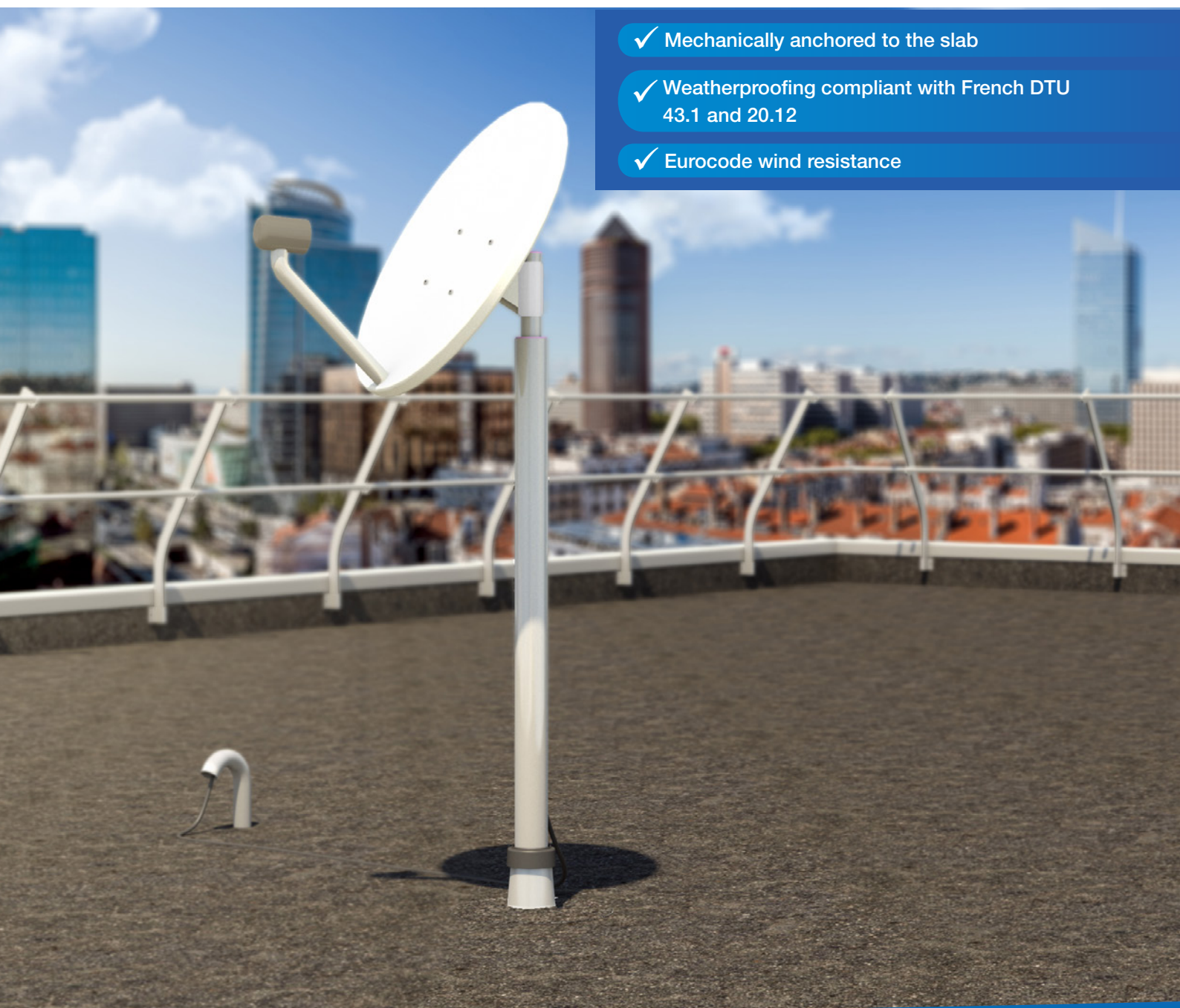

# Sherpal<sup>®</sup> Satellite dish support mast

Aluminium satellite dish support structure  
for flat roofs



- ✓ Mechanically anchored to the slab
- ✓ Weatherproofing compliant with French DTU 43.1 and 20.12
- ✓ Eurocode wind resistance

# System elements

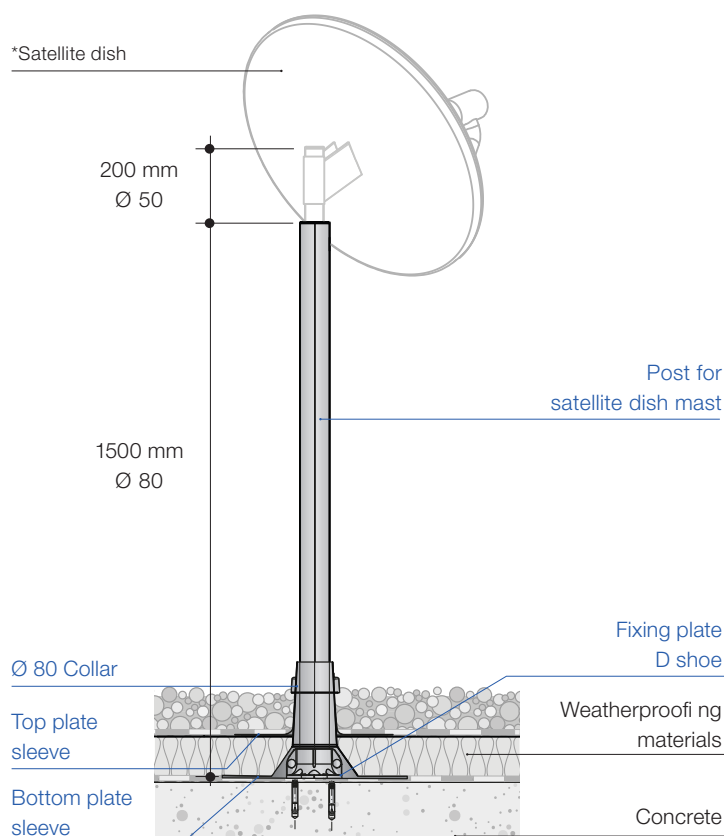

## Field of use

mast can support one satellite dish.

Sherpal® satellite dish support mast is compliant with Eurocodes in the following conditions:

- Building height: 20 m max
- Wind zone 2
- Land category 3b
- Satellite dish diameter 800 mm max

For all other cases, please contact us.

\*The part used to fix the satellite dish to the mast is not included.



Aluminium lacquering, cleaning and care information available on [www.danialu.com](http://www.danialu.com) or using this **code QR**.

## Sherpal® Satellite dish support mast

☐ Purchase order ☐ Price request

(Tick the required option)

Please provide the following information.

Company stamp

Date: .....

Company (address / company stamp) .....

Contact: Mrs/Mr .....

Phone number: ..... Fax: .....

Mobile phone: ..... Email: .....

Site reference: ..... Delivery address: .....

Contact on site: .....

Quantity ..... units

☐ Plate sleeve

☐ Bottom plate sleeve

### Finish

☐ Basic aluminium

☐ Danilac lacquered aluminium Ral colour .....

### Slab specifications

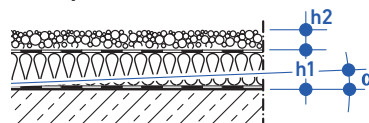

h1 weatherproofing: ..... mm

Thickness of gravel h2= ..... mm

Slope  $\alpha$  = ..... °

### dani alu France

Phone: 0033 478 878 973

E-mail: [export@danialu.com](mailto:export@danialu.com)

[www.danialu.com](http://www.danialu.com)

### dani alu Germany

Phone: 0049 6021 453 020

E-mail: [post@danialu.de](mailto:post@danialu.de)

[www.danialu.de](http://www.danialu.de)

### dani alu Austria

Phone: 0043 650 6500 000

E-mail: [post@danialu.at](mailto:post@danialu.at)

[www.danialu.info](http://www.danialu.info)

### dani alu United Kingdom

Phone: +44(0) 1865 59160

E-mail: [contact@danialu.co.uk](mailto:contact@danialu.co.uk)

[www.danialu.uk](http://www.danialu.uk)