



IDP

PORTABLE OUTDOOR INFRA-RED HEATER

IDP-2000

## 1.- IMPORTANT INFORMATION

- Read these instructions carefully before installing or using this heater for the first time. The guarantee will not cover damage caused by not following these instructions.
- The instructions should be retained for future reference. This guide must be kept and given to any new owner.
- The use of this heater is forbidden in areas where gases, explosive or inflammable substances are present.
- DO NOT USE THIS HEATER TO DRY CLOTHES.
- Ensure the power supply to the socket into which the heater is plugged is in accordance with the rating label on the heater and that the socket is earthed.
- Keep the power cable away from the hot body of the heater.
- Do not let the cable hang over the edge of a table or counter or let it come into contact with any hot surfaces.
- Do not use the heater while sleeping. Never leave the heater unattended while it is operated.
- The improper handling can cause injuries.
- Always unplug the heater when moving it from one location to another.
- Do not use extension cable. This could overheat and cause fires.
- Never touch the heater with wet or humid hands or barefoot.
- Do not leave any object above the heater, covering the grill, or restricting the air flow.
- The heater must be disconnected during installation and cleaning.
- The heater should not be located in front of, or under an electrical socket.
- The heater should be positioned so the controls cannot be used when using the shower or bath.
- The location of the heater should not be close to curtains or other inflammable articles, and the heater must not be located immediately below dripping clothes.
- It is important to maintain a minimum distance of 80 cm between the heater and curtains, or any other combustible materials that will be affected by the radiated heat.
- Installation should be carried out by a qualified electrical installer.
- Do not touch the fireguard or reflecting cover when the heater is in use; do not insert any objects into the fireguard to prevent high temperature scalding.
- Never rotate the heating part of the appliance during operation. To change the tilt angle of the heating part, we advise you to wait for 15 minutes after the appliance has been switched off.
- Although the heating element has stopped glowing, it may still be live and potentially dangerous. Check that the selection indicator (5) is in position off before taking any action.
- Avoid using the heater where there are children or disabled persons without being adequately supervised by a responsible person.
- Never dismantle the components of the heater or replace the components with the ones that do not meet the safety requirements. If the supply cord is damaged, it must be replaced by the manufacturer or its service agents or a similarly qualified person in order to avoid a hazard.
- The appliance is not intended for use by persons (including children) with reduced physical, sensory or mental capabilities, or lack of experience and knowledge, unless they have been given supervision or instruction concerning use of the appliance by a person responsible for their safety.
- Children should be supervised to ensure that they do not play with the appliance
- The heater should be switched off and be disconnected from electric supply to avoid accidents when it is not being watched or not in use for a long time.
- This appliance must be earthed.
- Ensure the voltage is suitable for the heater. Refer to technical label.
- The presence in the atmosphere of tobacco smoke or atmospheric pollution can with time discolour the heater surface.
- The infrared heater is designed to only work in a horizontal position.
- The heater is provided with an anti-tilt switch will switch off the heater if it is overturned, and will switch it on again automatically when it is restored to its upright position.
- Never operate your appliance if it has fallen over.
- This movable appliance is designed for use indoor and outdoor. Although the heater may be used outdoors, the main plug must only be connected to the supply indoors.

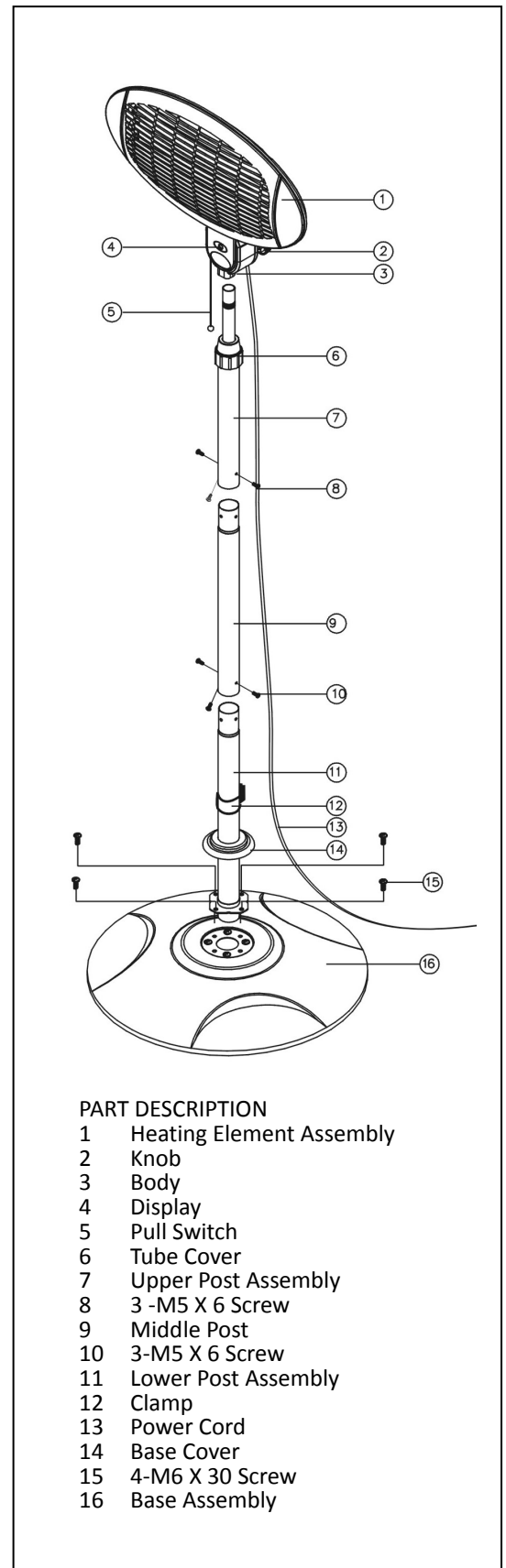

### PART DESCRIPTION

- |    |                          |
|----|--------------------------|
| 1  | Heating Element Assembly |
| 2  | Knob                     |
| 3  | Body                     |
| 4  | Display                  |
| 5  | Pull Switch              |
| 6  | Tube Cover               |
| 7  | Upper Post Assembly      |
| 8  | 3 -M5 X 6 Screw          |
| 9  | Middle Post              |
| 10 | 3-M5 X 6 Screw           |
| 11 | Lower Post Assembly      |
| 12 | Clamp                    |
| 13 | Power Cord               |
| 14 | Base Cover               |
| 15 | 4-M6 X 30 Screw          |
| 16 | Base Assembly            |

## **2.- INSTALLATION**

Open the box to take out the heater and all the accessories.

1.- Insert the lower post assembly (11) into the base assembly (16) and then fix it tightly by means of 4 M6X30 screws, and insert the clamp (12) into the lower post (11).

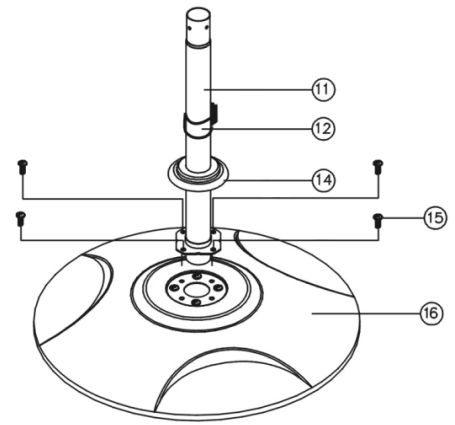

2.- Join the Lower Post Assembly and the Middle Post (9) together with 3-M5X6 screw.

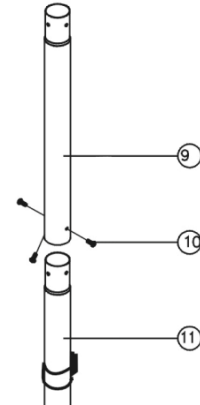

3.- Join the Upper Post Assembly (7) and the Middle Post (9) together with 3-M5X6.screw.

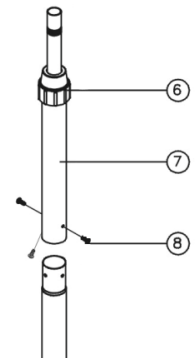

4.- Join the Heating Element Assembly (1) and the Upper Post Assembly (7) together ,then fix them tightly by rotating the Knob, and put the power cord supply into the clamp.

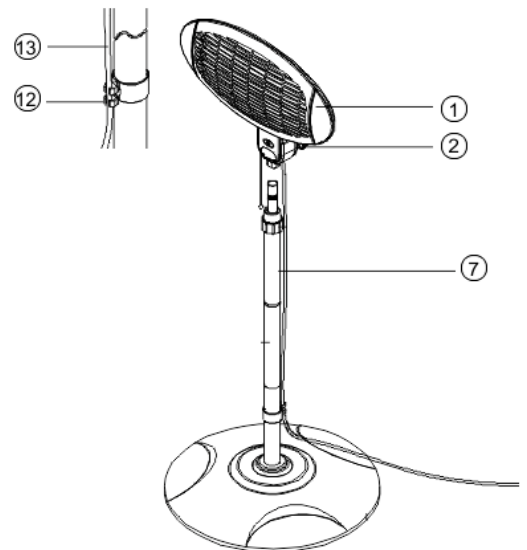

5.- According to the request of use angle, Heating Element Assembly can adjust Angle at 0°~45°.

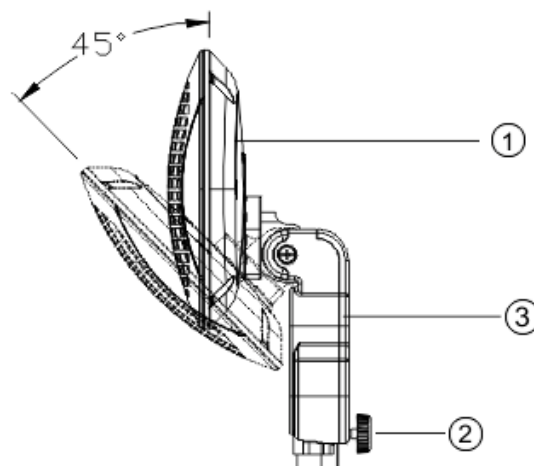

### **3.- OPERATION**

WARNING : Always choose a safe location for the heater, keeping in mind the safety instructions outlined in point 1.

The appliance is switched on by means of the pull switch (5). The slight vibration noticeable when the appliance is switched on will stop after a few seconds.

The indicator on the heater will show different positions in a rotary way:

- Position 0: Stop
- Position 1: 650 W (normal power)
- Position 1: 1350 W (intermediate power)
- Position 1: 2000 W (full power)

The heater is provided with an anti-tilt switch will switch off the heater if it is overturned, and will switch it on again automatically when it is restored to its upright position.

### **4.- MAINTENANCE**

Clean and dust with a dry, soft cloth only when the unit is disconnected and cold.

Do not use solvents or abrasive products for cleaning.

This thermal radiator has been manufactured under an assured quality system using environment friendly processes.

Please take the heaters to a clean point once their useful life is finished, in order to recycle their materials in the right way.

### **5.- SPECIFICATIONS**

Model: IDP-2000

Voltage: 230V~

Input: 2000W

Class I IPX4

**EN**



The symbol on the product or in its packaging indicates that this product may not be treated as household waste. Instead it shall be handed over to the applicable collection point for the recycling of electrical and electronic equipment. By ensuring this product is disposed of correctly, you will help prevent potential negative consequences for the environment and human health, which could otherwise be caused by inappropriate waste handling of this product. For more detailed information about recycling of this product, please contact your local city office, your household waste disposal service or the shop where you purchased the product. These instructions are only valid in the EU member states.



ELNUR S.A.  
Travesía Villa Esther, 11  
28110, Algete - Madrid

**Elnur UK - Unit 1**  
**Brownstreet North,**  
**Leigh, WN7 1BU**  
**01942 6770119**

[www.elnur.es](http://www.elnur.es)

[www.elnur-global.com](http://www.elnur-global.com)

[www.elnur.co.uk](http://www.elnur.co.uk)



*As a part of the policy of continuous product improvement ELNUR, S.A. reserves the right to alter specifications without notice*

*Como parte de la política de mejora continua ELNUR S.A. se reserva el derecho a realizar modificaciones técnicas sin previo aviso*

*Dans le cadre de la politique d'amélioration continue, Elnur s.a. se réserve le droit de réaliser des modifications techniques sans préavis.*