

1000TD series

Tiled Door

Standard Steel Access Panel for ceramic tiled walls **NON FIRE RATED**

KEY FEATURES

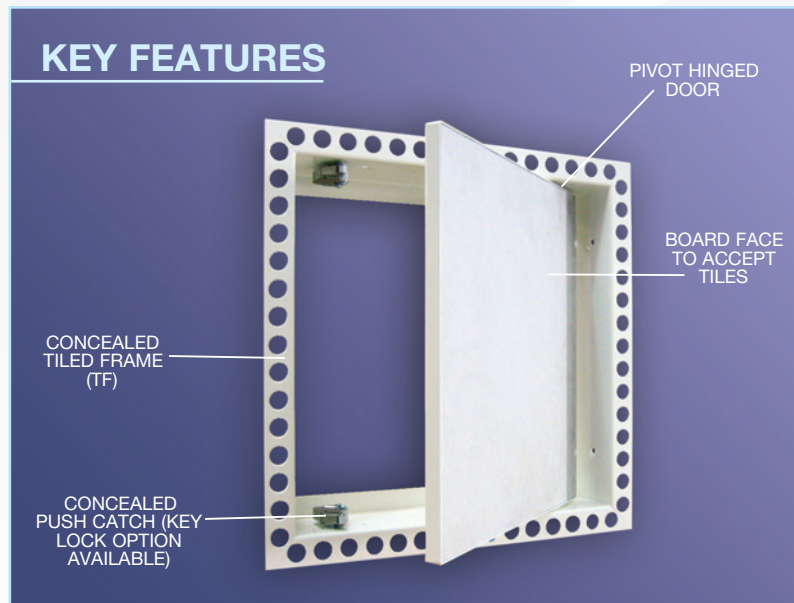

LOCK OPTIONS



Push Catch (PC)



Budget lock (BL)



Pivot Hinge and Concealed Frame



Completed Tiled Panel

INTRODUCTION

The PROFAB 1000/TD series range of steel access panels provides access into tiled jointless plaster/plasterboard walls, where access to mechanical and electrical services is required

DESCRIPTION

COMPOSITION & MANUFACTURE

The metal frame holds a plasterboard faced door through a pivot hinge system. The door is held closed with either a concealed push catch (PC) or with a concealed budget lock (BL) which opens towards the user. The pivot hinge system allows the door to be removed during installation. Panels are tiled to match the surrounding tile module. A constant 2mm gap is maintained between the door and frame by the dome location system.

1000/TF/TD/PC or BL

Frame: 1.2mm thick electro-galvanised factory welded mild steel. Manufactured to suit specified tile module size and finished powder coated semi-gloss white all over.

Door: 1.2mm thick electro-galvanised mild steel frame finished semi-gloss white all over and lined with a plasterboard infill to provide surface to accept tile.

Locks: Concealed push catch (PC) or budget lock (BL) on the rear of the door, operated from the front face with an 8mm square drive key (included). For budget lock a white, round removable cap on the door conceals the keyhole of the budget lock.

TYPICAL SIZES & WEIGHTS

(nominal only, actual size is dependant on the selected tile) Minimum size is 150mm x 150mm.

Dim x	Dim y	Kgs
300	300	4.0
450	450	8.0
600	600	13.0

All dimensions in millimetres.

All doors hinge along dimension y.

All panels are single door.

Please note that 600 x 600mm is the maximum size available for this product. For larger sizes please refer to 8000 series product.

KEY POINTS TO NOTE

1. X and Y dimensions on the 1000 TF are the manufactured panel size and refer to the door size that is obtained from the tile module and grout line width to be specified when ordering.
2. Overall frame depth is 80mm.
3. Minimum grout width is 1mm.
4. Structural opening required for 1000/TF installation is $(X + (2 \times \text{grout width}) + 5) \times (Y + (2 \times \text{grout width}) + 5)$. Use suitable packing at fixing points between the frame and structural wall to maintain squareness and rigidity. Available access when installed, with door in the open position is $(X - 90) \times (Y - 40)$

1000TD series

Tiled Door

FIRE PERFORMANCE

NON FIRE RATED

The 1000/PD series panel is a non-fire rated product, although being manufactured from steel it is non-combustible, excluding the plasterboard which has limited combustibility and which is tiled over, and the non-structural plastic components. For further advice on fire resistant requirements, contact Profab. Technical Services Department.

Fig.1

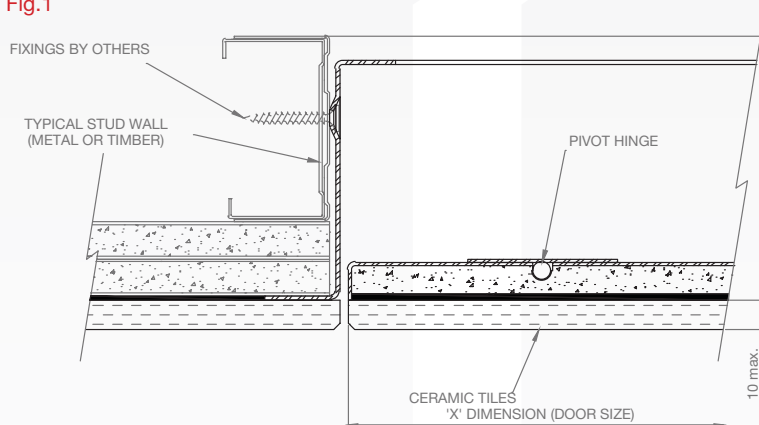

Fig.2

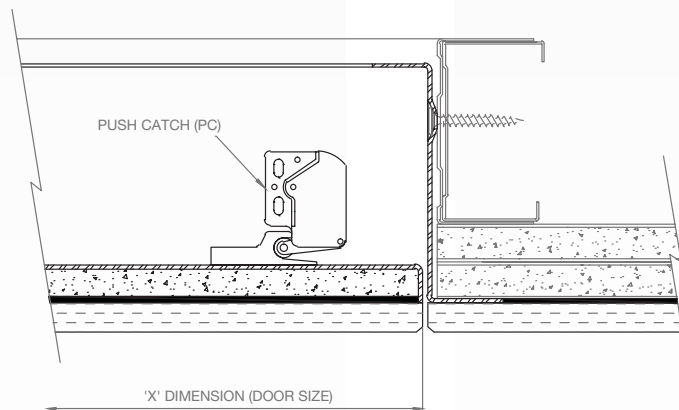
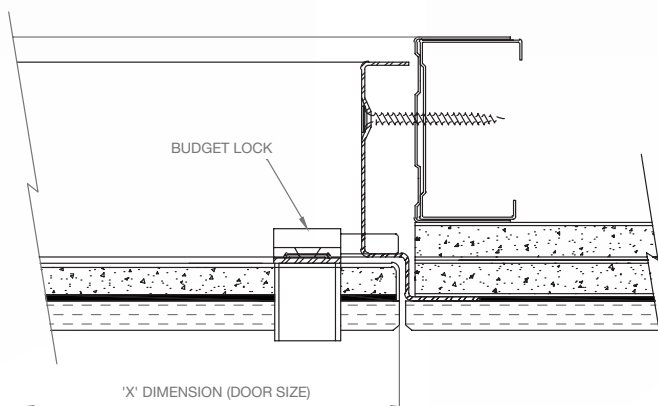

Fig.3



APPLICATIONS & USES

All standard panels are for internal use.

1000/TF is suitable for vertical use where the panel is being installed prior to any ceramic tiling being completed.

SPECIFICATIONS

EXAMPLE:

Access panel type 1000/TF/PC Size 454mm x 606mm single door to suit 150mm x 150mm x 6mm ceramic tiles with a 2mm grout width and fitted with a concealed push catch, supplied by Profab Access Ltd.

OTHER OPTIONS

The 1000/TD series is an entry-level access panel designed to provide a simple, economic means of accessing building services, so only limited modifications are available with this product. However, Profab's manufacturing flexibility provides for alternative sizes, locks and paint colours. Discussions with Profab should take place at the earliest opportunity if specification changes are being considered.

INSTALLATION

Apertures formed in masonry and dry lined walls should be correctly formed in accordance with the wall/system manufacturer's recommendations. The wall should adequately support the panel's additional weight and operating forces exerted on it during installation and operation. Typical fixing details are shown on this data sheet.

OPERATION

The panel is fitted either with a concealed push catch (PC) operated from the front face and requiring no key, or with a concealed budget lock (BL) operated with a supplied square drive key through a round keyhole in the door face following removal of the white plastic cap. (Additional keys and caps are available from Profab).

SUPPLY

Available direct from Profab and through a network of distributors. Refer to Profab for guidance.

TECHNICAL SERVICES

ADVISORY

If there is any doubt about the information given in this data sheet or the intended product usage, then Profab should be consulted. We are only too pleased to advise on the use of our products. Technical representation is available at all stages of a project. In house manufacturing enables us to offer full flexibility in product design for projects that need to meet specific design criteria.



1000TD series

Tiled Door - continued . . .

QUALITY & DEVELOPMENT

Profab access panels are manufactured under strictly controlled quality systems and so we reserve the right to amend any of our published information and specifications deemed necessary as a part of our continuous product development policy, without prior notice.

PLEASE CONTACT PROFAB ACCESS OR YOUR NEAREST DISTRIBUTOR FOR FURTHER INFORMATION & SALES

Distributor:

Profab Access Ltd.
Unit 45-48 Fourways, Carlyon
Road Industrial Estate,
Atherstone, Warwickshire
CV9 1LG
UK

Tel: 01827 718222
Fax: 01827 721092
sales@profabaccess.com
www.profabaccess.com

