



hergom

WOOD STOVES & FIREPLACES

PRODUCT CATALOGUE 2018-2019

ON FIRE SINCE 1959

"If you want



HERGÓM

Founded in 1959, Hergóm is today one of the main manufacturers of hearth products worldwide. Through more than half a century, Hergóm has gained success and experience in developing wood and biomass heating appliances, focusing on natural fuels, through research, development and improvement of the efficiency of our products.

perfection, do it yourself"

FOUNDRY

Owning a foundry, we use fine-cast iron as a primary source for our products. Cast iron grants our hearth appliances high durability, attractive and unique looks, and releases a steady, cozy and gentle warmth thanks to its thermal inertia, remaining warm for several hours after the fire has gone out.



PERFECTION

At Hergóm we know that to get to perfection, it is better to do everything ourselves. Every step, from design and engineering to the finished product, is carried out at our own facilities: castings, machining, ceramic enameling, final assembly... to make sure that your appliance is built in the rich tradition of our company, and will serve you faithfully for years to come.



ON FIRE

Everyday more and more consumers are discovering the benefits of wood heating, which is today one of the most economic and pleasant ways of heating their homes. With over 50 years of experience in designing and manufacturing hearth products, your Hergóm purchase represents not only the latest in aesthetic advances, but also the utmost in powerful heating technology. It's this integrity that gives Hergóm products their unmatched appeal, and has for over 50 years. All Hergóm stoves and fireplaces meet UNE-EN-13229 standards that ensure thermal values and performance.





STOVES

Fabricated entirely of top-quality grey cast iron shaped in a modern state-of-the-art moulding plant, our line of stoves sets the bar for quality. Exclusive design features ensure each appliance is economical and safe, providing clean and complete combustion for warmth you can trust. Whether it is classic painted iron or vitreous enamel glazed, our stoves are as beautiful as they are functional - with optimized fire viewing areas and distinctive character down to the last detail.





GLANCE SERIES

DESIGNED BY STRAND + HVAAS

Creations by Danish studio Strand + Hvas, located in Copenhagen, are based on Scandinavian design tradition: simplicity and clean lines.

Works by Niels Hvass and Christina Strand include various commercial successes and experimental projects, and is based on improving the user's interacting with their products. That is why the Glance Series is focused on providing the best user experience. Clean and balanced lines are the core of its design and the key of its allure to international consumers.



ENJOY FIRE

The firebox of the Glance Series stoves is composed by three ceramic glass walls under a cast iron structure, allowing you to enjoy the glow of the flames from all angles. The firebox is airtight, keeping uncontrolled air from entering the combustion process and granting you full control of the burn rate. Glass will remain always clean thanks to Hergóm's Airwash system, which drives air currents to the inner surface of the glass, keeping it free from soot and offering a perfect view of the fire.



GLANCE L

CE Certification: RRF 40 16 4301
Norm: EN 13240
Maximum heat output (KW): 13
Nominal heat output: 9,5 kw
Efficiency: 77%
Dimensions (An. x AL. x P.): 700 x 825 x 411



**Best Stove over 5 kW",
Hearth & Home Exhibition, Harrogate UK**



GLANCE WM

CE Certification: RRF 40 14 3599
Norm: EN 13240 / Art. 15a BV-G / BlmSchV
Maximum heat output (KW): 9
Nominal heat output: 7 kw
Efficiency: 80%
Dimensions (An. x AL. x P.): 550 x 825 x 415





GLANCE

CE Certification: RRF 40 14 3599
 Norm: EN 13240 / Art. 15a BV-G / BlmSchV
 Maximum heat output (KW): 9
 Nominal heat output: 7 kw
 Efficiency: 80%
 Dimensions (An. x AL. x P.): 550 x 825 x 415





E-40

CE Certification: RRF 40 16 4357

Norm: EN 13240 / BlmSchV

Maximum heat output (KW): 12

Nominal heat output: 9 kw

Efficiency: 79,2%

Dimensions (An. x AL. x P.): 600 x 870 x 430



White cast iron interiors.
Enjoy the durability and efficiency of cast iron, and the beautiful glow of the flame thanks to the heat-storage white cast iron firebox lining.



E-30 L

CE Certification: RRF 40 12 3104

Norm: EN 13240 / BlmSchV

Maximum heat output (KW): 14

Nominal heat output: 11 kw

Efficiency: 79,3%

Dimensions (An. x Al. x P.): 600 x 870 x 430





E-30 M

CE Certification: RRF 40 16 4357
Norm: EN 13240 / BlmSchV
Maximum heat output (KW): 12
Nominal heat output: 9 kw
Efficiency: 79,2%
Dimensions (An. x AL. x P.): 660 x 740 x 540

White cast iron interiors.
Enjoy the durability and efficiency of cast iron,
and the beautiful glow of the flame thanks to
the heat-storage white cast iron firebox lining.





E-30 S

CE Certification: RRF 4O 12 31O2
 Norm: EN 1324O / BlmSchV
 Maximum heat output (KW): 9
 Nominal heat output: 7 kw
 Efficiency: 79,1%
 Dimensions (An. x Al. x P.): 590 x 699 x 492

CE Certification: EZKA 14-O176-1
 Norm: EN 1324O
 Maximum heat output (KW): 7
 Nominal heat output: 5 kw
 Efficiency: 76,7%
 Dimensions (An. x Al. x P.): 455 x 522 x 456

E-30 XS

The new E-30 XS multifuel stove is designed to burn coal as well as wood, offering an efficient, optimum combustion with both fuels.





E-20 NS

CE Certification: LEE/O3O/O6-1

Norm: EN 13240

Maximum heat output (KW): 12

Nominal heat output: 8 kw

Efficiency: 75%

Dimensions (An. x AL. x P.): 580 x 715 x 415

HEARTHSTONE SERIES



GREEN, EFFICIENT COMBUSTION

Stoves in the HearthStone series feature Fire Perfected Technology, which allows for a super-efficient combustion through an air supply system located all over the top of the airtight firebox. Thanks to Fire Perfected Technology, HearthStone stoves achieve extraordinary fuel efficiency and an extremely clean burn.

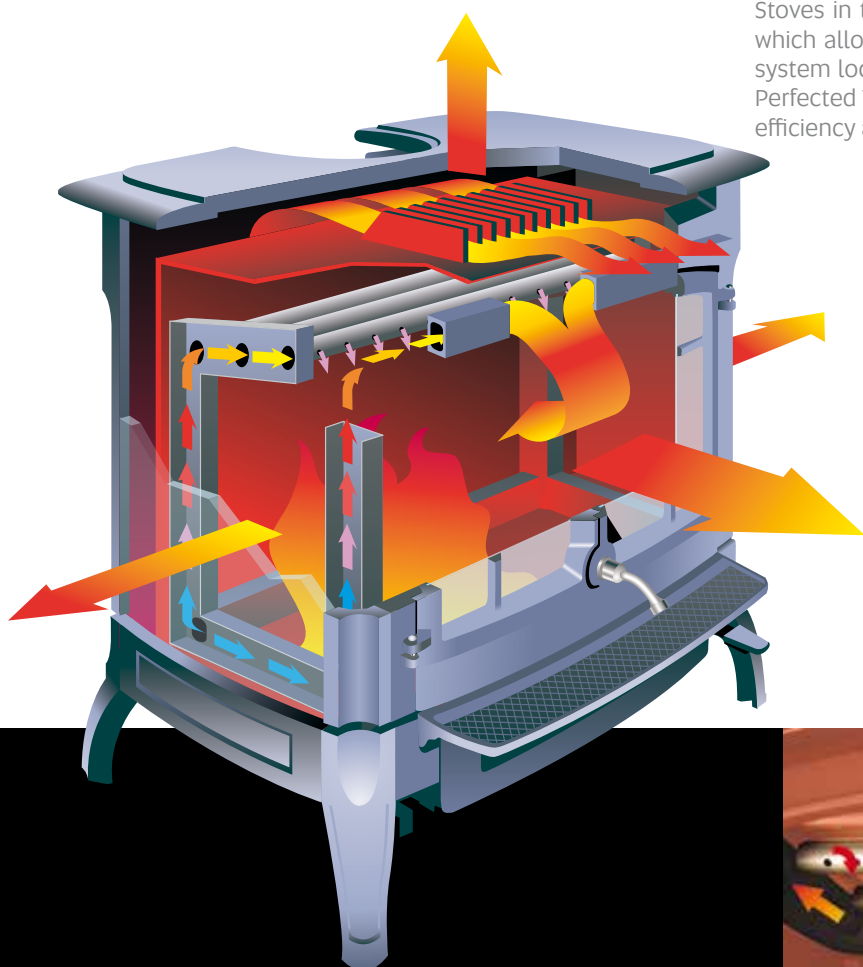

- 1** Advanced double combustion, thanks to the the back air collector and a series of stainless steel tubes located on the ceiling of the firebox which inject air. This air supply ignites remaining dust particles before they leave the chamber.
- 2** Airtight combustion chamber, avoiding unwanted air supply and achieving a controlled, precise burn regulation.
- 3** Single lever control. The stove is easy operated and performance more consistent.
- 4** Ceramic baffle with extra heat resistance.
- 5** Clean burn with extremely low particle emissions.

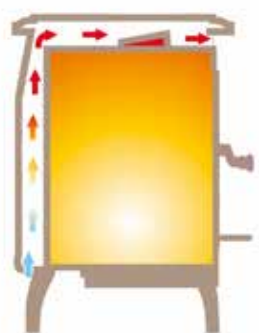
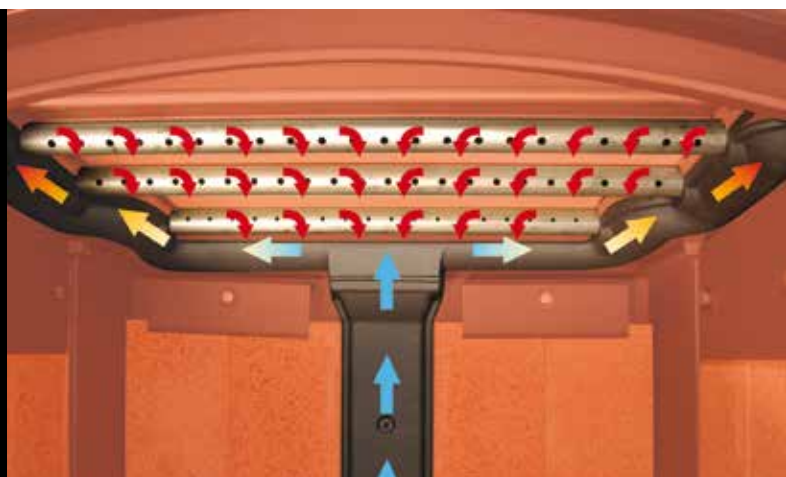

Double convective body: the double cast iron body and heat exchanger maximize the heating surface of the stove and the convection heat ensures a gentle warmth while keeping a powerful heat output. (Manchester and Bennington models).



ENAMELS

HearthStone models are offered in a variety of attractive glass enamel colours. Enamel finishes keep cast iron safe from external agents, and the gloss of their surface remains intact over time. Plus, the smooth surfaces allows for an easy cleaning.

HEATING WITH SOAPSTONE

Soapstone is a natural material which can absorb the high heat of a fire, then radiate a gentle, even and comfortable heat into the room.

Once heated, soapstone stays warm for hours, making it the ideal material for overnight heating or for other long stretches of time when you can't tend the fire.



CAST IRON + SOAPSTONE

HearthStone cast iron stoves are lined with soapstone on the inside of the firebox. You can enjoy the style of an all cast iron stove, and also benefit from the powers of soapstone. Our cast iron stoves provide heat soon after lighting, and also stay warm longer than other cast iron stoves thanks to the soapstone lining.



HEATLIFE™

HearthStone wood stoves stay warmer longer, keeping your home at a comfortable temperature, for an extended time. HeatLife™ measures the total hours of usable heat from a single load of wood. Hearthstone wood stoves use soapstone to retain heat and deliver consistent warmth long after the fire goes out. The combination of combustion technology with the HeatLife™ of soapstone means you're using less wood. Not only is your home warm and comfortable, but you're saving money and heating efficiently.

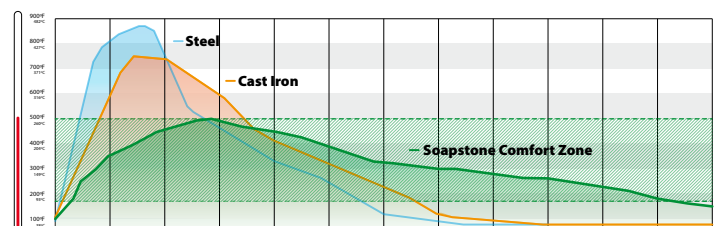





MANCHESTER

CE Certification: K9192012T1
Norm: EN 13240 / BlmSchv / US EPA
Maximum heat output (KW): 17
Nominal heat output: 12,6 kw
Efficiency: 75,2%
Dimensions (An. x Al. x P.): 770 x 780 x 600
Finish Options:
Black matt, Ivory enamel.



SHELBURNE

CE Certification: EZ/O9/2791-1

Norm: EN 13240 / BlmSchv / US EPA

Maximum heat output (KW): 13

Nominal heat output: 10,5 kw

Efficiency: 75,4%

Dimensions (An. x AL x P.): 770 x 740 x 550

Finish Options:

Black matt, Brown enamel.



CE Certification: 2006PMC/107
Norm: EN 13240 / US EPA
Maximum heat output (KW): 13
Nominal heat output: 11,5 kw
Efficiency: 84,4%
Dimensions (An. x AL. x P.): 570 x 670 x 560
Finish Options: Black matt, Brown enamel.

CRAFTSBURY



CE Certification: 2005PMC/O51
Norm: EN 13240 / US EPA
Maximum heat output (KW): 20
Nominal heat output: 16,3 kw
Efficiency: 79,2%
Dimensions (An. x AL. x P.): 740 x 690 x 540
Finish Options: Black matt, Blue majolica enamel.

HERITAGE



LONG LASTING HEAT

Thanks to its high efficiency and extraordinary heat retention properties of soapstone, the Heritage Stove releases gentle, long lasting warmth for hours, even after the fire has died out.





FIREPLACE INSERTS

Every day, more homeowners are in search of a solution to modernize their old, inefficient open fireplace. Hergóm has created a new range of fireplace inserts designed to be installed in new buildings, or to replace existing open fireplaces.

Our solutions enable you to continue enjoying fire as before, but with greater safety, comfort and efficiency. If you already had a fireplace, now you may have a Hergóm fireplace.

Hergóm compact inserts are perfect to heat a large room. With their quiet, adjustable speed blowers they drive hot air into the room, warming up the space quickly and evenly. Additionally, Hergóm inserts feature a steel jacket with connections to drive hot air to nearby rooms, through natural convection.



SERE 100 2C

CE Certification: EZKA/14/O158-1

Norm: EN 13229 / BlmSchV

Maximum heat output (kW): 17

Nominal heat output: 12 kW

Efficiency: 78,2%

Dimensions (An. x AL. x P.): 1.015 x 610 x 575

The Sere 100 2C fireplace insert features 2 glass doors that allow you to enjoy the fireview from two different rooms, or from two different areas in the same room. Wood can be loaded from both sides.





SERE 100

CE Certification: EZKA/12/O75-3
Norm: EN 13229 / BlmSchV
Maximum heat output (KW): 17
Nominal heat output: 12 kw
Efficiency: 75%
Dimensions (An. x AL. x P.): 1.015 x 609 x 483



SERE 80

CE Certification: EZKA/12/O75-2
Norm: EN 13229
Maximum heat output (KW): 13
Nominal heat output: 10 kw
Efficiency: 73,2%
Dimensions (An. x AL. x P.): 815 x 609 x 483





SERE 70

CE Certification: EZKA/12/O75-1

Norm: EN 13229

Maximum heat output (KW): 11

Nominal heat output: 8,9 kw

Efficiency: 71,3%

Dimensions (An. x AL. x P.): 715 x 540 x 483



NATURE SERIES

Built in cast iron and featuring a large ceramic glass for a panoramic fire view, the Nature fireplace inserts family is state-of-the-art burning technology, a sophisticated and efficient heat source. The double combustion system and the airtight firebox, lined in refractory or cast iron, guarantees a high temperature in the combustion chamber. As a result, a complete and long lasting burn process is achieved.

THE NATURE ADVANTAGES

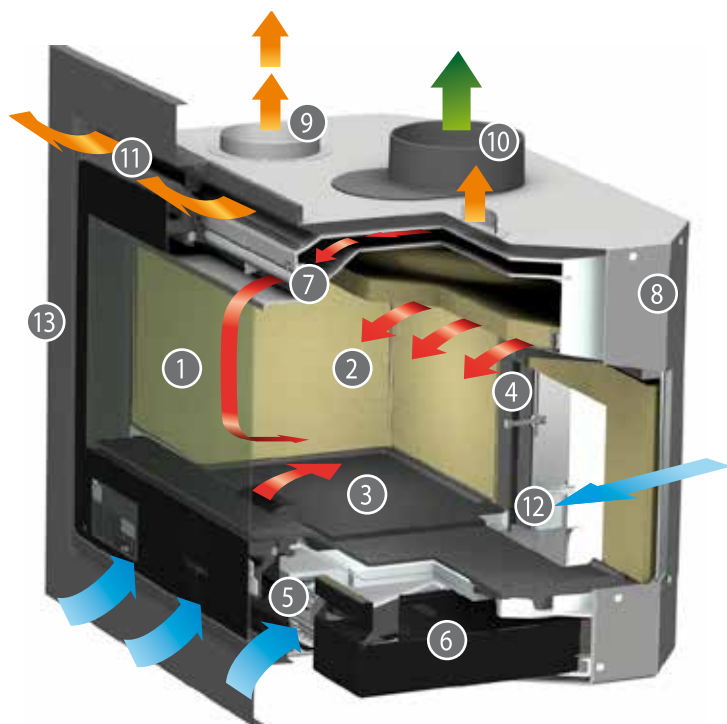

NATURE 100

CE Certification: EZKA/12/O75-6

Norm: EN 13229

Maximum heat output (KW): 17

Nominal heat output: 12 kw

Efficiency: 77,1%

Dimensions (An. x AL. x P.): 998 x 598 x 543



REMOTE CONTROL

- Primary air intake
- Combustion air
- Convection air
- Smoke exit

- ① Ceramic glass with patented invisible attachment to the cast iron door frame (PAT. ES2381288B1).
- ② Firebox lining in cast iron or refractory material.
- ③ Firebox bottom in cast iron.
- ④ Double combustion system.
- ⑤ Convection turbine with adjustable speed.
- ⑥ High capacity removable ash pan.
- ⑦ Airwash clean glass system
- ⑧ Convection steel jacket.
- ⑨ Convection air outlets.
- ⑩ Two position adjustable flue collar.
- ⑪ Front convection air exit.
- ⑫ External combustion air inlet.
- ⑬ Finishing frame.



Nature inserts allow you to adjust combustion air flow easy and conveniently through the remote control. Featuring an auto mode, the appliance adjusts automatically the air intake according to its temperature, optimizing its efficiency and protecting it from overheating.





NATURE 70

CE Certification: EZKA/12/O75-4

Norm: EN 13229

Maximum heat output (KW): 11

Nominal heat output: 8,5 kw

Efficiency: 75,4%

Dimensions (An. x AL x P.): 698 x 548 x 492





NATURE 80

CE Certification: EZKA/12/O75-5

Norm: EN 13229

Maximum heat output (KW): 13

Nominal heat output: 10 kw

Efficiency: 76%

Dimensions (An. x AL. x P.): 798 x 548 x 492





SLIDING DOOR FIREPLACES

Hergóm's sliding door fireplaces are the perfect appliances to give a touch of warmth and distinction to your most appreciated living spaces. Their modern designs, balanced proportions and oversized glass surfaces allow for a unique fire-viewing experience. Glass frames slide smoothly upwards for an unobstructed vision of the fire. Additionally, door panels are hinged to allow you for an easy cleaning of the window panels. Most models feature a convection jacket and fans to drive hot air to other rooms.

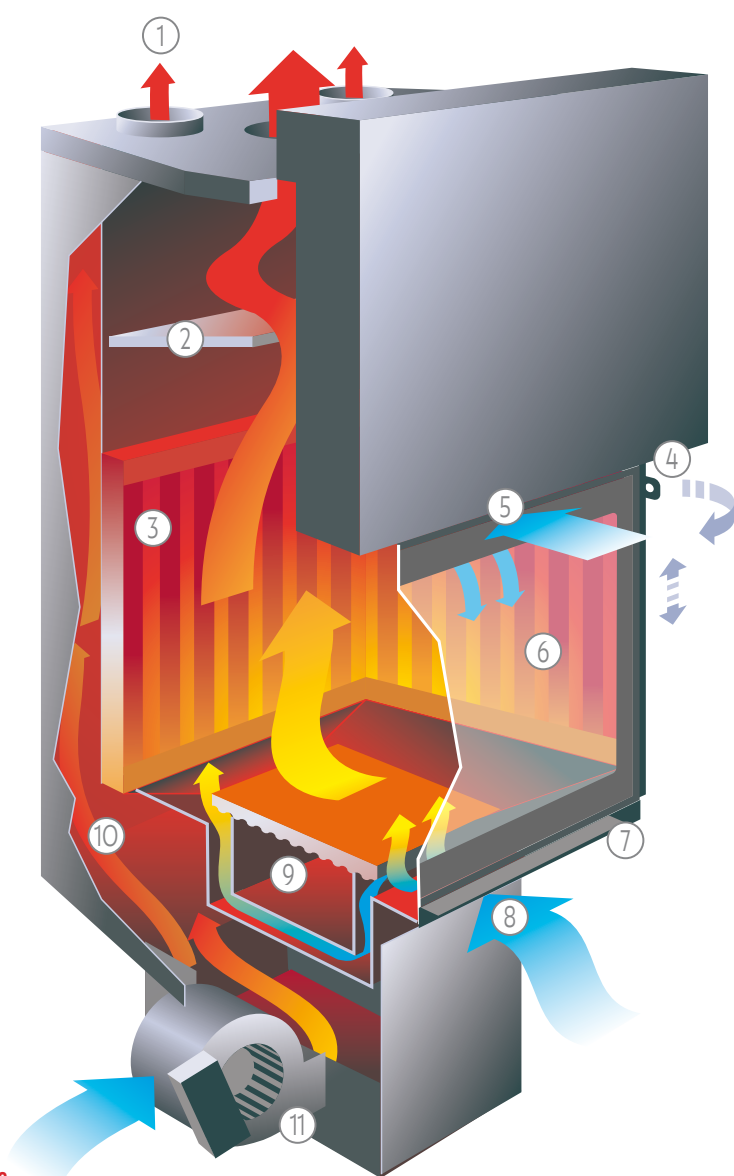

- ① Convection outlet for hot air channeling to nearby rooms.
- ② Ceramic walls and baffle, that keep high temperatures inside the firebox and increase efficiency.
- ③ Temperatures inside the firebox and increase efficiency.
- ④ Oscillating door opening.
- ⑤ Adjustable secondary air intake and "Airwash" glass cleaning system.
- ⑥ Ceramic glass.
- ⑦ Sliding door opening.
- ⑧ Adjustable combustion air inlet.
- ⑨ Removable ash pan.
- ⑩ Steel convection jacket.
- ⑪ Convection air intake and convection blower (optional).

STILKAMIN XL

CE Certification: LEE/O3O/10
Norm: EN 13229 / BlmSchV
Maximum heat output (KW): 25
Nominal heat output: 23 kw
Efficiency: 75,1 %
Dimensions (An. x AL. x P.): 1.315 x 1.415 x 601
Dimensions glass (An x AL): 1.120 x 520



STILKAMIN L

CE Certification: LEE/O3O/10
Norm: EN 13229 / BlmSchV
Maximum heat output (KW): 23
Nominal heat output: 20 kw
Efficiency: 76 %
Dimensions (An. x AL. x P.): 1.121 x 1.471 x 591
Dimensions glass (An x AL): 920 x 520



CE Certification: LEE/O3O/O9
Norm: EN 13229 / BlmSchV
Maximum heat output (KW): 20
Nominal heat output: 17 kw
Efficiency: 77 %
Dimensions (An. x Al. x P.): 909 x 1.553 x 599
Dimensions glass (An x Al): 720 x 600

STILKAMIN S 600





STILKAMIN S 460

CE Certification: LEE/O30/O9
Norm: EN 13229 / BlmSchV
Maximum heat output (KW): 20
Nominal heat output: 17,5 kw
Efficiency: 79 %
Dimensions (An. x AL. x P.): 919 x 1.553 x 599
Dimensions glass (An x AL): 720 x 460

ECK

CE Certification: LEE/O43/O9
Norm: EN 13229 / BlmSchV
Maximum heat output (KW): 17
Nominal heat output: 13 kw
Efficiency: 75 %
Dimensions (An. x AL. x P.): 849 x 1.250 x 615
Dimensions glass (An x AL x P.): 770 x 513 x 357



hergoma 37



WOOD FIRED OVENS

Hergóm roasting ovens that use all available advances and technologies to provide a perfect log grill. Enhanced control over temperature, faster cooking times, and independent cooking chambers that prevent smoke and soot from affecting the flavor of your food. Our wood burning ovens are an innovative combination of cast iron and stainless steel, in strict compliance with food hygiene standards. The most traditional and delicious dishes can now be prepared in these ovens, conceived for indoor or sheltered outdoor use.

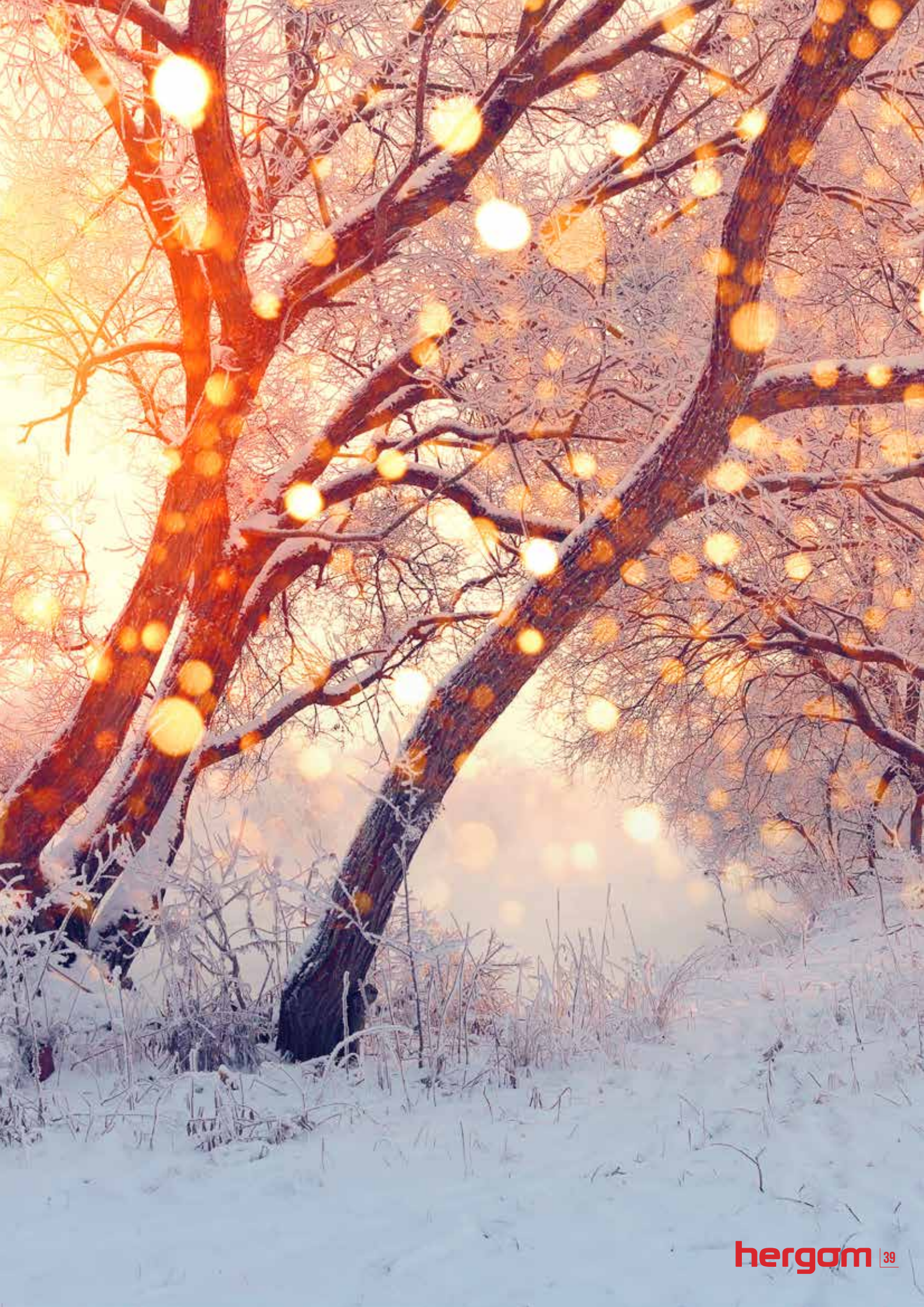

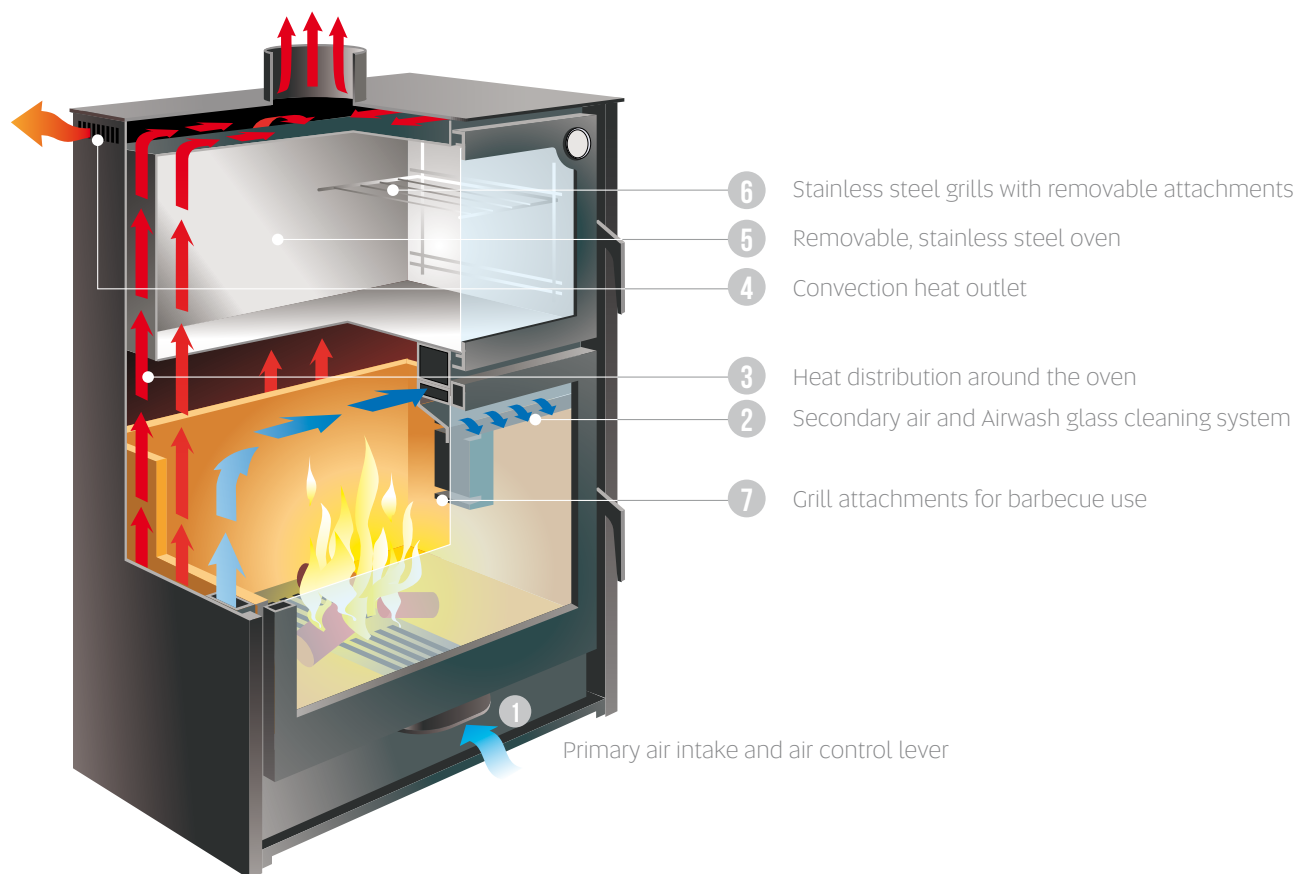

Aranda wood-fired oven is fully built in cast iron, with a stainless steel oven and oven light.

ARANDA

CE Certification: RRF 15 11 2754
 Norm: EN 12815 / BlmSchV
 Maximum heat output (KW): 18
 Nominal heat output: 12,5 kw
 Efficiency: 71 %
 Dimensions (An. x AL. x P.): 700 x 975 x 725



ARCE

CE Certification: EZKA/11/O37-10
Norm: EN 13240 / BlmSchV
Maximum heat output (KW): 14
Nominal heat output: 12 kw
Efficiency: 80,1 %
Dimensions (An. x AL. x P.): 705 x 1.075 x 440



ARCE R

CE Certification: EZKA/11/O37-10
Norm: EN 13240 / BlmSchV
Maximum heat output (KW): 14
Nominal heat output: 12 kw
Efficiency: 80,1 %
Dimensions (An. x AL. x P.): 1.030 x 1.075 x 833



GREEN HEAT

Wood is a natural, renewable and "CO₂ neutral" fuel.

When you burn wood in a high efficiency Hergóm fireplace, the amount of CO₂ released into the atmosphere is higher than if it had followed its natural process of decomposition in the forest. The ratio of CO₂ produced in the combustion is so low that the trees themselves absorb it through photosynthesis, transforming carbon back into wood. Contrary to what happens with fossil fuels, this absorption-release cycle can be repeated indefinitely, without producing an excess of CO₂. According to estimates by the Environmental Protection Agency of the United States, an increase in the amount of fuel from biomass would significantly reduce the impact of greenhouse gases on the planet.

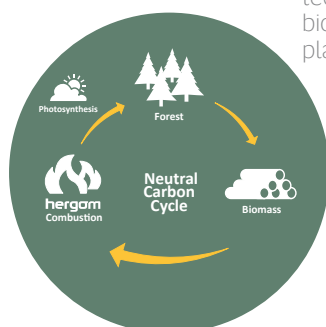

All Hergóm products are certified by the EC brand, which guarantees their performance in terms of efficiency and thermal values. Still, we work hard to overcome the strictest international controls, far exceeding the minimum requirements regarding performance, CO emissions and particles. By using wood as a fuel in a Hergóm hearth with maximum efficiency, you will be contributing to a cleaner and more sustainable world.



CHOOSING THE RIGHT WOOD

Not all firewood is the same. Choosing the right wood is very important in order to enjoy a clean, efficient burn.

Avoid fresh wood: it will give less heat and it will generate creosote in the appliance and installation, requiring more cleaning and maintenance. Also avoid soft woods (pine and other conifers): they will burn too intensely, with high temperatures that can overfire the stove, eventually damaging inner components.

The best option is hard woods –maple, oak, beech- that burn slowly and keep long lasting embers.

Before wood is ready to be burnt, it requires to be seasoned for at least one year, reaching its optimum level of humidity (under 20%) after 2 years.



TECHNICAL INFORMATION



TECHNICAL INFORMATION

STOVES

GLANCE

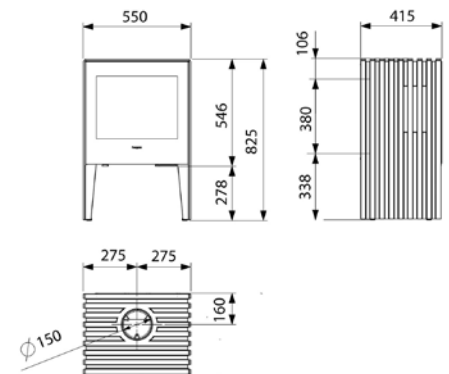

CE Certification.....	RRF 40 14 3599
Norm.....	N 13240 / Art. 15a BV-G / BlmSchV
Heat output min-max (kW).....	2-9
Nominal heat output (kW).....	7
Efficiency (%).....	80%
Maximum log length (mm).....	400
Weight (kg).....	160
Flue exit.....	Top & Rear
Flue exit diameter (mm).....	150
Clearance to combustibles (Sides/Rear) (mm).....	500/150
Fuel.....	Wood
Firebox material.....	Vermiculite
External air inlet.....	Yes
Ash pan.....	Yes
Paint finish.....	Black
Enamel finish.....	-



GLANCE WALL MOUNT

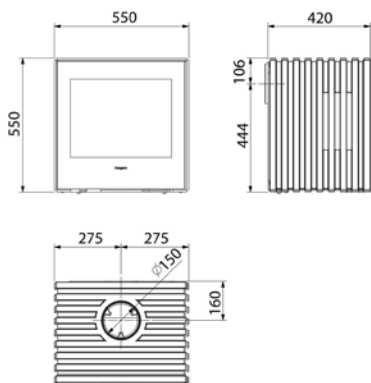

CE Certification	RRF 40 14 3599
Norm	N 13240 / Art. 15a BV-G / BlmSchV
Heat output min-max (kW)	2-9
Nominal heat output (kW)	7
Efficiency (%)	80%
Maximum log length (mm)	400
Weight (kg)	150
Flue exit	Top & Rear
Flue exit diameter (mm)	150
Clearance to combustibles (Sides/Rear) (mm)	500/*

Fuel	Wood
Firebox material	Vermiculite
External air inlet	Yes
Ash pan	Yes
Paint finish	Black
Enamel finish	-



GLANCE L

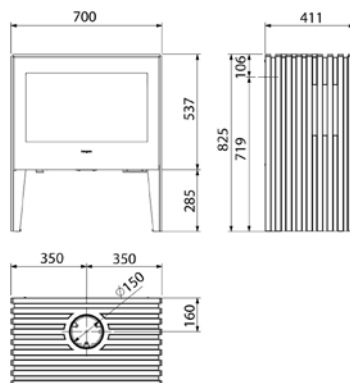

CE Certification	RF 40 16 4301
Norm	N 13240
Heat output min-max (kW)	3-13
Nominal heat output (kW)	9,5
Efficiency (%)	77%
Maximum log length (mm)	500
Weight (kg)	198
Flue exit	Top & Rear
Flue exit diameter (mm)	150
Clearance to combustibles (Sides/rRear) (mm)	500 / 150

Fuel	Wood
Firebox material	Vermiculite
External air inlet	Yes
Ash pan	Yes
Paint finish	Black
Enamel finish	-



E-40

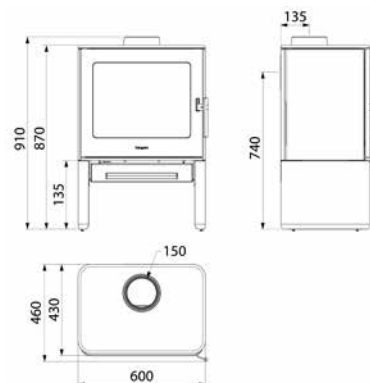

CE Certification	RF 40 16 4357
Norm	N 13240 / BlmSchV
Heat output min-max (kW)	3-12
Nominal heat output (kW)	9
Efficiency (%)	79%
Maximum log length (mm)	500
Weight (kg)	150
Flue exit	Top & Rear
Flue exit diameter (mm)	150
Clearance to combustibles (Sides/Rear) (mm)	450/450

Fuel	Wood
Firebox material	Cast iron
External air inlet	Yes
Ash pan	Yes
Paint finish	Black
Enamel finish	-



*To be installed on non-combustible walls only.

E-30 L

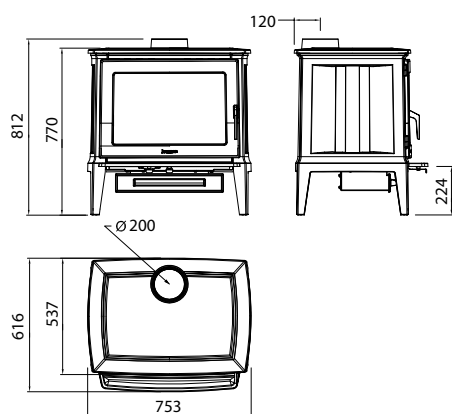

CE Certification	RRF 40 12 3104
Norm	N 13240 / BlmSchV
Heat output min-max (kW)	3-14
Nominal heat output (kW)	11
Efficiency (%)	79%
Maximum log length (mm)	600
Weight (kg)	190
Flue exit	Top
Flue exit diameter (mm)	200
Clearance to combustibles (Sides/Rear) (mm)	450/450

Fuel	Wood
Firebox material	Cast iron
External air inlet	Yes
Ash pan	Yes
Paint finish	Black
Enamel finish	-



E-30 M

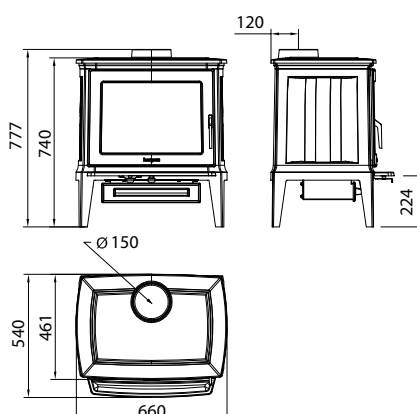

CE Certification	RF 40 16 4357
Norm	N 13240 / BlmSchV
Heat output min-max (kW)	3-12
Nominal heat output (kW)	9
Efficiency (%)	79%
Maximum log length (mm)	500
Weight (kg)	150
Flue exit	Top & Rear
Flue exit diameter (mm)	150
Clearance to combustibles (Sides/Rear) (mm)	450/450

Fuel	Wood
Firebox material	Cast iron
External air inlet	Yes
Ash pan	Yes
Paint finish	Black
Enamel finish	-



E-30 S

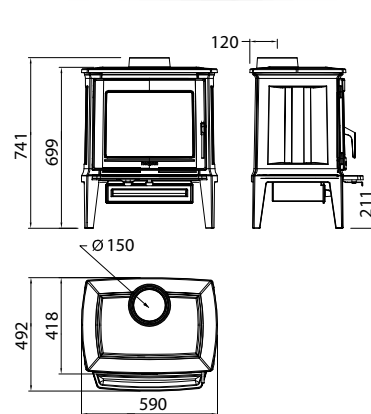

CE Certification	RF 40 12 3102
Norm	N 13240 / BlmSchV
Heat output min-max (kW)	2-9
Nominal heat output (kW)	7
Efficiency (%)	79%
Maximum log length (mm)	400
Weight (kg)	110
Flue exit	Top
Flue exit diameter (mm)	150
Clearance to combustibles (Sides/Rear) (mm)	450/450

Fuel	Wood
Firebox material	Cast iron
External air inlet	Yes
Ash pan	Yes
Paint finish	Black
Enamel finish	-

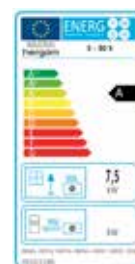

E-30 XS

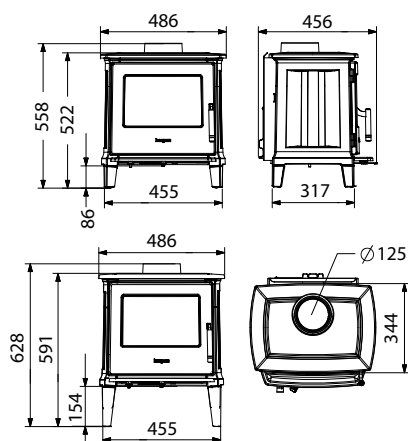

CE Certification.....	ZKA 14-0176-1
Norm.....	N 13240
Heat output min-max (kW).....	1,5-7
Nominal heat output (kW).....	5
Efficiency (%).....	77%* / 80%*
Maximum log length (mm).....	350
Weight (kg).....	100
Flue exit.....	Top & Rear
Flue exit diameter (mm).....	125
Clearance to combustibles (Sides/Rear) (mm).....	450/250

Fuel.....	Wood / Coal**
Firebox material.....	Cast iron
External air inlet.....	Yes
Ash pan.....	Yes
Paint finish.....	Black
Enamel finish.....	-

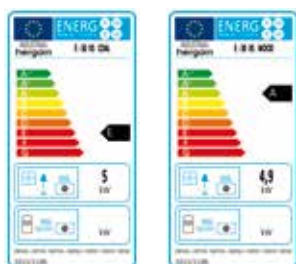

E-20 NS

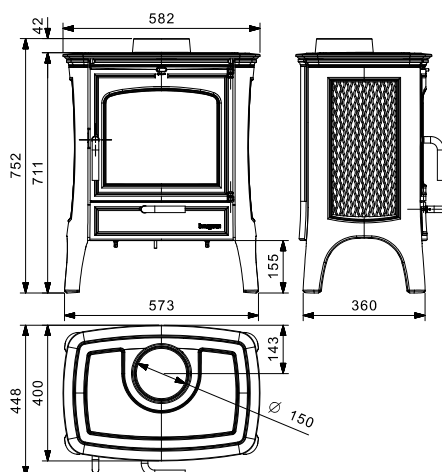

CE Certification.....	LEE/O30/O6-1
Norm.....	N 13240
Heat output min-max (kW).....	3-12
Nominal heat output (kW).....	9
Efficiency (%).....	75%
Maximum log length (mm).....	420
Weight (kg).....	105
Flue exit.....	Top
Flue exit diameter (mm).....	150
Clearance to combustibles (Sides/Rear) (mm).....	600/600

Fuel.....	Wood
Firebox material.....	Refractory
External air inlet.....	No
Ash pan.....	Yes
Paint finish.....	Black
Enamel finish.....	-



MANCHESTER

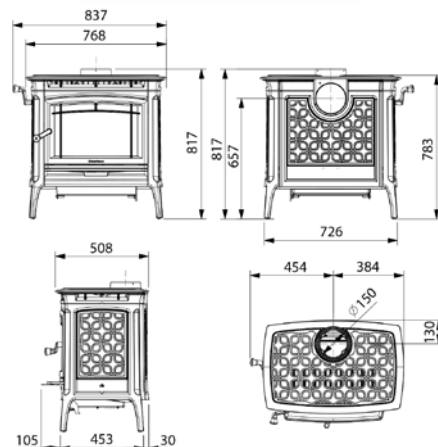

CE Certification.....	K9192012T1
Norm.....	N 13240 / BlmSchV / US EPA
Heat output min-max (kW).....	4,5-17
Nominal heat output (kW).....	13
Efficiency (%).....	75%
Maximum log length (mm).....	600
Weight (kg).....	236
Flue exit.....	Top & Rear
Flue exit diameter (mm).....	150
Clearance to combustibles (Sides/Rear) (mm).....	500/300

Fuel.....	Wood
Firebox material.....	Soapstone
External air inlet.....	Yes
Ash pan.....	Yes
Paint finish.....	Black
Enamel finish.....	Ivory



* Wood/Coal

** Coal kit available as an option.

SHELBURNE

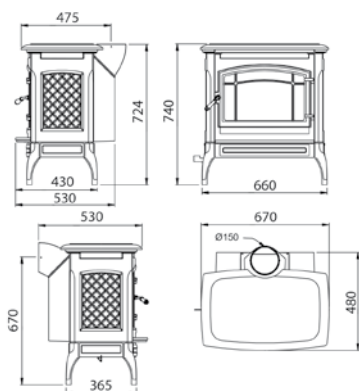

CE Certification	EZ/O9/2791-1
Norm	N 13240 / BlmSchV / US EPA
Heat output min-max (kW)	3-13
Nominal heat output (kW)	10,5
Efficiency (%)	78,5%
Maximum log length (mm)	480
Weight (kg)	180
Flue exit	Top & Rear
Flue exit diameter (mm)	150
Clearance to combustibles (Sides/Rear) (mm)	460/610

Fuel	Wood
Firebox material	Refractory
External air inlet	Yes
Ash pan	Yes
Paint finish	Black
Enamel finish	Brown



CRAFTSBURY

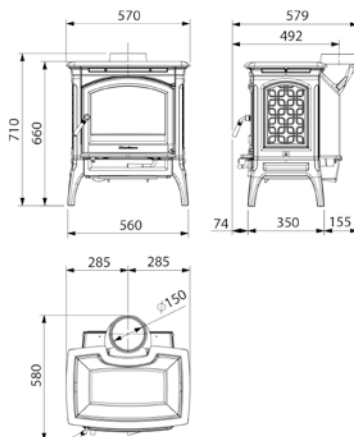

CE Certification	2006PMC/107
Norm	N 13240 / US EPA
Heat output min-max (kW)	3-13
Nominal heat output (kW)	11,5
Efficiency (%)	84%
Maximum log length (mm)	450
Weight (kg)	130
Flue exit	Top & Rear
Flue exit diameter (mm)	150
Clearance to combustibles (Sides/Rear) (mm)	460/610

Fuel	Wood
Firebox material	Soapstone
External air inlet	Yes
Ash pan	Yes
Paint finish	Black
Enamel finish	Brown



HERITAGE

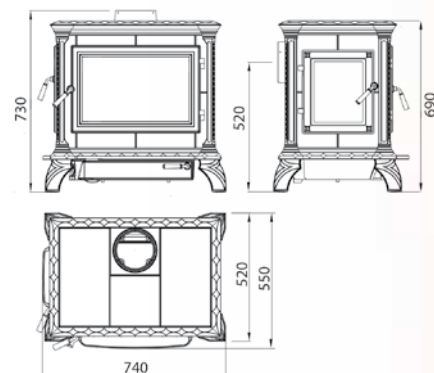

CE Certification	2006PMC/051
Norm	N 13240 / US EPA
Heat output min-max (kW)	5-20
Nominal heat output (kW)	16,3
Efficiency (%)	79%
Maximum log length (mm)	540
Weight (kg)	216
Flue exit	Top & Rear
Flue exit diameter (mm)	150
Clearance to combustibles (Sides/Rear) (mm)	430/400

Fuel	Wood
Firebox material	Soapstone
External air inlet	Yes
Ash pan	Yes
Paint finish	Black
Enamel finish	Seafoam





TECHNICAL INFORMATION

FIREPLACE INSERTS

SERE-100 2C

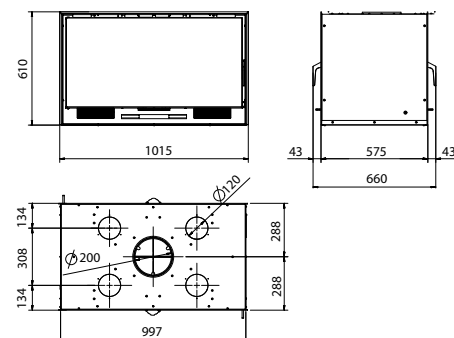

CE Certification	EZKA/14/O158-1
Norm	EN 13229 / BlmSchV
Heat output min-max (kW)	4,5-17
Nominal heat output (kW)	12
Efficiency (%)	78%
Maximum log length (mm)	700
Weight (kg)	138
Flue exit diameter (mm)	200
Air outlets diameter (mm)	120

Fuel	Wood
Firebox material	Vermiculite
Convection jacket	Yes
Air outlets	4
Convection blower(s)	Optional
External air inlet	No
Ash pan	Yes
Paint finish	Black



SERE-100

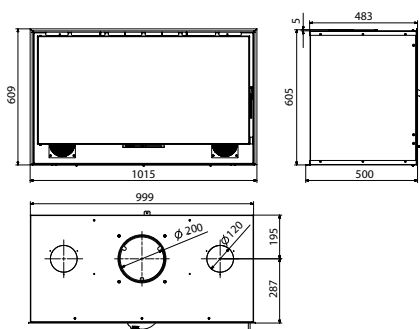

CE Certification.....	EZKA/12/O75-3
Norm.....	EN 13229 / BlmSchV
Heat output min-max (kW).....	4,5-17
Nominal heat output (kW).....	12
Efficiency (%).....	75%
Maximum log length (mm).....	700
Weight (kg).....	134
Flue exit diameter (mm).....	200
Air outlets diameter (mm).....	120

Fuel.....	Wood
Firebox material.....	Cast iron or Vermiculite
Convection jacket.....	Yes
Air outlets.....	2
Convection blower(s).....	Optional
External air inlet.....	Yes
Ash pan.....	Yes
Paint finish.....	Black



SERE-80

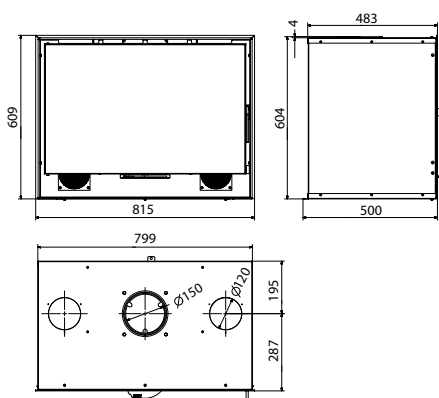

CE Certification.....	EZKA/12/O75-2
Norm.....	EN 13229
Heat output min-max (kW).....	3-13
Nominal heat output (kW).....	10
Efficiency (%).....	73%
Maximum log length (mm).....	550
Weight (kg).....	114
Flue exit diameter (mm).....	150
Air outlets diameter (mm).....	120

Fuel.....	Wood
Firebox material.....	Cast iron or Vermiculite
Convection jacket.....	Yes
Air outlets.....	2
Convection blower(s).....	Optional
External air inlet.....	Yes
Ash pan.....	Yes
Paint finish.....	Black



SERE-70

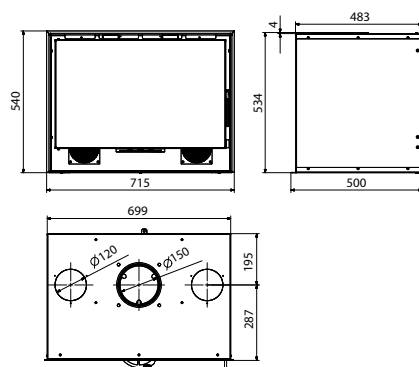

CE Certification.....	EZKA/12/O75-1
Norm.....	EN 13229
Heat output min-max (kW).....	3-11
Nominal heat output (kW).....	9
Efficiency (%).....	71%
Maximum log length (mm).....	500
Weight (kg).....	95
Flue exit diameter (mm).....	150
Air outlets diameter (mm).....	120

Fuel.....	Wood
Firebox material.....	Cast iron or Vermiculite
Convection jacket.....	Yes
Air outlets.....	2
Convection blower(s).....	Yes
External air inlet.....	Yes
Ash pan.....	Yes
Paint finish.....	Black

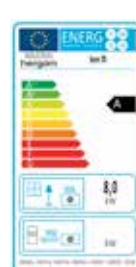

NATURE 100

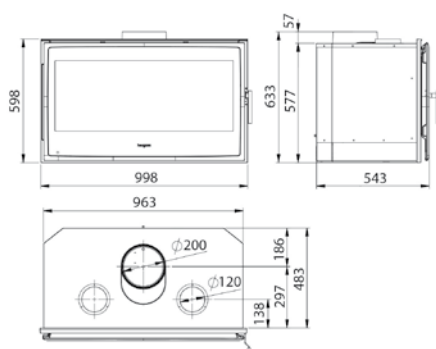

CE Certification	EZKA/12/075-6
Norm	EN 13229
Heat output min-max (kW)	4,5-17
Nominal heat output (kW)	12
Efficiency (%)	77%
Maximum log length (mm)	700
Weight (kg)	134
Flue exit diameter (mm)	200
Air outlets diameter (mm)	120

Fuel	Wood
Firebox material	Cast iron or Vermiculite
Convection jacket	Yes
Air outlets	2
Convection blower(s)	Yes
External air inlet	Yes
Ash pan	Yes
Paint finish	Black



NATURE 80

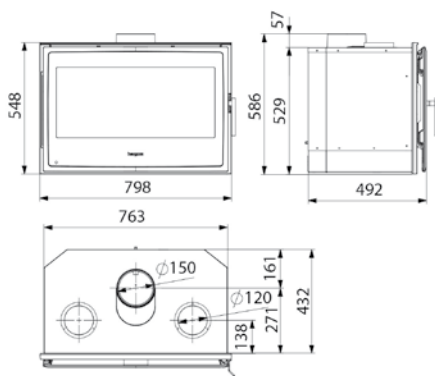

CE Certification	EZKA/12/075-5
Norm	EN 13229
Heat output min-max (kW)	3-13
Nominal heat output (kW)	10
Efficiency (%)	76%
Maximum log length (mm)	550
Weight (kg)	114
Flue exit diameter (mm)	150
Air outlets diameter (mm)	120

Fuel	Wood
Firebox material	Cast iron or Vermiculite
Convection jacket	Yes
Air outlets	2
Convection blower(s)	Yes
External air inlet	Yes
Ash pan	Yes
Paint finish	Black



NATURE 70

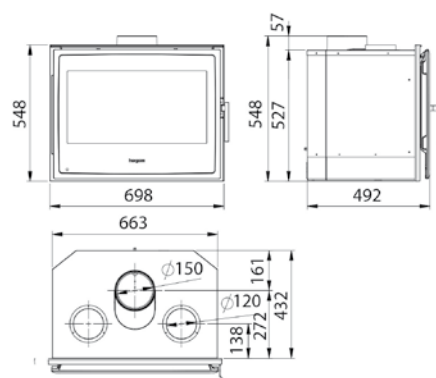

CE Certification	EZKA/12/075-4
Norm	EN 13229
Heat output min-max (kW)	3-11
Nominal heat output (kW)	8,5
Efficiency (%)	75%
Maximum log length (mm)	500
Weight (kg)	95
Flue exit diameter (mm)	150
Air outlets diameter (mm)	120

Fuel	Wood
Firebox material	Cast iron or Vermiculite
Convection jacket	Yes
Air outlets	2
Convection blower(s)	Yes
External air inlet	Yes
Ash pan	Yes
Paint finish	Black



STILKAMIN XL

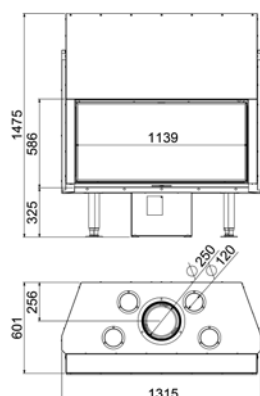

CE Certification.....	LEE/O30/10
Norm.....	EN 13229 / BlmSchV
Heat output min-max (kW).....	7-25
Nominal heat output (kW).....	23
Efficiency (%).....	75%
Maximum log length (mm).....	750
Weight (kg).....	308
Flue exit diameter (mm).....	250
Air outlets diameter (mm).....	120

Fuel.....	Wood
Firebox material.....	Refractory
Convection jacket.....	Yes
Air outlets.....	4
Convection blower(s).....	Optional
External air inlet.....	No
Ash pan.....	Yes
Paint finish.....	Black



STILKAMIN L

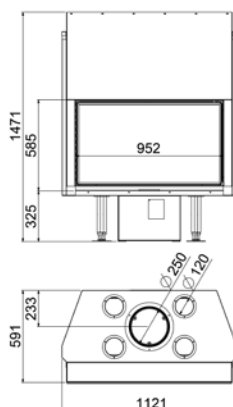

CE Certification.....	LEE/O30/10
Norm.....	EN 13229 / BlmSchV
Heat output min-max (kW).....	7-23
Nominal heat output (kW).....	20
Efficiency (%).....	76%
Maximum log length (mm).....	550
Weight (kg).....	268
Flue exit diameter (mm).....	250
Air outlets diameter (mm).....	120

Fuel.....	Wood
Firebox material.....	Refractory
Convection jacket.....	Yes
Air outlets.....	4
Convection blower(s).....	Optional
External air inlet.....	No
Ash pan.....	Yes
Paint finish.....	Black

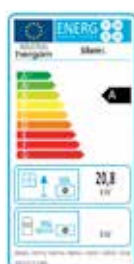

STILKAMIN S 460

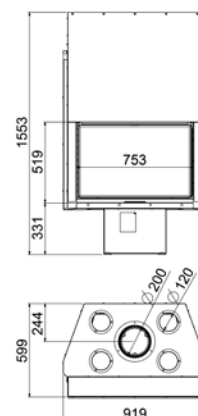

CE Certification.....	LEE/O30/09
Norm.....	EN 13229 / BlmSchV
Heat output min-max (kW).....	5-20
Nominal heat output (kW).....	17
Efficiency (%).....	79%
Maximum log length (mm).....	400
Weight (kg).....	250
Flue exit diameter (mm).....	200
Air outlets diameter (mm).....	120

Fuel.....	Wood
Firebox material.....	Refractory
Convection jacket.....	Yes
Air outlets.....	4
Convection blower(s).....	Optional
External air inlet.....	No
Ash pan.....	Yes
Paint finish.....	Black



STILKAMIN S 600

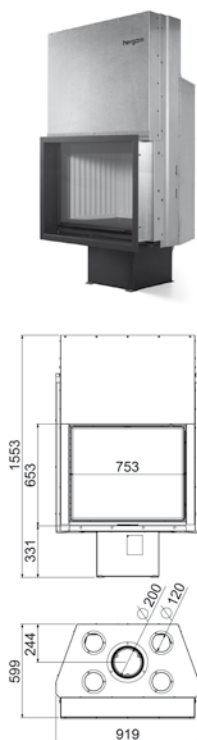

CE Certification	LEE/O30/O9
Norm	EN 13229 / BlmSchV
Heat output min-max (kW)	5-20
Nominal heat output (kW)	17
Efficiency (%)	77%
Maximum log length (mm)	400
Weight (kg)	258
Flue exit diameter (mm)	200
Air outlets diameter (mm)	120

Fuel	Wood
Firebox material	Refractory
Convection jacket	Yes
Air outlets	4
Convection blower(s)	Optional
External air inlet	No
Ash pan	Yes
Paint finish	Black



ECK

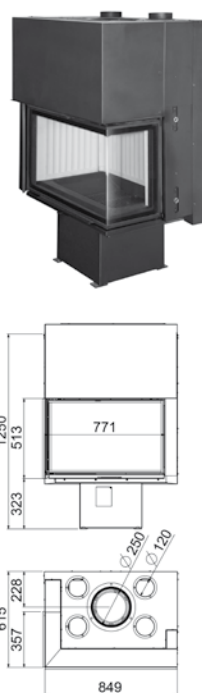

CE Certification	LEE/O43/O9
Norm	EN 13229 / BlmSchV
Heat output min-max (kW)	4,5-17
Nominal heat output (kW)	13
Efficiency (%)	75%
Maximum log length (mm)	400
Weight (kg)	256
Flue exit diameter (mm)	250
Air outlets diameter (mm)	120

Fuel	Wood
Firebox material	Refractory
Convection jacket	Yes
Air outlets	4
Convection blower(s)	Optional
External air inlet	No
Ash pan	Yes
Paint finish	Black



HGB 70

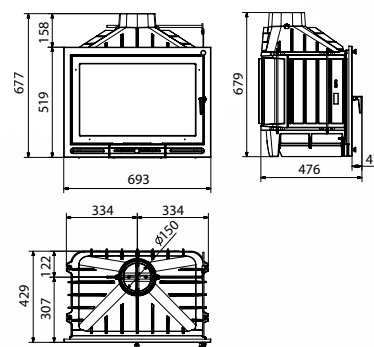

CE Certification	RRF 29 13 3377
Norm	EN 13229 / BlmSchV
Heat output min-max (kW)	3-13
Nominal heat output (kW)	11
Efficiency (%)	80%
Maximum log length (mm)	500
Weight (kg)	117
Flue exit diameter (mm)	150
Air outlets diameter (mm)	-

Fuel	Wood
Firebox material	Cast iron
Convection jacket	No
Air outlets	No
Convection blower(s)	No
External air inlet	Yes
Ash pan	Yes
Paint finish	Black





TECHNICAL INFORMATION

WOOD FIRED OVENS

ARANDA

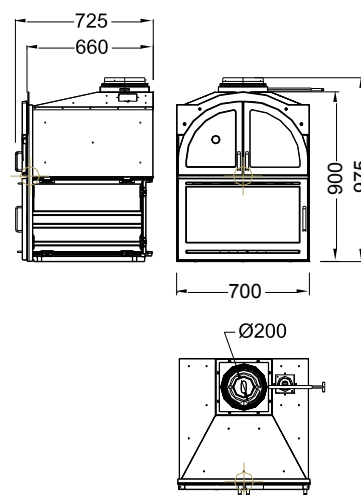

CE Certification.....	RRF 15 11 2754
Norm	EN 12815 / BlmSchV
Heat output min-max (kW).....	4,5-18
Nominal heat output (kW).....	12,5
Efficiency (%)	71%
Oven dimensions (W x H x D) (mm).....	570 x 300 x 620
Maximum log length (mm)	500
Weight (kg)	242
Flue exit	Top
Flue exit diameter (mm)	200
Clearance to combustibles (Sides/Rear) (mm)	*
Fuel	Wood
Firebox material	Cast iron
Oven material	Stainless steel
Removable grills	Yes
Draft valve	Yes
External air inlet	No
Ash pan	Yes
Paint finish	Black



ARCE

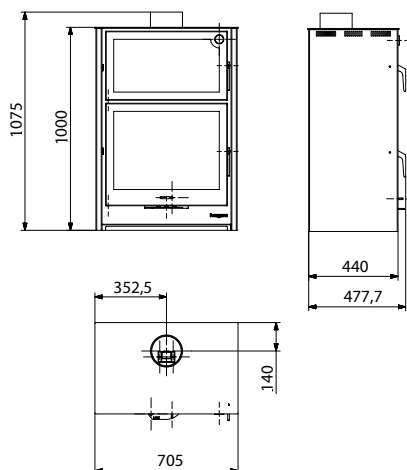

CE Certification.....EZKA/11/O37-10
 Norm.....EN 13240 / BlmSchV
 Heat output min-max (kW).....3,5-14
 Nominal heat output (kW).....12
 Efficiency (%).....80%
 Oven dimensions (W x H x D) (mm)....520 x 275 x 363
 Maximum log length (mm).....500
 Weight (kg).....150
 Flue exit.....Top
 Flue exit diameter (mm).....150
 Clearance to combustibles
 (Sides/Rear) (mm).....600/600

Fuel.....Wood
 Firebox material.....Vermiculite
 Oven material.....Stainless steel
 Removable grills.....Yes
 Draft valve.....No
 External air inlet.....No
 Ash pan.....Yes
 Paint finish.....Black



ARCE R

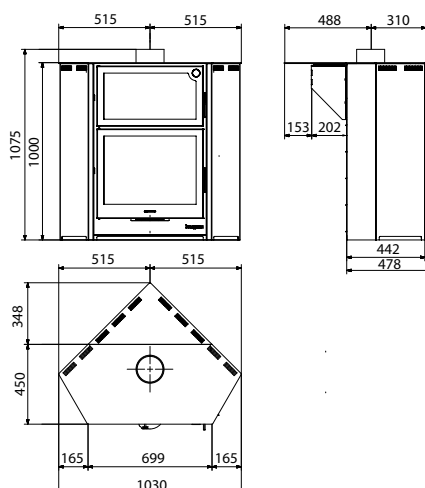

CE Certification.....EZKA/11/O37-10
 Norm.....EN 13240 / BlmSchV
 Heat output min-max (kW).....3,5-14
 Nominal heat output (kW).....12
 Efficiency (%).....80%
 Oven dimensions (W x H x D) (mm)....520 x 275 x 363
 Maximum log length (mm).....500
 Weight (kg).....158
 Flue exit.....Top
 Flue exit diameter (mm).....150
 Clearance to combustibles (Sides/Rear) (mm).....*

Fuel.....Wood
 Firebox material.....Vermiculite
 Oven material.....Stainless steel
 Removable grills.....Yes
 Draft valve.....No
 External air inlet.....No
 Ash pan.....Yes
 Paint finish.....Black



*To be installed on non-combustible walls only.



Industrias Hergóm, S.L.

39110 SOTO DE LA MARINA (Cantabria)
Apartado de Correos 208 de Santander
39080 Santander (España)
Tel.: +34 942 58 70 00 / Fax: +34 942 58 70 01
comercial@hergom.com

hergom.com

UK sole importer:

EUROSTOVE LIMITED

UNIT H1 Mendip Industrial Estate
Mendip Road
Rooksbridge
Somerset
BS26 2UG
Tel. 01934 750 500 / Fax. 01173 156 207
info@eurostove.co.uk

eurostove.co.uk