

Subfloors

AltroPol™

AltroPol™ is used for the polymer modification of cementitious systems and supports our range of floor finishes. Designed to enhance the physical properties of cement based floor screeds and repair compounds, it improves flexural strength, impact and abrasion resistance.

Typical applications include thin section floor screeds, smoothing screeds to even out the surface of damaged or tamped finish concrete, levelling screeds to receive other finishes, screeds of varying thickness to install falls for drainage purposes or heavy duty wearing screeds with high impact resistance.

AltroPol is supplied as a white mobile liquid. It is readily diluted with water and then used to gauge the screed mixture of cement and aggregates to provide the desired performance and characteristics.



Screed thickness:

The minimum recommended screed design thickness using AltroPol in the mix is as follows:

- 6mm epoxy, slurry bonded
- 50mm unbonded
- 75mm floating

How to use it:

- thin section floor screeds
- to carry out the repairs to the surface of damaged or tamped finish concrete
- base to receive resilient floor coverings and resin finishes
- screeds of varying thickness to install falls for drainage purposes
- patching of worn or damaged concrete

Benefits:

- faster curing to allow early overlayment
- greatly reduced drying time
- easy to use single component, gauged as required
- thinner screeds with excellent durability and impact resistance
- superb adhesion, maintained even in wet conditions
- integral antifoam so no additions on site are necessary

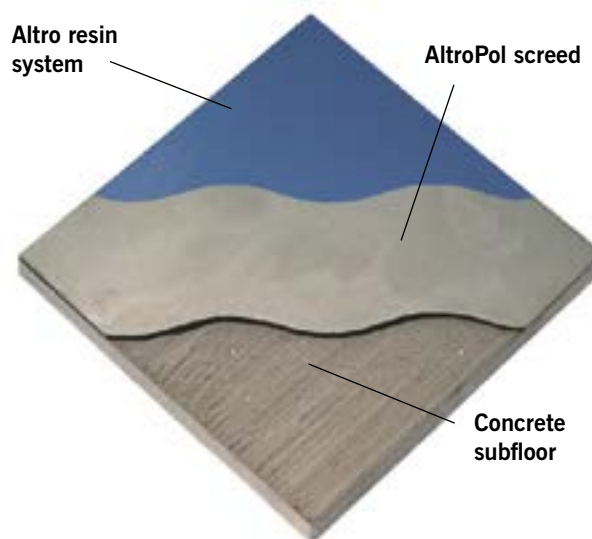

Altro XpressLay safety flooring may be laid over new concrete floors with up to 97% relative humidity or in areas subject to damp. See pages 86-91 for more details.



AltroProof Solo™

How's this for a real problem solver? AltroProof Solo Universal and AltroProof Solo Fast Track are damp-proof membranes that offer protection in up to 97% relative humidity (99.9% theoretical), suppressing residual construction moisture. This allows for early installation of floor coverings / coatings in fast-track building operations, and makes them ideal for fast-track installation over green concrete and for refurbishment projects on existing substrates.

Quick and easy to apply, AltroProof Solo Universal and AltroProof Solo Fast Track have low viscosity and provide excellent adhesion. AltroProof Solo Fast Track has the added advantage of an extra-short curing cycle, saving time by enabling levelling / smoothing compounds to be laid on the same day.

Typically, Altro safety flooring, Altro smooth flooring and Altro rubber flooring are used in conjunction with a water resistant levelling screed which can usually be applied on the same day. Suitable water resistant smoothing compounds may be applied beneath AltroProof Solo and AltroProof Solo Fast Track.

Altro safety flooring, Altro resins, Altro smooth flooring and Altro rubber flooring can be installed directly over AltroProof Solo, with the AltroProof Solo or AltroProof Solo Fast Track warranty matching the product warranty when installed as part of the Altro system.

Altro acoustic underlay 1101

When noise is a problem, Altro Acoustic Underlay 1101 will tone it down. Suitable for Altro safety, rubber and smooth flooring, we give you a wide range of product and colour options to create a quiet environment – even if you choose the loudest colours.

When tested in accordance with BS EN ISO 140-8-1997, the combined product meets the requirements of:

- approved Document E, Resistance To The Passage of Sound, July 2003, and
- BB93 Acoustic Design of Schools (min.requirement 17dB)

Typical areas where Altro Everlay may be used

- temporary walkways or areas where substrate may need to be used later
- screed or slabs where construction moisture has not dried out
- areas where subfloor has been exposed to water spillage
- old subfloors which may not contain an adequate damp-proof membrane
- on metal access floor systems (subject to flushness of joints)
- over old, soundly fixed vinyl asbestos tiles or vinyl sheet
- to save time and cost instead of applying a surface damp-proof membrane
- on external areas where the subfloor is asphalt or damp concrete



Altro Everlay™ underlayment

Provides damp-resistant, stabilised base and tolerates construction moisture up to 97% RH.

When your subfloor is not up to scratch, Altro Everlay can sort it. It is designed to overcome problems encountered in laying sheet flooring over new or old subfloors, cutting time and cost.

Whether you have old tiles, damp subfloors or contamination from oil or paint, Altro Everlay can help you install the new floor you need. It can be laid over a variety of surfaces including sheet metal and access floors.

If noise is an issue, Altro Everlay B includes a sound absorbent, insulating layer to create a comfortable and quiet environment.

Altro Everlay:

- provides a continuous base which is stabilised and resistant to damp
- cuts down laying time as it can reduce normal subfloor drying times
- allows for a new, temporary floor to be laid over an existing floor, without adhesive damage on uplifting
- affords tolerance to residual construction moisture, accommodating hygrometer readings of up to 97% RH or, on subfloors with no damp-proof membrane, of up to 92% RH

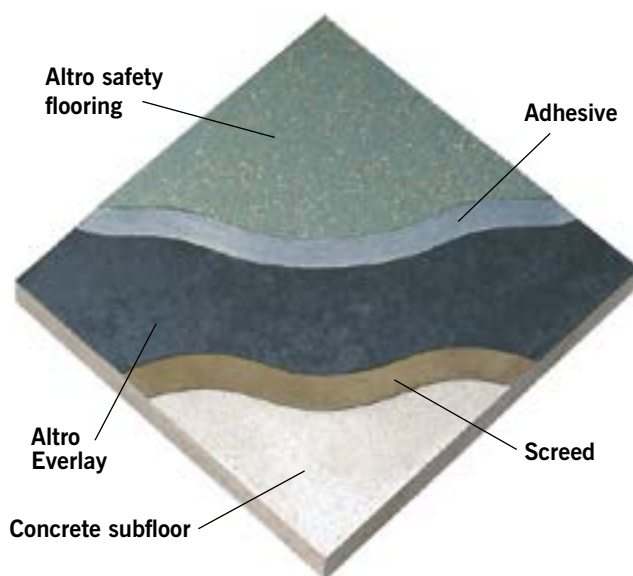



Altro Everlay A

Made of specially coated fibreglass, it is an underlay designed to enable the loose laying of Altro safety flooring, Altro rubber sheet materials and Altro smooth flooring. Available in 1.2mm thick sheets of 2m width, average length is 50m. The weight of the roll is 100kg.

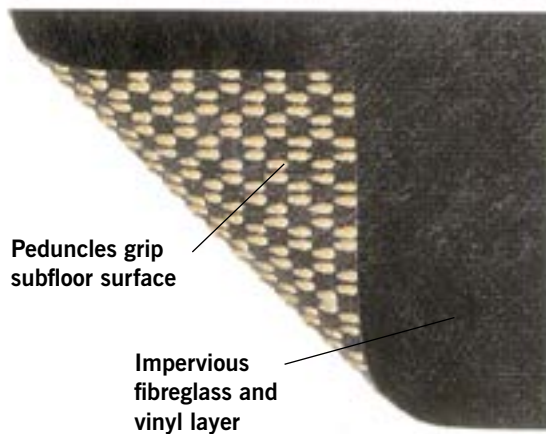

Altro Everlay B

When you need a tougher underlay with the added benefit of increased sound absorption and insulation. Altro Everlay B is a specially coated fibreglass sheet with a layer of resilient material. Available in 4mm thick sheets of 2m width, average length is 20m. The weight of the roll is 88kg.

Altro Everlay B has the added benefits of:

- giving underfoot softness and comfort to PVC sheet materials
- improving insulation
- improving sound absorption (20dB in accordance with ISO 140-8, when used in conjunction with Altro sheet material)

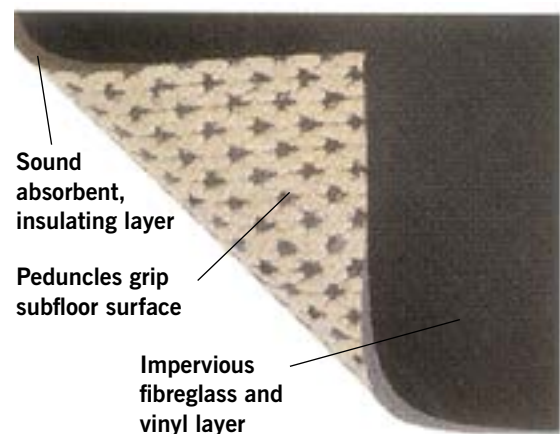

Flooring accessories

Altro adhesives

AltroFix™ 15	For a good all-rounder, AltroFix 15 is suitable for all our flooring ranges, in areas not subject to spillage. A single part high tack acrylic copolymer, it can be used with Altro safety flooring and Altro smooth flooring, and with Altro Nuvola Stratus 2.7mm tiles and Altro Nuvola Cirrus in light traffic areas.
Coverage Average	Approximately 35-40m ² per 12 kg unit, depending on the application and subfloor porosity.
AltroFix™ 19 Plus	AltroFix 19 Plus can handle the spills in life. It provides a solvent and water-free, two-part polyurethane adhesive that is not affected, once it has cured, by spillages of water and most other liquids. AltroFix 19 Plus is supplied in 1.5kg, 3kg, and 6kg units in the correct quantities for mixing. Both A and B parts are held within the container. AltroFix 19 Plus can be used with all Altro safety flooring (in areas subject to spillages). AltroFix 19 Plus is also recommended for use with Altro materials which can be bonded to Altro Everlay underlayment.
	Not suitable for use on vertical surfaces.
Colour	Beige
Coverage Average	4 to 6 m ² /kg depending on porosity of the subfloor and trowel size.
AltroFix™ 41	For our Altro Nuvola rubber flooring range, a specially formulated two part resin adhesive in areas subject to spillages.
Coverage Average	Coverage 12-14m ² per 5 kg unit.
AltroFix™ 25NF	When you're in the fast lane, AltroFix™ 25NF will keep you on track. A contact adhesive, it enables the floor to be used immediately after laying. Ensure use in well-ventilated areas. Should always be used for coving and vertical surfaces.
Colour	Orange
Coverage Average	15m ² bonded area per 5 litre unit.
AltroFix™ 365	When you need a bond that lasts, AltroFix 365 won't let you down. A high tack acrylic adhesive that can be applied to dry porous and impervious surfaces. For use with Altro safety flooring and Altro smooth flooring, in areas not subjected to spillage.
Coverage Average	Coverage 25-35m ² per 5 litre unit depending upon subfloor and method of application.

Safety flooring / recommended cleaning methods

Manual	Mechanical
<ol style="list-style-type: none"> 1. Sweep up loose dirt and dust 2. Apply AltroClean 44™ or equivalent alkaline cleaner and leave for several minutes 3. Scrub with deck scrubber or edge cleaner 4. Mop up residue. Always use a twin compartment bucket to avoid redistribution of dirt 5. Mop rinse with clean, warm water and allow to dry 	<ol style="list-style-type: none"> 1. Vacuum up dust and dirt, remove large debris 2. Apply AltroClean 44™ or equivalent alkaline cleaner and leave for several minutes 3. Machine scrub using medium synthetic pad 4. Wet vacuum residue 5. Rinse with warm clean water and vacuum dry

Visit www.altro.co.uk/tech-docs/maintenance for full cleaning and maintenance guidance, including new Altro Easyclean Maxis PUR recommendations.

Cleaners and dressings for Altro floors

AltroClean 44™	For general maintenance, an alkaline cleaner recommended for use with Altro safety flooring and Altro resin systems.
Availability	AltroClean 44 is sold in cases which contain either: 10 x 1l bottles or 4 x 5l bottles.
AltroClean 44+™	When you face a tough cleaning job, a concentrated alkaline cleaner recommended for use with Altro safety flooring in heavily soiled circumstances.
Availability	AltroClean 44+ is sold in cases which contain either: 10 x 1l bottles or 4 x 5l bottles.
AltroClean 48W™	For use with Altro Nuvola rubber and Altro smooth flooring. AltroClean 48W can also be used with Altro safety flooring where it is not required to provide maximum slip resistance. See note below.
Availability	AltroClean 48W is sold in cases which contain: 4 x 5l bottles.
AltroGloss 211™	A specialist cleaner for Altro Nuvola rubber flooring.
Availability	AltroGloss 211 is sold in cases which contain: 4 x 5l bottles.
AltroMastic clean-up wipes	Easy to use clean-up wipes for the removal of excess mastic before it sets.
	Note: Failure to maintain Altro safety flooring in accordance with the recommended procedure can affect the performance and slip resistance of the product. Maintenance booklets are available from Altro or your local distributor.

Altro specifications

SG 1041-02 ALTRO SAFETY VINYL

150 A PLASTICS FLOORING:

- Location:
- Base:
- Preparation:
- Fabricated underlay:
- As clause
- Flooring roll: **Homogeneous/Heterogeneous PVC to BS EN 649/BS EN 13845.**
Manufacturer and reference: Altro
safety floor by Altro, telephone 01462 707600
fax 01462 707610.
BS EN 685 class 43.
Width: **2000** mm
Thickness:mm
Colour:
- Adhesive (and primer if recommended by manufacturer):
- Seam welding: **Hot-welding with matching Altro Welding Rod, as clause 680A.**
- Accessories:
- Finishing:
- Special requirements:

- 462 A SMOOTHING UNDERLAYMENT COMPOUND
- 531 A SURFACE DAMP-PROOF MEMBRANE
- 541 A SHEET EVERLAY
- 641 A ADHESIVE FIXING – ALTRO SHEET FLOORING
- 680 A SEAM WELDING
- 731 A SEALANT
- 770 A SET-IN COVED SKIRTINGS
- 770 B SIT-ON COVED SKIRTINGS
- 771 A SELF-COVED SKIRTINGS
- 773 A JUNCTIONS BETWEEN
SELF-COVED SKIRTINGS AND
DOOR FRAMES/ARCHITRAVE
- 780 A TRAFFIC
- 821 A FINISHING PLASTICS FLOORING
- 821 B FINISHING PLASTICS FLOORING

For NBS details visit www.altro.co.uk



Altro Limited a company certified by SGS to
ISO 9001 and ISO 14001

Altro PVC stair nosings and accessories

For a perfectly colour coordinated installation, Altro PVC stair nosings and accessories can match your floors. They are constructed in impact resistant rigid and flexible PVC, to complement the Altro rubber flooring ranges. It is also compatible with Altro safety and smooth flooring.

As well as nosings and stair trim sections, accessories include matching riser and stringer sections, coved skirtings, stair and landing trims.

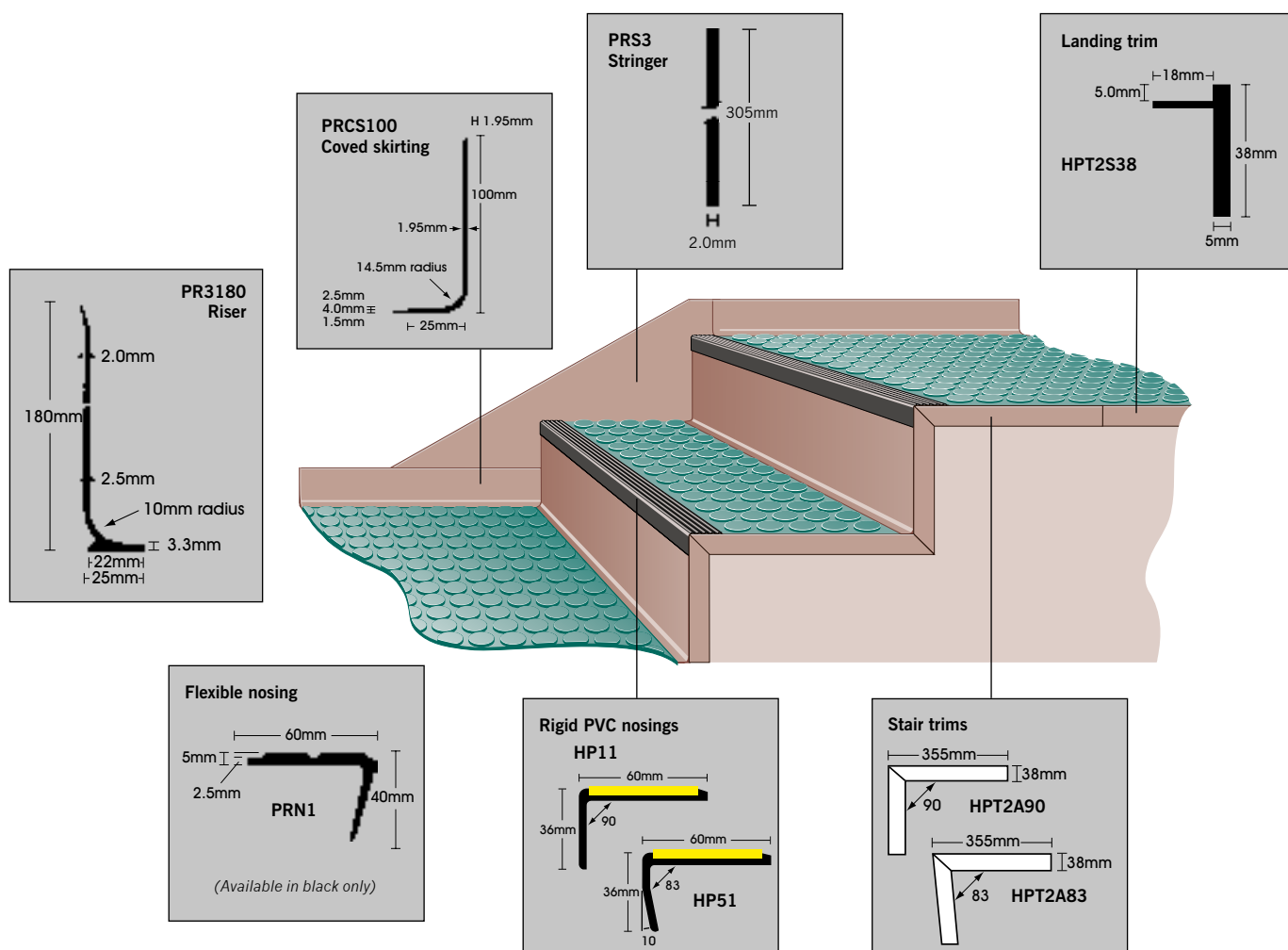

Coved skirtings

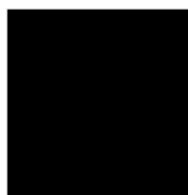

Black
208

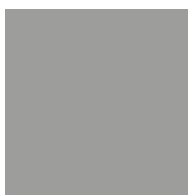

Dove
001

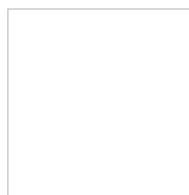

White
WHT

Nosings



Black
208



Dove
001

Inserts only available in yellow.

This guide will assist specifiers and installers with the selection of appropriate Altro recommended adhesives. Technical data sheets are available for each adhesive along with Material

Safety Data Sheets (MSDS). If in any doubt, please consult Altro Technical Services Department.

Adhesives guide

	Wood	Sand / cement screed	Latex screed	Altro acoustic 1101	Altro Everlay	Altroproof universal and fast track	Power floating	Asphalt	Metal	Terrazzo	Covings	Porous substrate	Non-porous substrate
Altro safety (spills)	A19 Plus	A19 Plus	A19 Plus	A19 Plus	A19 Plus	A19 Plus	A19 Plus	A19 Plus	A19 Plus	A19 Plus	A25NF		
Altro safety (no spills)	A365 or A15	A365 or A15	A365 or A15	A365 or A15	A19 Plus	A365	A365	A365	A365	A365	A25NF		
Altro Walkway 20 SD/ Static Dissipative	Tremco 106	Tremco 106 or Balls F57	Tremco 106 or Balls F57	Contact Altro	Mapei G19C	Mapei G19C	Mapei G19C	Mapei G19C	Mapei G19C	Mapei G19C	A25NF		
Altro smooth	A365 or A15	A365 or A15	A365 or A15	A365 or A15	-	A365	A365	A365	A365	A365	A25NF		
Altro Nuvola Stratus and Altro Nuvola Cirrus (Heavy traffic or spills)	A41	A41	A41	A41	A19 Plus (sheet only)	A41	A41	A41	A41	A41	A25NF		
Altro Nuvola Stratus and Altro Nuvola Cirrus (Light/Medium traffic, no spills)	A15	A15	A15	A15	A19 Plus (sheet only)	Latex Screed *	Latex Screed *	Latex Screed *	Latex Screed *	Latex Screed *	A25NF		
Altro Whiterock												W139 W157	W139

* for adhesive recommendations, see latex screed column

NB Adhesives stated are direct to the subfloor. With AltroFix 365 on impervious substrates, allow complete evaporation before laying.

Altro acoustic underlay 1101 - The same adhesive as quoted above should be used to bond both the underlay to the subfloor and floorcovering to the underlay.

The performance of Altro flooring and wall cladding depends on their correct installation, and the care with which jointing detail is finished. For your guidance, the drawings published here demonstrate best practice.

A representative selection of commonly encountered installations is shown.

For further guidance, typical specification clauses or isometric diagrams please contact us.

Resin flooring

Altro resin flooring transition detail

RF4/11/05

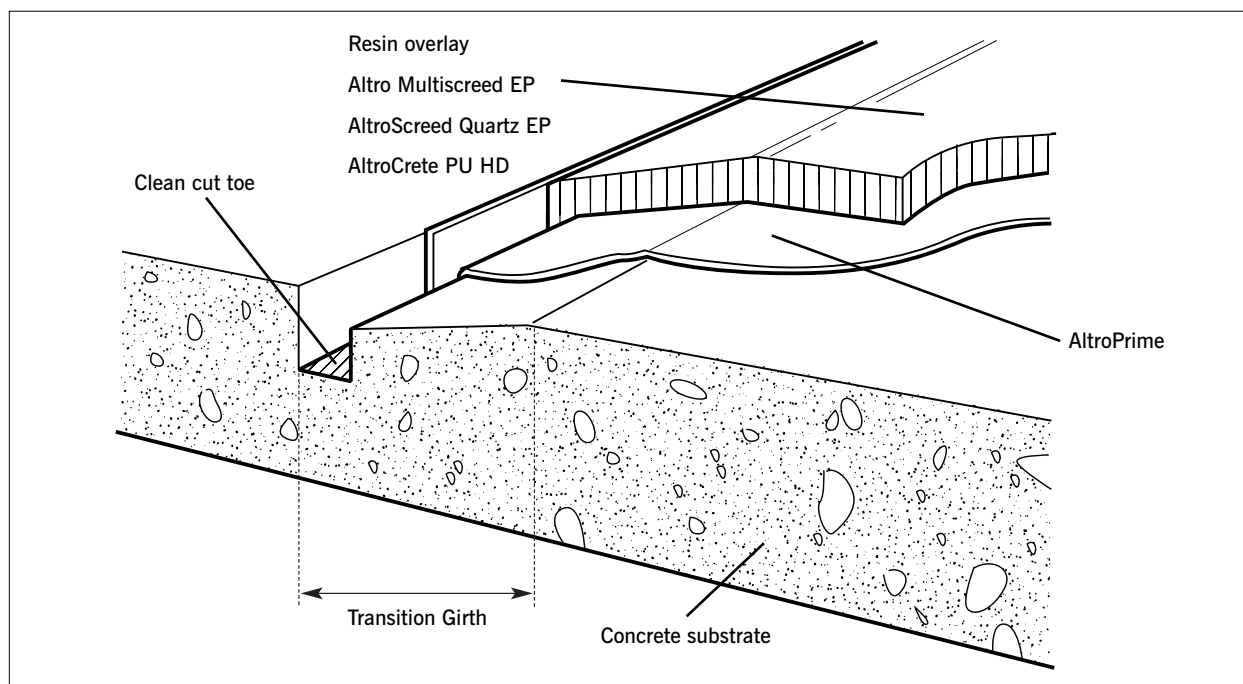

In situ cove detail with retaining rebate

RF2/07/00

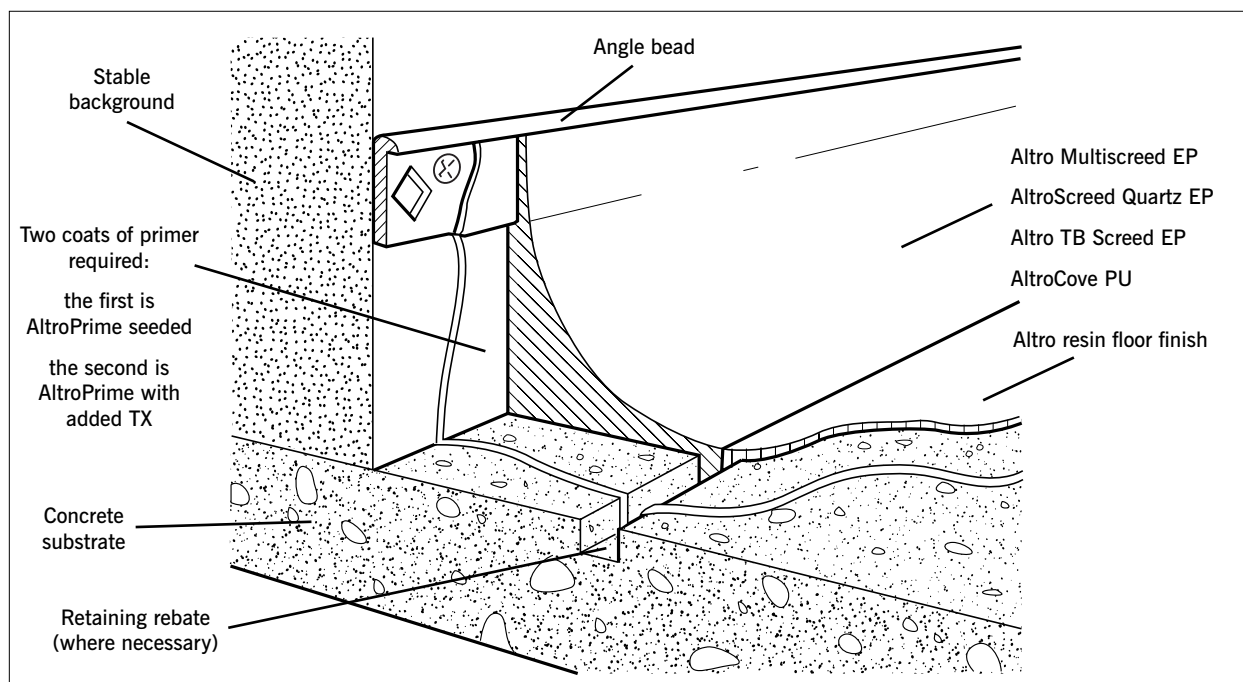

Altro resin flooring finish at floor expansion joints

RF1/07/00

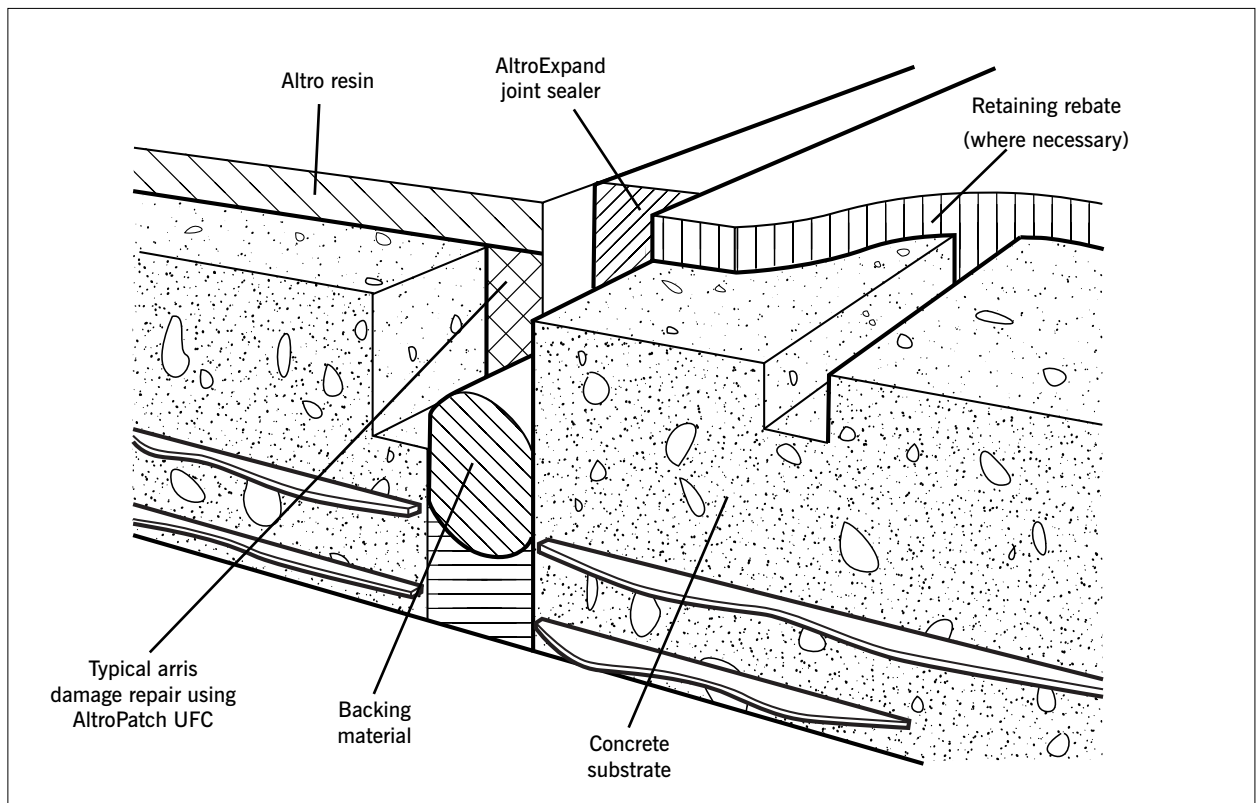

Altro resin flooring finished to stainless steel drainage

RF5/11/05

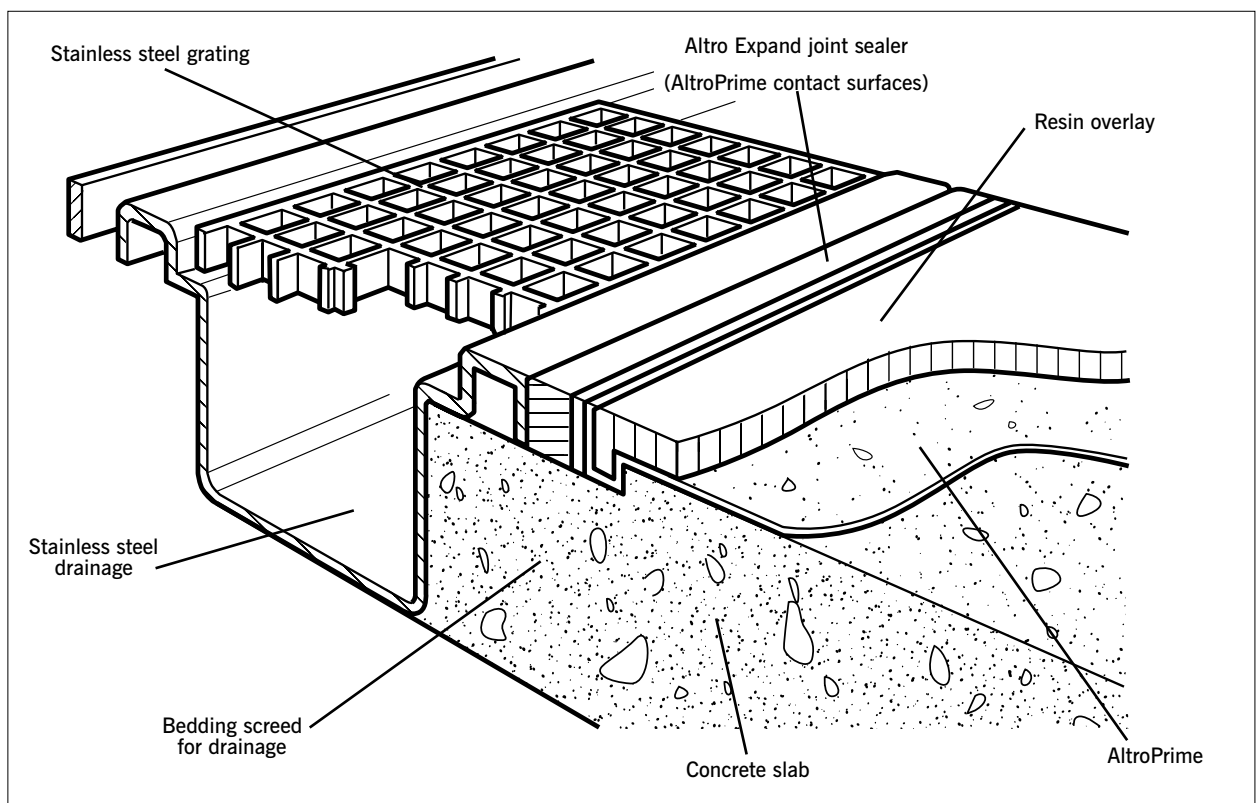

Altro resin flooring finished to poured trench drainage

RF6/11/05

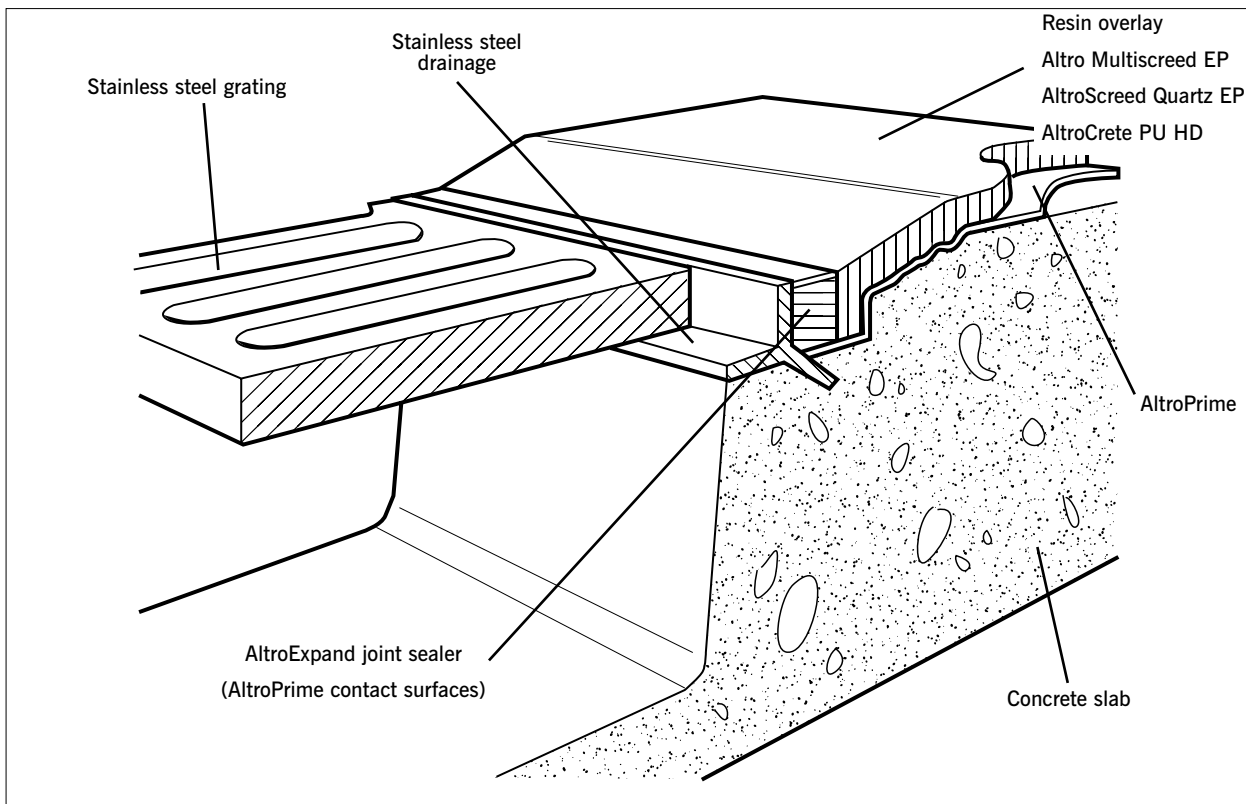

Altro resin flooring with in situ cove and isolated slab to wall

RF7/11/05

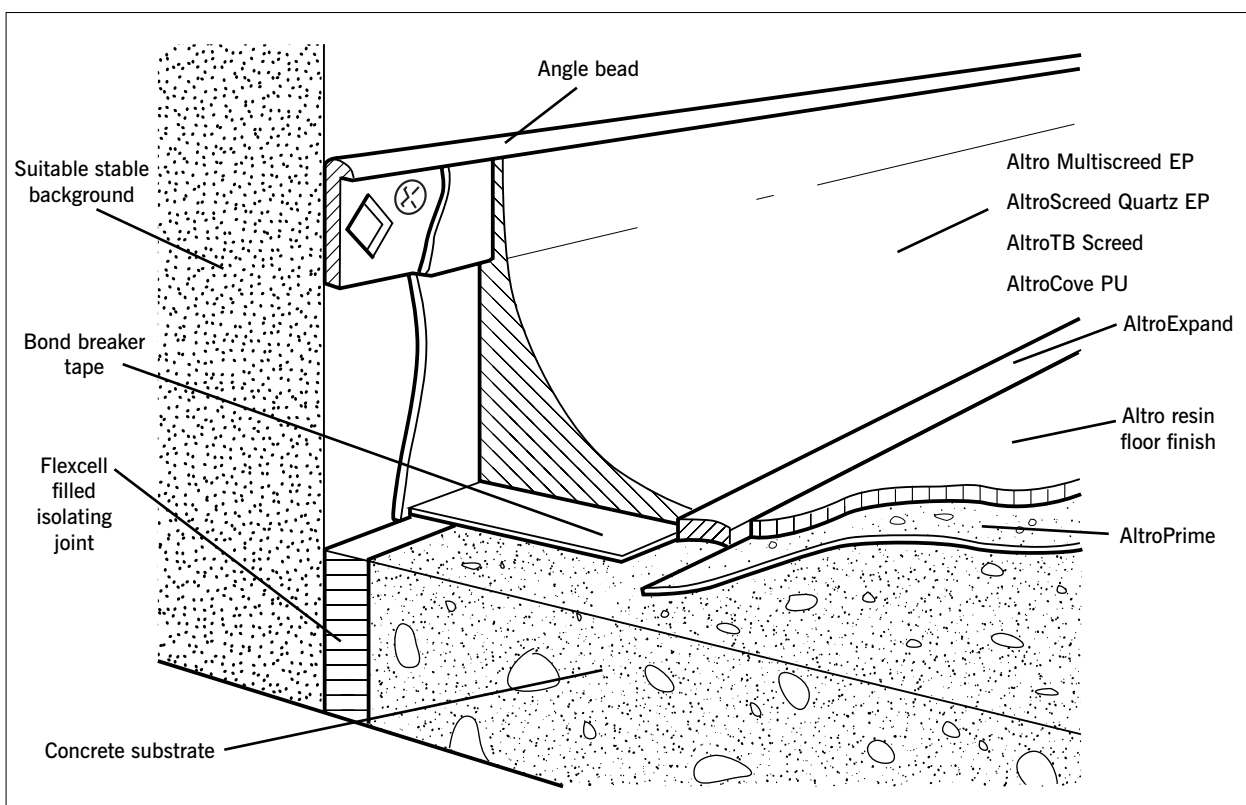

Walls

Altro Whiterock™ hygienic PVCu wall cladding to Altro resin flooring detail

WF5

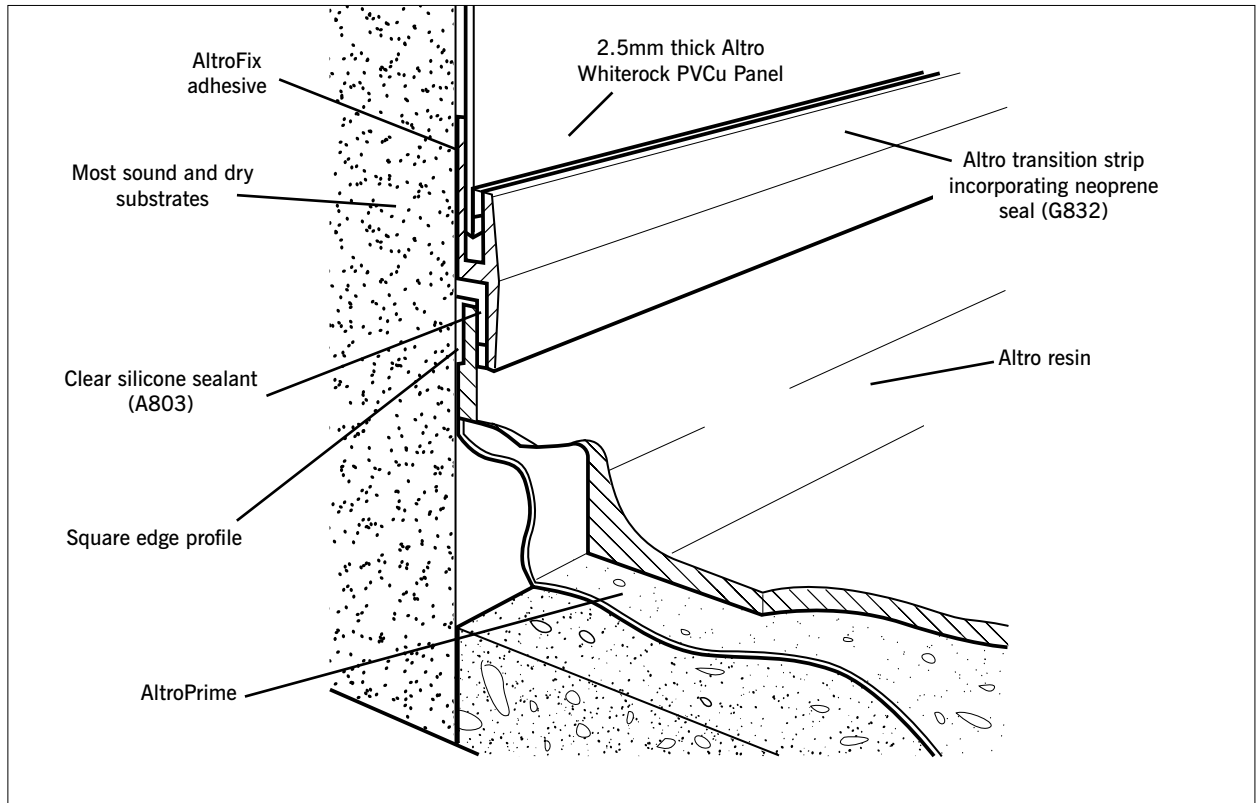

Altro Whiterock™ hygienic PVCu wall cladding to Altro resin flooring detail

WF6

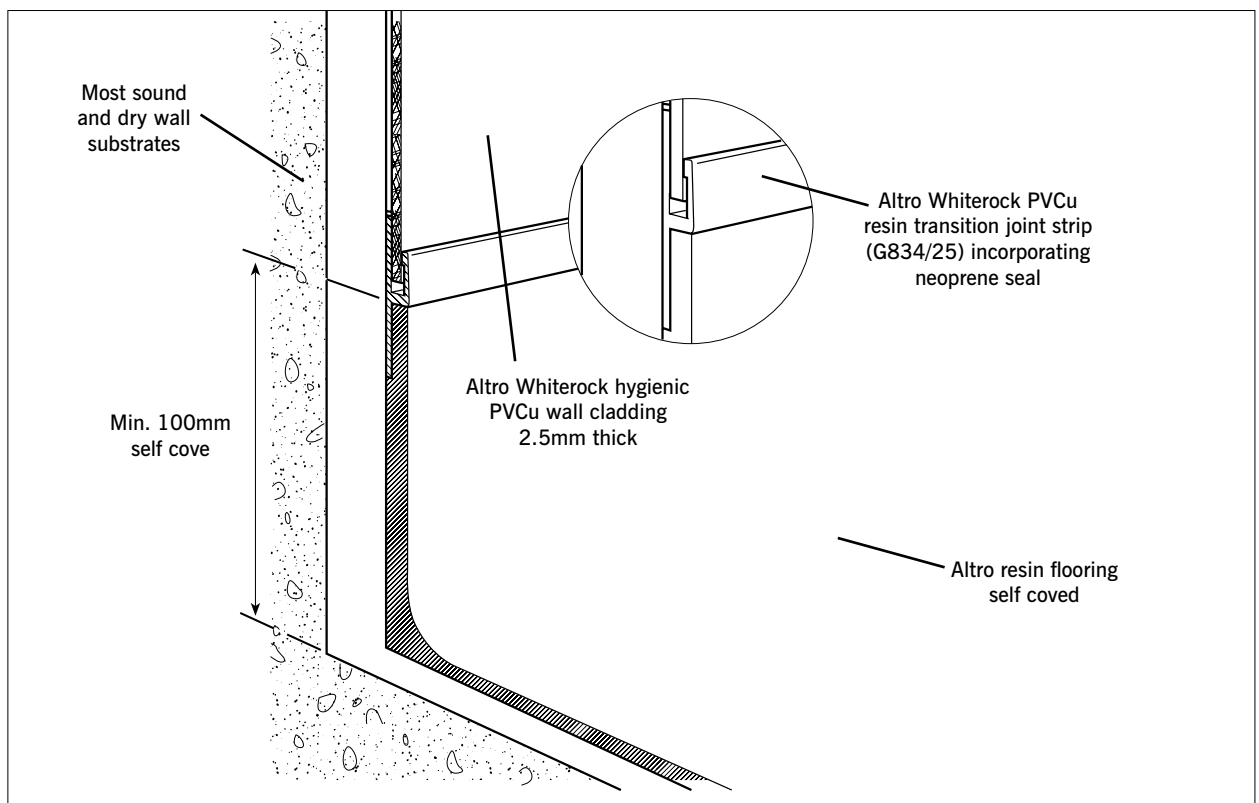

Altro Whiterock™ hygienic PVCu wall cladding to shower tray with integral upstand detail

WS2

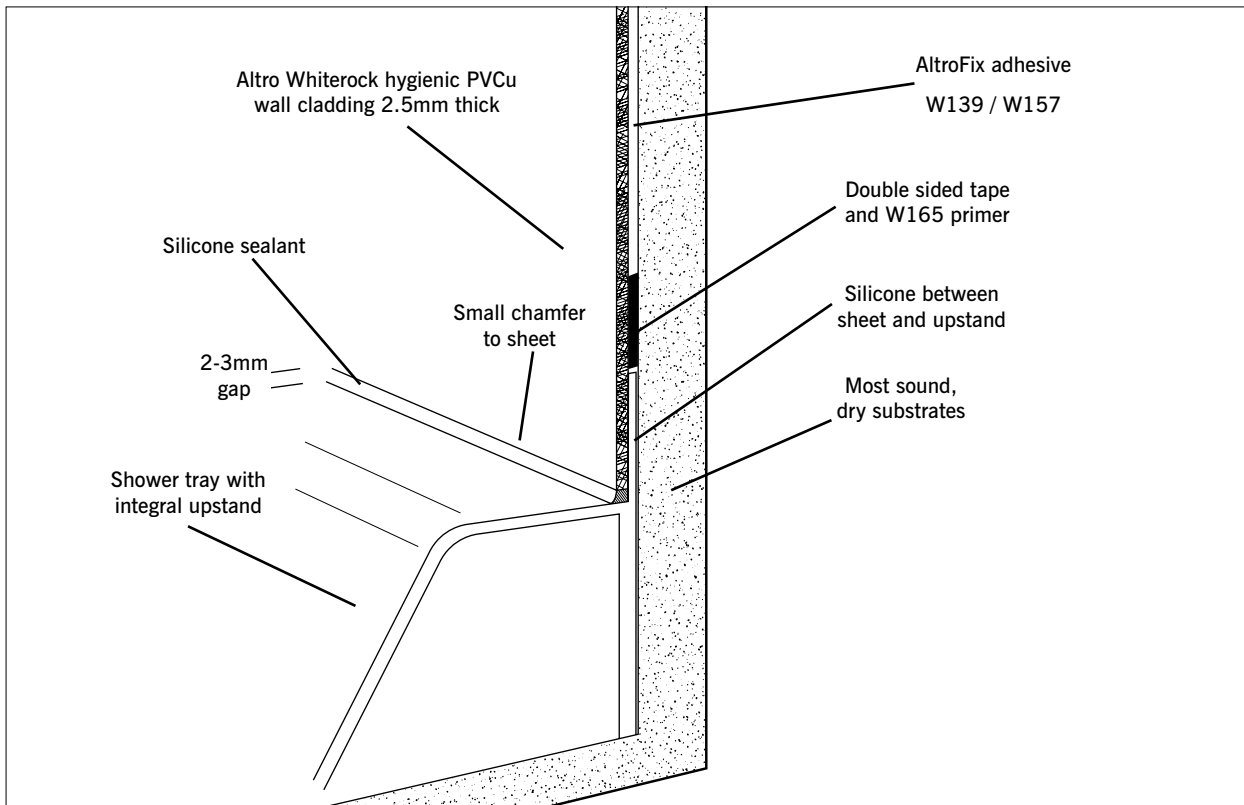

Altro Whiterock™ hygienic PVCu wall cladding to Altro FlexiJoint™ detail

W11

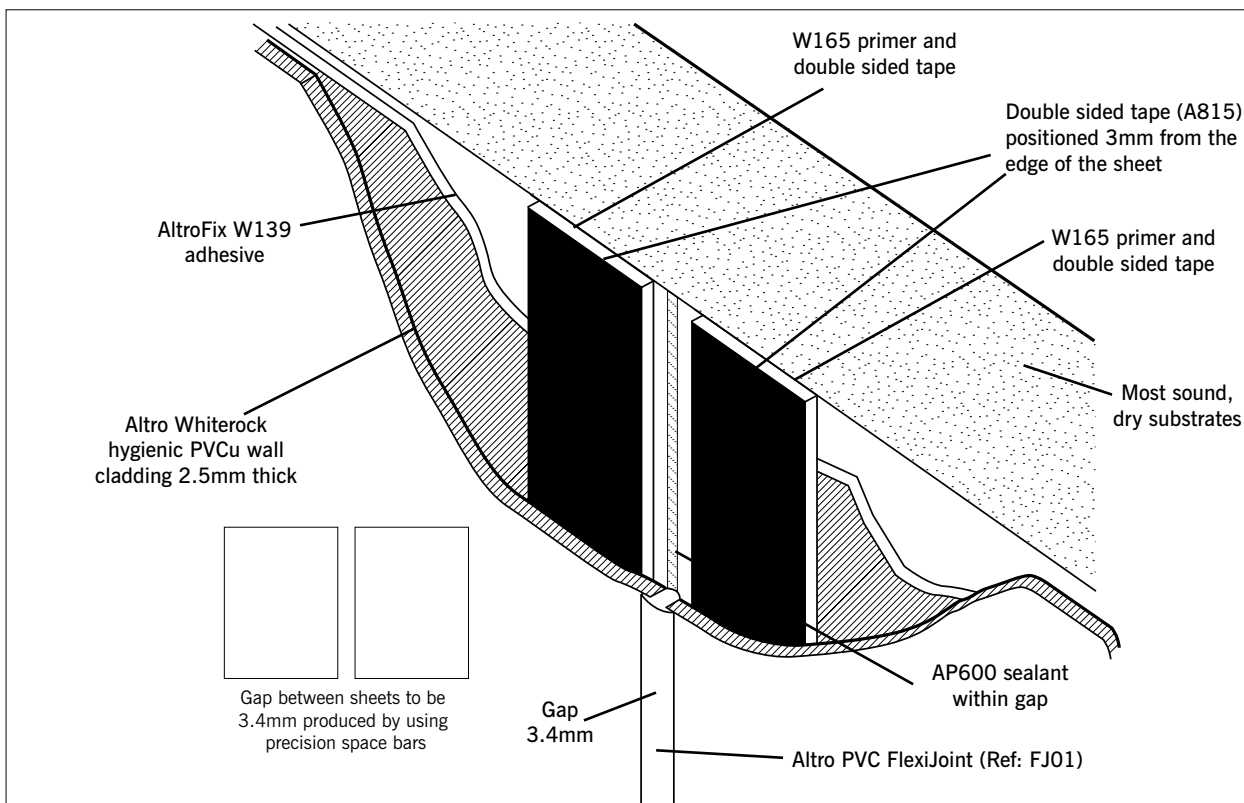

Altro Whiterock™ hygienic PVCu wall cladding to Altro Whiterock hygienic PVCu wall cladding detail

W9

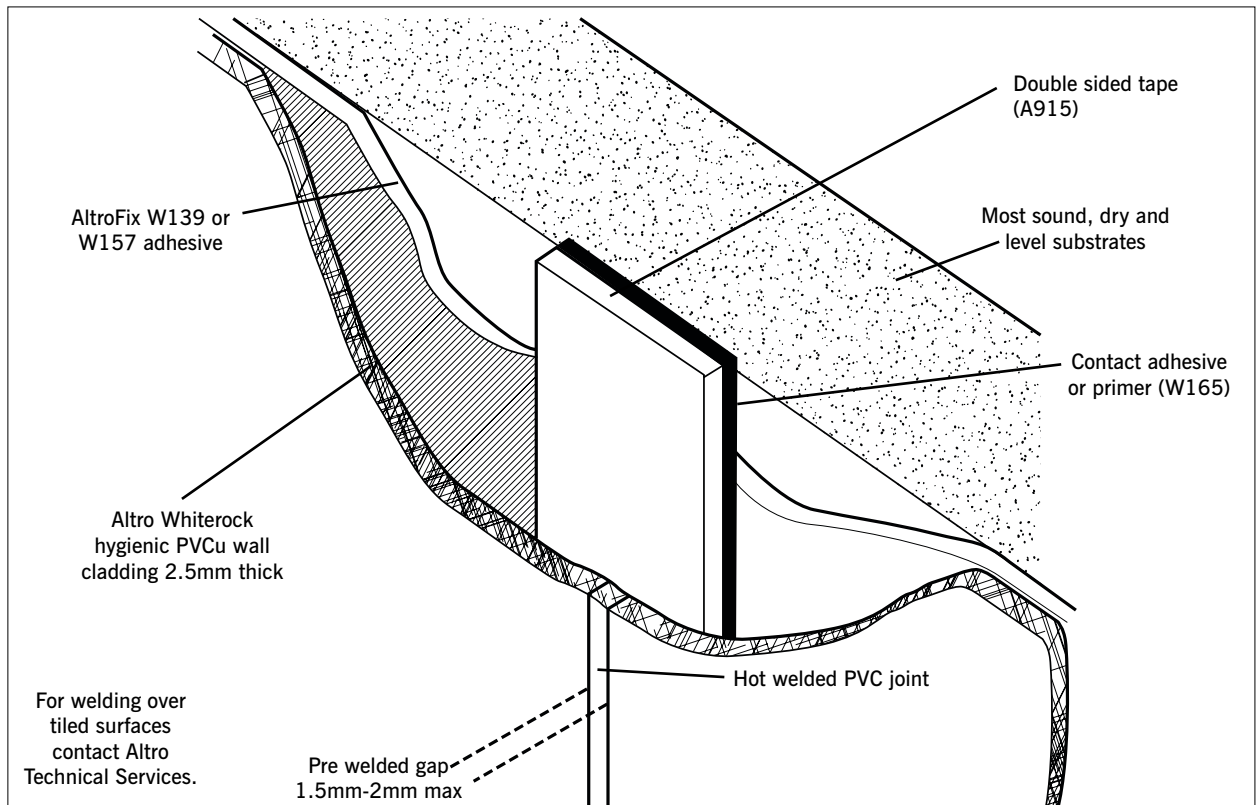

Altro Whiterock™ hygienic PVCu wall cladding to window/door frame detail

W1

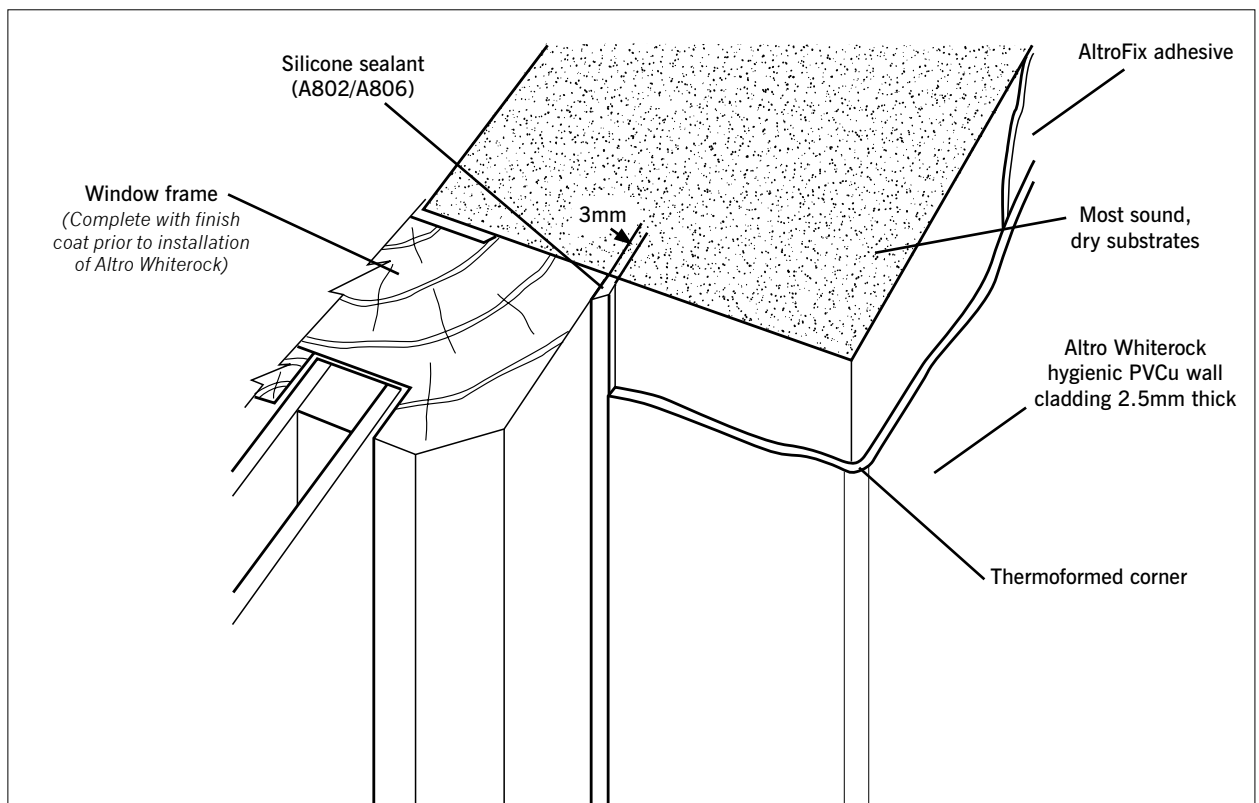

Altro Whiterock™ hygienic PVCu wall cladding to Altro Aquarius / Altro Marine 20 safety flooring shower tray detail

WF4

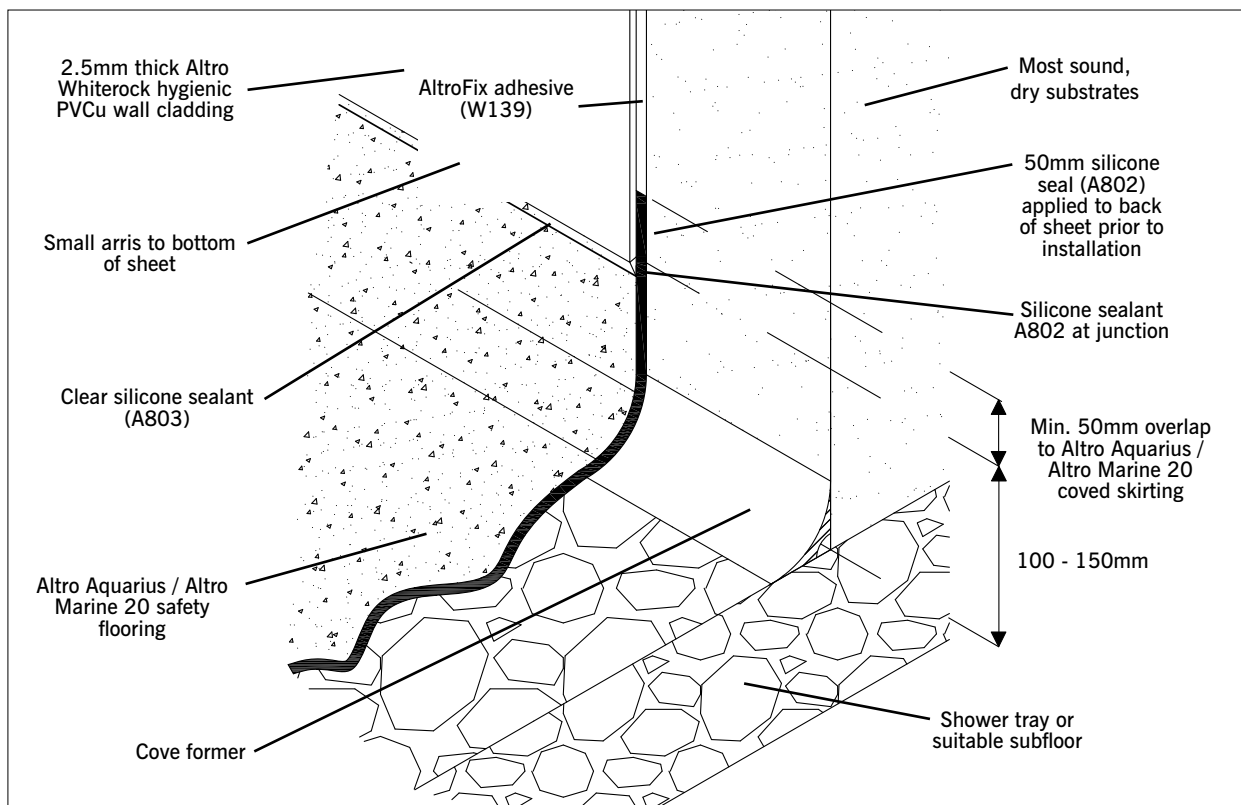

Shower tray detail for dementia-friendly environments available at www.altro.com

Altro Whiterock™ hygienic PVCu wall cladding to Altro safety flooring overlap detail

WF4a

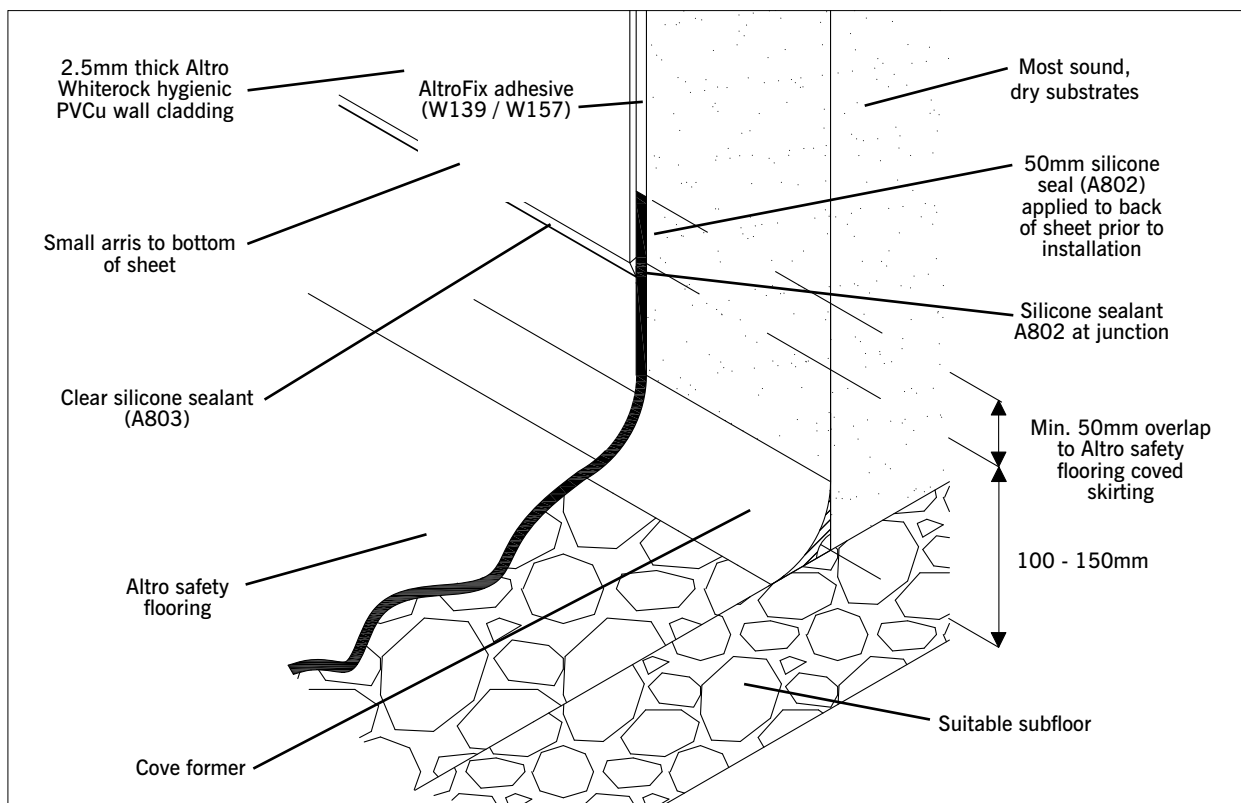

Altro Whiterock™ hygienic PVCu wall cladding with corner protector fixing detail

W8

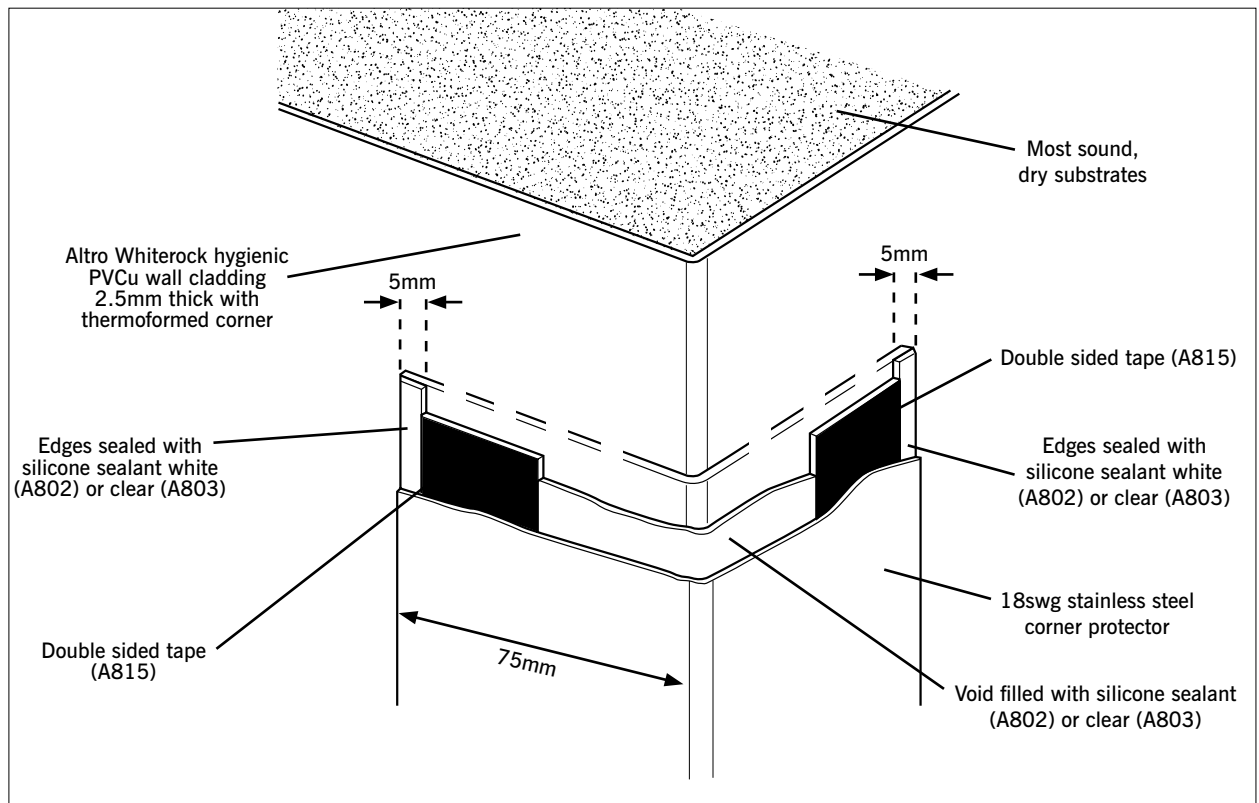

Altro Whiterock™ hygienic PVCu wall cladding to boxing inspection cover detail

W3

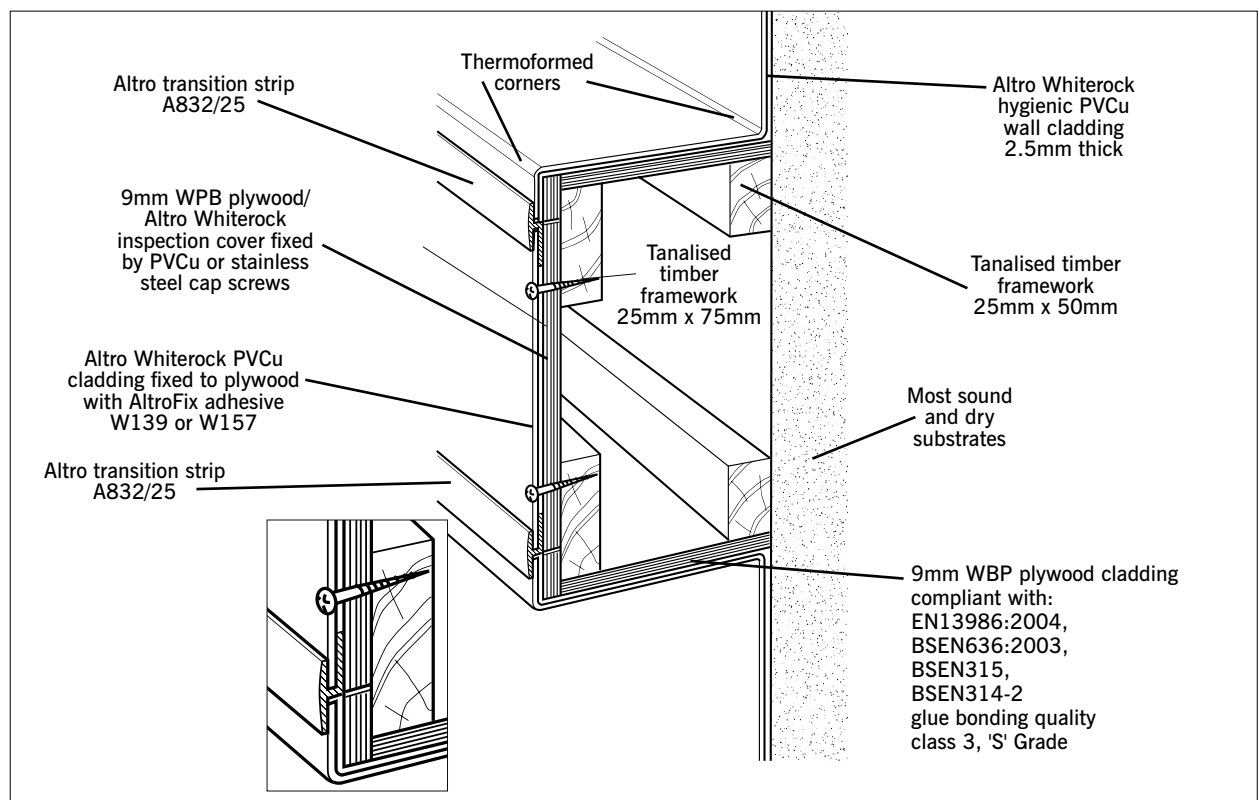

Safety flooring

Self-coved with cove former to Altro Whiterock semi-rigid hygienic PVCu sheet

D8/03/05

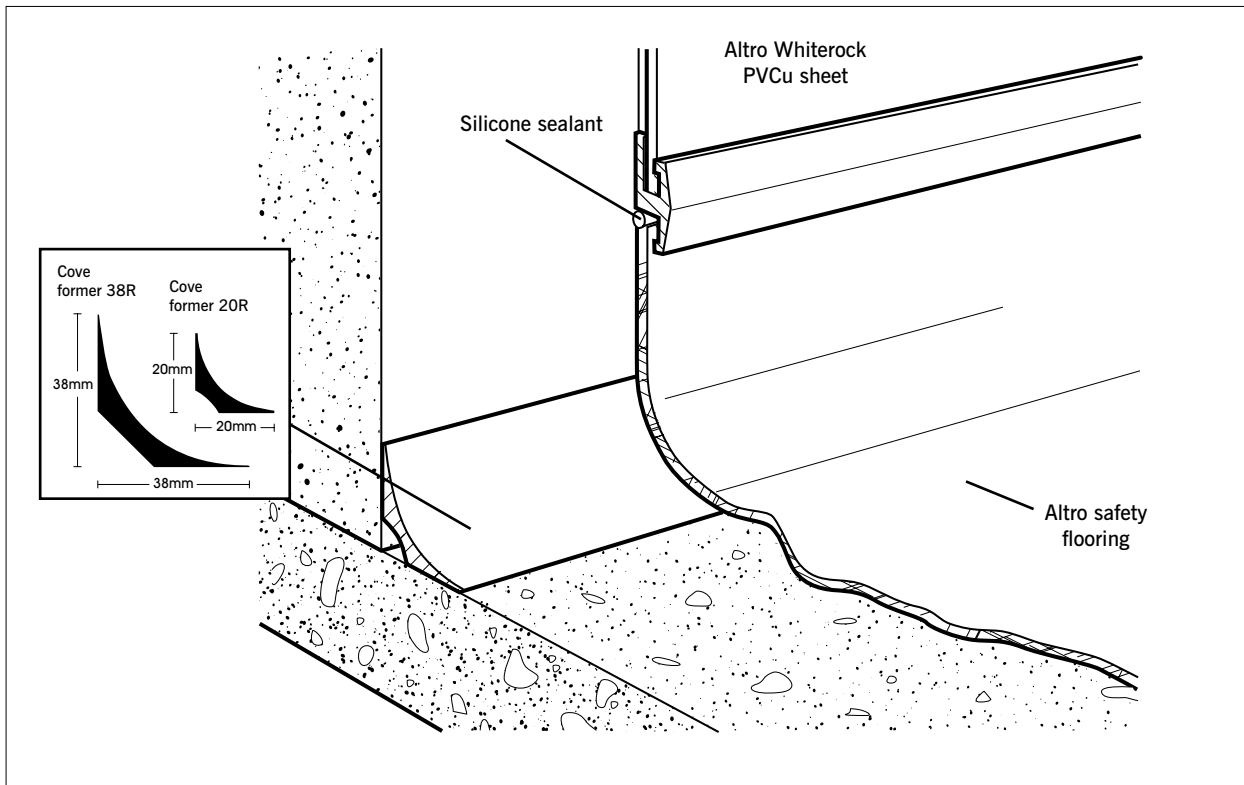

Self-coved with cove former and captile strip C8 to wall tiles

D5/03/05

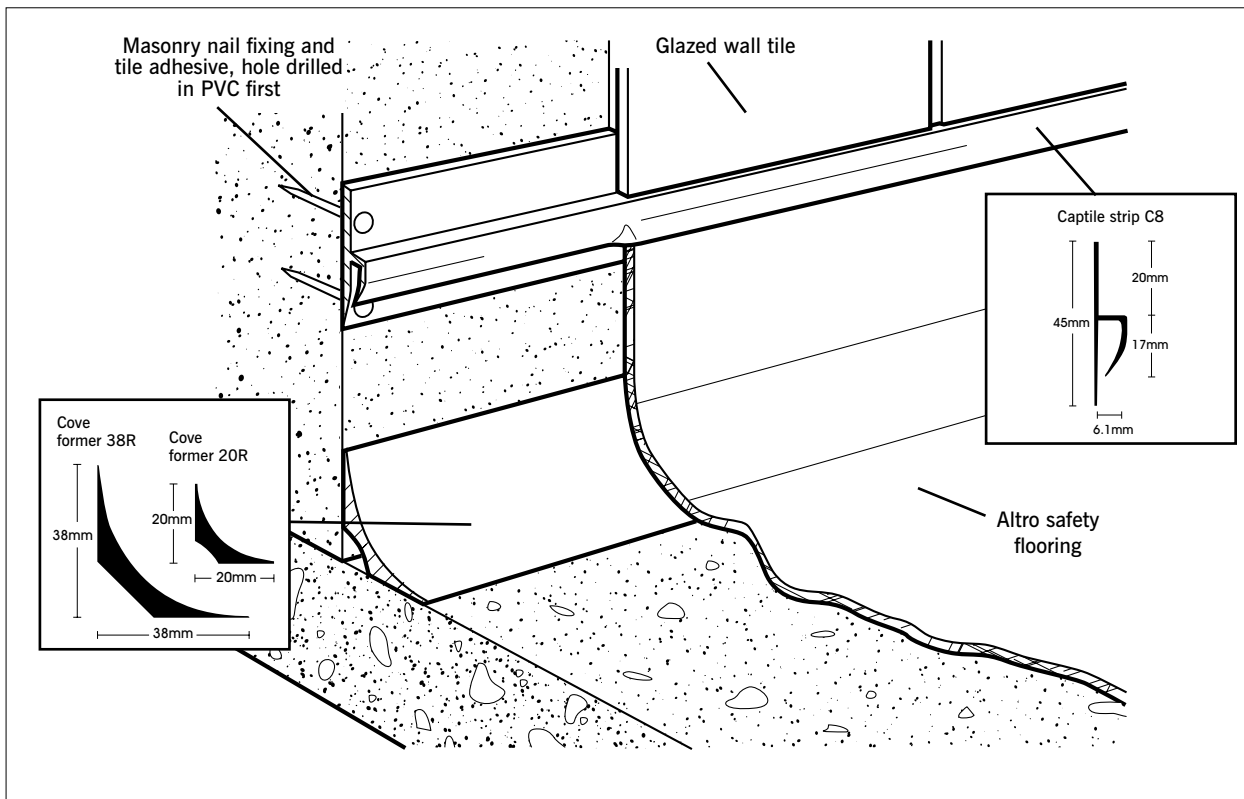

Self-coved to architrave

D9/03/05

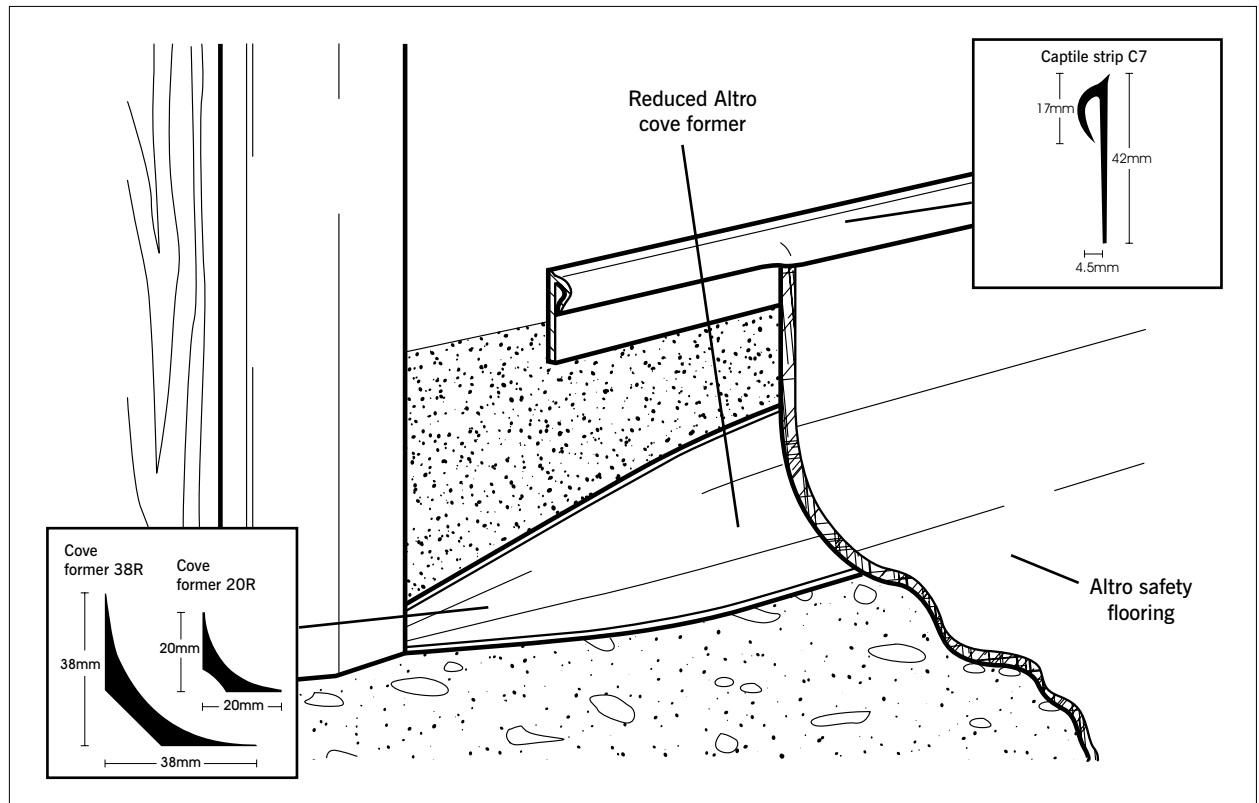

Self-coved with cove former and capping seal C11 over floor tiles

D6/03/05

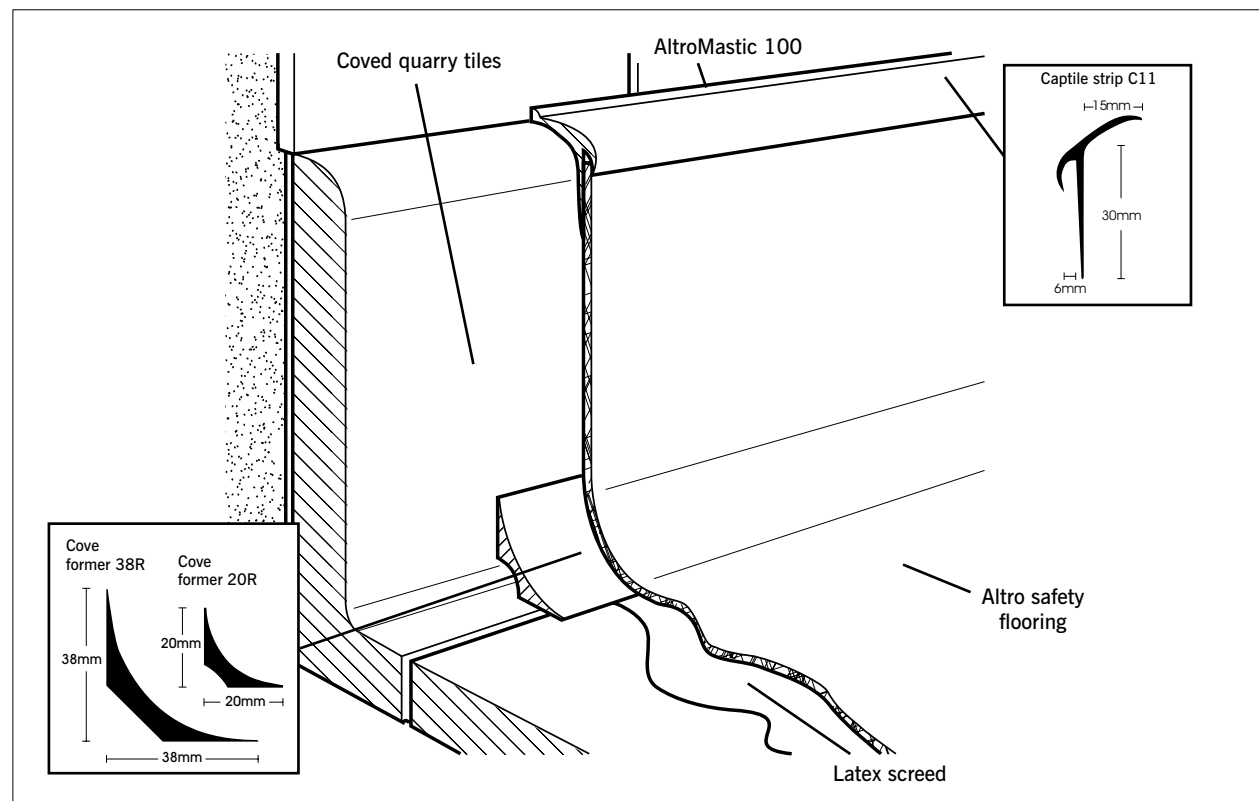

Self-coved with cove former and capping seal

D4/03/05

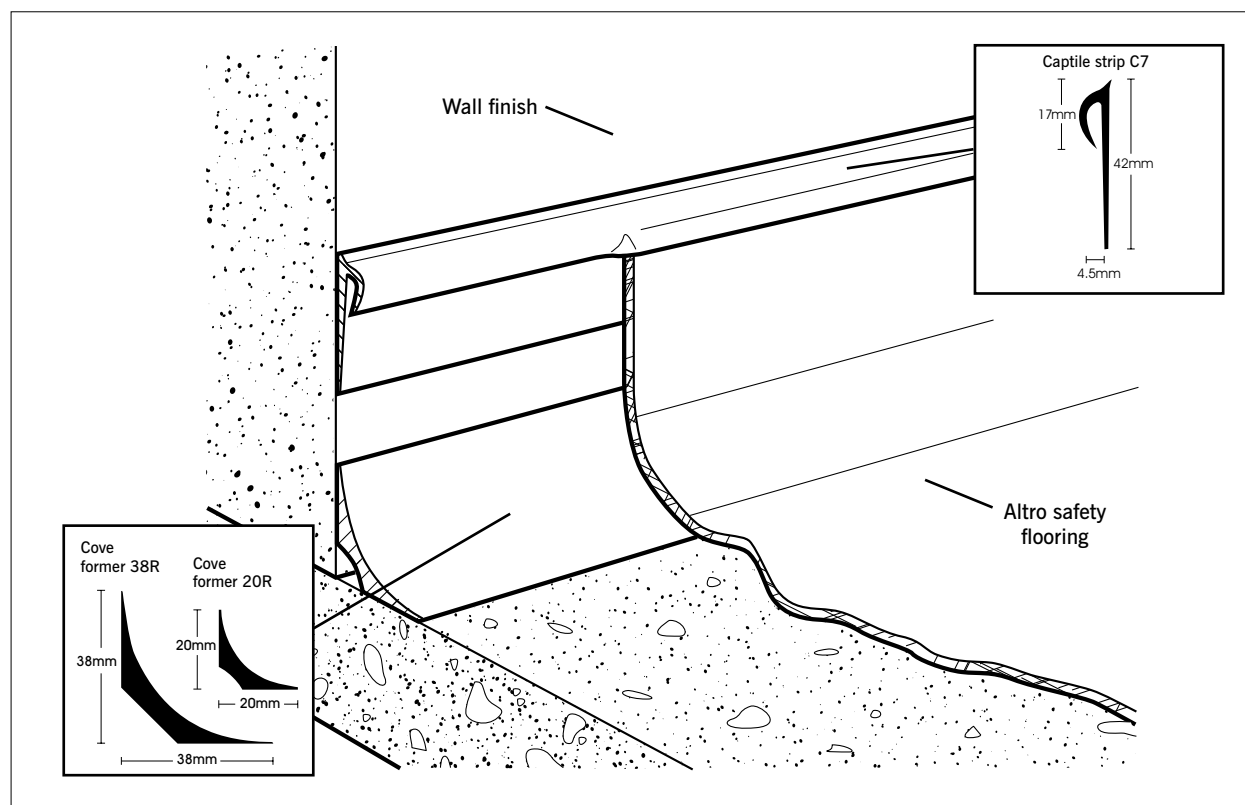

Sit-on cove

D2

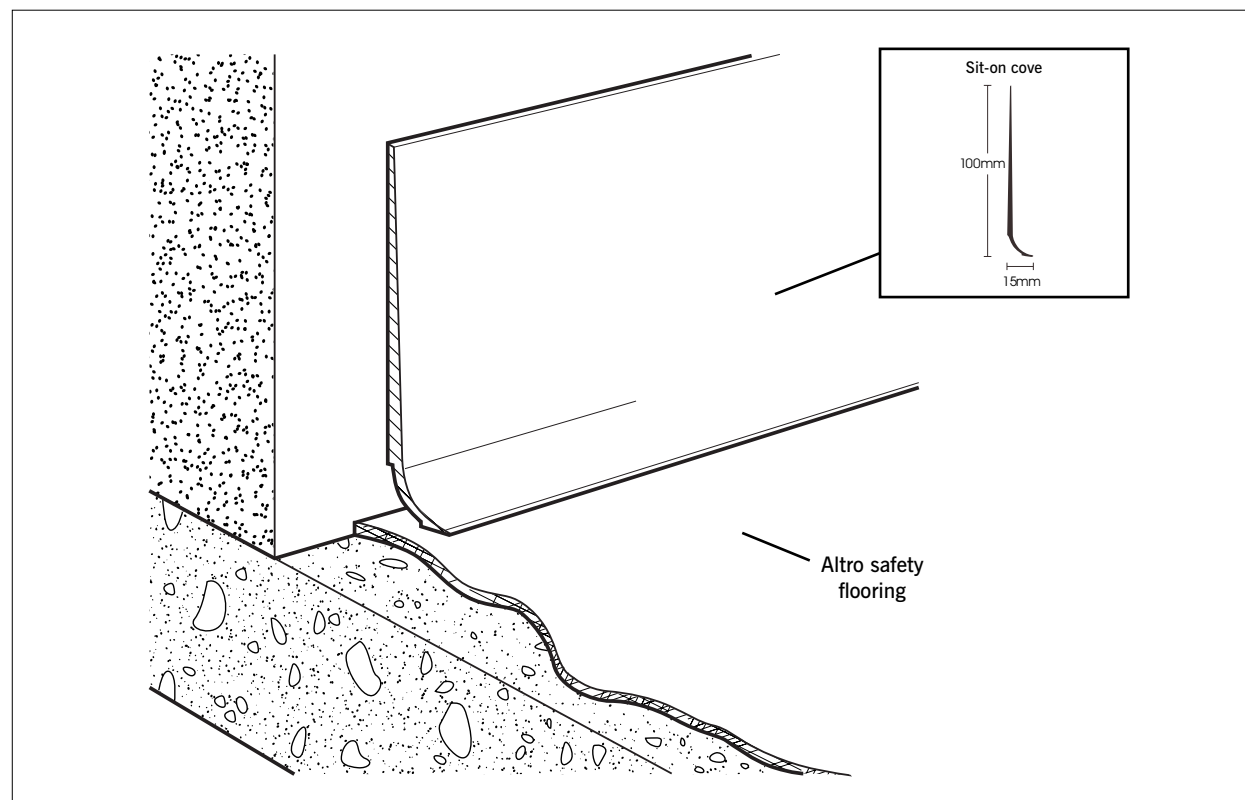

Set-in cove skirting

D3

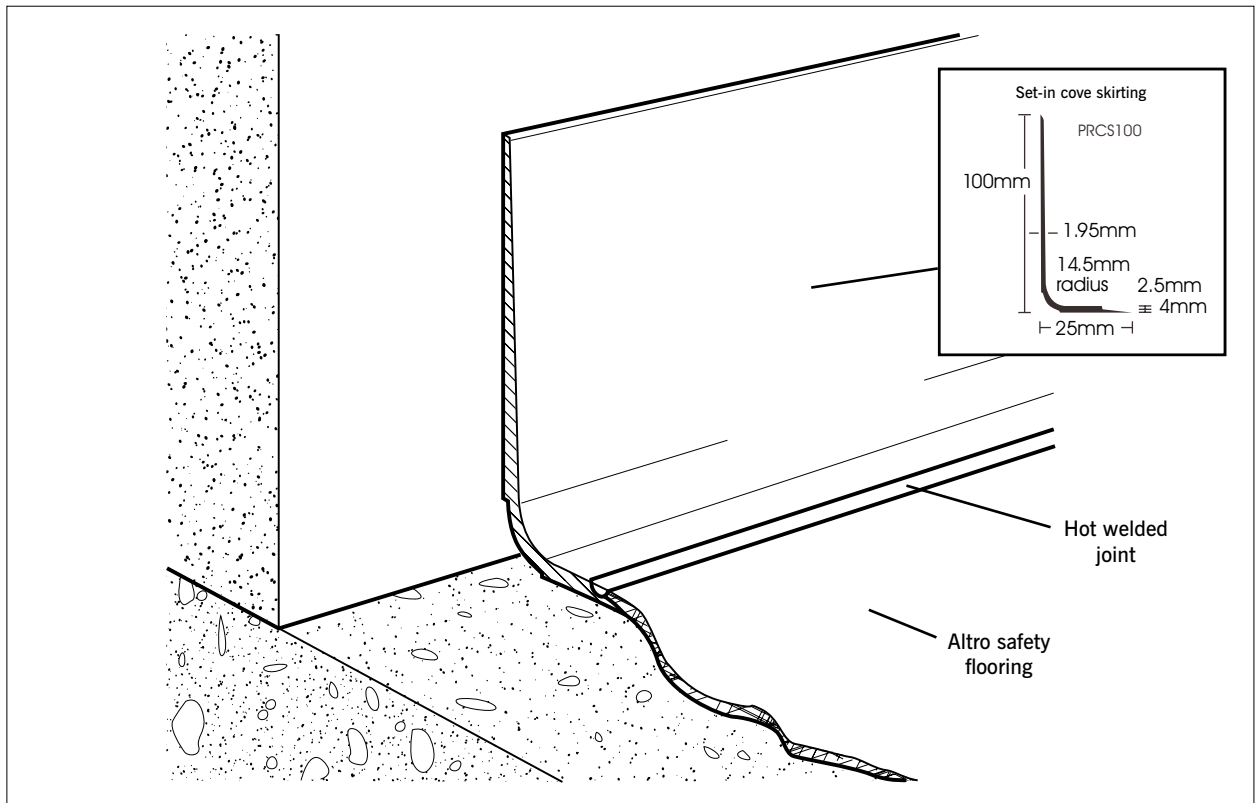

Straight laid

D1/03/05

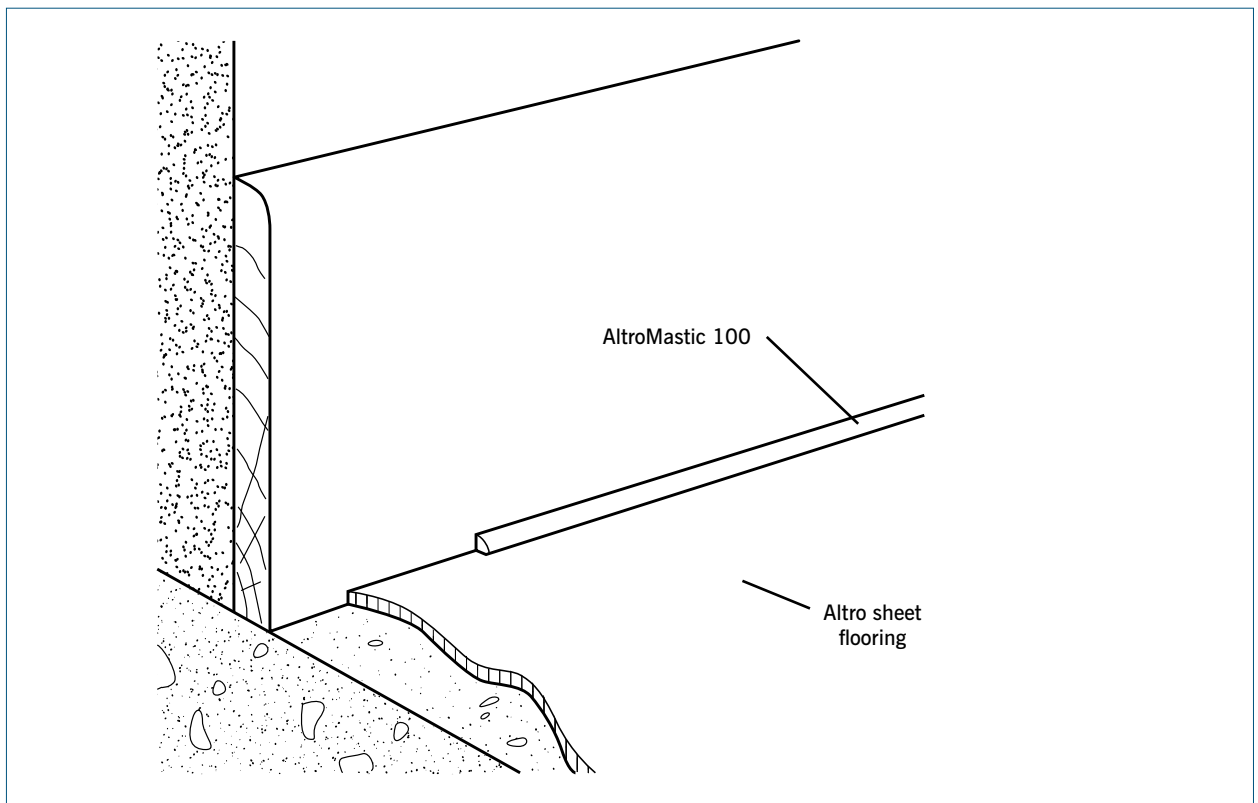

Transition with clamping drain

D13/03/05

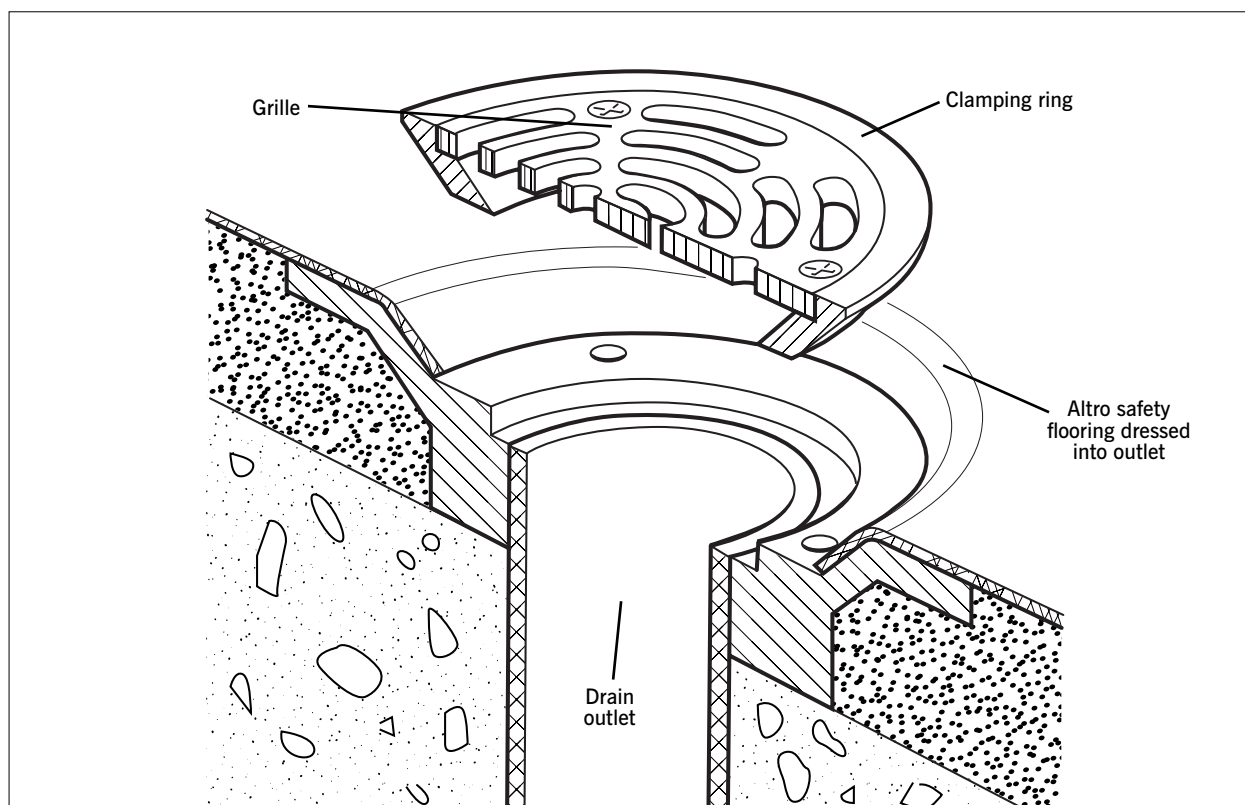

Transition with clamping channel

D14/03/05

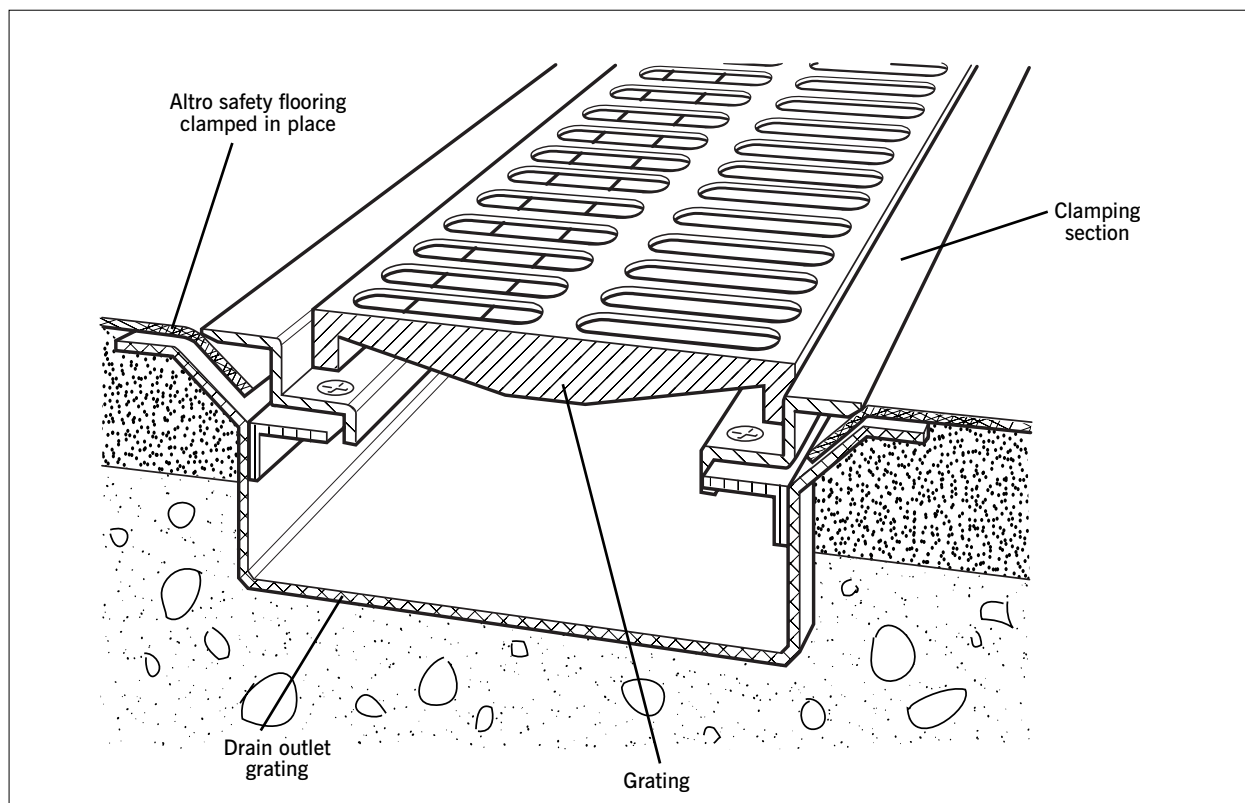

Finished to gully angle

D10/03/05

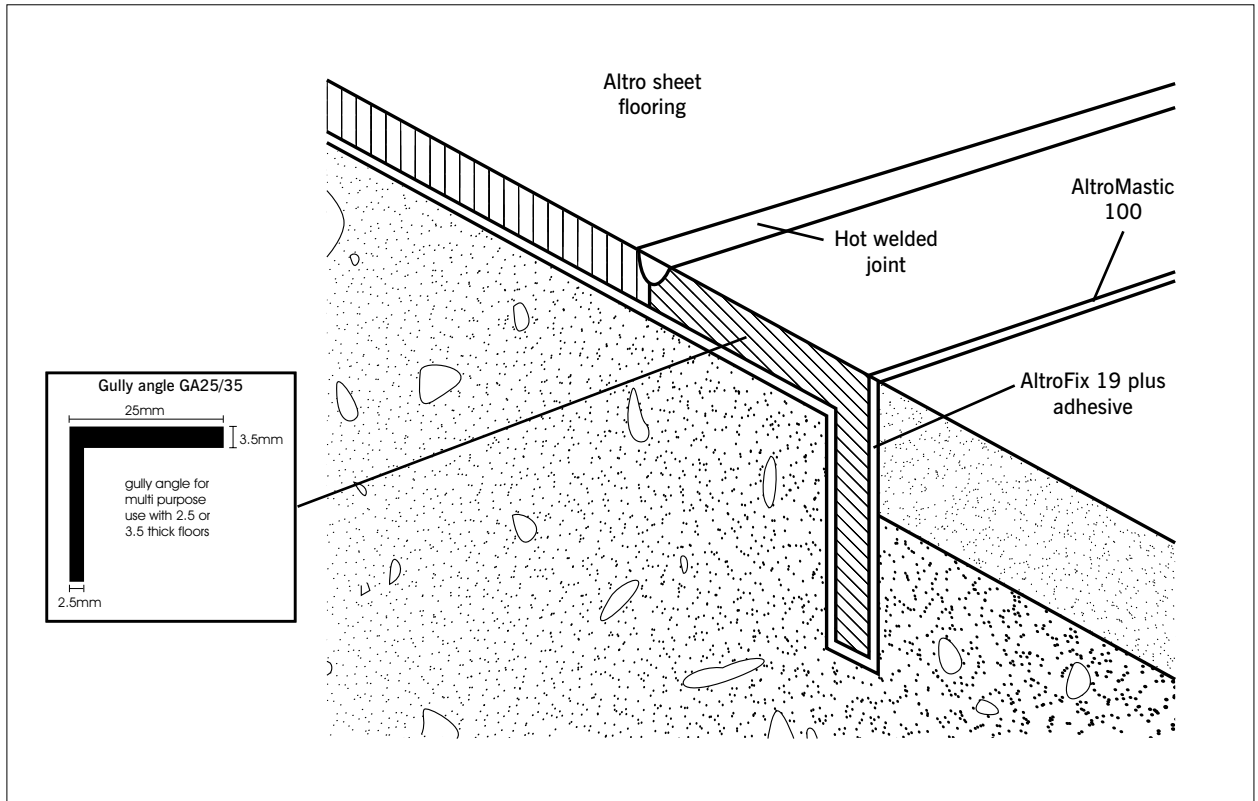

Transition with other floor surfaces

D12/08/05

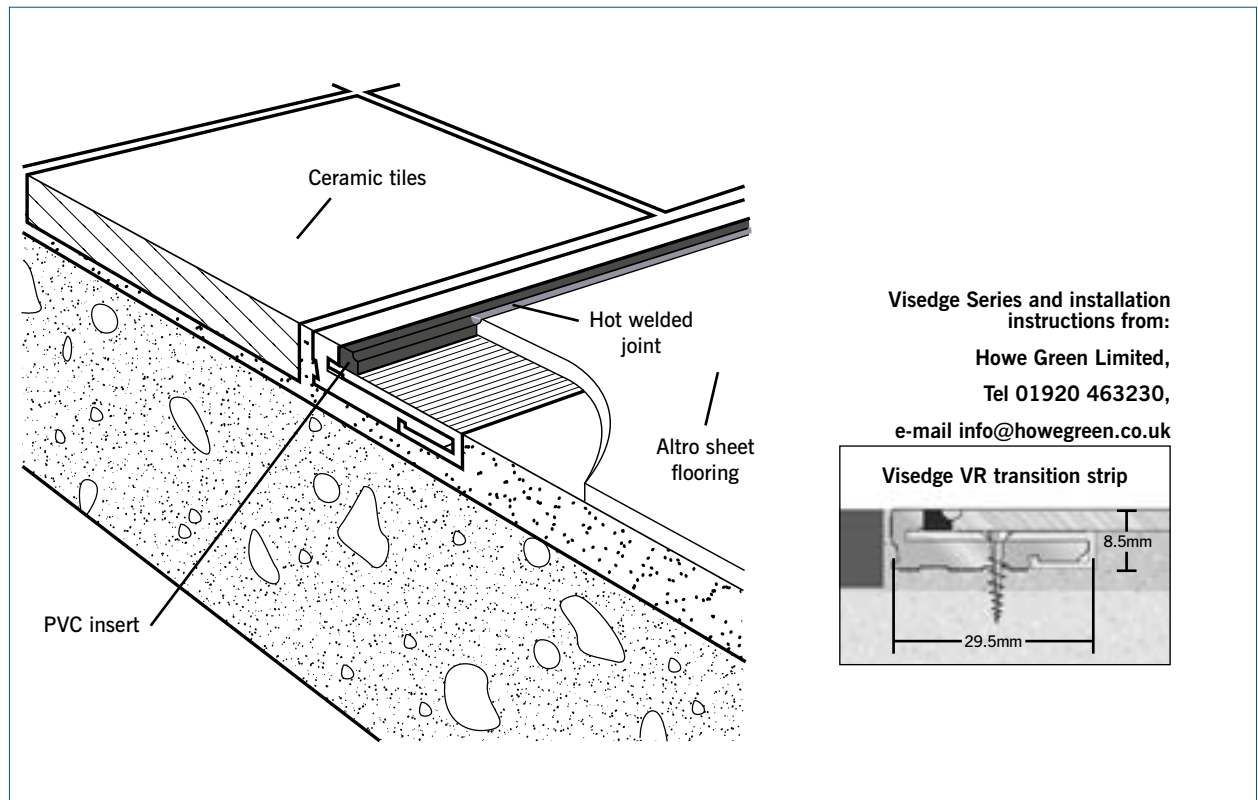

Transition with access covers

D16/03/05

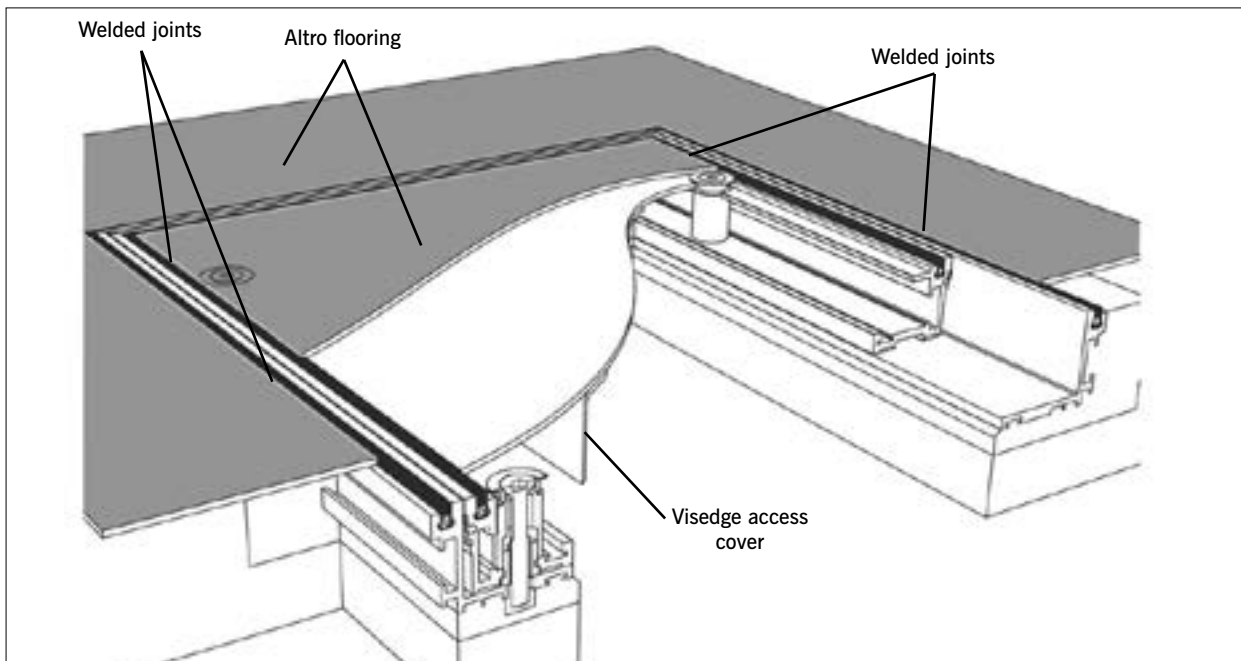

Altro offer many other installation detail drawings to assist specifiers and installers. All our installation detail drawings can be downloaded from www.altro.co.uk, within the 'Technical Information' section of the site. Altro can also provide detail and typical specification clauses for virtually any installation of our flooring, wall cladding or doorset products.